

**Description**

The MyHOME Server is a device designed to interact with the MyHOME <sup>(1)(2)</sup> by means of the Home + Control app for smartphone and tablet (available in the stores for Android and iOS systems).

In particular thanks to this device one can:

**Start the MyHOME system**

- Concerning the Lights<sup>(3)</sup>, Automation<sup>(3)</sup> and Temperature Control<sup>(3)</sup> systems the system is started via the MyHOME Server directly using the Home + Project application.
- Energy management system can be configured via MyHOME Server using MyHOME\_Suite PC software.

**Interact with the MyHOME system**

- The MyHOME <sup>(4)</sup> system can be controlled via the MyHOME Server and third party devices <sup>(5)</sup> via the Home + Control. Both the installer (using the Home + Project App) and the user (using the Home + Control App) can perform customisations and create scenarios for managing the MyHOME system.

<sup>(1)</sup> **Note: MyHOME Server is only compatible with the Home + Project application and with the MyHOME\_Suite software.**

<sup>(2)</sup> The new Living Now civil series is compatible with firmware versions after 2.1, or app versions after 2.2

<sup>(3)</sup> For correct operation it is fundamental that the connection is made on the private riser BUS (level 3) of the automation system (see MyHOME Automation Guide).

**NOTE:** It is not possible to have more than 175 channels per system. Home + Project will issue a warning when this limit is exceeded. It is not possible to install the MyHOME Server on systems with logical expansion.

<sup>(4)</sup> The MyHOME Server manages the Light, Automation, Temperature control, Energy Management, Burglar-alarm systems.

<sup>(5)</sup> For example one can interact with Philips Hue® and Lixf® lamps, ...

**Technical data**

Power supply from SCS BUS:	18 - 27 Vdc
Supplementary power supply (optional):	18 - 27 Vdc
Absorption from SCS BUS without additional power supply:	130 mA max
Absorption from SCS BUS with additional power supply:	3 mA max
Absorption from additional power supply:	160 mA max
Operating temperature:	5 – 35 °C
Default fixed IP address:	192.168.0.55

**Dimensional data**

Size: 6 DIN modules

Front view

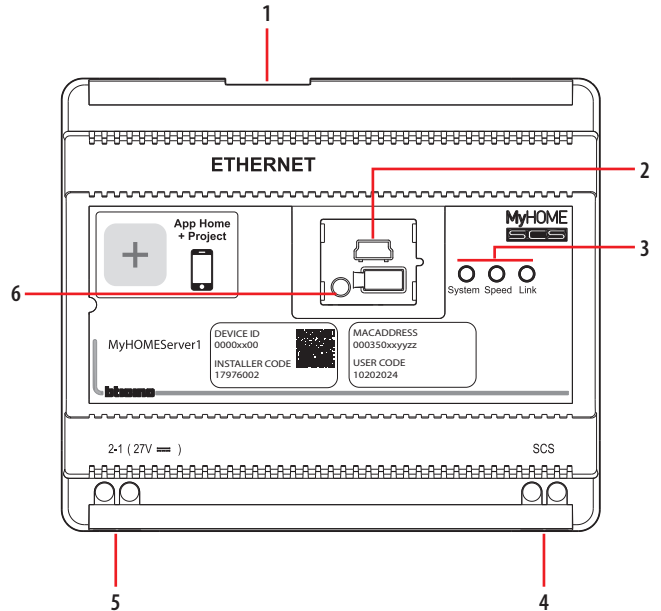

**Legend**

1. RJ45 for Ethernet LAN 10/100 Mbit
2. Under the door are:
  - USB port for firmware update using MyHOME\_Suite software \*
  - RESET pushbutton (to change to DHCP Dynamic IP keep pressed for 10 s)
  - RS232 serial connection
3. User interface:
  - Speed: Connection speed: ON = 100 Mbit/s  
OFF = 10 Mbit/s
  - Link: When on, it indicates that the Ethernet network has been found
  - System: On connecting the power supply it switches on and off and the next time it switches on it indicates that MyHOME Server is operative
4. 2 wire BUS for connection to the MyHOME system
5. Supplementary power supply (optional) (27 Vdc)
6. Restart pushbutton:
  - short pressure (1") = device restart
  - long pressure (10") = Dynamic IP Setting (D HCP)
 After the long pressure of the reset pushbutton, the system LED will flash twice slowly and twice quickly for about 10".

\* **NOTE:** It is recommended to update the MyHOMEServer1 to the latest available firmware version. The MyHOME\_Suite software and the firmware can be downloaded from the website [www.homesystems-legrandgroup.com](http://www.homesystems-legrandgroup.com).

## Light and Automation Devices that can be directly associated via MyHOME Server

Description	Legrand code	From production batch:	BTicino code	From production batch:
Scenario control	LG-573902	08W51	BT-L4680	09W08
	LG-573903	08W51	BT-N4680	09W08
	LG-574503	all	BT-NT4680	09W08
	LG-574504	all	BT-HC4680	09W08
	LG-067217	all	BT-HD4680	09W08
	LG-067218	all	BT-HS4680	09W08
	LG-078478	all		
LG-079178	all			
SCS/SCS interface	LG-003562	12W20	BT-F422	12W20
Touch multifunction control	LG-067243	13W05		
	LG-067244	13W05		
	LG-067245	13W05		
BUS 8-key control	LG-067592	all	BT-LN4652	all
			BT-H4652	all
2 m basic control	LG-067552	all	AR-64360	09W40
			BT-H4652/2	09W40
			BT-L4652/2	09W40
			BT-AM5832/22	09W40
3 m basic control	LG-067554	all	BT-L4652/3	09W40
			BT-H4652/3	09W40
			BT-AM5832/3	09W40
Light actuator			BT-K8002L	all
BUS shutter actuator	LG-067557	all	BT-LN4661M2	all
			BT-H4661M2	all
			BT-AM5861M2	all
			BT-K8002S	all
BUS shutter control	LG-067558	all	BT-LN4660M2	all
			BT-H4660M2	all
			BT-AM5860M2	all
Special control	LG-067553	all	AR-64362	all
			BT-L4651M2	08W41
			BT-H4651M2	08W41
			BT-AM5831M2	08W41
16A 100/240V 1 relay DIN actuator	LG-003847	all	BT-F411U1	all
16A 100/240V 2 relay DIN actuator	LG-003848	all	BT-F411U2	all
16A 100/240V 1 relay DIN actuator	LG-003841	10W17	BT-F411/1N	09W13
16A 2 relay DIN actuator	LG-003842	10W18**	BT-F411/2	09W04**
16A 100/240V 2 relay DIN actuator	LG-002601	all	BT-BMSW1002	all
16A 100/240V 4 relay DIN actuator	LG-002602	all	BT-BMSW1003	all
6A 4 relay DIN actuator	LG-003844	10W22*	BT-F411/4	09W04*
16A 100/240V 4 relay DIN actuator	LG-002604	all	BT-BMSW1005	all
4 output DIN actuator for 0-10V ballast	LG-002612	all	BT-BMDI1002	all
DIN actuator for 0-10V ballast	LG-003656	10W05	BT-F413N	09W14
Basic contact interface	LG-573996	10W04	BT-3477	10W04
DIN contact interface	LG-003553	10W13	BT-F428	09W50

\* If the device is installed on the output of the F422 interface, the minimum batch is 15W25

\*\* If the device is installed on the output of the F422 interface, it is not possible to associate it using the APP. It is recommended to replace it with the code F411U2

Description	Legrand code	From production batch:	BTicino code	From production batch:
1000 VA DIN dimmer	LG-002621	all	BT-F416U1	all
1000 W DIN dimmer	LG-003652	09W50	BT-F414	09W29
400 VA DIN dimmer	LG-003653	10W07	BT-F415	09W22
2 x 400 VA DIN dimmer	LG-002622	all	BT-F417U2	all
300 VA DIN dimmer	LG-003665	all	BT-F418	all
2 x 300 VA DIN dimmer	LG-003651	all	BT-F418U2	all
LG-573912 3 m touch control	LG-573912	11W27	BT-HC4657M3	11W09
	LG-573913	11W09	BT-HD4657M3	11W12
			BT-HS4657M3	11W12
4 m touch control			BT-HC4657M4	11W12
			BT-HD4657M4	11W12
			BT-HS4657M4	11W14
SCS/DALI interface	LG-002631	10W13	BT-F429	10W20
Basic actuator			BT-3475	12W31
BUS shutter DIN actuator	LG-003666	all	BT-F401	all
Control actuator	LG-067561	all	BT-AM5852M2	all
	AR-64195	all	BT-H4672M2	all
	AR-64196	all	BT-LN4672M2	all
	AR-64393	all		
Basic control actuator			BT-3476	12W39
Control actuator	LG-067556	all	BT-LN4671M2	all
DIN dimmer for 0-10 V ballast	LG-002611	all	BT-BMDI1001	all
BUS Dual Tech Green Switch	LG-067226	all	BT-L4658N	all
	LG-078486	all	BT-N4658N	all
	LG-574048	all	BT-NT4658N	all
	LG-574098	all	BT-HC4658	all
			BT-HD4658	all
BT-HS4658	all			
PIR BUS automatic switch	LG-067225	all	BT-L4659N	all
	LG-078485	all	BT-N4659N	all
	LG-574046	all	BT-NT4659N	all
	LG-574096	all	BT-HC4659	all
			BT-HD4659	all
BT-HS4659			all	
PIR ceiling mounted sensor	LG-048820	all	BT-BMSE3001	all
PIR+US double technology ceiling mounted sensor	LG-048822	all	BT-BMSE3003	all
IP55 PIR wall mounted sensor	LG-048834	all		
Memory module			BT-F425	10W01
Control			BT-K4652M2	all
			BT-K4652M3	all
Control actuator			BT-K4672M2S	all
			BT-K4672M2L	all

**Temperature Control Devices that can be directly associated via MyHOME Server**

Description	Legrand code	From production batch:	BTicino code	From production batch:
Thermostat with Display	LG-067459	all	BT-LN4691	all
	LG-064170	all	BT-H4691	all
	LG-752131	all		
	LG-752731	all		
Temperature control probe			BT-KM4691	all
			BT-KG4691	all
			BT-KW4691	all
Probe without adjustment	LG-067458	13W36	BT-L4693	13W36
	LG-573924	13W36	BT-N4693	13W36
	LG-573925	13W36	BT-NT4693	13W36
			BT-HC4693	13W36
			BT-HS4693	13W36
			BT-HD4693	13W36
DIN actuator with 2 independent relays	LG-003579	13W06	BT-F430/2	13W06
DIN actuator with 4 independent relays	LG-003580	13W06	BT-F430/4	13W06
DIN actuator with 8 independent relays	LG-003517	all	BT-F430R8	all
DIN actuator with 2 0-10 V outputs	LG-003518	all	BT-F430V10	all
DIN actuator with 3 independent relays and 2 0-10 V outputs	LG-003519	all	BT-F430R3V10	all