

IR switch

HC/HD/HS4431N - L/N/NT4431N - A/AM/AG5751N

Description

The passive infrared switch can be used to automatically switch on devices when people pass by (for example, the light switches on without operating the switch or button). Suitable for all types of loads, including LED lamps. In order to optimise performance, it is possible to adjust the device activation threshold depending on the amount of natural light, and set a switch-off delay after the last movement detected. The operating range may be increased by installing several devices in different positions, with parallel outputs. The volume coverage is ensured by 3 levels of A, B and C rays, tilted at +2, -6 and -30 degrees in relation to the installation axis, and extends for 4 metres.

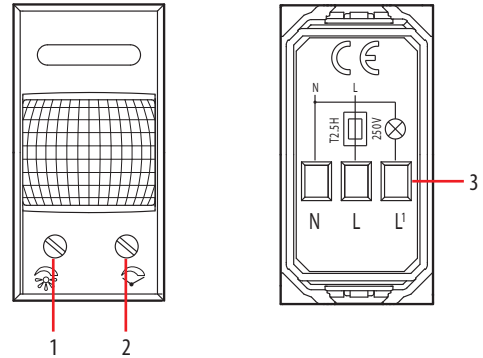

Technical data

Power supply: 230 Vac ± 10% 50 Hz
 Switching-on time adjustment: from 30 seconds - 10 minutes
 Twilight adjustment: from 5 lux to excluded
 Working temperature: 5 – 40 °C

Legend

1. Twilight adjustment
2. Switching off delay adjustment
3. Connection clamps

Dimensional data

1 flush-mounted module

Controllable loads

	Incandescence lamps Halogen lamps	Compact fluorescent lamps LED lamps	Linear fluorescent lamps	Electronic transformers	Reducer motors for rolling shutters
230 Vac	2 A 460 W	0,5 A 50 W	2 A 460 W	2 A 460 W	2 A 230 W cosφ=0,5

Coverage field

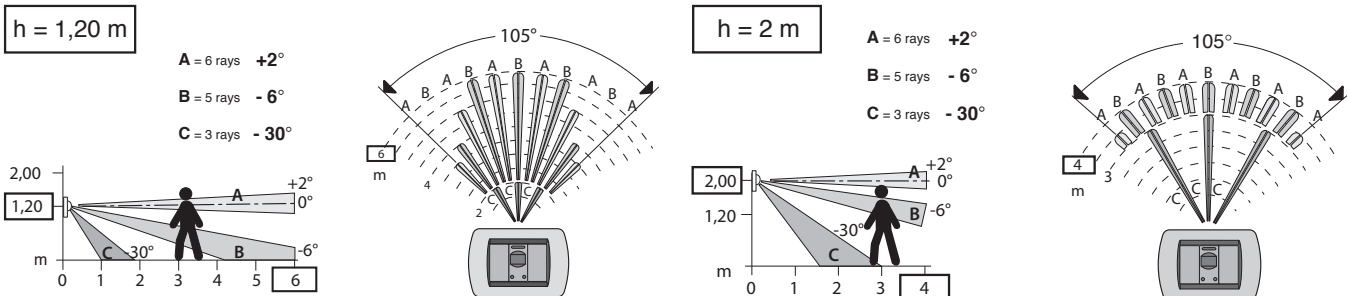

Wiring diagram

Basic diagram

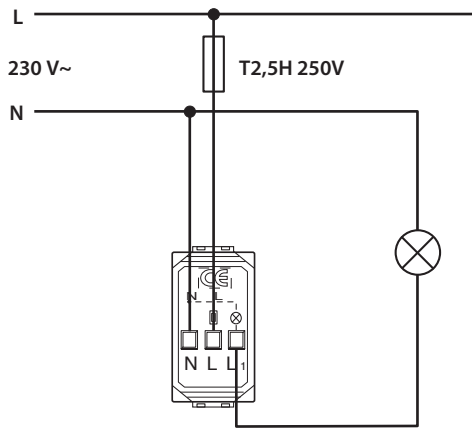

Wiring diagram in parallel

