

CONTENTS	Page
1. Description	1
2. Installation.....	2
3. Operation.....	3
4. Connection	11
5. Maintenance.....	12
6. Compliance and approvals	14
7. Equipment and accessories.....	14

1. DESCRIPTION

Background/emergency evacuation spotlight units IP 65 - IK 07 - Class II

Cat. No.	Flux/Battery life	Mode	NM pwr cons. (W)	Batteries	Product weight (kg)
6 604 62	1500 lm/1 hr	NM	0.9	LiFePO4	2.12
6 604 63	2500 lm/1 hr	NM	0.9	LiFePO4	2.38
6 604 65	1500 lm/2 hr	NM	0.9	LiFePO4	2.38
6 624 63	1500 lm/1 hr	NM	0.9	LiFePO4	2.38

• Dimensions

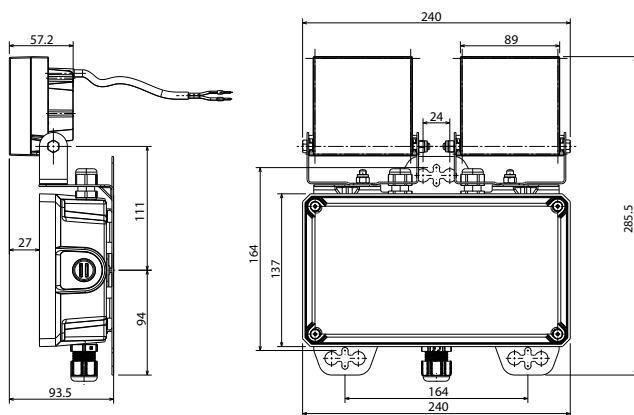

Product volume: 6.4 dm³

• Technical characteristics

Product for surface mounting on walls or ceilings
 LED spotlight units
 Fitted with 1x2.5 mm² automatic connection terminals
 Remote control input terminals protected against connection errors
 Power supply: 230 V± - 50/60 Hz
 Operating temperature: 0°C to +35°C
 Built-in remote control function allows it to be set to rest mode from the electrical panel if the lighting circuit is switched off intentionally.

• Materials

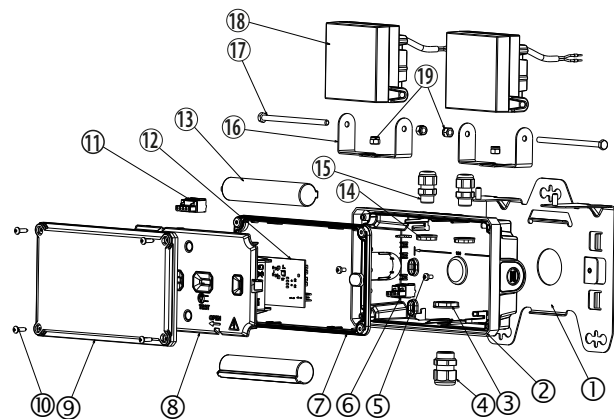

- ① Metal plate
- ② Weatherproof box: Black polycarbonate, self-extinguishing 850°C 30 s
- ③ PG13.5 cable gland locknut, black
- ④ Cable gland: polyamide self-extinguishing 850°C 30 s
- ⑤ M4x8 screw
- ⑥ Connector
- ⑦ Transparent seal: UV SEBS
- ⑧ Reflector: black polycarbonate, self-extinguishing 850°C 30 s
- ⑨ Diffuser: transparent polycarbonate, self-extinguishing 850°C 30 s
- ⑩ Pozidrive screw
- ⑪ Connector
- ⑫ Circuit board
- ⑬ Battery
- ⑭ PG9 cable gland locknut, black
- ⑮ Cable gland: polyamide self-extinguishing 850°C 30 s
- ⑯ Metal clamp
- ⑰ M6 x 110 screw
- ⑱ Spotlight

1. DESCRIPTION (CONTINUED)

• **Technical characteristics (continued)**

All plastic parts weighing more than 50 g are marked with their material type so that the materials can be recycled at the product's end of life.

• **Calorific value**

Thermal load of the plastic components of the casing:
16.6 MJ.

2. INSTALLATION

1

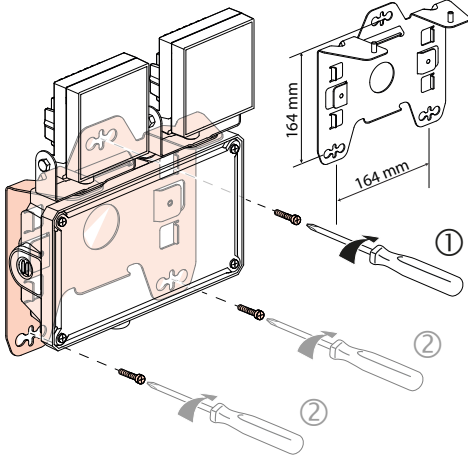

2

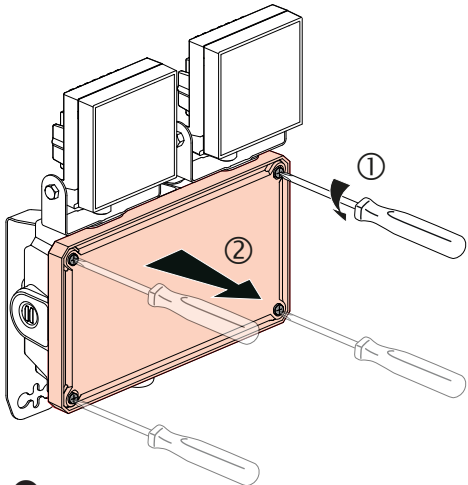

3

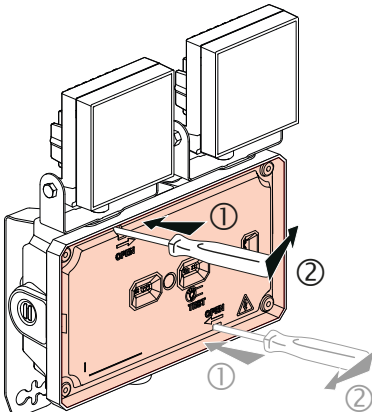

2. INSTALLATION (CONTINUED)

4

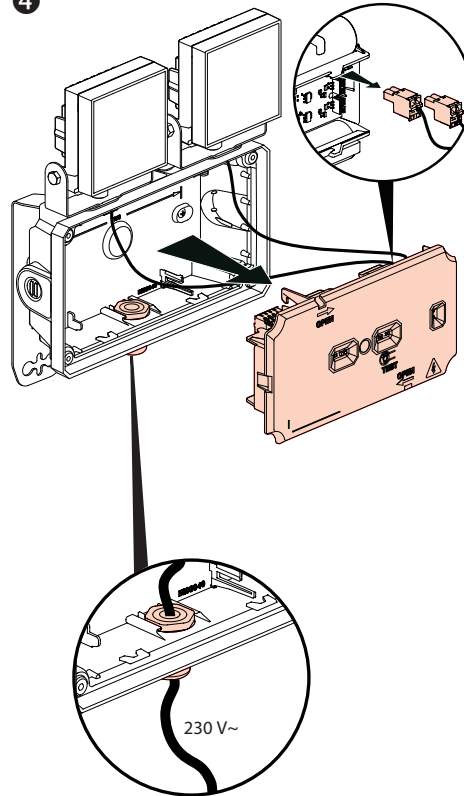

• **Connection**

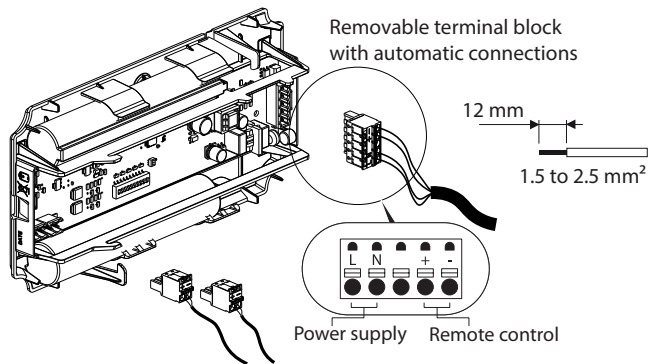

• **Ensuring the IP protection**

To ensure IP 65 protection, it is essential to use the cable gland and nut provided for the cable entry and to attach the diffuser using the 4 fixing screws provided.

As soon as installation is complete, attach a maintenance label Cat. No. 0 609 00 and write the commissioning date on it.

• **Ensuring the IK protection**

To ensure IK 07 protection, it is essential to fix the diffuser using the 4 fixing screws provided.

To ensure IK10 protection, add the protective grille Cat. No. 0 626 83 (see section 7 "Equipment and accessories").

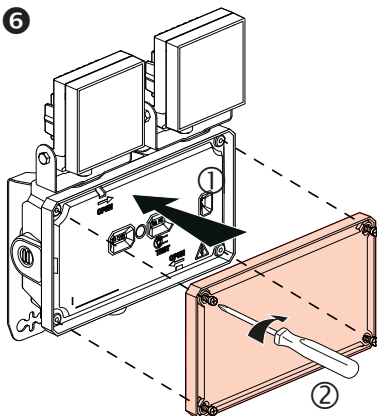
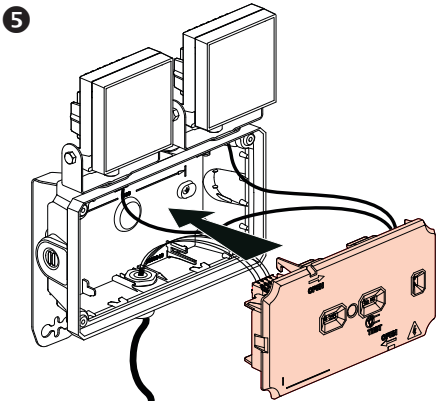
2. INSTALLATION (CONTINUED)**3. OPERATION****Self-testing mode**

These spotlight units are factory-set to Self-testing mode, and are therefore ready for use straight out of the box, without any additional setup.

Addressable mode (Cat. No. 6 624 63)

This product can be addressed using the configuration tool Cat. No. 0 882 40. It is then possible to control it remotely using the central control panel Cat. No. 0 626 00 (for more detailed information, see the addressable self-contained emergency lighting units installation manual available in the Legrand e-catalogue).

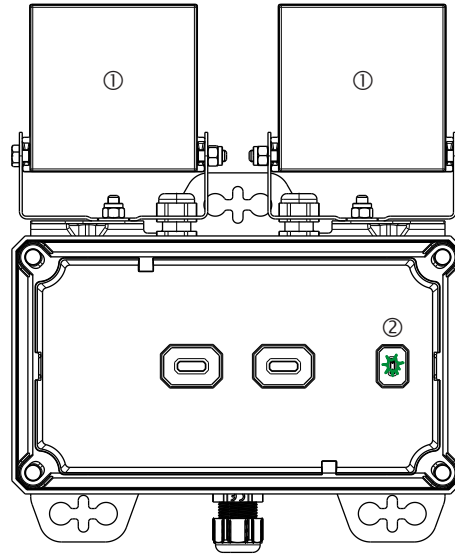
3. OPERATION (CONTINUED)**▪ 3.1 Switch-on/standby state**

The spotlights are off ①

The green unit status LED comes on (flashing while the batteries are charging: 28 hours max.) ②

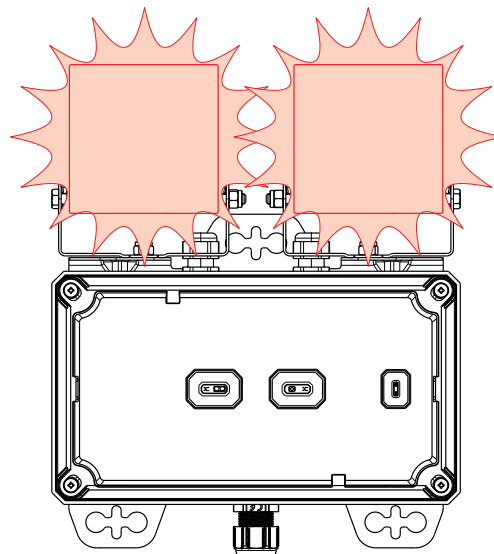
▪ 3.2 Mains supply break/emergency operation

The spotlights come on at the declared flux

The green unit status LED goes off

▪ 3.3 Setting to rest mode using remote controls 0 039 00/01 & 0 626 00 (Cat. No. 6 624 63)**After the normal lighting is switched off intentionally:**

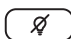
Pressing the Off  button sets the luminaire to rest mode to prevent the battery discharging.

Normal lighting switched back on:

The unit automatically returns to standby.

3. OPERATION (CONTINUED)

3.4 Automatic checking of the unit status

This unit automatically checks its operating status.







Once a week:

Switches to emergency state and tests the light source for 15 s.

Once every three months:

Switches to emergency state and tests the light source and the battery standby power time.

3.4.1 Result of the automatic checks

LEDs	Luminaire OK	Battery fault	Electronic/light source fault
Green	 (steady or flashing)		
Yellow		 (steady)	 (rapid flashing)

The day of the test is set at the time the unit is first switched on. The day of the test is chosen randomly in order to ensure that a minimum number of units is tested at the same time.

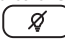
The time at which all the units are tested can be changed to the required time by simultaneously pressing the On  and Off  buttons on the remote control.

3.4.2 Stopping a test in progress

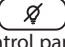
If a battery life test hinders operation, it can be stopped immediately. Press the Off  button on the remote control Cat. No. 0 039 00/01 or central control panel 0 626 00 (Cat. No. 6 624 63). The test is stopped and postponed until the following day.

3.4.3 Special cases

When the unit has been switched off for more than 3 days, the tests are no longer carried out. The test cycle will resume after the unit is switched back on and the batteries have been recharged. The tests planned for the day the unit is switched back on are automatically postponed for 24 hours.

3.6 Addressing the units (Cat. No. 6 624 63)

Infrared configuration tool Cat. No. 0 882 40 with the Legrand Close Up app is used to view and modify the emergency lighting unit parameters.

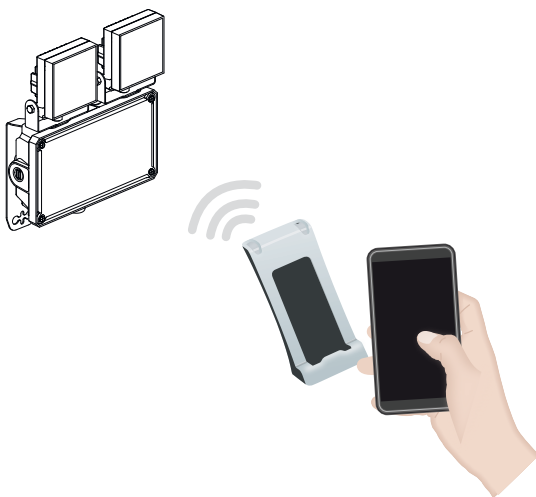

 The screenshots change as and when the Close Up app is updated.

When you open the app, if you don't have a Legrand account, you will need to create one. You will also need to create a project.

3.5 Checking the spotlights

3.5.1 Checking the connection

The spotlight operation and connection can be checked by pressing the "Test" button on the front.

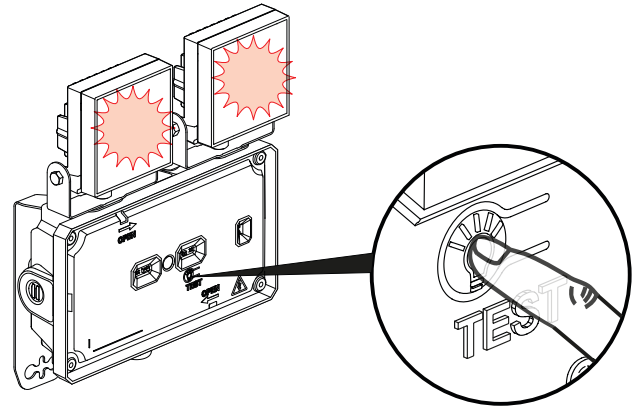

3.5.2 Spotlight orientation

The "Test" button can also be used to turn the spotlight light beam towards the installation without needing to power up the unit.

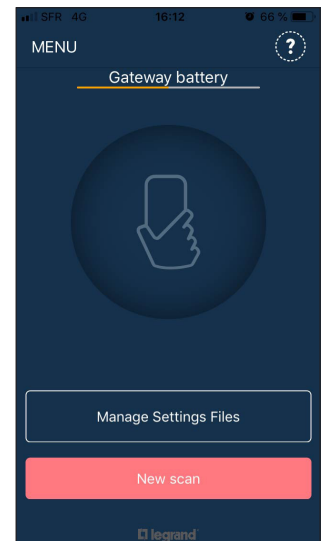
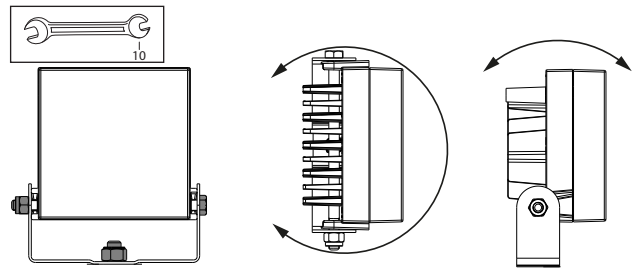

3. OPERATION (continued)

3.6 Addressing the units (Cat. No. 6 624 63) (continued)

3.6.1 Addressing the units directly

With the tool and the Legrand Close Up app, if the user chooses not to interrogate the unit first, addressing can be done by selecting "Addressing the units directly".

To access unit addressing, follow the steps detailed below:

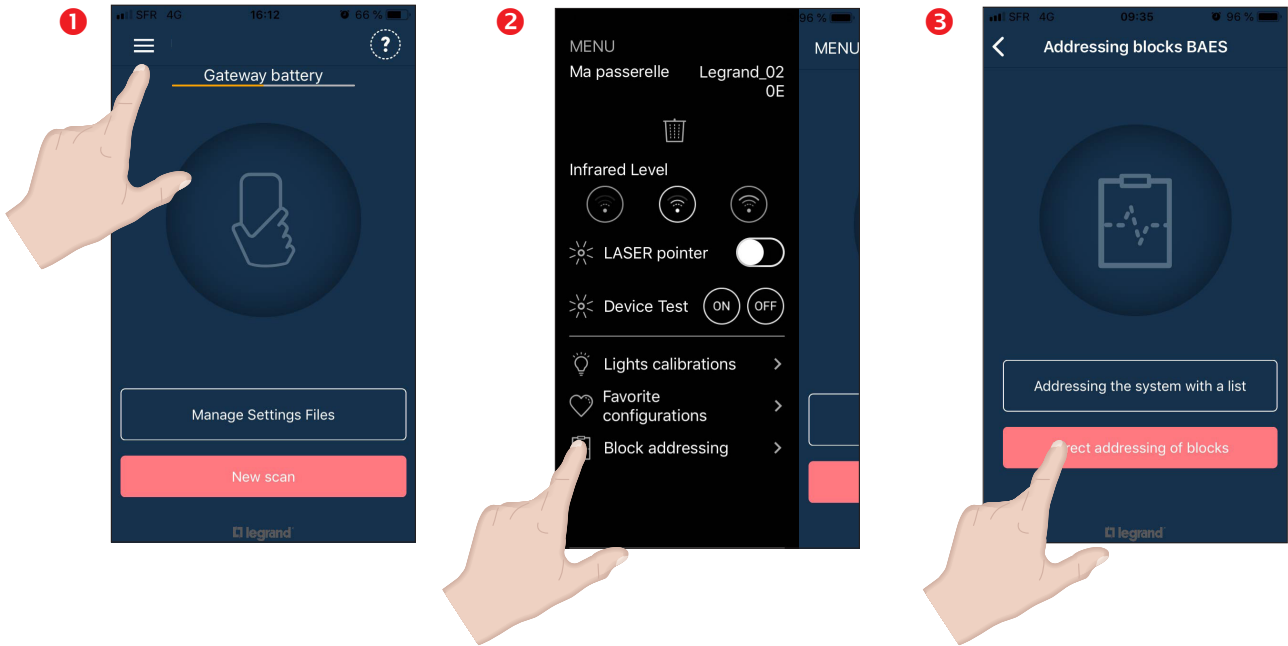

On the home screen click .

Click "Block addressing".

Click "Direct addressing of blocks".

Assigning an address

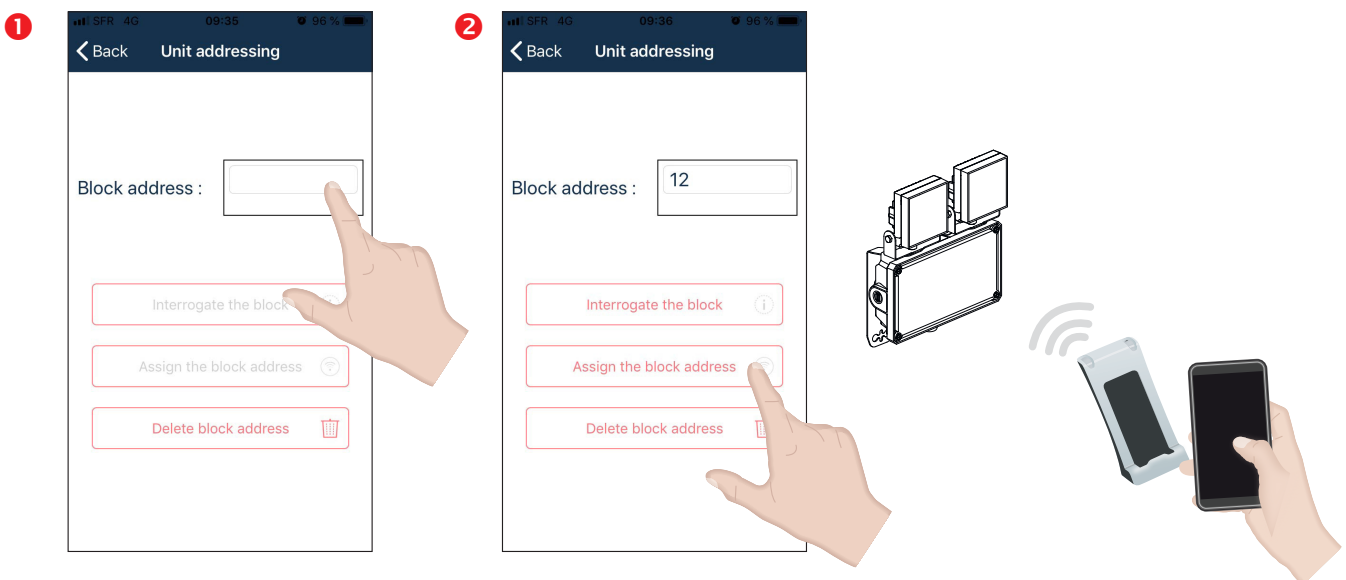

Aim the configuration tool at the unit to confirm this action.

Assign an address number, then complete the action with "Assign the block address".

3. OPERATION (continued)

■ **3.6 Addressing the units (Cat. No. 6 624 63) (continued)**

3.6.1 Addressing the units directly (continued)

Deleting an address

To delete the unit address, simply click "Delete block address".

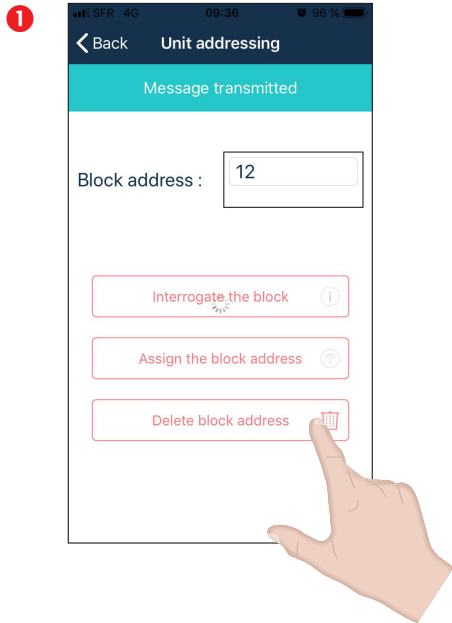

Checking the unit address

After interrogating the unit (see Viewing information section), it can be addressed by performing the steps below.

Note: Address 1023 corresponds to the standard self-testing function (unit not addressed).

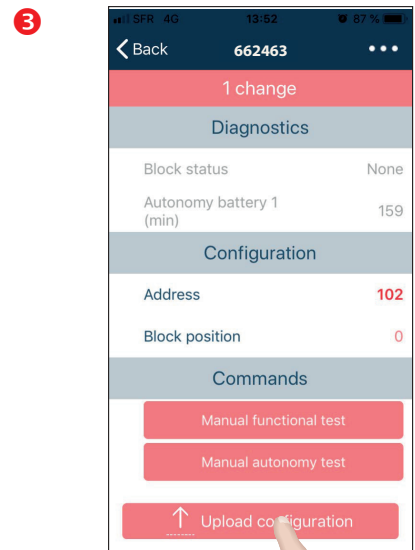
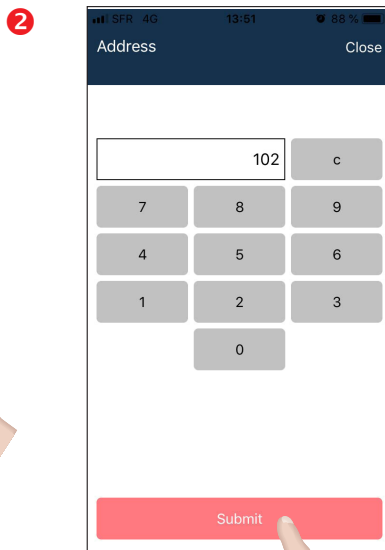
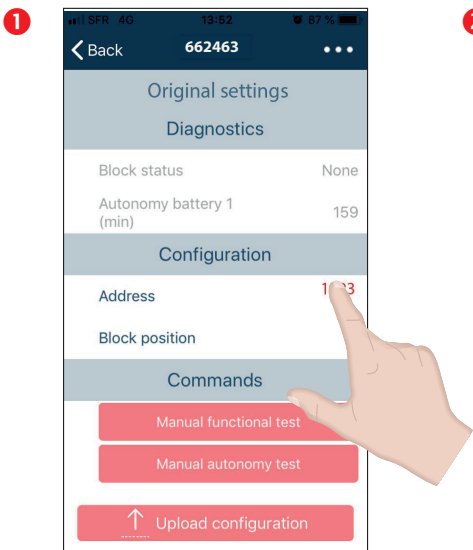

To assign an address to the unit, click to the right of "Address".

In this step you enter the number you wish to assign to the unit address, then confirm.

Next, save this change by clicking "Upload configuration".

3. OPERATION (continued)

3.6 Addressing the units (Cat. No. 6 624 63) (continued)

3.6.1 Addressing the units directly (continued)

Checking the unit address (continued)

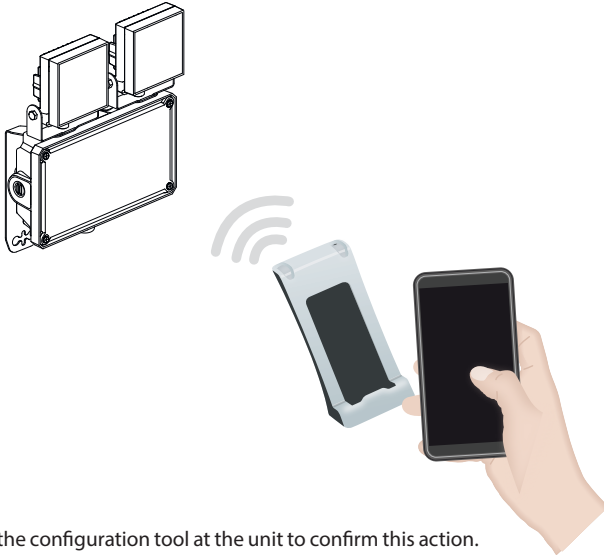

Aim the configuration tool at the unit to confirm this action.

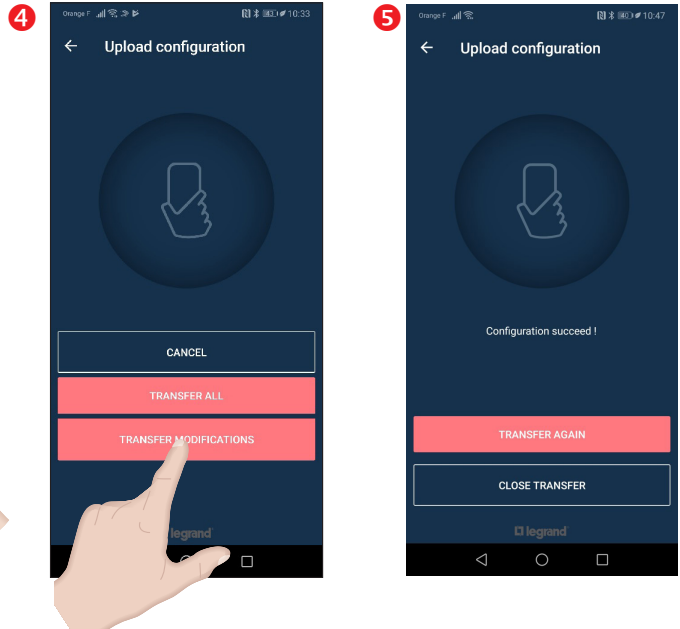

3.6.2 Addressing the system using a list

After clicking "Addressing the system with a list" there are 2 options:

- Resume addressing
- or
- Upload interface addressing

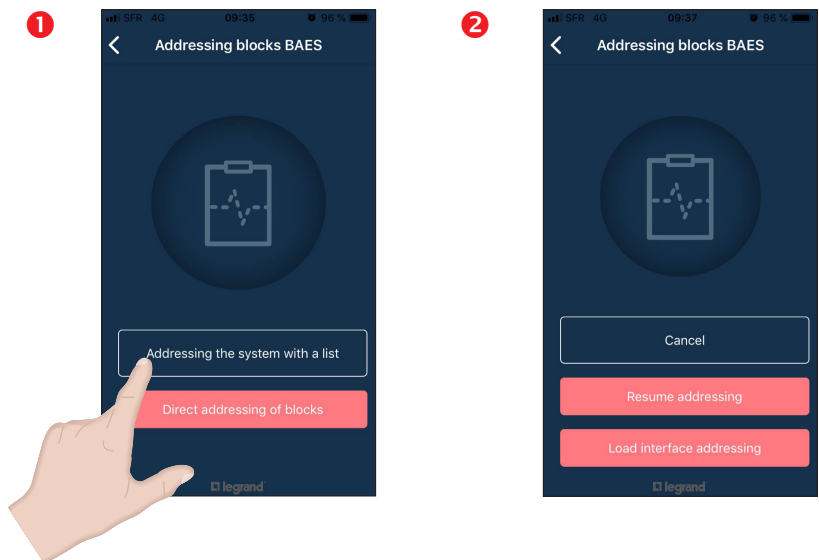

After clicking "Upload interface addressing" you need to attach the .csv file for the relevant interface. For more information about creating the .csv file, see the addressable self-contained emergency lighting units installation manual.

3. OPERATION (continued)

3.6 Addressing the units (Cat. No. 6 624 63) (continued)

3.6.2 Addressing the system using a list (continued)

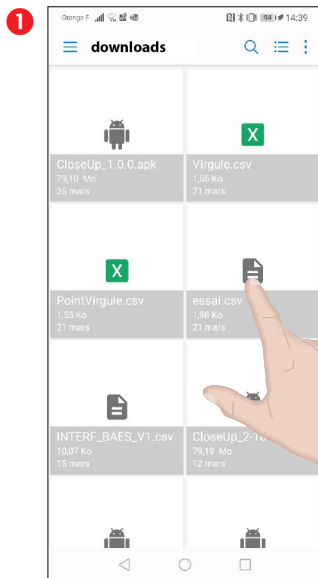

Select the file.

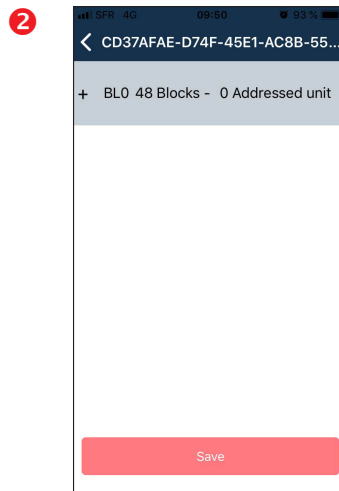

The file is imported and the content can be accessed by clicking on +

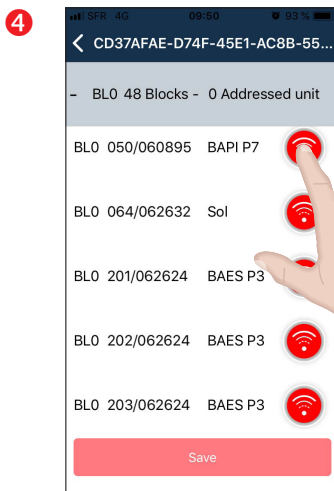
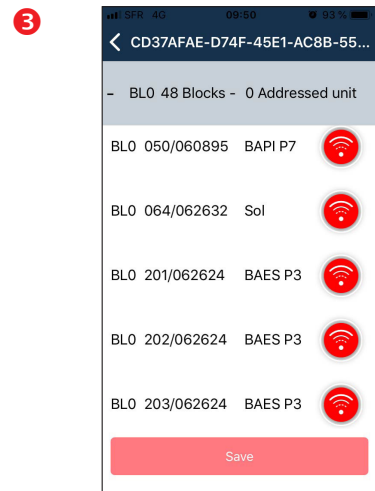

To address the units, click on the icon

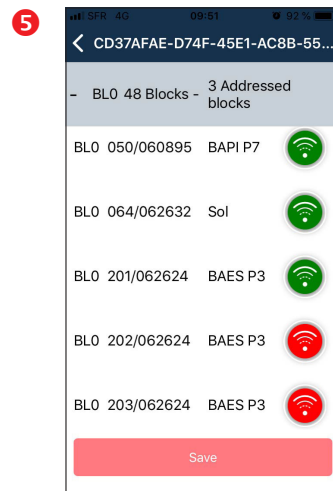

The icon for the unit concerned turns green if it has been addressed correctly.

3. OPERATION (continued)

■ **3.6 Addressing the units (Cat. No. 6 624 63)** (continued)

3.6.2 Addressing the system using a list (continued)

⚠ If the unit doesn't respond or hasn't received the addressing information, the following message appears:

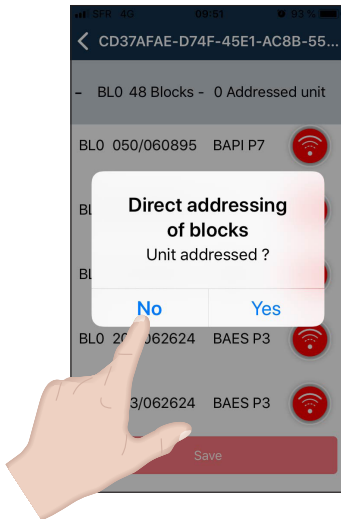

Click **"No"**, then try again.

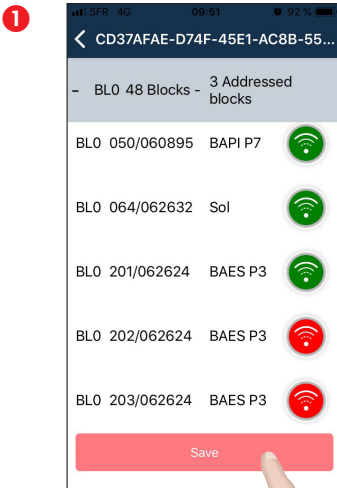

Then save this file listing the addressed units: click **"Save"**.

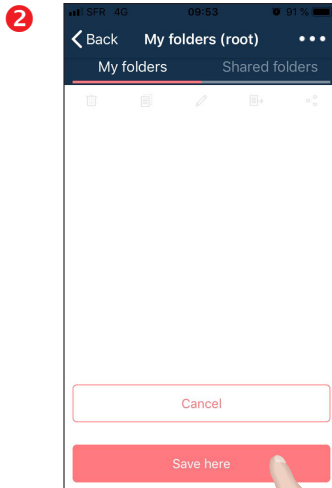

Then click **"Save here"** and give a name to this file listing the addressed units, then **"Save"**.

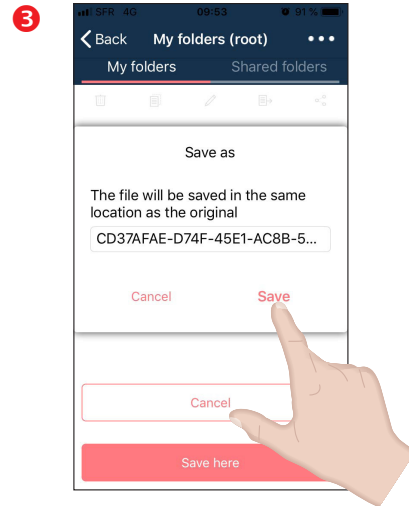

3. OPERATION (continued)

■ **3.6 Addressing the units (Cat. No. 6 624 63)** (continued)

3.6.2 Addressing the system using a list (continued)

Click "Resume addressing" to continue addressing and view which units have already been saved.

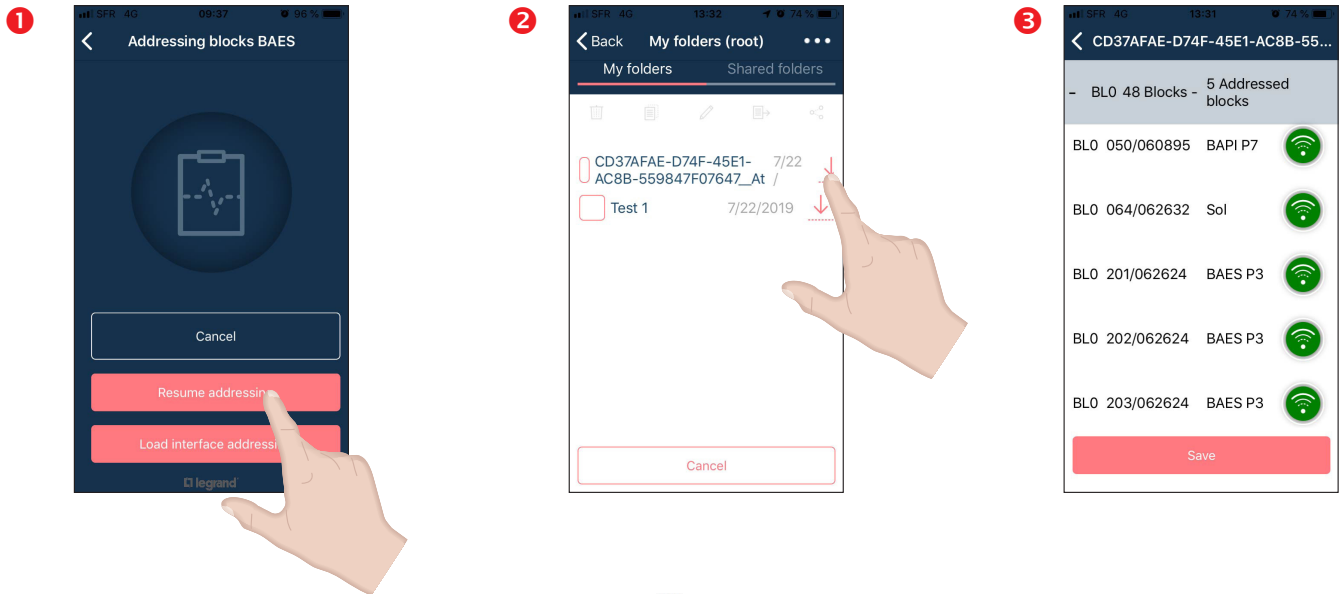

Select the ↓ icon and you can then work on the relevant interface file by repeating the steps described earlier.

Deleting a unit address from an interface

From the screen displaying the interface details, it is possible to delete the addresses of units with green dots.

Press the 📶 icon and the dot next to the unit concerned turns back to red.

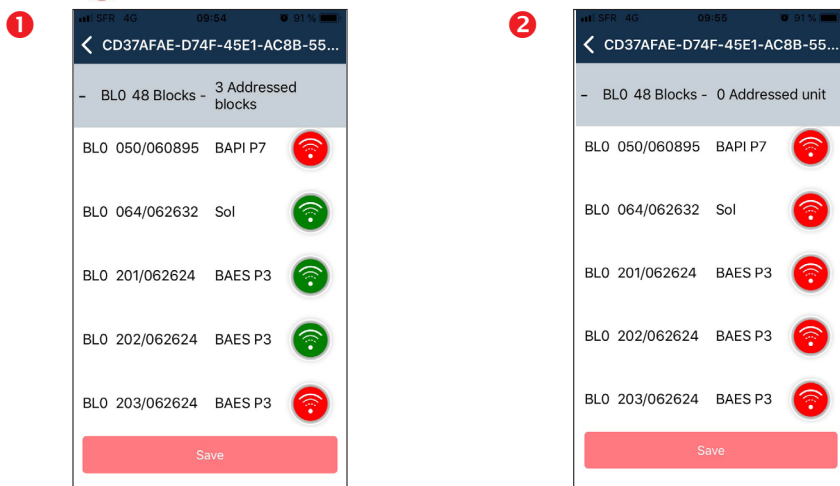

4. CONNECTION

4.1 Connecting the units to the mains

The branch can be joined in the electrical cabinet, on the switch or in a junction box.
The rules concerning the power supply are the same for emergency lighting as for any other type of luminaire.

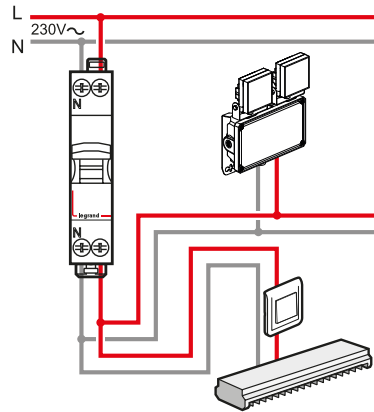

4.2 Operation with remote control unit

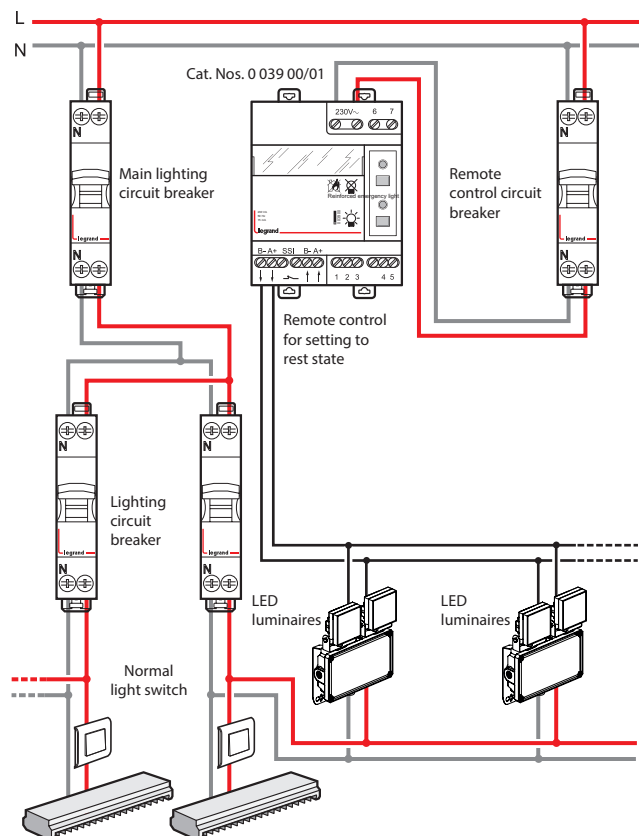

Note:

In the event of interference on the remote control line or unwanted switching on of the self-contained emergency lighting units: add a 1K Ohm resistor between the A+ and B- terminals on remote control 0 039 00/01 (this resistor is supplied with the remote control).

5. MAINTENANCE

5.2 Replacing the batteries (continued)

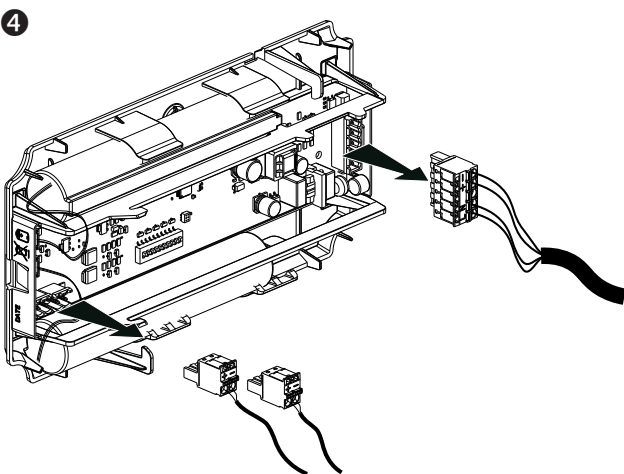
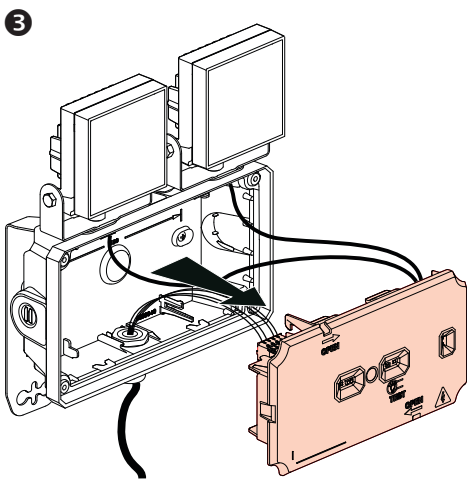
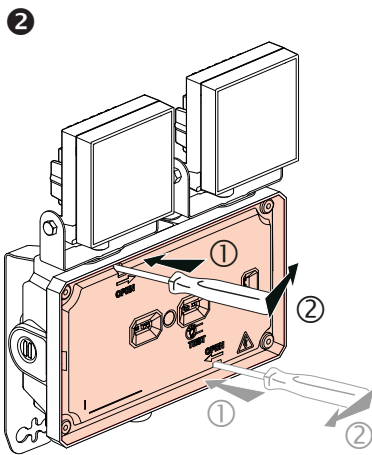

5.2 Replacing the batteries (continued)

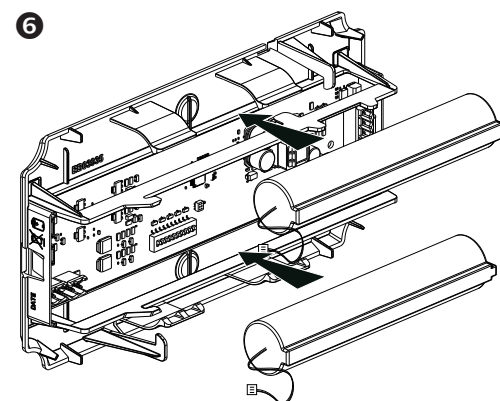
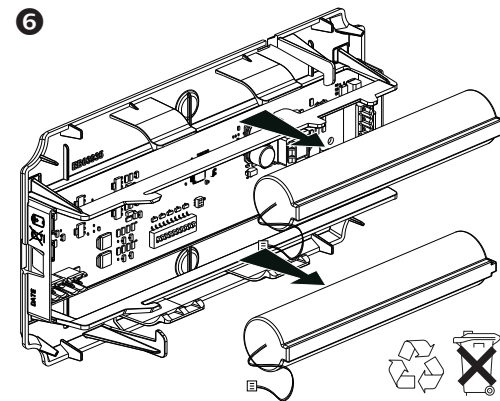
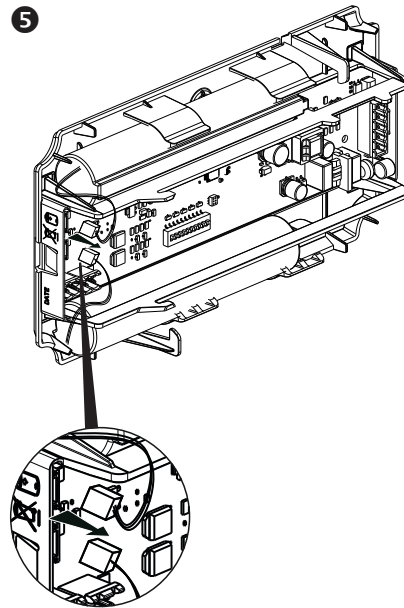

5. MAINTENANCE (CONTINUED)

▪ **5.2 Replacing the batteries (continued)**

6

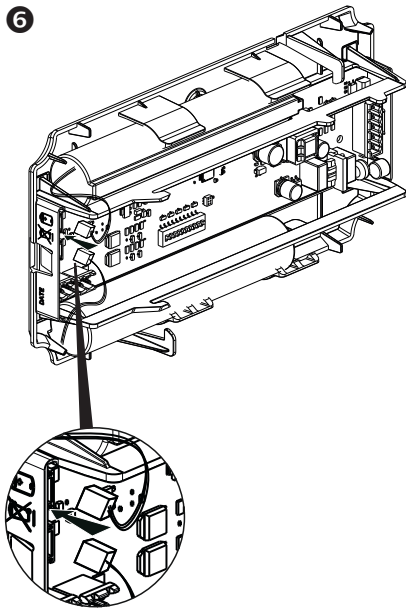

The batteries must be replaced when the self-contained unit can no longer provide its rated operating time (yellow LED on continuously).

Important: The product must be powered off before dismantling.

Legrand distribution partners take back used lighting units and batteries. When the batteries have been changed, replace the maintenance label, marking on it the date on which the unit was returned to service.

6. COMPLIANCE AND APPROVALS

EN IEC 60598-2-22: 2022: European standard "Luminaires: Particular requirements. Luminaires for emergency lighting"

EN 60598-1 2015 + A1 2018: European standard "Luminaires".

EN IEC 62034: European standard "Automatic test systems for battery-powered emergency escape lighting".

Products certified with the AENOR N mark

Directives

- LV directive 2014/35/EU of 26/02/2014 and 2011/65/EU of 08/06/2011 amended by 2015/863 of 31/03/2015 (ROHS 2)

- EMC directive 2014/30/EU of 26/02/2014

7. EQUIPMENT AND ACCESSORIES

▪ **7.1 Standard protective grille Cat. No. 0 626 83**

Impact resistance: IK 10 - 20 joules
Fixes over 4 holes on all sides

