

## MDC-MDC and MDC-LC Fiber Patch Cords

Cat. No(s) : 132081/82/83/84/85/86/87/88/89  
132090/91/92 - On-demand

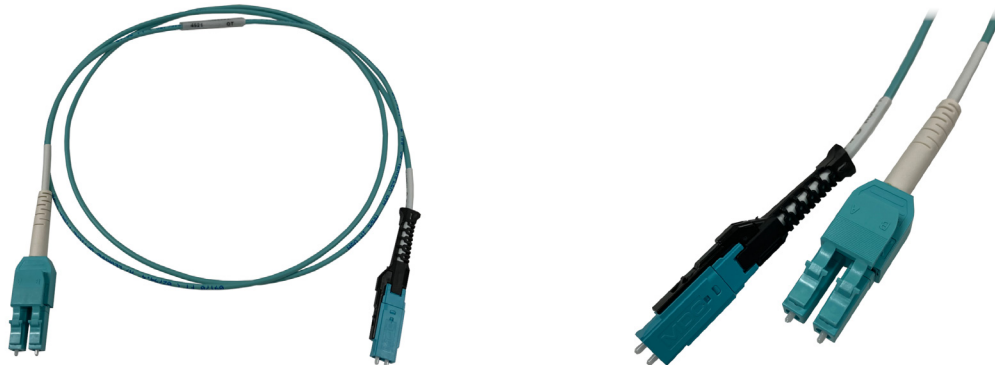

### 1. DESCRIPTION :

Pre-Configure MDC-MDC and MDC-LC Fiber Patch Cords are built to exceed industry standards for quality, performance, insertion and return loss. Available in two performance tiers Ultra (multimode) and Core (Single-mode and Multimode). The most common configurations are setup for easy selection and purchase.

#### Single-mode optical patchcords

Cat. Nos.	Designation	Length
132083	Patchcord MDC/LC OS2 G657A1 CORE LSZH (A to A)	1m
On-demand		1 to 50m
132088	Patchcord MDC/MDC OS2 G657A1 CORE LSZH (A to A)	1m
132089		2m
132090		3m
132091		5m
On-demand		1 to 50m

#### Multimode optical patchcords

Cat. Nos.	Designation	Length
132081	Patchcord LC/MDC OM4 CORE LSZH (A to A)	1m
On-demand		1 to 50m
132084	Patchcord MDC/MDC OM4 CORE LSZH (A to A)	1m
132085		2m
132086		3m
132087		5m
On-demand		1 to 50m
132082	Patchcord LC/MDC OM5 CORE LSZH (A to A)	1m
On-demand		1 to 50m
132092	Patchcord MDC/MDC OM5 CORE LSZH (A to A)	1m
On-demand		1 to 50m
On-demand	Patchcord MDC/MDC OR LC/MDC OM4 OR OM5 ULTRA LSZH (A to A)	1 to 50m

### 2. FEATURES/BENEFITS :

- Duplex connectors with uniboot configuration to save space into high density environment.
- Easy switchable to change the standard A to B configuration to a A to A configuration
- Fiber identification on each connectors.
- Conform to IEC, ANSI/TIA, and Telecordia performances requirements
- RoHS, REACH & SvHC compliant
- Available in standard and custom lengths
- 3D endface geometry (interferometry): sampling quality control.
- Optical performance: 100% factory tested
- VSFF (Very Small Form Factor) duplex MDC connector :
  - \* Individual connector access in the most extremely dense connector environments easily accomplished using push-pull boot technology.
  - \* It features 3 times more fiber cabling density over LC connectors.
  - \* Simple polarity reversal with no exposed fibers.

### 3. APPLICATIONS :

- Data centre
- Telecommunication networks
- FTTX
- LAN and WAN
- Broadband network

## 4. POLARITY SWITCHING :

### LC Connector

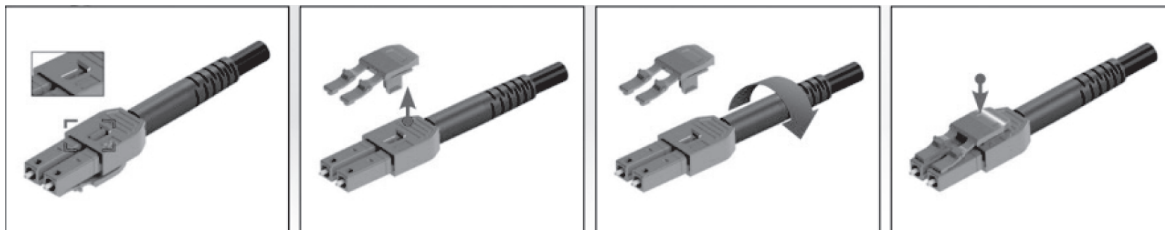

### MDC Connector

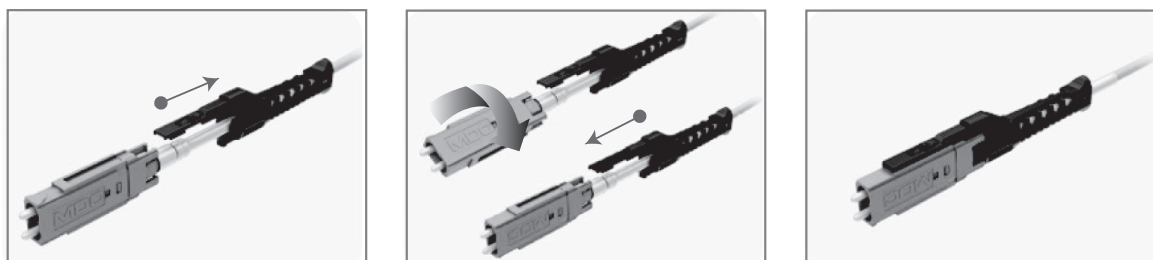

## 5. CONNECTORS AND FIBERS SPECIFICATIONS :

Fiber type	OS1a/OS2 G657A1	EC 60793-2-50 Category B-657.a1 and B-652.d
Measurement	Core Performance	Conformance
IL Max./Master	0.30 dB	IEC 61300-3-4
IL Typ./Master	0.10 dB	IEC 61300-3-4
IL Max./Random*	0.30 dB	IEC 61300-3-34
IL Typ./Random*	0.15 dB	IEC 61300-3-34
Return Loss	> 55 dB	IEC 61300-3-6

Fiber type	OM4 OM5		IEC 60793-2-10 type A1a.3 IEC 60793-2-10 type A1a.4
	Core Performance	Ultra Performance	Conformance
Measurement	Core Performance	Ultra Performance	Conformance
IL Max./Master	0.30 dB	0.15 dB	IEC 61300-3-4
IL Typ./Master	0.10 dB	0.10 dB	IEC 61300-3-4
IL Max./Random*	0.30 dB	0.15 dB	IEC 61300-3-34
IL Typ./Random*	0.15 dB	0.10 dB	IEC 61300-3-34
Return Loss	> 40 dB	> 40dB	IEC 61300-3-6

\* Performance is guaranteed only with other components of the same Legrand range (Core and Ultra). Mixing ranges or use of components of other brand may lead to a different performance of the system. The uncertainty value for field measurement with LSPM testing using a reference cord defined in ISO/IEC 14763-3 applies to field testing with proposed Legrand testing cords. Refer to the Fiber Optic Testing Guide for Legrand Solutions.

## 6. CONNECTORS MECHANICAL SPECIFICATIONS :

Mechanical properties		Conformance
Mechanical endurance	500 matings	IEC 61300-2-2
Vibration	10-55Hz, 0.75 amplitude	IEC 61300-2-1
Cable retention	Magnitude 50N	IEC 61300-2-4

\* The change in attenuation for all the above listed criteria is a maximum of 0,20 dB

Connector type	Conformance	Colors
LC	IEC 61754-20	OS2 : Blue OM4 : Aqua OM5 : Lime Boot : White
MDC	-	OS2 : Blue OM4 : Aqua OM5 : Lime Boot : Black

## 7. CABLE SPECIFICATION :

Characteristics	Units	Values
Cable Material		LSZH
Cable diameter	mm	2.0 ± 0.15
Cable colour		OS2 : Yellow OM4 : Aqua OM5 : Lime
Strength member		Aramids
Crush	N/100mm	500
Operating temperature	°C	- 5 to 50
Minimum bending radius	mm	10D (installed) 20D (loaded)