

# UTP/FTP/STP Category 6 patch module

Cat. No(s): 4 131 01/02/03

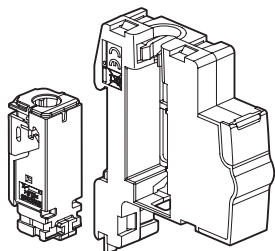

CONTENTS	Page
1. Presentation .....	1
2. Selection chart .....	1
3. Positioning .....	1
4. Technical characteristics .....	1
5. Dimensions .....	1
6. Typical RJ 45 connection .....	2
7. Compliance and approvals .....	2

## 1. PRESENTATION

Patch equipment for Grade 2 and 3 TV applications.  
Patch module fitted with a Cat. 6 LCS<sup>3</sup> RJ 45 connector with toolless connection certified PoE++ by an independent laboratory.  
Takes high-speed transmissions (Gbps).  
With a label-holder for marking the room in the dwelling.  
DIN rail mounting.

## 2. SELECTION CHART

Description	Cat. No.	No. of modules	Type	Weight (g)
Category 6 patch modules	4 131 01	1	UTP	36
	4 131 02	1	FTP	36
	4 131 03	1	STP	66

## 3. POSITIONING

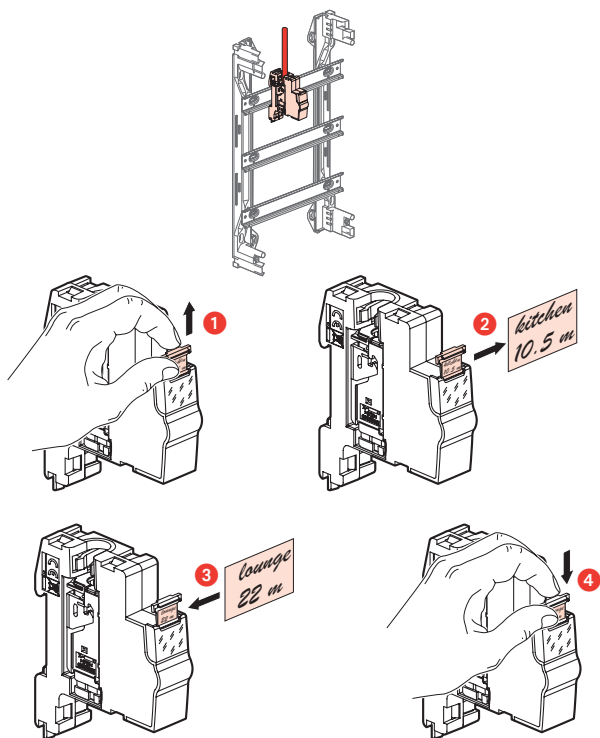

## 4. TECHNICAL CHARACTERISTICS

### 4.1 Material characteristics:

#### Module

Plastic casing: PC ral 7035

#### Connectors

- Contacts: gold/nickel, minimum gold thickness > 0.8 μm
- Metal parts: bronze, nickel, platinum, gold
- PBT polycarbonate

### 4.2 Electrical characteristics:

- Breakdown voltage: 1000 V
- Contact resistance: 20 mΩ
- Insulation resistance: 500 M at 100 VDC
- Compatible with "PoE" power supply up to 100 W (IEEE 802.3af, IEEE 802.3at, IEEE 802.3bt)

### 4.3 Mechanical characteristics:

#### Modules

- Tensile resistance on DIN rail: 100 N
- IP20 - IK04

#### Connectors

- Maximum number of connections and disconnections: 5 without replacing the wire
- Endurance: 2500 operations (plug-in/pull-out)
- IK03

### 4.4 Climate characteristics:

- Operating temperature: -10°C to +60°C
- Humidity: 5% to 85% (non-condensing)

## 5. DIMENSIONS

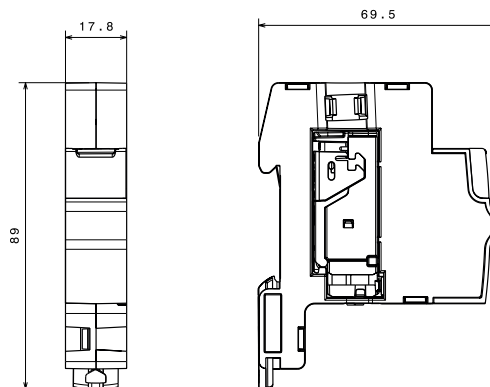

## 6. TYPICAL RJ 45 CONNECTION

TIA 568 A and B dual colour code:

- UTP (8 contacts)
- FTP/STP (9 contacts)

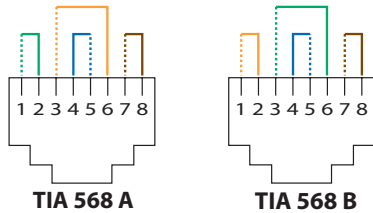

Colour code and contact number

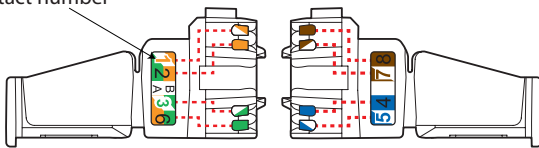

Identification number

- UTP: HD 51
- FTP: HD 52
- STP: HD 53

Colour code category:  
Cat. 6 blue

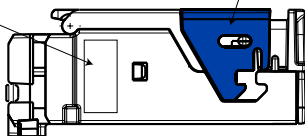

Permissible conductors:

- Single-core/Multicore: 0.4 to 0.65 mm, AWG 26 to 22
- Polyethylene conductor insulation: Ø 0.85 to 1.7 mm on insulation

Number of wires to be connected per connection:

RJ 45 connectors are equipped with a locking nut. They do not require a special tool and can be re-wired if a mistake is made.

This system makes it easy to spread pairs before fitting them onto the connector.

Spreading the cables and positioning the sleeve firmly in the spreader ensures that a pair-breakage distance of 13 mm is kept between pairs, as required by the standard.

Spreading pairs at 90° to the cable ensures the best possible performance.

## 7. COMPLIANCE AND APPROVALS

Conforming to standards:

- ISO/IEC 11801 Ed3.0
- IEC 60512-99-002
- ANSI/TIA 568.2-D

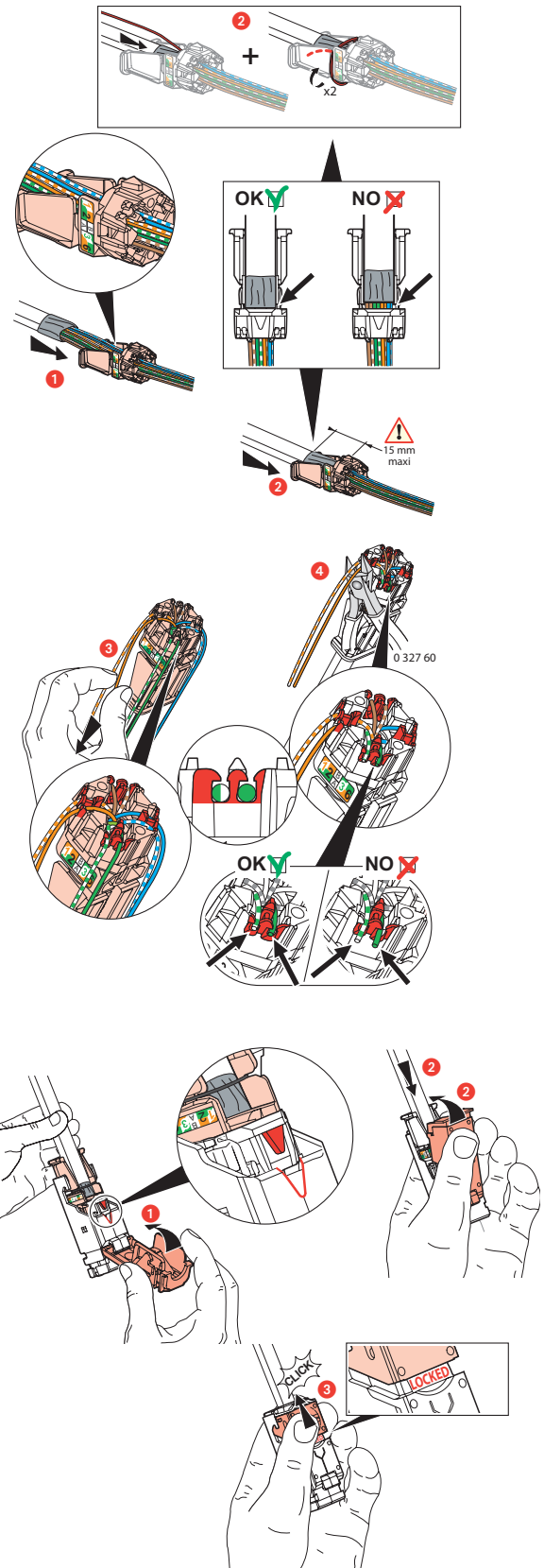

## 8. PERFORMANCE

### ■ Performance of permanent link with U/UTP cable

The red line represents the limit of the standard, the black line represents extension of the limit of the standard

Return loss

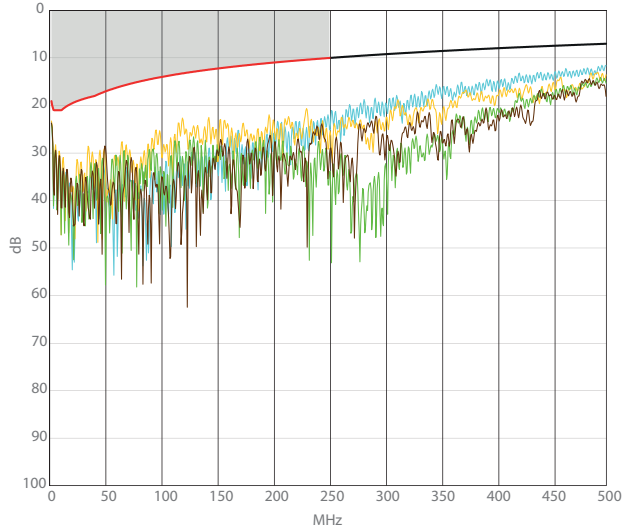

PS NEXT (Power Sum NEXT)

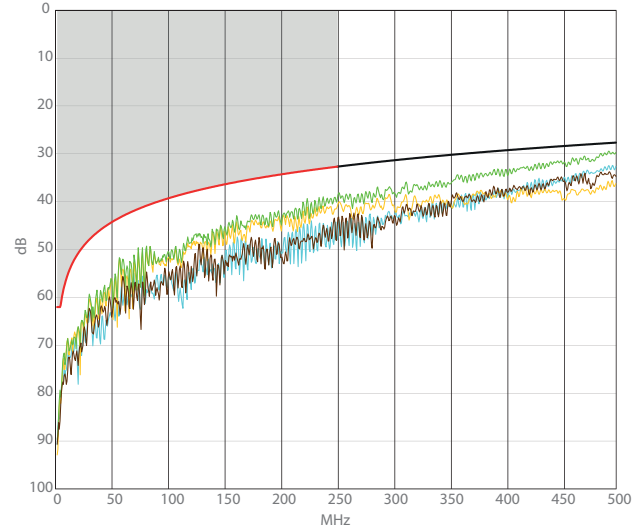

Attenuation

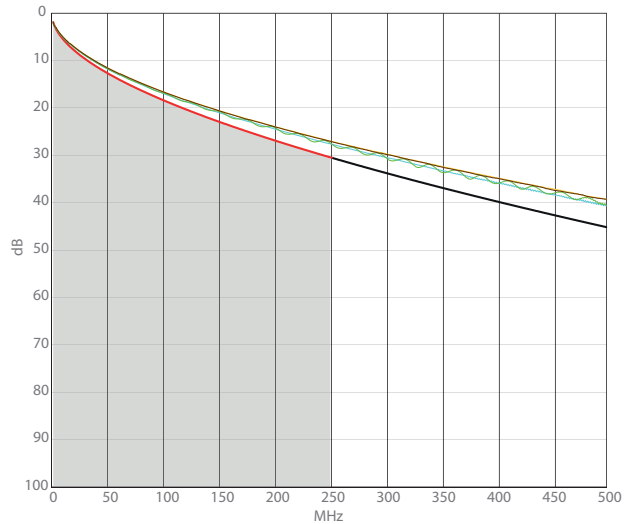

ACR (Attenuation to Crosstalk Ratio)

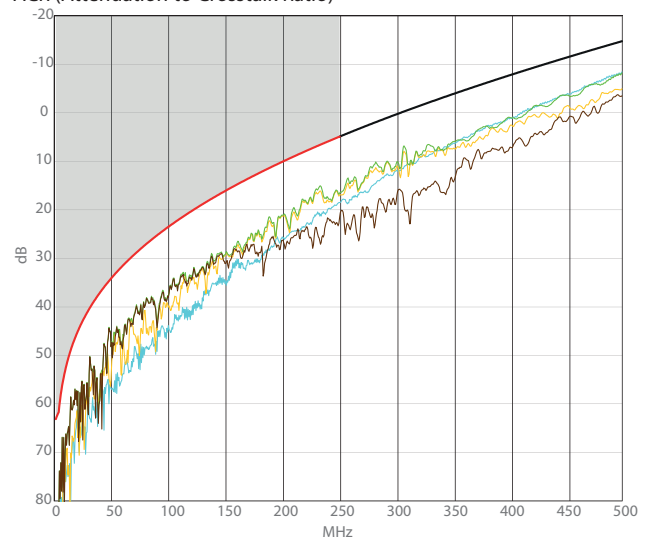

NEXT (Near End Crosstalk Attenuation)

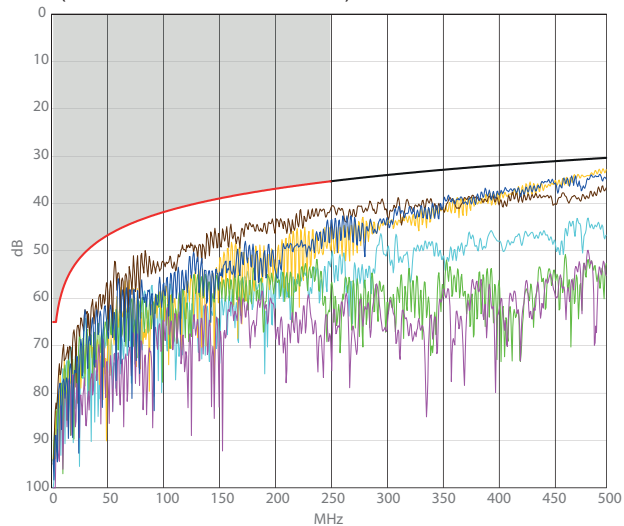

ELFEXT (Equal Level Far End Crosstalk Attenuation)

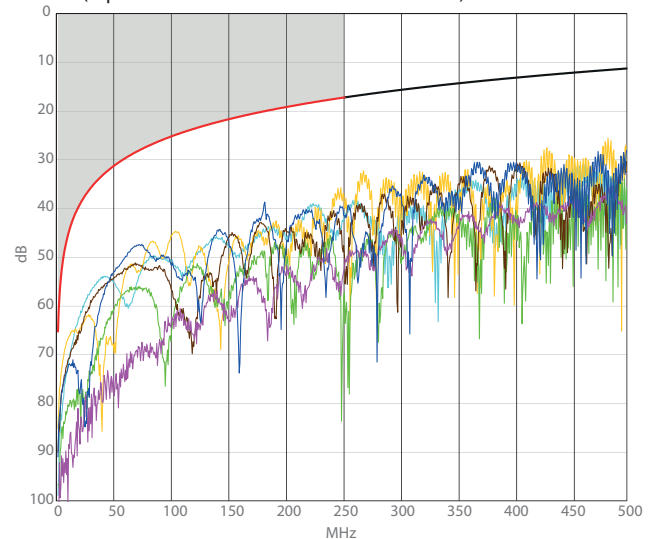

## ■ Performance of permanent link with F/UTP cable

Return loss

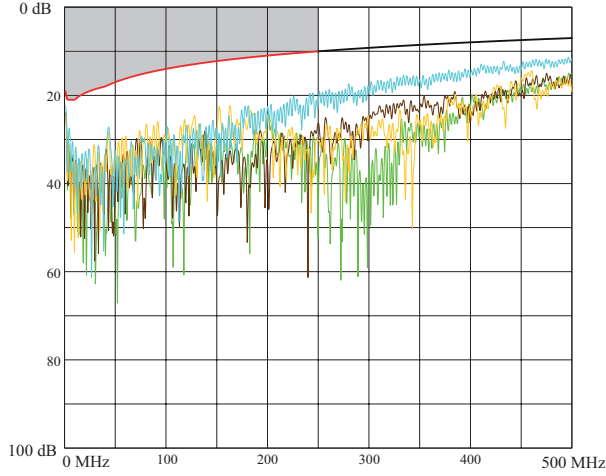

PS NEXT (Power Sum NEXT)

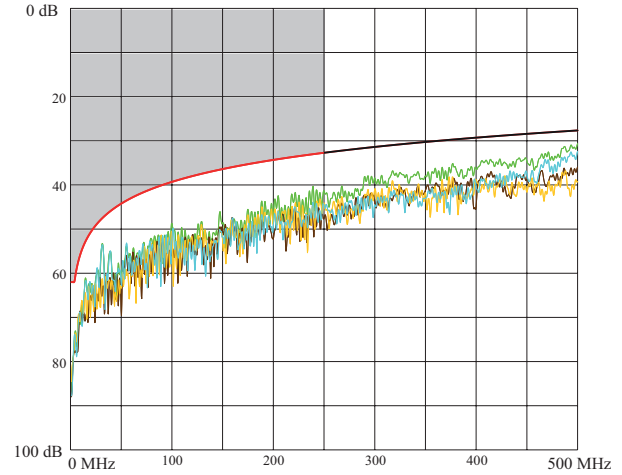

Attenuation

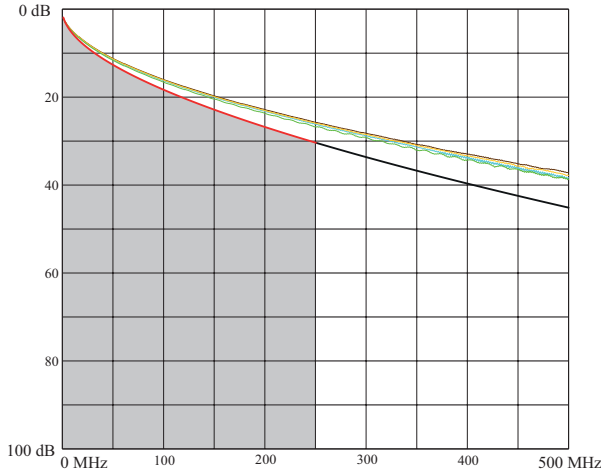

ACR (Attenuation to Crosstalk Ratio)

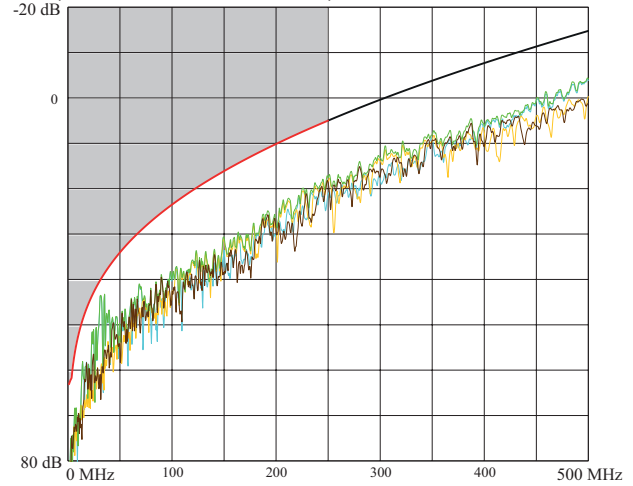

NEXT (Near End Crosstalk Attenuation)

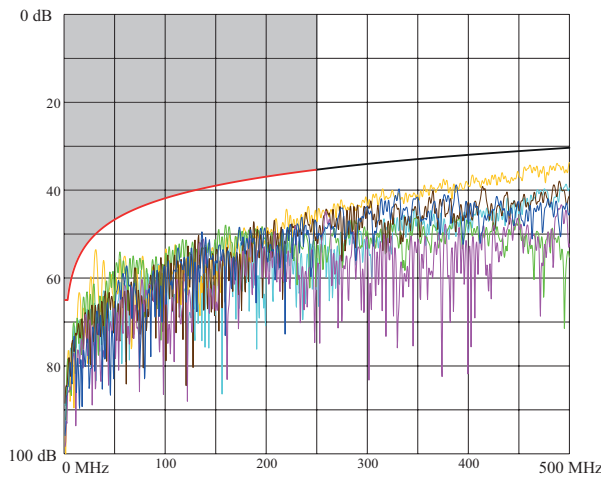

ELFEXT (Equal Level Far End Crosstalk Attenuation)

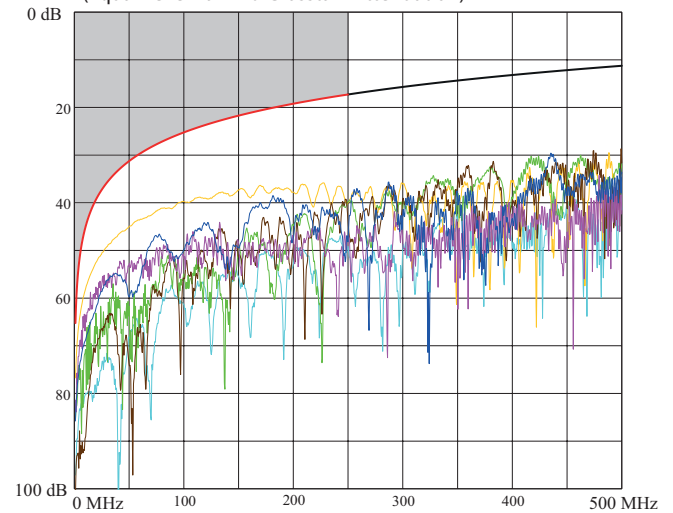

## ■ Performance of permanent link with SF/UTP cable

Return loss

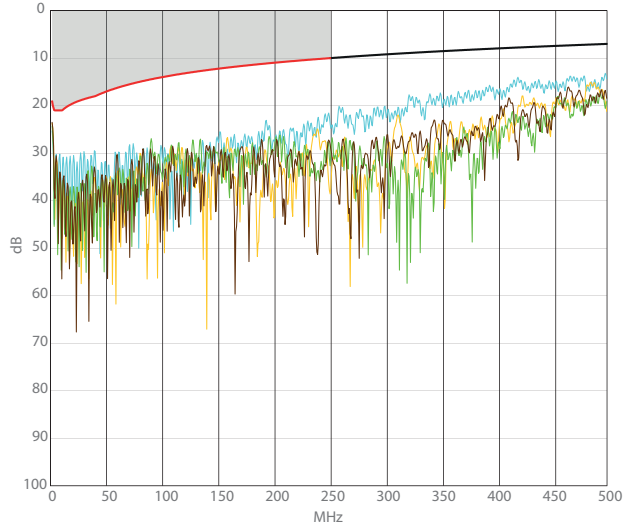

PS NEXT (Power Sum NEXT)

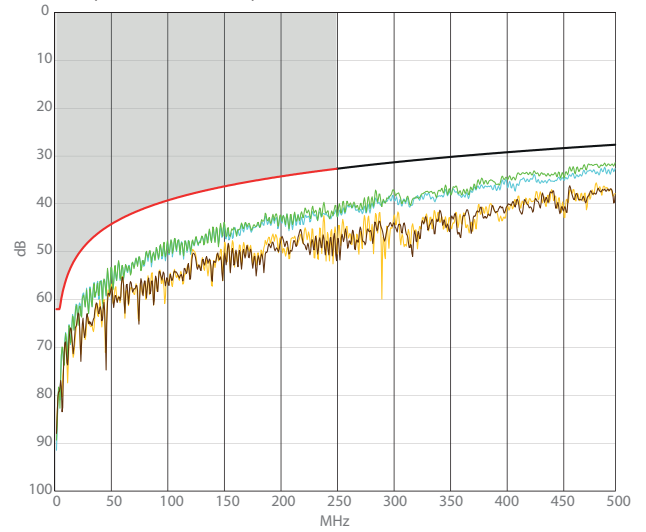

Attenuation

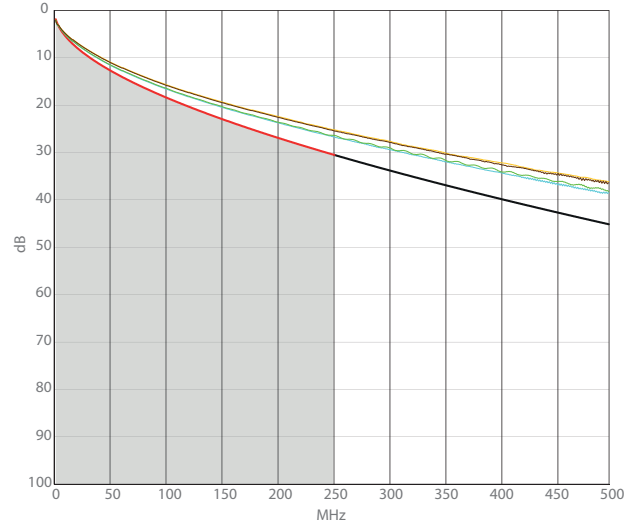

ACR (Attenuation to Crosstalk Ratio)

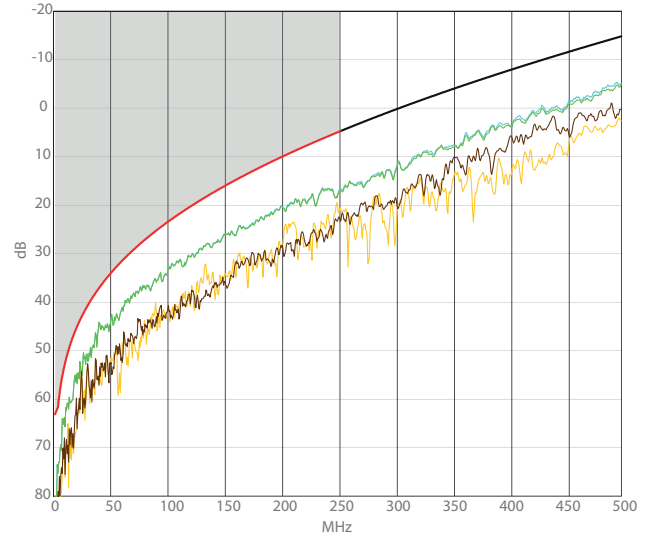

NEXT (Near End Crosstalk Attenuation)

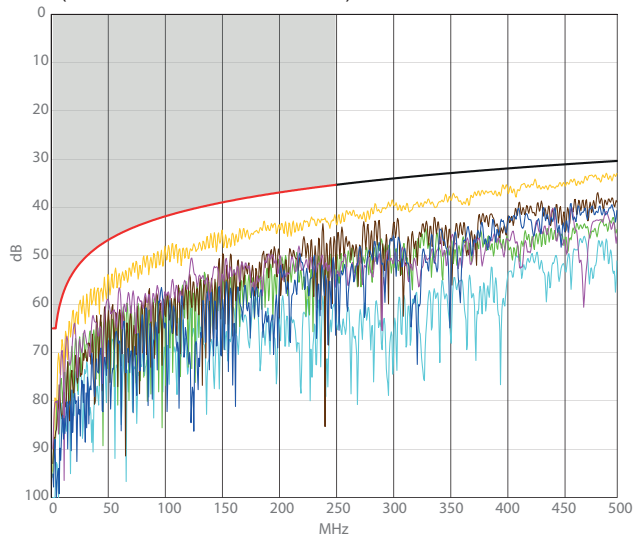

ELFEXT (Equal Level Far End Crosstalk Attenuation)

