

Technical Specifications

Power supply	: 230 V~ 50/60 Hz – 5 mA – Class II – IP20
Terminal capacity	: 2 × 1.5 mm ²
Mounting.....	: On  rail
Dimensions.....	: 4 modules (70 mm)
Output voltage.....	: SELV
Battery*	: 8.4 V Ni-MH technology – Ref. 0 610 99
Operating temperature.....	: Min./Max. (+10 °C to +45 °C)
Battery charging time:.....	: 24 hours

*For battery pack replacement, refer to the technical data sheet.

Safety instructions



This product should be installed in compliance with installation rules, preferably by a qualified electrician. Incorrect installation and/or incorrect use can lead to risk of electric shock or fire. Before carrying out the installation, read the instructions and take account of the product's specific mounting location.

Do not open up, dismantle, alter or modify the device except where specifically required to do so by the instructions. All **Legrand** products must be opened and repaired exclusively by personnel trained and approved by **Legrand**. Any unauthorised opening or repair completely cancels all liabilities and the rights to replacement and guarantees.

Use only **Legrand** brand accessories.

1. Wiring

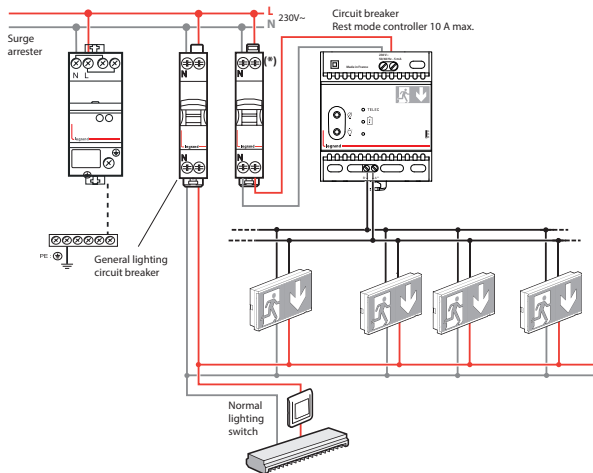

General power supply: 230 V~
Tightening torque: 0.6 Nm

Rest mode / emergency mode confirmation light indicator
=> Flashing Green

Rest mode activation (after mains interruption of emergency luminaires)

Emergency mode activation of emergency luminaires

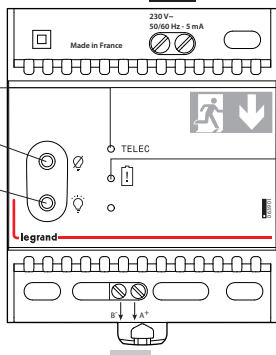

Battery fault red indicator

Output for emergency lighting luminaires (or for controller extension)

2. Features

• Emergency luminaires put into rest mode, after mains power interruption

1) After closing of the building : general lighting switched off

- A single press of the key  puts the emergency luminaires into rest mode

(After general lighting international power off)

- A single press of the key  activates the emergency mode.

These two commands are confirmed by the green LED. (TELEC).

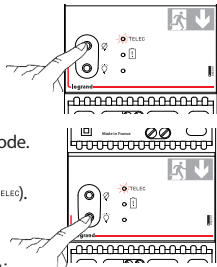



2) Reopening of the building : switching on the general lighting

- The emergency lights automatically return to standby mode.

• Check of emergency lights operation.

At any time, the 0 639 01 rest mode controller allows all emergency lights to be switched on in emergency mode in order to verify their proper operation, without switching off the general lighting.

- A single press of the button  activates the emergency mode of the emergency lights.

- A single press of the button  puts the emergency lights back into standby mode (end of the verification).

• Change in the time for all emergency.

In some cases, for operational reasons (movies theaters, entertainment halls, etc...), it's possible to select a specific test time for all the emergency lights in the building.

- At the new select time.

2. Features (continued)

• Adjustment of the test time for all emergency luminaires.

In some cases, for operational reasons (cinemas, performance halls, etc.), it is possible to select a specific test time for all the BAES units in the installation.

– At the new selected test time.

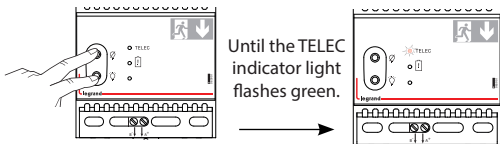

Note: The day of the tests will be set randomly for each emergency light, in order to ensure that only a minimum number of emergency lights luminaires are tested at the same time.

3. Continuity test (without discharging the emergency lighting units) Alternating green/yellow LED flashing.

