

632946

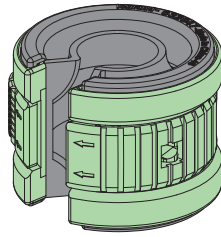

632947

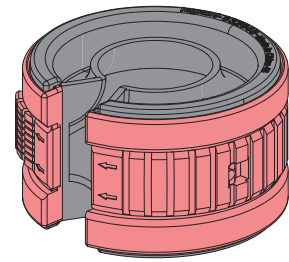

632948

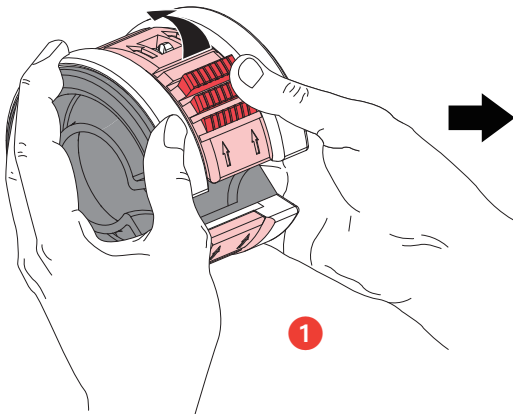
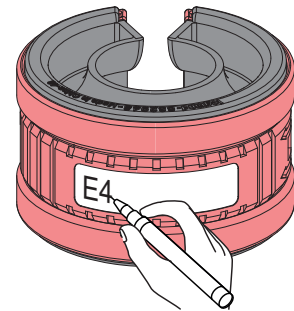
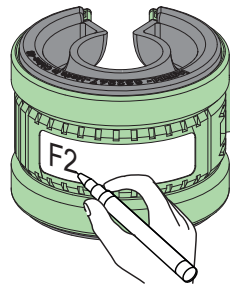

1

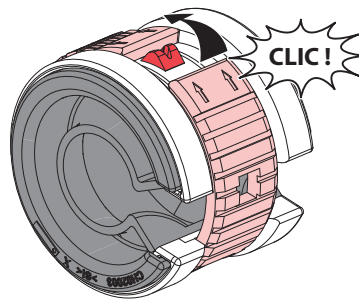

2

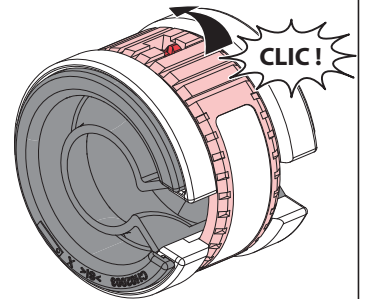

3

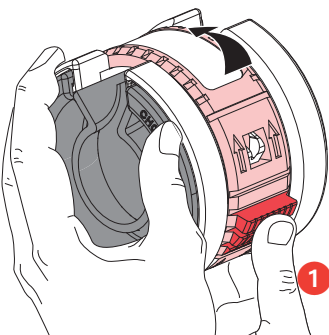

1

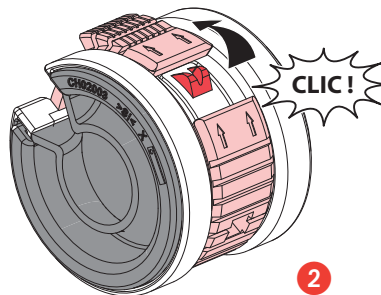

2

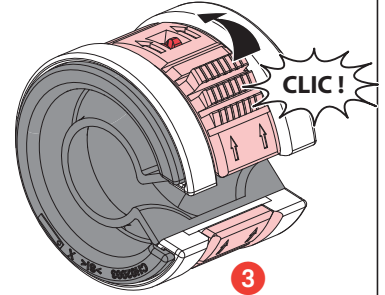

3

- FIBRE OPTIQUE
- OPTICAL FIBRE
- GLASFASER

- FIBRA ÓPTICA
- FİBER OPTİK
- الألياف الضوئية .

- ВОЛОКОННАЯ ОПТИКА
- FIBRA OTTICA
- 光缆

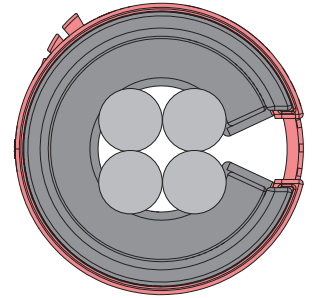
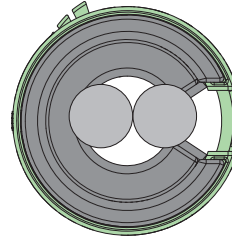
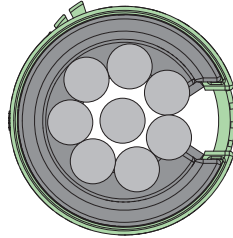
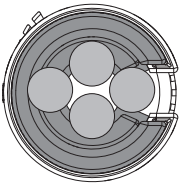
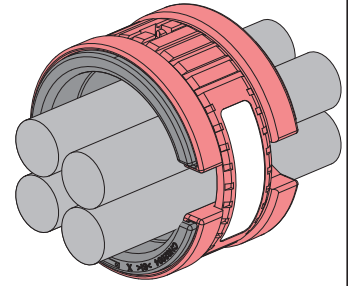
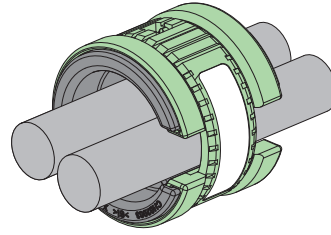
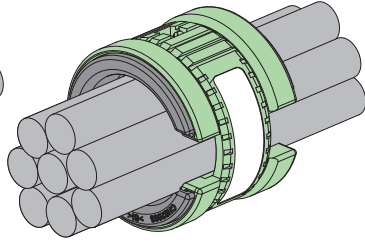
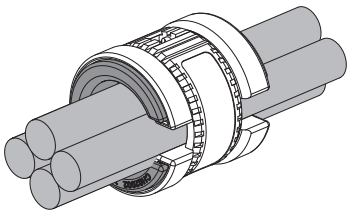

632946
4 X Ø 10MM

632947
8 X Ø 10MM

632947
2 X Ø 18MM

632948
4 X Ø 18MM

- CUIVRE
- COPPER
- KUPFER

- COBRE
- BAKIR
- نحاس .

- МЕДЬ
- RAME
- 铜缆

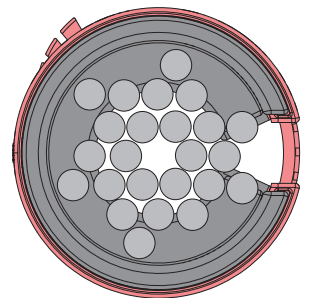
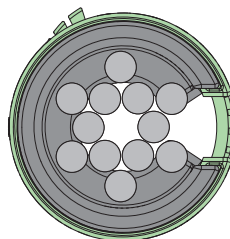
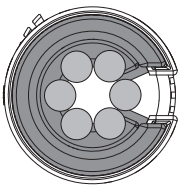
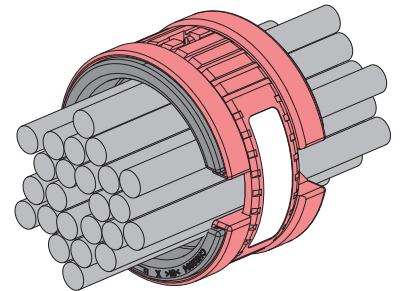
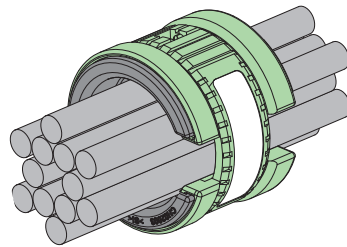
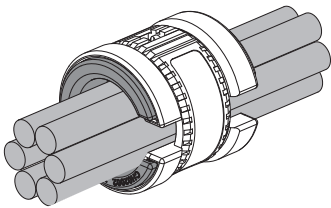

632946
6 X Ø (*)

632947
12 X Ø (*)

632948
24 X Ø (*)

(*) AWG de 22 à 26
(*) AWG from 22 to 26
(*) AWG 22 bis 26

(*) AWG 22 a 26
(*) AWG 22-26 arası
(*) من 22 إلى 26 AWG (*)

(*) AWG от 22 до 26
(*) Da AWG 22 a 26
(*) AWG 22 至 26

- INSTALLATION FIBRE OPTIQUE
- FIBRE OPTIC INSTALLATION
- GLASFASERINSTALLATION

- INSTALACIÓN DE FIBRA ÓPTICA
- FIBER OPTIK TESISAT
- تركيبات الألياف الضوئية

- УСТАНОВКА ОПТОВОЛ. КАБЕЛЯ
- IMPIANTO IN FIBRA OTTICA
- 光纤安装

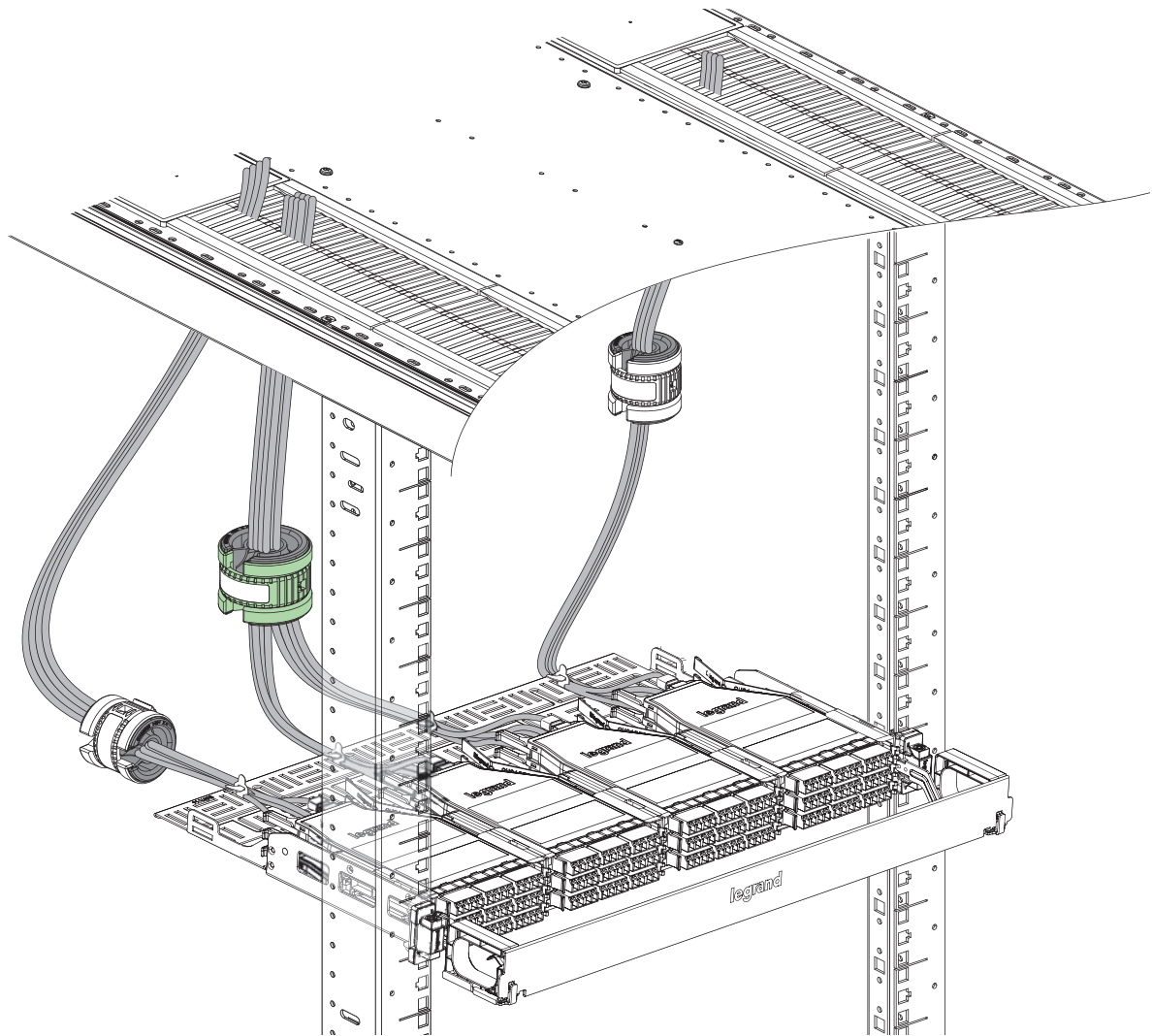

- INSTALLATION CUIVRE
- COPPER INSTALLATION
- KUPFERINSTALLATION

- INSTALACIÓN DE COBRE
- BAKIR TESISAT
- التركيبات النحاسية

- УСТАНОВКА МЕДНОГО КАБЕЛЯ
- IMPIANTO IN RAME
- 铜材安装

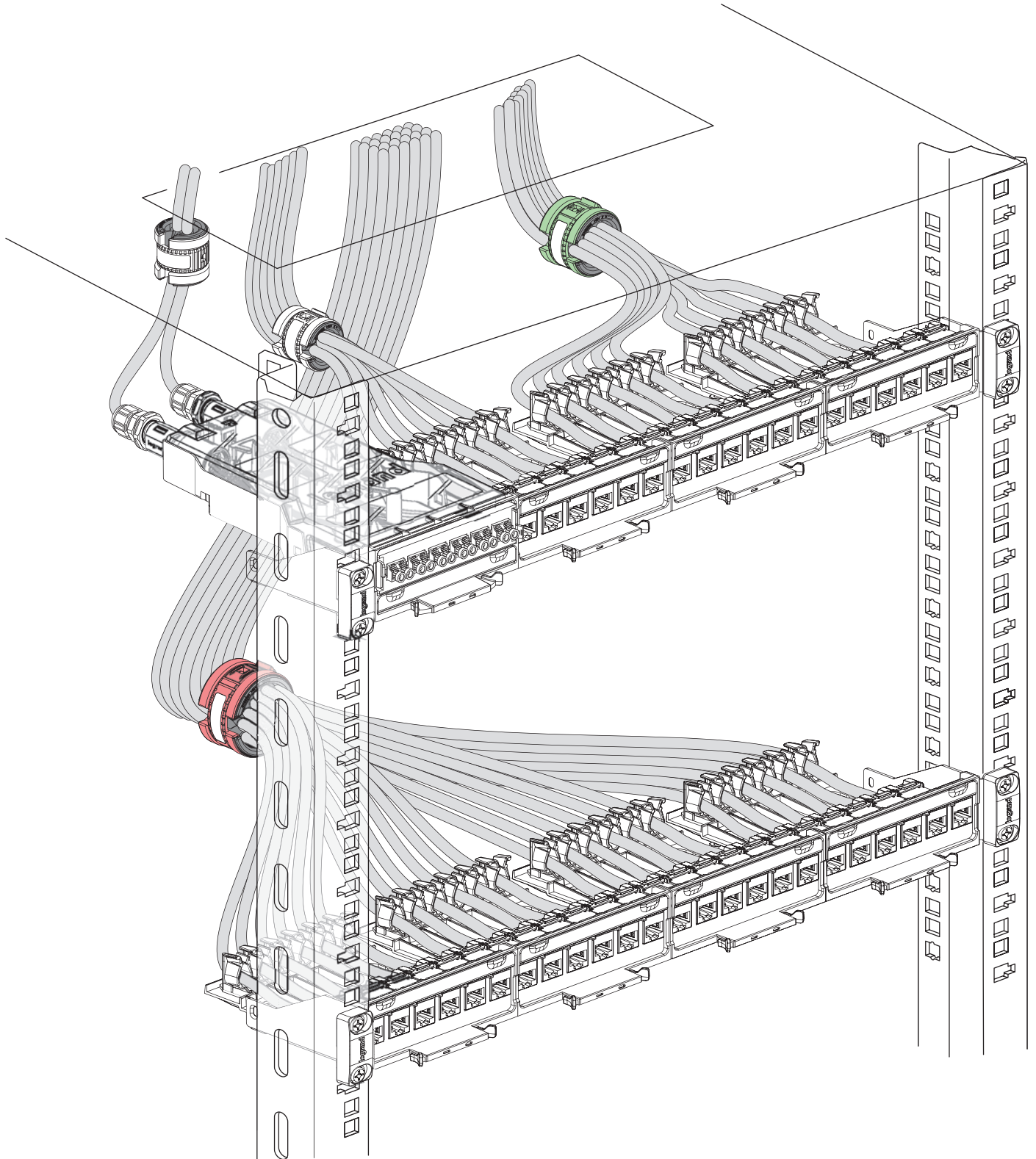

⚠ Consignes de sécurité

FR LU BE CH

Avant toute intervention, couper le courant.
Respecter strictement les conditions d'installation et d'utilisation.

⚠ Safety instructions

GB IE

Make sure the power supply is disconnected before any intervention.
Strictly comply with instructions for installation and use.

⚠ Sicherheitshinweise

DE AT LI CH

Vor jeglichem Eingriff die Spannungsfreiheit sicherstellen.
Einbau- und Gebrauchsanleitungen sind genau zu beachten.

⚠ Consignas de seguridad

ES

Antes de realizar cualquier intervención, cortar la corriente eléctrica.
Respetar estrictamente las condiciones de instalación y uso.

⚠ Güvenlik talimatları

TR CY

Herhangi bir müdahaleden önce, akımı kesiniz.
Yerleştirme ve kullanım koşullarına titizlikle riayet ediniz.

⚠ إرشادات الأمان:

«اقطع التيار الكهربائي قبل أي تدخل. تقيّد تقييداً تاماً بشروط التركيب والاستخدام.»

⚠ Меры предосторожности

RU

Отключить питание перед проведением любых ремонтных работ.
Строго соблюдайте требования к условиям монтажа и эксплуатации.

⚠ Istruzioni di sicurezza

IT CH

Prima di qualsiasi intervento, interrompere l'alimentazione.
Rispettare scrupolosamente le condizioni d'installazione e uso.

⚠ 安全提示

在任何干涉以前一定要断电，严格遵守安全和使用的规定。