

- Coffret coup de poing à voyants saillie/encastré
- Opbouw/inbouw kastje met verklikkers
- Break glass call point: manual mushroom head push button with indicators - surface/flush mounting
- Aufputz-/Unterputz-Kasten mit Piltaster und Leuchtmeldern
- Pulsador de alarma, con piloto saliente/de empotrar
- Cassetta con pulsante a fungo con spie da parete e da incasso
- Quadro com botoneira de emergência e sinalização saliente/encastrado



380 00/09/59

 **legrand**®

380 00/09

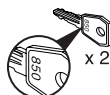
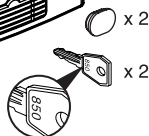
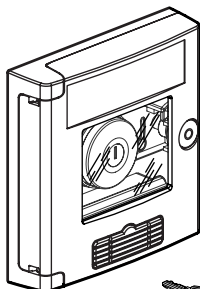
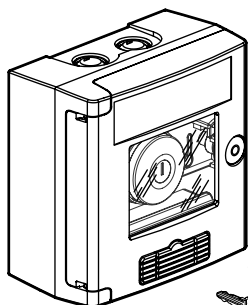
380 59

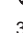

 230 V~ ; 3 A  
 400 V~ ; 1,75 A  
 48 V= ; 1 A  
 24 V= ; 1,5 A

⊗ : 230 V~ ; 12 mA

380 00/09 : IP 44 - IK 07

380 59 : IP 30 - IK 07

☒ 2 x 1,5 mm<sup>2</sup>



≤ 2000 m

**FRANCE**

**Attention :**

L'installation doit être réalisée conformément aux exigences de la norme NF C 15-100 :

- Pour commande en 230V.
- Dispositif de protection : disjoncteur bipolaire.

380 91

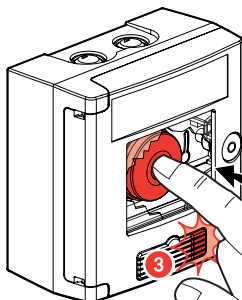
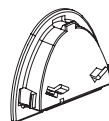
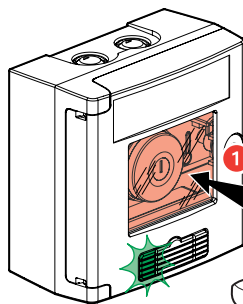
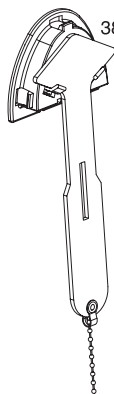
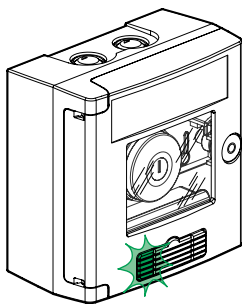

2

3

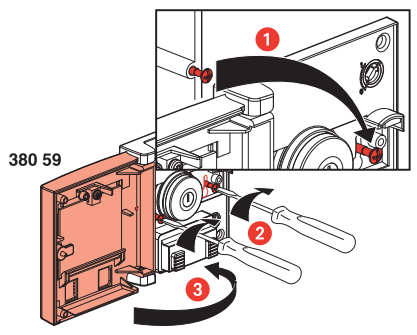
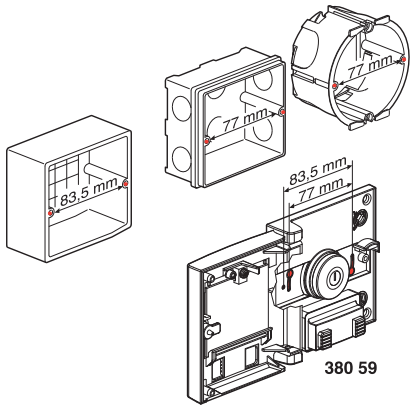
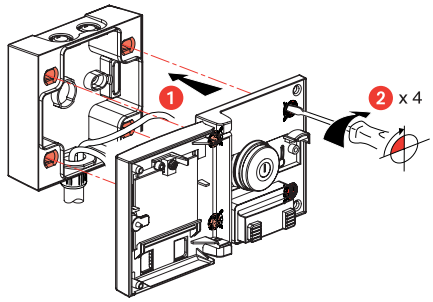
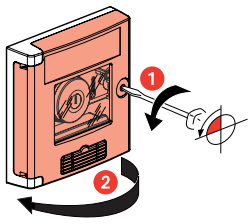
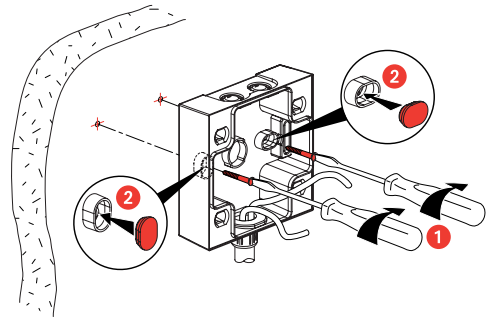
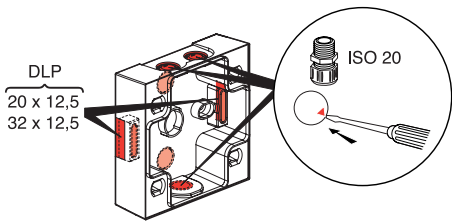

- Remplacement du dispositif de fermeture par une serrure Réf. 013 90
- Vervanging van het sluitingsmechanisme door een slot ref. : 013 90
- Installation of lock ref. 013 90
- Austausch der Verschlussvorrichtung gegen ein Schloss mit Ref. Nr. 013 90
- Sustitución del dispositivo de cierre por una cerradura ref. : 013 90
- Sostituzione del dispositivo di chiusura con una serratura Art. : 013 90
- Substituição do dispositivo de fecho por fechadura , refª: 013 90

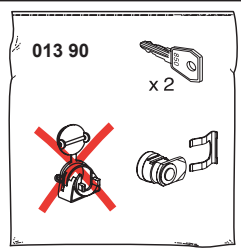

- Raccordement des voyants
- Aansluiting van de verklikkers
- Connection of indicators
- Anschluss der Leuchtmelder
- Conexión de los pilotos
- Collegamento delle spie
- Ligações dos sinalizadores

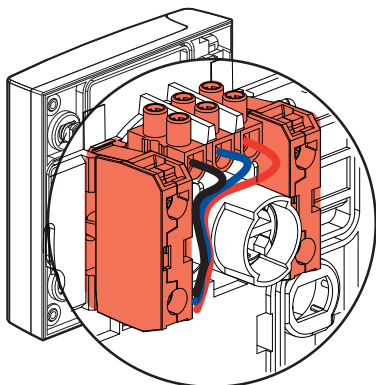

- Câbler les 3 fils
- De 3 draden aansluiten
- Connect the 3 wires
- Die drei Drähte anschliessen
- Cablear los 3 hilos
- Cablare i 3 fill
- Ligue os 3 fios

- Liaisons électriques internes
- Interne elektrische verbindingen
- Internal electrical connection
- Interne elektrische Schaltung
- Uniones eléctricas internas
- Collegamenti elettrici interni
- Ligações eléctricas internas

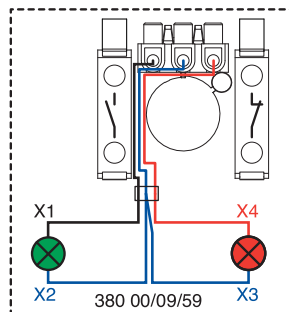

- Longueur de ligne
- Lengte van lijn
- Length of line

- Linien länge
- Longitud de línea
- Lunghezza di linea

- Comprimento de linha

230 V~

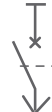

- ≤ 300 mètres
- ≤ 300 meters
- ≤ 300 meters
- ≤ 300 meter
- ≤ 300 metros
- ≤ 300 metri
- ≤ 300 metros

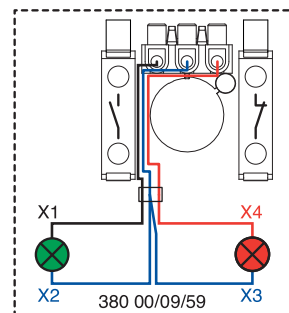

- Exemples de câblage
- Bekabelingsvoorbeelden
- Wiring examples

- Verdrahtungsbeispiel
- Ejemplos de cableado
- Esempios di cablaggio

- Exemplos de cablagem

- Déclencheur à émission et contact auxiliaire séparé
- Uitschakelspoel door emissie in afzonderlijk hulpcontact
- Shunt trip and separate auxiliary contact
- Auslöser am Gerät und getrennter Hilfskontakt
- Disparador a emisión y contacto auxiliar separado
- Sganciatore a lancio di corrente e contatto ausiliario separato
- Bobina de disparo por emissão de corrente e contacto auxiliar separado

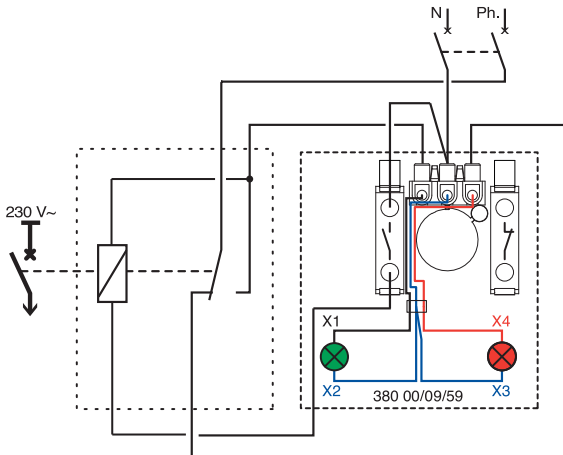
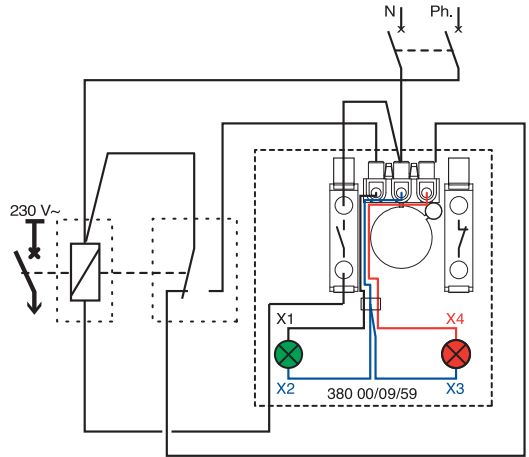

- Déclencheur à émission et contact auxiliaire intégré
- Uitschakelspoel door emissie in geïntegreerd hulpcontact
- Shunt trip and integral auxiliary contact
- Auslöser am Gerät und angegliederter Hilfskontakt
- Disparador a emisión y contacto auxiliar incorporado
- Sganciatore a lancio di corrente e contatto ausiliario integrato
- Bobina de disparo por emissão de corrente e contacto auxiliar incorporado

- Déclencheur à minimum de tension
- Minimumspanningsuitschakelspoel
- Under-voltage shunt trip
- Unterspannungsauslöser
- Disparador a mínimo de tensión
- Sganciatore di minima tensione
- Bobina de disparo por mínimo de tensão

