

## Connected starter pack: Gateway Module + Contactor

### 4 121 91B



#### Composition of this pack

This pack allows you to create a connected installation in your home.

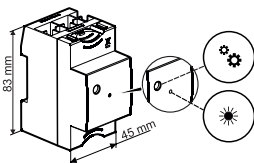



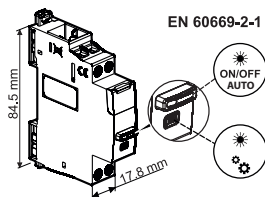







Gateway module



Connected Contactor

	<b>U</b>	<b>P</b> consumption	<b>F</b>
-5°C +45°C	100-240V~ 50/60Hz	2W MAX	2,4-2,4835Ghz <100 mW

 <b>F</b>									
2,4-2,4835Ghz <100 mW	Silent <10dB	Planning	Measure	4800W	1200VA	EV plug remote	3840W	650W	3000W

	<b>U</b>	<b>I</b>	Shedding 
-5°C +45°C	100-240V~ 50/60Hz	20A MAX	Connected shedding compatible

#### Safety instructions

This product should be installed in compliance with installation rules, preferably by a qualified electrician. Incorrect installation and/or incorrect use can lead to risk of electric shock or fire. Before carrying out the installation, read the instructions and take account of the product's specific mounting location. Do not open up, dismantle, alter or modify the device except where specifically required to do so by the instructions. All **Legrand** products must be opened and repaired exclusively by personnel trained and approved by **Legrand**. Any unauthorised opening or repair completely cancels all liabilities and the rights to replacement and guarantees. Use only **Legrand** brand accessories.

LE15598AA-EN

Your products are compatible with technology Apple HomeKit for control of your connected home. This allows you, for example, to control your products by voice through the wizard Siri voice from your iPhone, iPad, HomePod or Apple Watch.

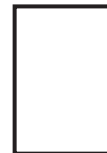

Apple HomeKit: During the installation of the iOS mobile app, you will be asked for this code.

#### HomeKit (using the House application)

To control this HomeKit-enabled accessory, the latest version of iOS or iPadOS is recommended. Controlling this HomeKit-enabled accessory automatically and away from home requires a HomePod, Apple TV, or iPad set up as a home hub. It is recommended that you update to the latest software and operating system.

#### Legal notice

Using products with the Apple HomeKit logo means that an electronic accessory has been designed to connect specifically to the iPod, iPhone or iPad, and has been certified by the developer to meet Apple's performance standards.

Apple is not responsible for the operation of this device or its compliance with safety and regulatory standards. Please note that using this accessory with the iPod, iPhone, or iPad may affect wireless performance.

iPhone, iPod and iPad are registered trademarks of Apple Inc., registered in the U.S. and other countries.

App Store is a service mark of Apple Inc., registered in the U.S. and other countries.

HomeKit and iPadOS are trademarks of Apple Inc.

iOS is a trademark or registered trademark of Cisco in the U.S. and other countries and is used under licence.

Android, Google Play and Google Play badge are trademarks of Google LLC.



[www.legrand.com/ecatalogue/](http://www.legrand.com/ecatalogue/)

LEGRAND - Pro and Consumer Service - BP 30076  
87002 LIMOGES CEDEX FRANCE • [www.legrand.com](http://www.legrand.com)

## Installation step by step

- ① Choose a location for the Gateway module, in the electrical cabinet:

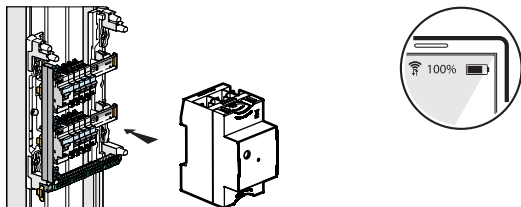

- ① If an Internet box is present in the home, check with a smartphone that the Wi-Fi signal strength is sufficient at the chosen location.
- ② If an Internet box is not yet present, choose a location near a fiber or telephone outlet that will be used for the Internet box.

- ② Install the **Gateway module** in the electrical cabinet



Turn OFF the power at  
**general circuit breaker**

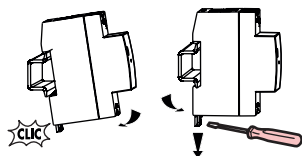

Cable the Gateway module  
under a circuit breaker

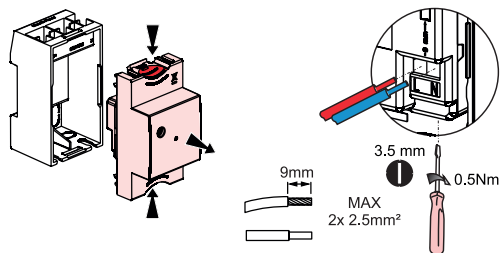

- ③ Add the **contactor** to your connected installation



OFF

Turn off the power at  
general circuit breaker

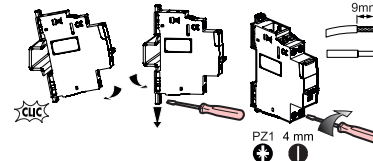

<b>C1, C2:</b>
MAX 2x 1.5mm <sup>2</sup> 2.5mm <sup>2</sup>
<b>N, L, Load:</b>
MAX 2x 2.5mm <sup>2</sup> 6mm <sup>2</sup>
<b>C1,C2, N, L, Load:</b>
MIN : 0.8Nm MAX : 1.4Nm

## Wiring examples

Thanks to its control circuit with integrated power and protection, you no longer need to install a circuit breaker 2A to protect the control circuit if you wire a contact between C1 and C2.

For the protection of the Connected Contactor, it is recommended to use a circuit breaker or a gG fuse with current rating  $\leq 20A$ .

If conditions allow, the existing electrical protections in the electrical panel can be reused for this purpose.

Controlled by the energy  
supplier electric meter

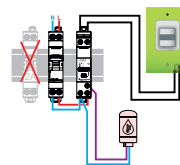

Swimming pool pump and other  
motors

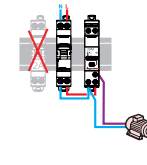

EV plug remote

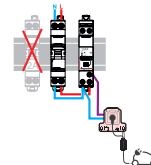

Control of heaters through an  
installed central remote

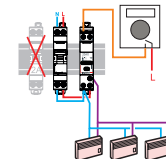

Control of a power single line contactor  
by a connected contactor \*

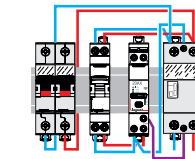

Control of a power three lines contactor  
by a connected contactor \*

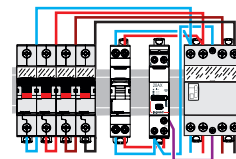

\* : Non-functional consumption measurement when controlling a single line or a three lines power contactor by a connected contactor.

— N (neutral) = blue  
— L (Line) = everything but blue and green/yellow  
— Line after contact = usually purple, orange...

- 4 Complete your connected installation with additional products (not included in this pack, non-exhaustive list of products):



Modules for the electrical panel

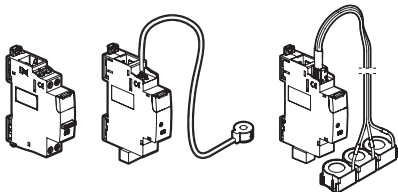

Sockets, switches and micromodules

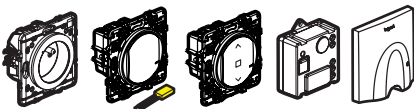

Accessories and wireless push-buttons

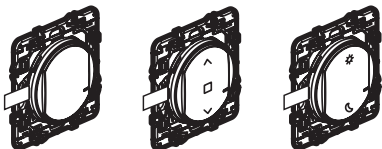

Wire wired products using the individual instructions provided in the packaging of each of them.

The Legrand ecosystem is growing regularly, do not hesitate to consult the website [legrand.com](https://www.legrand.com) to keep you informed.

- 5 Configure the **Gateway Module** and the **Contactor**



OFF

Turn off the power at  
**general circuit breaker**



ON

Turn on the power at the  
**general circuit breaker\*** once  
the installation completed and  
controlled\*\*

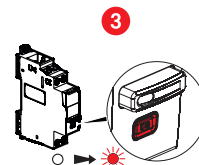

\* In order to restart all connected products at the same time.

\*\* After wiring the installation, refit the front plate so that no active live part is accessible.

- 6 Start configuring the installed products



For quick setup without Internet access:

Use the **Home + Pro** app.

Download the Home + Pro app and follow the instructions to set up your installation WITHOUT Internet access.



For installation with Internet access:

Use the **Home + Control** app.

Download the Home + Control app and follow the instructions to access more settings: configure scenarios, action schedules, and automations.

You're ready to control your installation and can customize your scenarios via the Home + Control app or your voice assistant.



### Reset a Connected Contactor to remove it from a connected installation

Press the configuration button of the Connected Contactor (> 5 seconds) until the configuration indicator lights up in fixed red. It is no longer associated with the gateway present in the installation.

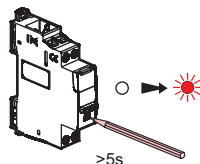

To add this connected product and peripheral items in your connected installation, you must follow the instructions:

- with **Legrand Home + Control app** (**Parameters/Add new product**)
- or consult the guides and instructions sheets on **legrand.com**



[www.legrand.com/ecatalogue/](http://www.legrand.com/ecatalogue/)

LEGRAND - Pro and Consumer Service - BP 30076  
87002 LIMOGES CEDEX FRANCE • [www.legrand.com](http://www.legrand.com)

### Use by manual control and status LED

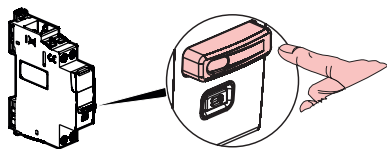

Automatic Mode



ON/OFF Mode



### UE SIMPLIFIED DECLARATION OF CONFORMITY

The undersigned,

**Legrand**

declares that the radio equipment listed on this instruction sheet are compliant to the directive 2014/53/UE.

The full text of the UE declaration of conformity is available at the following website:

[www.legrand.com/ecatalogue](http://www.legrand.com/ecatalogue)