

Wireless Color Ambiance Switch «with Netatmo» 1 991 36/37

This pack allows you to complete a smart installation to control your color ambiance lighting from the Wireless Color Ambiance Switch, from the Home + Control app, and from voice assistants.

legrand®
SIMPLY
CONNECTED

> Content:

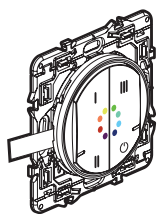

x1

Wireless Color Ambiance Switch

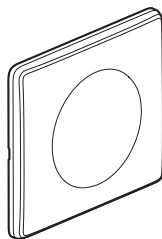

x1

Cover plate

Removal stickers

> Installation steps

- 1** Ensure to have an installed starter pack or gateway «with Netatmo», and to have downloaded the Legrand Home + Control app.

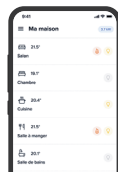

Download on the
App Store

GET IT ON
Google Play



- 2** To associate the command with your connected installation, it is recommended to follow the instructions in the **Legrand Home + Control** application

- 3** You are now ready to control your smart lighting from your Wireless Color Ambiance Switch or remotely thanks to the Home + Control app and voice assistants.

You can personalize your scenes via the app and set the colors want.



> Wireless command operation

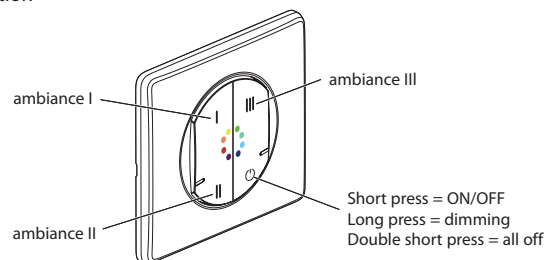

> Place the double-sided stickers if you want to stick the command on a wall.

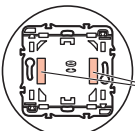

Stick both adhesives on the back of the command



Before sticking the wireless command on the wall, please check sticking on a non-visible part of the wall.

LE14016AA

> Complete your installation:

Your Legrand connected installation is scalable. You can easily add all Legrand connected solutions (to be found on legrand.com), Netatmo products or even Zigbee 3.0 certified lighting products from other brands.

And so, customise your scenarios and schedules via the Home + Control App.

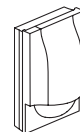

Motion detector 199140

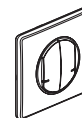

Double wireless control for
lights and/or outlets
1991 69/79/89
1992 39/59

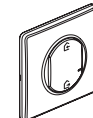

Wireless Home / Away
switch
1 991 66/76/86
1 992 36/56



Mobile socket
1 991 41



Dimmable or color Zigbee
3.0 connected bulbs

> Battery replacement

1

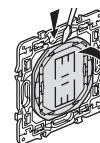

2

Lithium battery
CR 2032
3 V

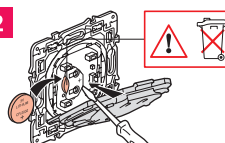

3

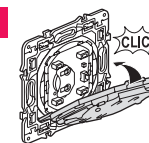

> Reset process

To reset the Wireless Ambiance Color Switch, do a long press on the «Configuration» button

About zigbee 3.0

Zigbee is a communication protocol that allows connected products (lighting, lighting controls, plugs, roller shutter control...) certified Zigbee 3.0 to communicate and work together. To check if a light is Zigbee 3.0 certified and therefore compatible with your «with Netatmo» connected starter pack

look for the logo on the packaging or on the product's manual. You can also consult the list of all Zigbee 3.0 certified products at the following address: <https://csa-iot.org>

If you already have Zigbee 3.0 certified products that have their own connection bridge, consider resetting them to be able to use them with your «with Netatmo» connected starter pack. Refer to your products' manuals for the reset procedure

⚠ Safety instructions

This product should be installed in compliance with installation rules, preferably by a qualified electrician. Incorrect installation and/or incorrect use can lead to risk of electric shock or fire. Before carrying out the installation, read the instructions and take account of the product's specific mounting location. Do not open up, dismantle, alter or modify the device except where specifically required to do so by the instructions. All **Legrand** products must be opened and repaired exclusively by personnel trained and approved by **Legrand**. Any unauthorised opening or repair completely cancels all liabilities and the rights to replacement and guarantees. Use only **Legrand** brand accessories.



www.legrand.fr

LEGRAND - Pro and Consumer Service - BP 30076
87002 LIMOGES CEDEX FRANCE • www.legrand.com

SIMPLIFIED EU DECLARATION OF CONFORMITY

The undersigned,
Legrand

declares that the radio-electric equipment referred to in these instructions complies with directive 2014/53/EU. The full text of the EU declaration of conformity is available on the following website :

www.legrandoc.com