

Linkeo C+ - Linkeo C Series

- Connecteurs
 - Connectoren
 - Connectors
 - Stecker
- Conectores
 - Conectores
 - Złącza
 - Разъёмы

• 连接头
• الموصلات



RJ 45 - Cat 5e - Cat 6 - Cat 6A

	UTP				FTP	STP		
	International		Domestic China	Linkeo C series	International	International	Domestic China	Linkeo C series
Cat 5e	632936	632974	632917	632998	632933	632935	632916	632995*
Cat 6	632934	632973	632915	632997		632932	632914	
Cat 6A	632931		632913*	632996*		632930	632912*	

* Permanent link certified only

- Installation
- Installatie
- Installation
- Installation
- Instalación

- Instalação
- Instalacja
- Установка
- 安装
- التركيب

Cat 5e-Cat6-Cat 6A

L1 ≤ 90 m
L2 ≤ 5 m
L3 ≤ 5 m

- Câblage (AWG 22....26)
- Verdrahtung (AWG 22 bis 26)
- Okablowanie(AWG 22....26)
- 布线 (AWG 22...26)
- Bekabeling (AWG 22....26)
- Cableado (AWG 22....26)
- Прокладка проводов (AWG 22...26)
- ربط الأسلاك (AWG 22...26)
- Cabling (AWG 22 to 26)
- Cablagem (AWG 22-26)
- (AWG 22....26)

U/UTP	F/UTP	F/UTP Cat 6A	SF/UTP
S/FTP			
F/FTP			
U/FTP			

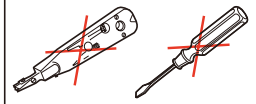
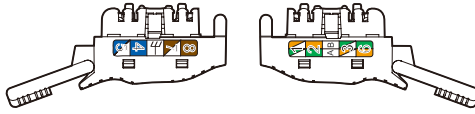
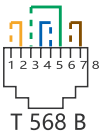
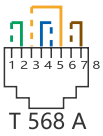

- Ouverture du connecteur
- De connector openen
- Opening the connector
- Öffnen des Steckers

- Apertura del conector
- Abertura do conector
- Otworzenie złącza
- Открытие разъема

- 打开连接头
- فتح المفصل

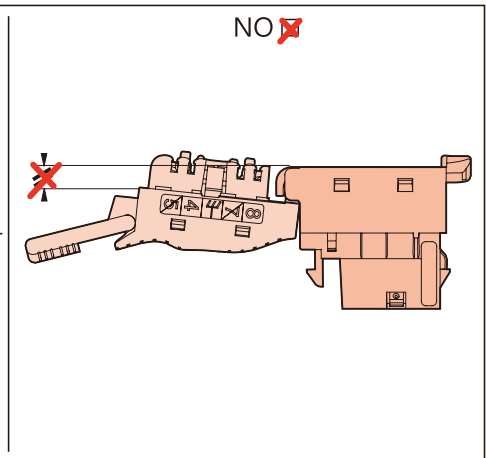
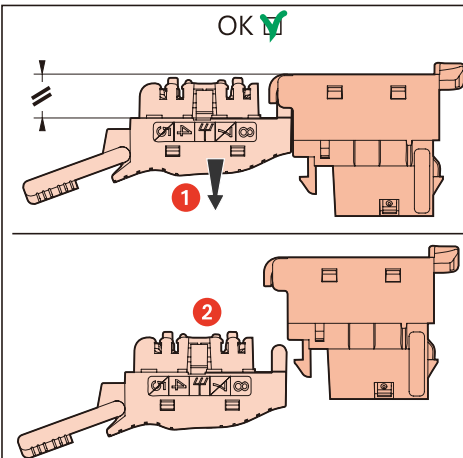
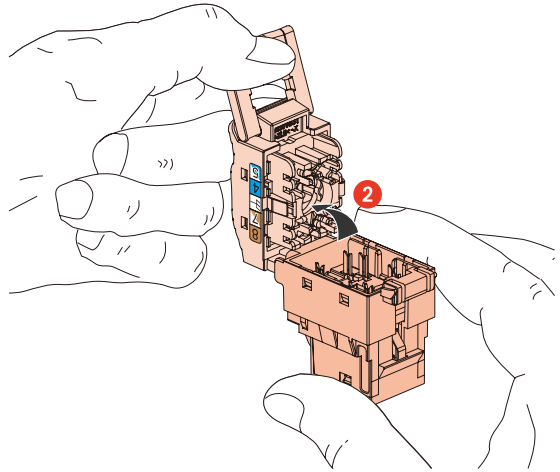
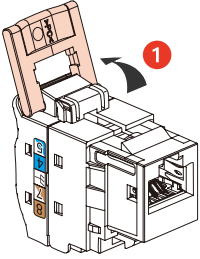

- Préparation connecteur UTP
- De connector UTP voorbereiden
- Preparing the UTP connector
- Vorbereitung UTP-Stecker

- Preparación conector UTP
- Preparação de conector UTP
- Przygotowanie złącza UTP
- Подготовка разъема UTP

- 准备UTP连接头
- إعداد الموصل UTP

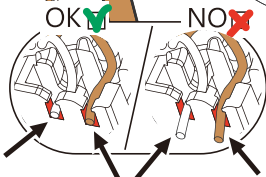
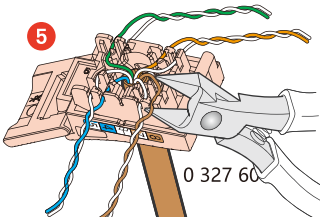
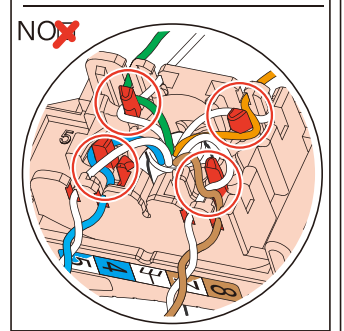
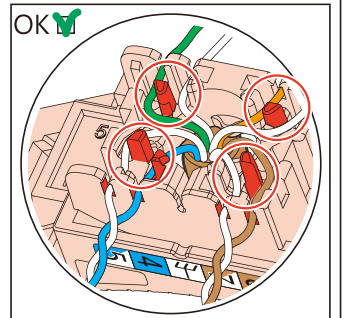
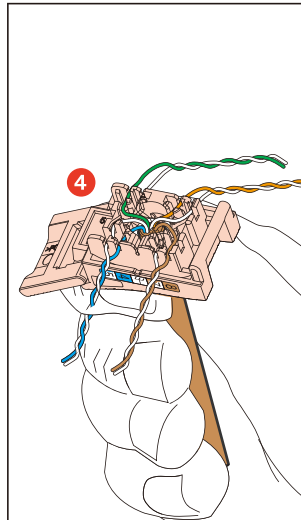
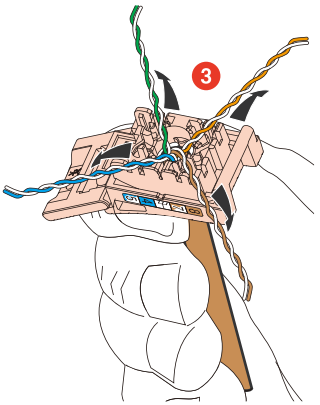
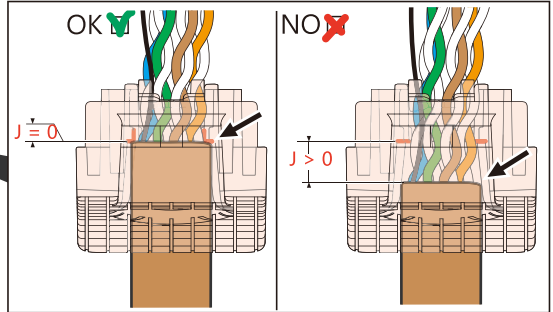
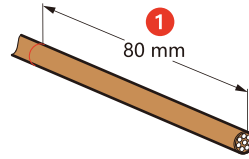
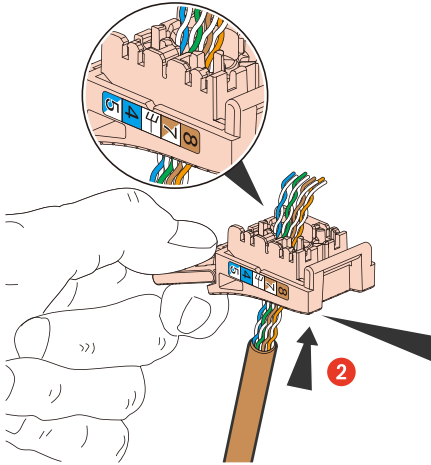

- Fermeture connecteur UTP
- De connector UTP sluiten
- Closing the UTP connector
- Schließen UTP-Stecker

- Cierre conector UTP
- Fecho de conector UTP
- Zamknięcie złącza UTP
- Закрыццё раз'язема UTP

- 关闭UTP连接头
- غلق الموصل UTP

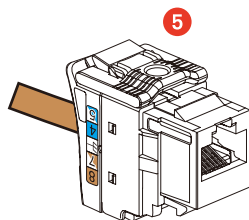
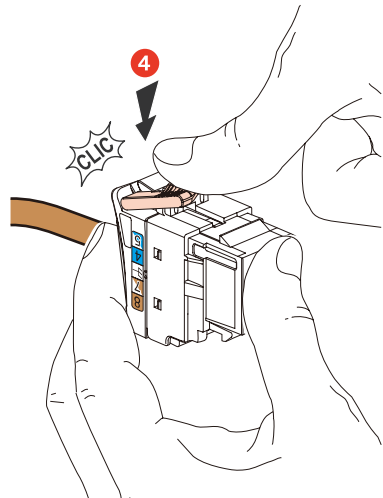
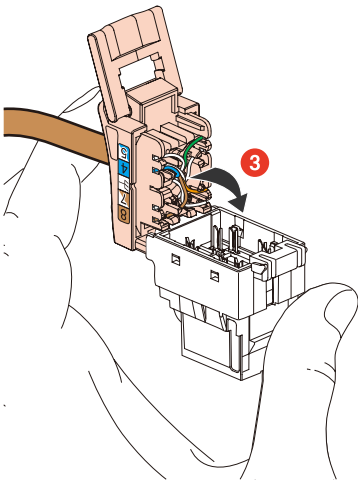
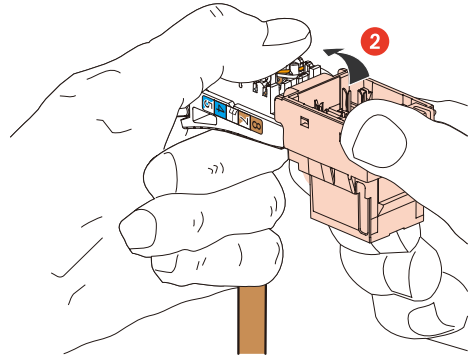
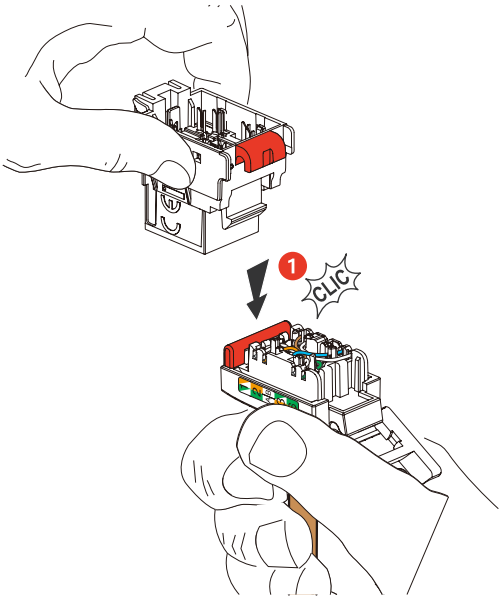

- Préparation connecteur FTP
- De connector FTP voorbereiden
- Preparing the FTP connector
- Vorbereitung FTP-Stecker

- Preparación conector FTP
- Preparação de conector FTP
- Przygotowanie złącza FTP
- Подготовка разъема FTP

- 准备FTP接头
- إعداد الموصل FTP

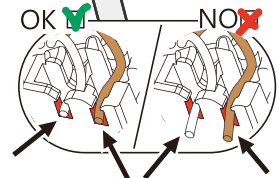
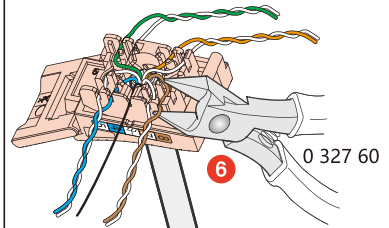
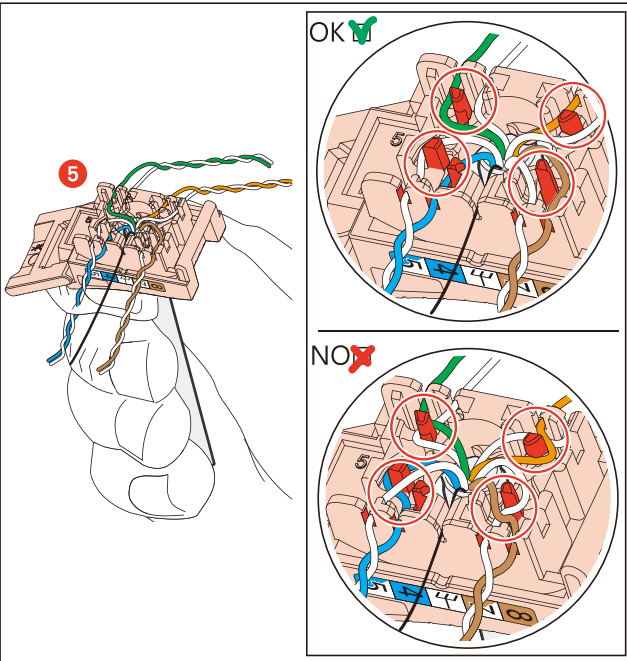
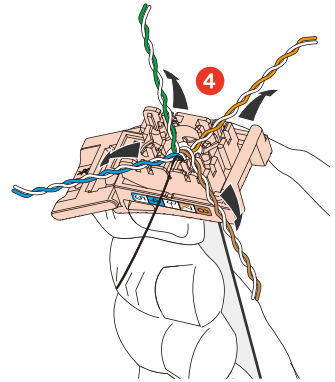
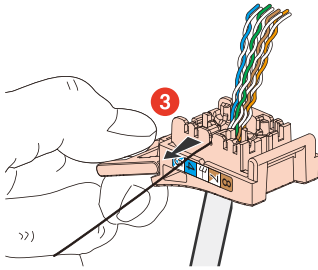
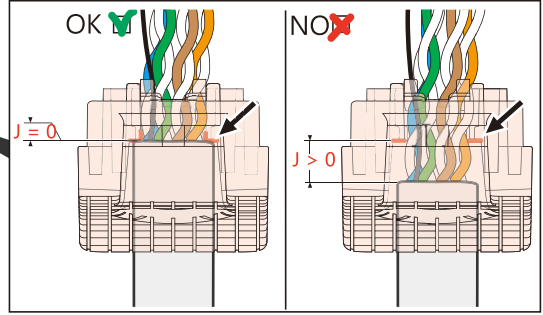
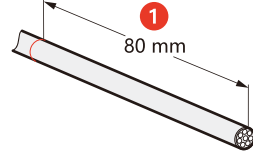
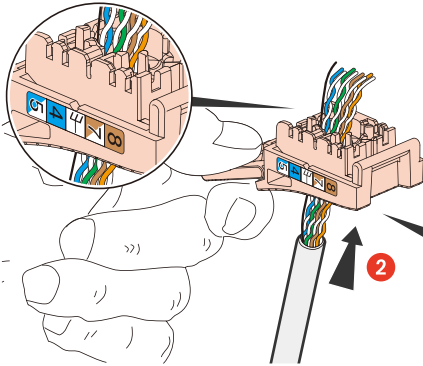

- Fermeture connecteur FTP
- De connector FTP sluiten
- Closing the FTP connector
- Schließen FTP-Stecker

- Cierre conector FTP
- Fecho de conector FTP
- Zamknięcie złącza FTP
- Закрыццё раз'ёма FTP

- 关闭FTP 连接头
- غلق الموصل FTP

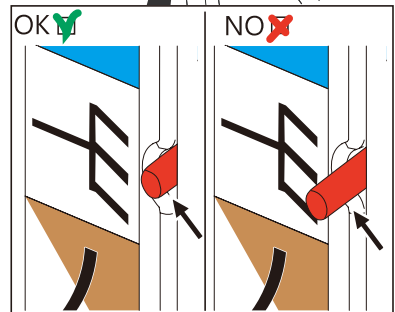
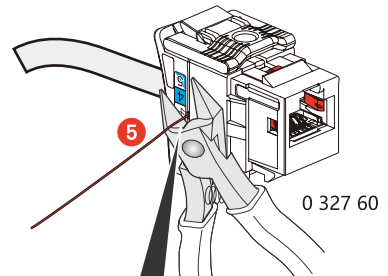
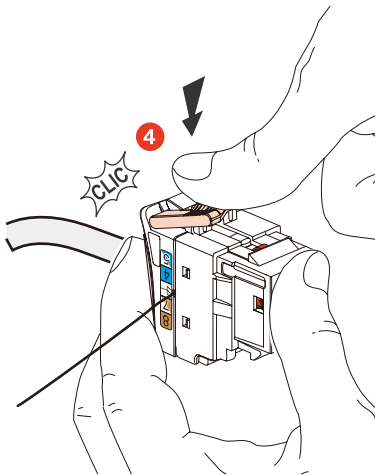
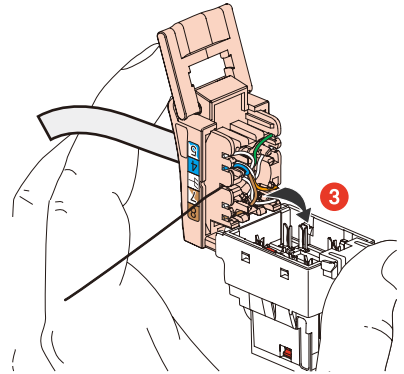
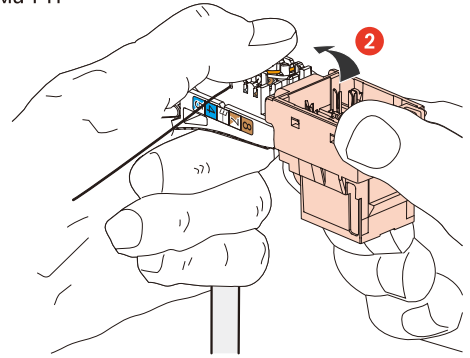
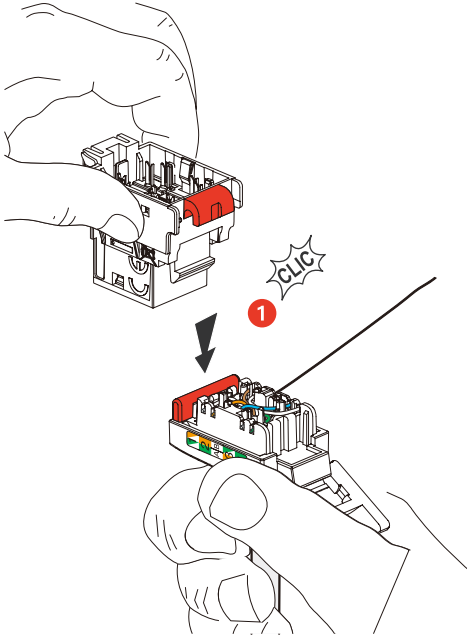

- Préparation connecteur STP
- De connector STP voorbereiden
- Preparing the STP connector
- Vorbereitung STP-Stecker

- Preparación conector STP
- Preparação de conector STP
- Przygotowanie złącza STP
- Подготовка разъема STP

- 准备STP连接头
- إعداد الموصل STP

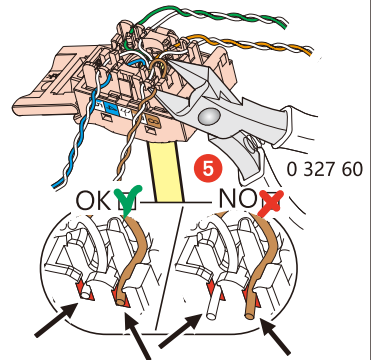
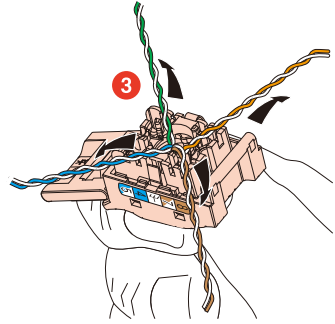
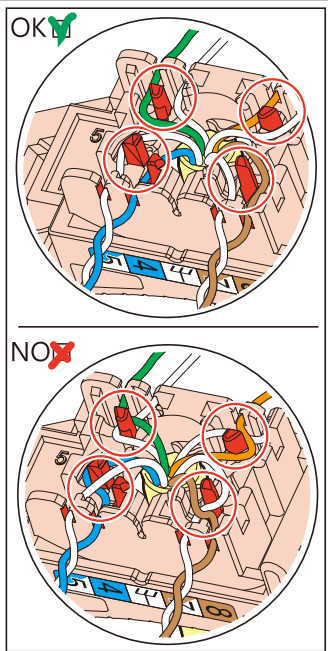
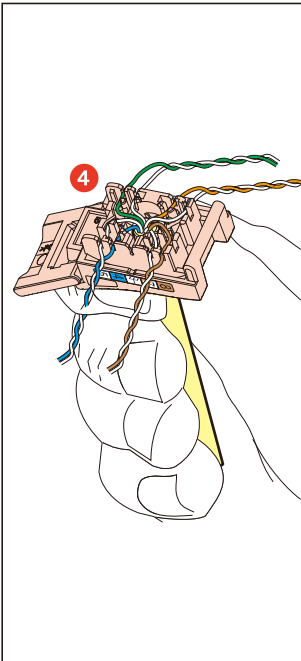
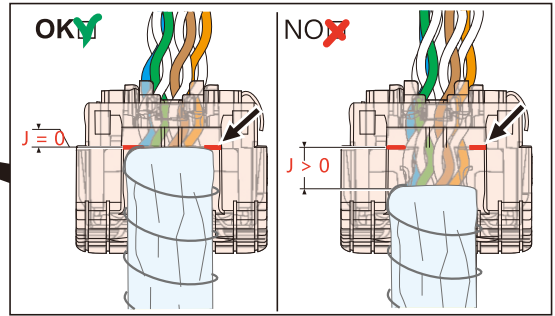
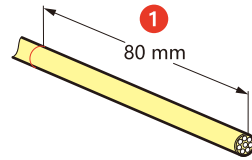
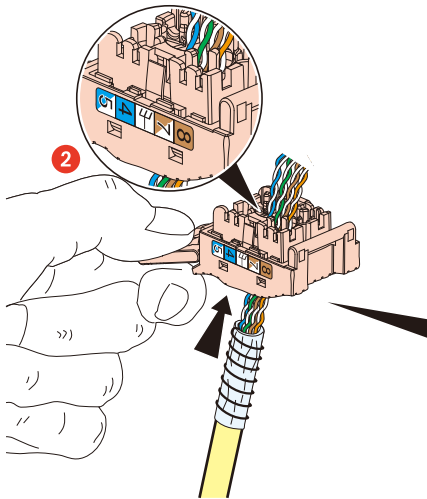

- Fermeture connecteur STP
- De connector STP sluiten
- Closing the STP connector
- Schließen STP-Stecker

- Cierre conector STP
- Fecho de conector STP
- Zamknięcie złącza STP
- Закрыццё раз'ёма STP

- 关闭STP连接头
- غلق الموصل STP

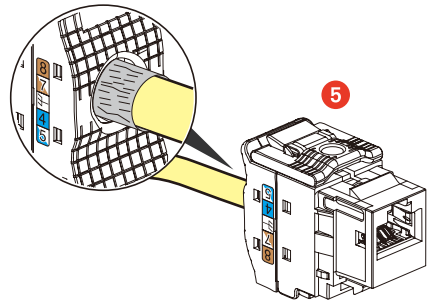
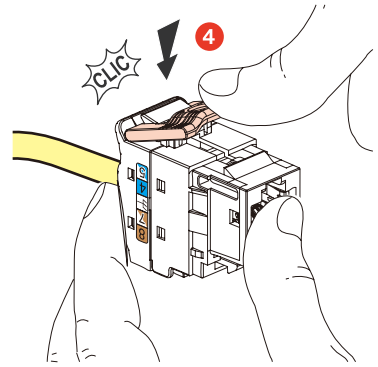
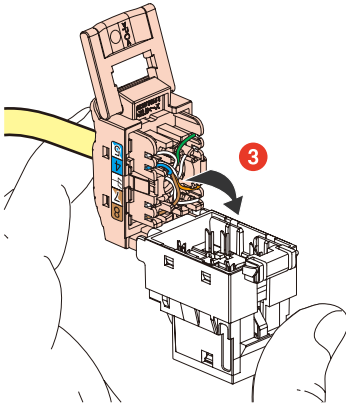
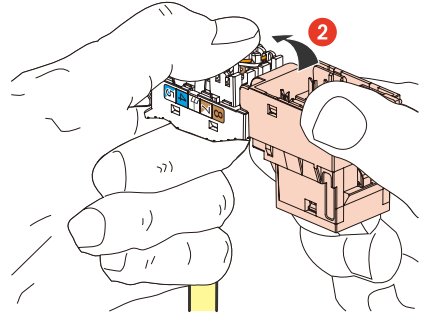
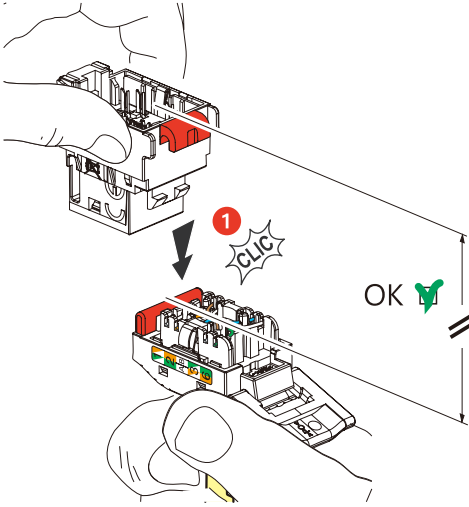

⚠ Consignes de sécurité
Avant toute intervention, couper le courant.
Respecter strictement les conditions d'installation et d'utilisation.

FR DE IT CH

⚠ Consignas de seguridad
Antes de realizar cualquier intervención, cortar la corriente eléctrica.
Respetar estrictamente las condiciones de instalación y uso.

ES

⚠ 安全提示
在任何干涉以前一定要断电，严格遵守安全和使用的规定。

⚠ 注意

في أي تدخل، تفتتاً تفتتاً تماماً بشروط التركيب والاستخدام.

⚠ Veiligheidsvoorschriften
Onderbreek voor enige ingreep de stroom.
Neem de installatie- en gebruiksvoorwaarden nauwgezet in acht.

NL BE

⚠ Instruções de segurança
Antes de qualquer intervenção, desligar a corrente.
Respetar rigorosamente as condições de instalação e de utilização.

PT

⚠ Safety instructions
Make sure the power supply is disconnected before any intervention.
Strictly comply with instructions for installation and use.

GB IE

⚠ Przepisy bezpieczeństwa
Przed każdą czynnością na urządzeniu, odłącz dopyły prądu.
Ścisłe przestrzegać instrukcji dotyczących instalacji i użytkowania.

PL

⚠ Sicherheitshinweise
Vor jeglichem Eingriff die Spannungsfreiheit sicherstellen.
Einbau- und Gebrauchsanleitungen sind genau zu beachten.

DE CH

⚠ Меры предосторожности
Отключить питание перед проведением любых ремонтных работ.
Строго соблюдайте требования к условиям монтажа и эксплуатации.

RU