

# Linkeo C

- Connecteurs
- Connectoren
- Connectors
- Stecker

- Conectores
- Conectores
- Złącza
- Разъёмы

• 连接头  
• الموصلات •

RJ 45 - Cat 5e - Cat 6 - Cat 6A



	UTP			FTP		STP	
Cat 5e	6 329 11	6 329 17	6 329 24	-	-	6 329 10	6 329 16
Cat 6	6 329 09	6 329 15	6 329 23	6 329 08	-	6 329 07	6 329 14
Cat 6A	6 329 06	6 329 13	-	-	-	6 329 05	6 329 12

- Installation
- Installatie
- Installation
- Installation
- Instalación
- Instalação

- Instalacja
- Установка
- 安装
- التركيب

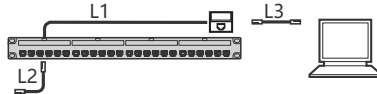

**!**

Cat 5e-Cat6-Cat 6A

L1 ≤ 90 m  
L2 ≤ 5 m  
L3 ≤ 5 m

- Câblage (AWG 23....26)
- Bekabeling (AWG 23....26)
- Cabling (AWG 23 to 26)
- Verdráhtung (AWG 23 bis 26)
- Cableado (AWG 23....26)
- Cablagem (AWG 23-26)
- Okablowanie (AWG 23....26)
- Прокладка проводов (AWG 23....26)
- 布线 (AWG 23...26)
- ربط الأسلاك (AWG 23...26)

U/UTP	F/UTP	F/UTP Cat 6A	SF/UTP
S/FTP			
U/FTP			

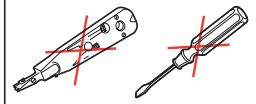
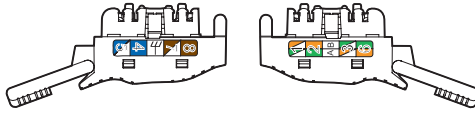
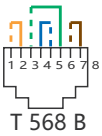
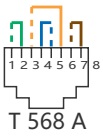

- Ouverture du connecteur
- De connector openen
- Opening the connector
- Öffnen des Steckers

- Apertura del conector
- Abertura do conector
- Otworzenie złącza
- Открытие разъема

- 打开连接头
- فتح الموصل

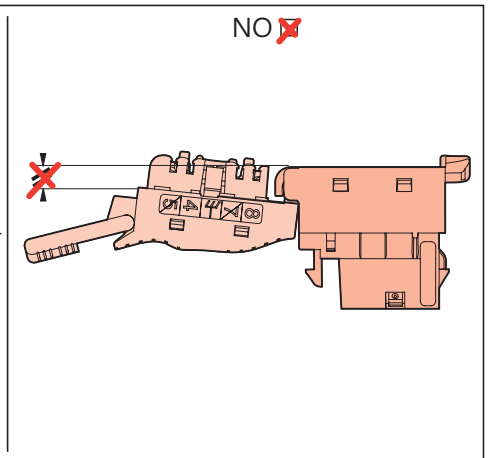
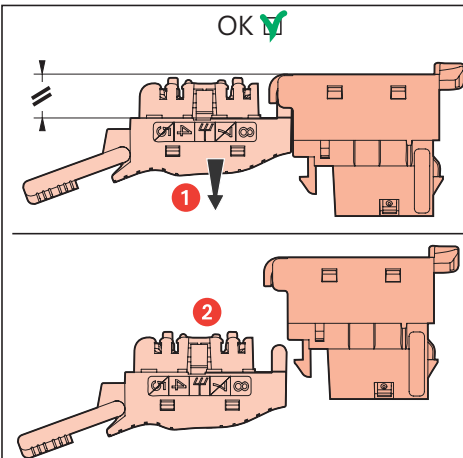
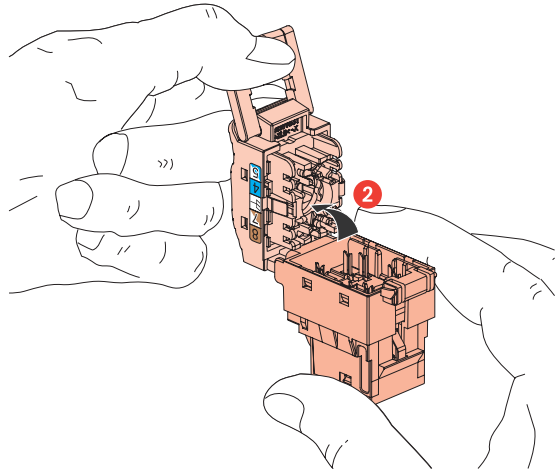
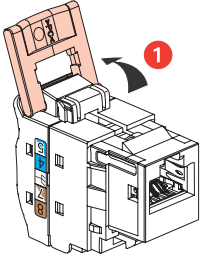

- Préparation connecteur UTP
- De connector UTP voorbereiden
- Preparing the UTP connector
- Vorbereitung UTP-Stecker

- Preparación conector UTP
- Preparação de conector UTP
- Przygotowanie złącza UTP
- Подготовка разъема UTP

- 准备UTP连接头
- إعداد الموصل UTP

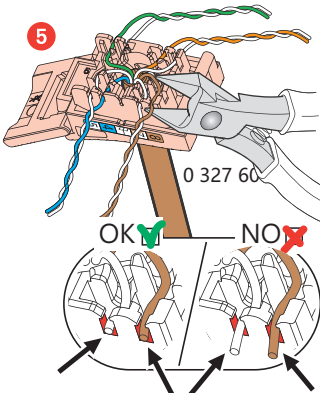
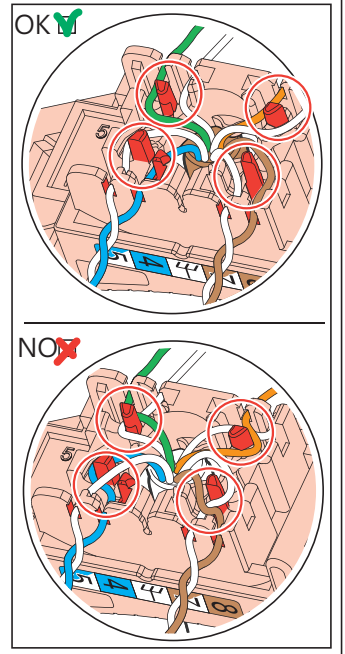
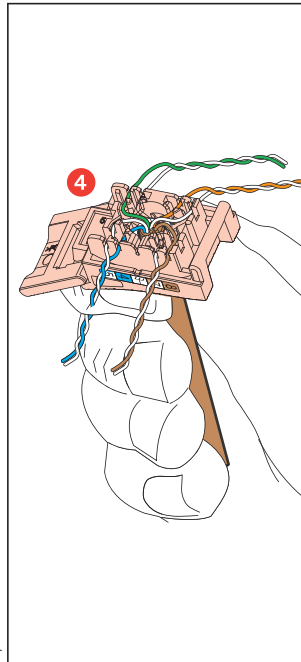
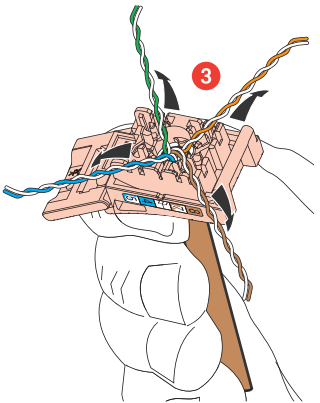
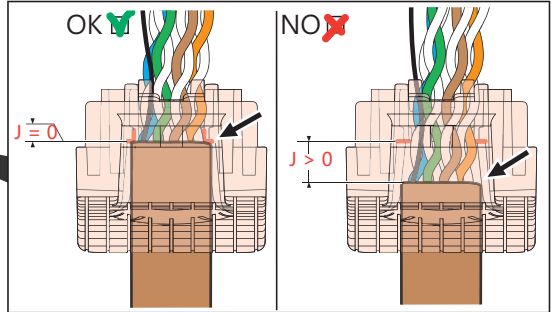
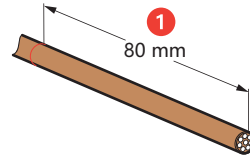
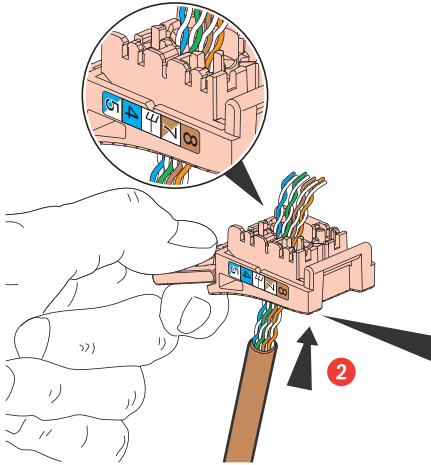

- Fermeture connecteur UTP
- De connector UTP sluiten
- Closing the UTP connector
- Schließen UTP-Stecker

- Cierre conector UTP
- Fecho de conector UTP
- Zamknięcie złącza UTP
- Закрыццё раз'ёма UTP

- 关闭UTP连接头
- غلق الموصل UTP

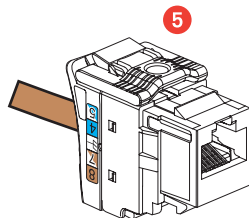
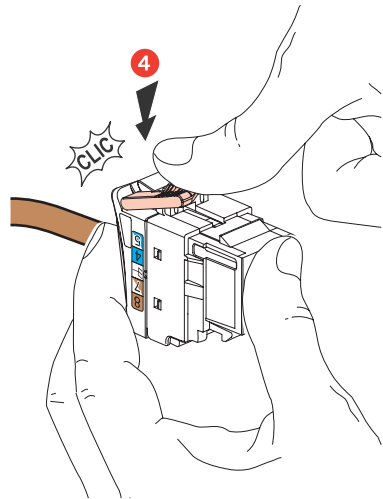
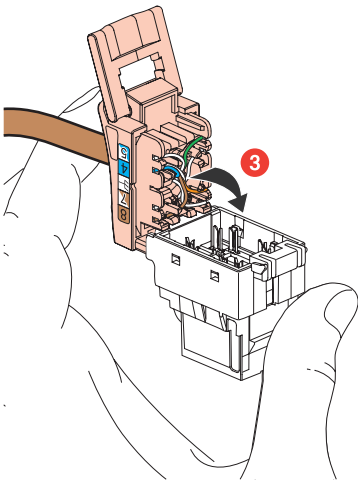
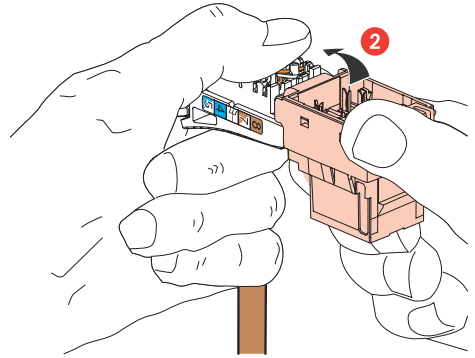
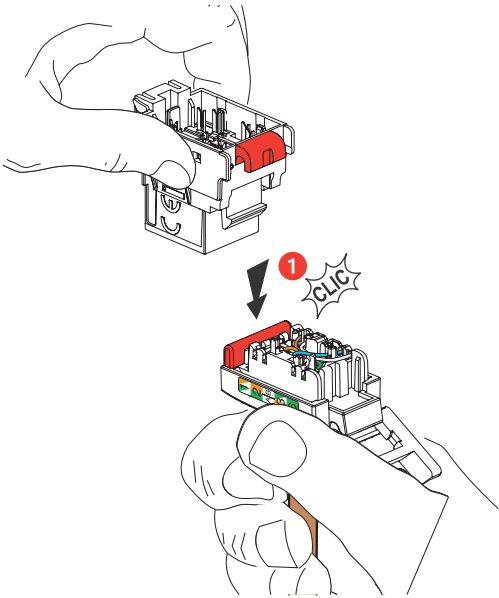

- Préparation connecteur FTP
- De connector FTP voorbereiden
- Preparing the FTP connector
- Vorbereitung FTP-Stecker

- Preparación conector FTP
- Preparação de conector FTP
- Przygotowanie złącza FTP
- Подготовка разъема FTP

- 准备FTP接头
- إعداد الموصل FTP

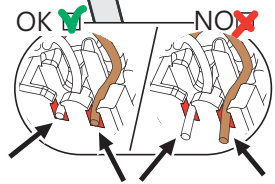
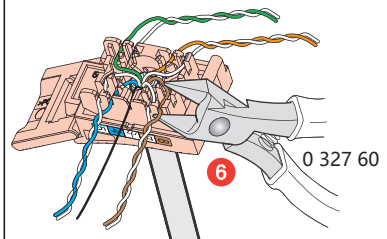
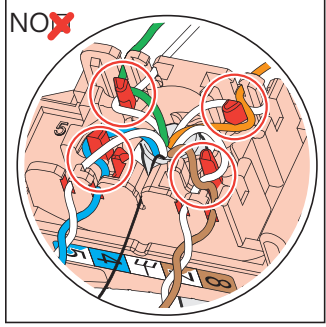
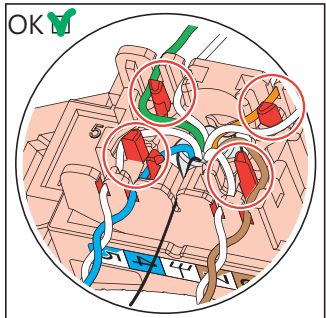
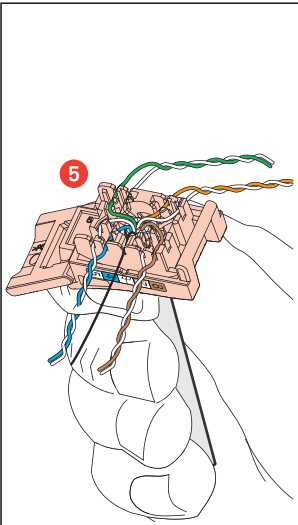
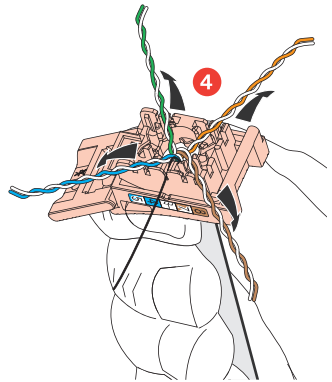
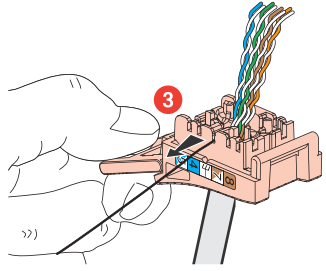
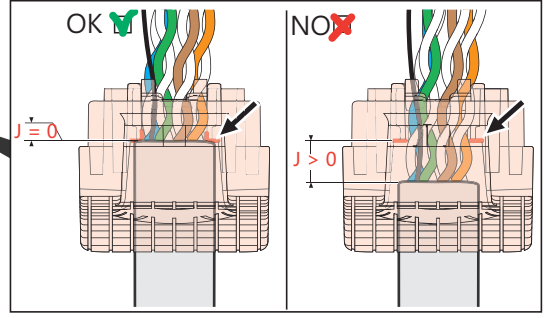
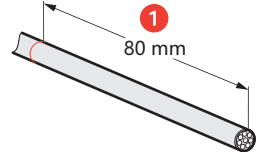
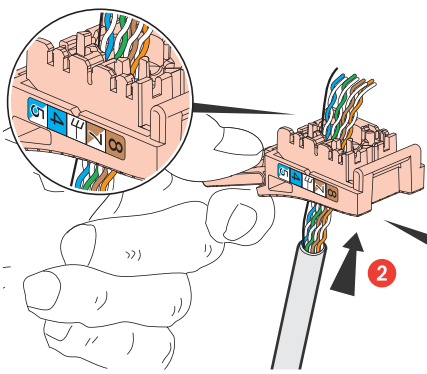

- Fermeture connecteur FTP
- De connector FTP sluiten
- Closing the FTP connector
- Schließen FTP-Stecker

- Cierre conector FTP
- Fecho de conector FTP
- Zamknięcie złącza FTP
- Закрыццё раз'ёма FTP

- 关闭FTP 连接头
- غلق الموصل FTP

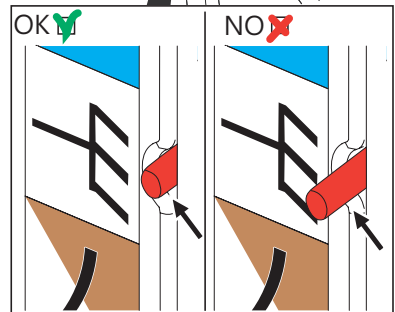
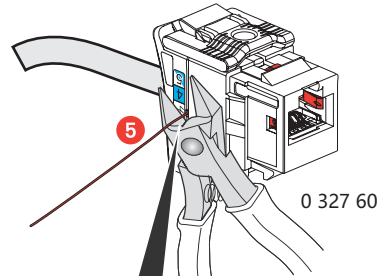
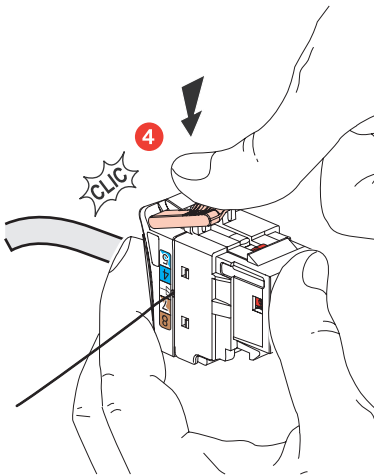
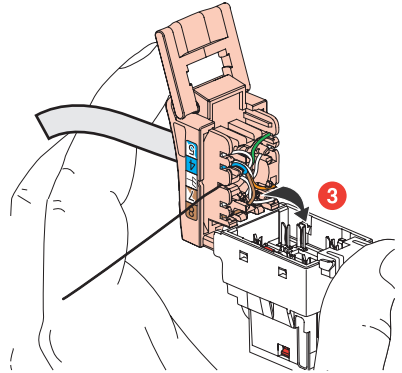
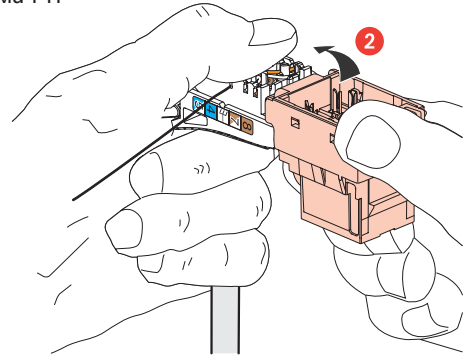
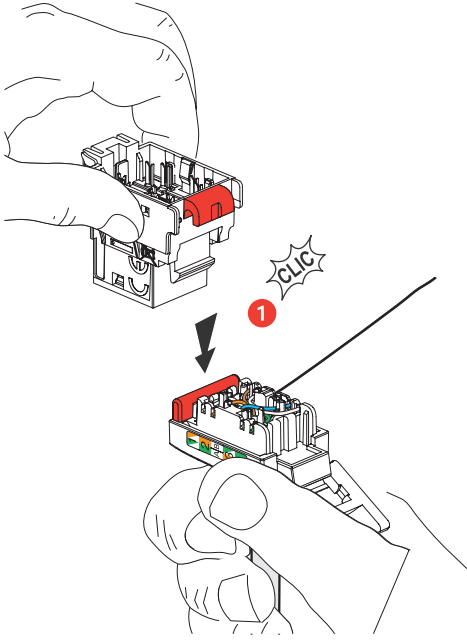

- Préparation connecteur STP
- De connector STP voorbereiden
- Preparing the STP connector
- Vorbereitung STP-Stecker

- Preparación conector STP
- Preparação de conector STP
- Przygotowanie złącza STP
- Подготовка разъема STP

- 准备STP连接头
- إعداد الموصل STP

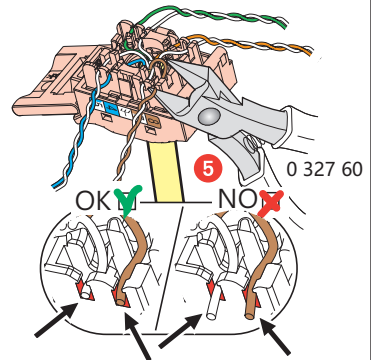
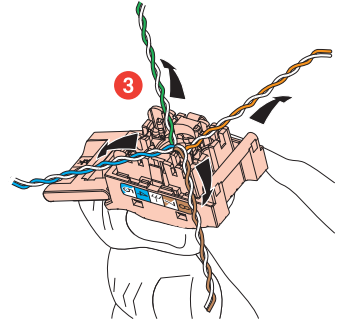
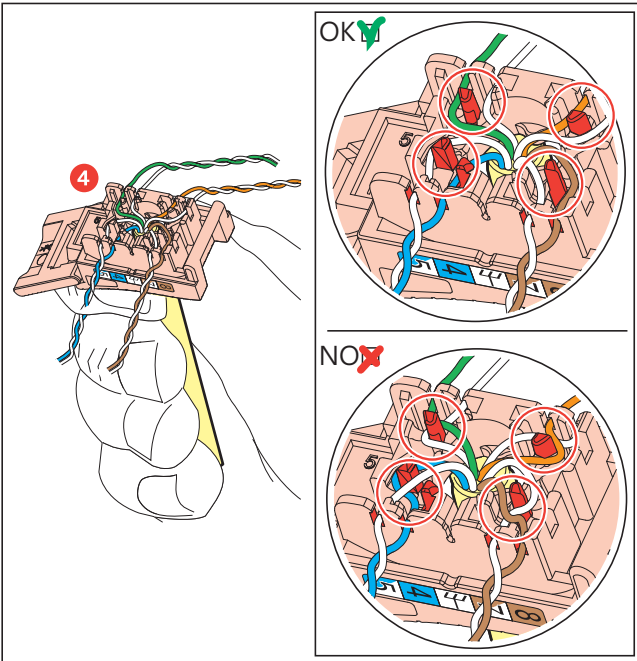
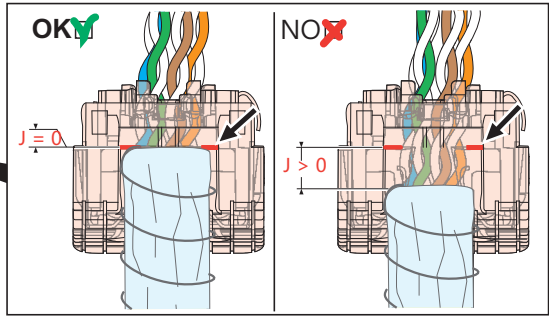
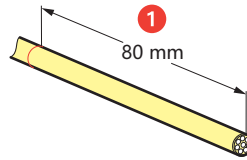
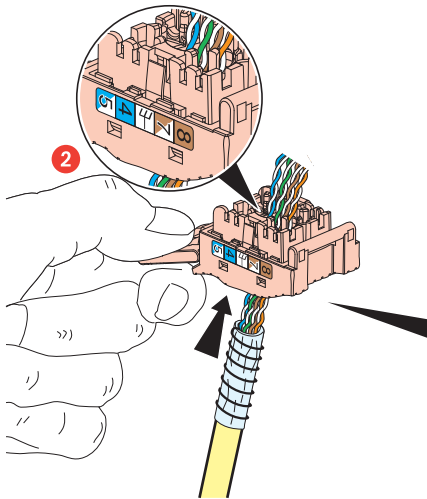

- FERMETURE connecteur STP
- De connector STP sluiten
- Closing the STP connector
- Schließen STP-Stecker

- Cierre conector STP
- Fecho de conector STP
- Zamknięcie złącza STP
- Закрыццё раз'язема STP

- 关闭STP连接头
- غلق الموصل STP

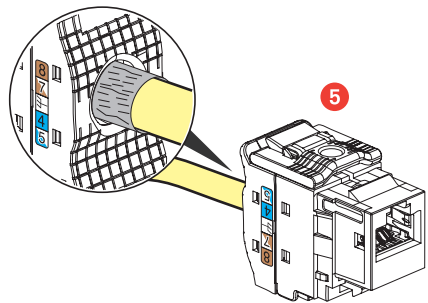
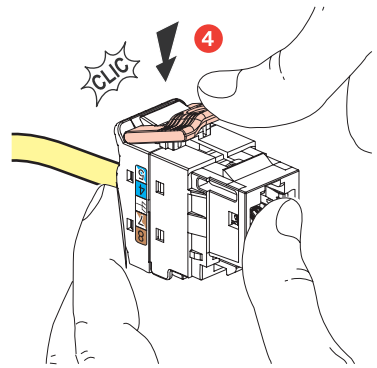
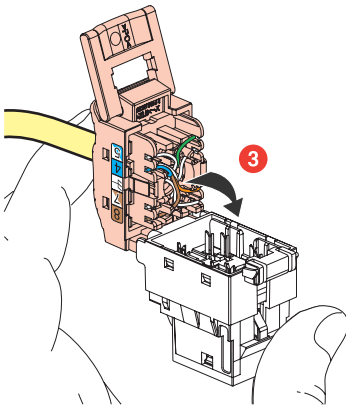
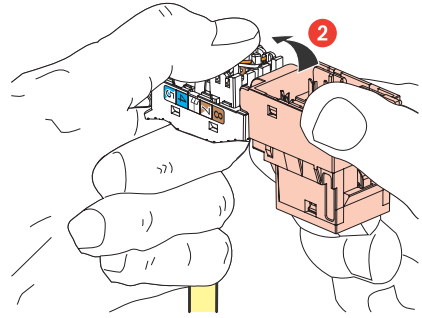
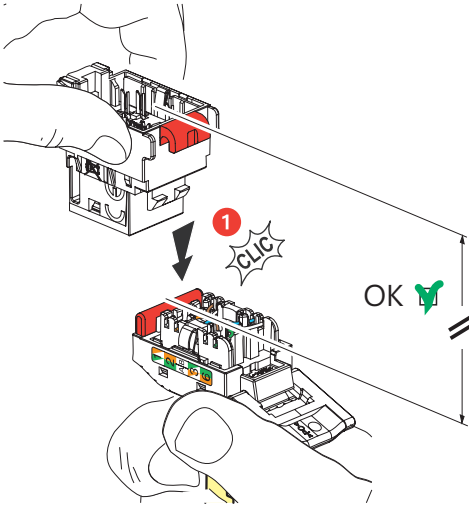

⚠ Consignes de sécurité  
Avant toute intervention, couper le courant.  
Respecter strictement les conditions d'installation et d'utilisation.

FR · ID · HE · CH

⚠ Consignas de seguridad  
Antes de realizar cualquier intervención, cortar la corriente eléctrica.  
Respetar estrictamente las condiciones de instalación y uso.

ES

⚠ 安全提示  
在任何干涉以前一定要断电，严格遵守安全和使用的规定。

⚠ إرشادات الأمان:

«القطع التيار الكهربائي قبل أي تدخل. تفتية تقيماً تأماً بشروط التركيب والاستخدام.»

⚠ Veiligheidsvoorschriften  
Onderbreek voor enige ingreep de stroom.  
Neem de installatie- en gebruiksvoorwaarden nauwgezet in acht.

NL · BE

⚠ Instruções de segurança  
Antes de qualquer intervenção, desligar a corrente.  
Respetar rigorosamente as condições de instalação e de utilização.

PT

⚠ Safety instructions  
Make sure the power supply is disconnected before any intervention.  
Strictly comply with instructions for installation and use.

GB · IE

⚠ Przepisy bezpieczeństwa  
Przed każdą czynnością na urządzeniu, odłącz dopyły prąd.  
Ścisłe przestrzegać instrukcji dotyczących instalacji i użytkowania.

PL

⚠ Sicherheitshinweise  
Vor jeglichem Eingriff die Spannungsfreiheit sicherstellen.  
Einbau- und Gebrauchsanleitungen sind genau zu beachten.

DE · CH

⚠ Меры предосторожности  
Отключить питание перед проведением любых ремонтных работ.  
Строго соблюдайте требования к условиям монтажа и эксплуатации.

RU