

Plug & Play Gateway
1 991 00

The Plug & Play Gateway makes it easy to connect all connected solutions «with Netatmo» and Zigbee 3.0 lighting. It plugs into an existing power socket and simply connects to the Wi-Fi network of your internet router

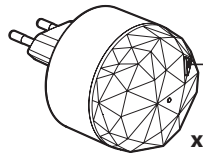

> Pack composition



Configuration button
Plug & Play Gateway
Frequency band: 2.4 to 2.4835 GHz
Power level: < 100 mW

> Installation steps

1 Plug the gateway into an easily accessible protected socket with a maximum 16 A circuit breaker.

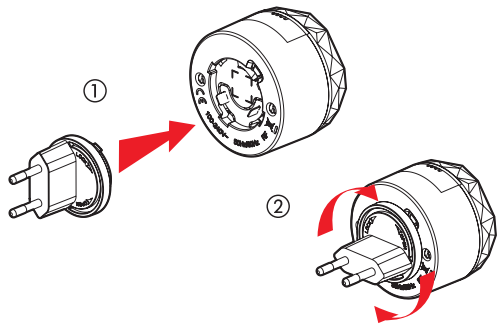

2 Download the Home + Control App and follow the instructions to add wired and wireless products to your installation.

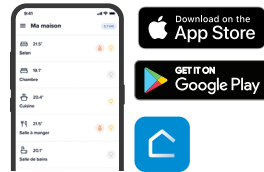

3 You are ready to control your installation via a vocal assistant and can customise your scenarios via the Home + Control App.



> Complete your installation:

Your Legrand connected installation is scalable. You can easily add all Legrand connected solutions (to be found on legrand.com), Netatmo products or even Zigbee 3.0 certified lighting products from other brands. And so, customise your scenarios and schedules via the Home + Control App.

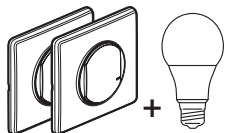

Extension pack
Céliane 1 991 30/31/32/33
Valena Life 1 993 20/21/22/23
Valena Next
1 992 20/21/22/23/24/25



2 ways wireless lighting control
Céliane 0 677 24/74 - 0 648 94
Valena Life 7 52x 87 - 7 563 87
Valena Next 7 418 12/42/72

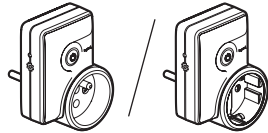

Standard French-Belgian mobile socket
0 648 87

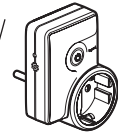

German standard mobile socket
0 648 40

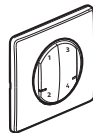

4 scenes
Céliane 0 677 55/56/57
Valena Life 7 52x 68 - 7 563 68
Valena Next 7 418 02/32/62

> Reset process

To reset your Plug & Play Gateway, press and hold the «Configuration» button on the Plug & Play Gateway until it lights up steady orange, then release the button. The Plug & Play Gateway then starts its reinitialization as well as that of the products attached to it (excluding battery-operated products), this can take several minutes. The Plug & Play Gateway will light up pink to indicate that the reset operation is complete.

Your Home + Control App will notify you of a disconnection from your Plug & Play Gateway.

This notification is likely to occur within 20 minutes of resetting your Plug & Play Gateway.

About Zigbee 3.0

Zigbee is a communication protocol that allows connected products (lighting, lighting controls, plugs, roller shutter control...) certified Zigbee 3.0 to communicate and work together. To check if a lighting is Zigbee 3.0 certified and therefore compatible with your «with Netatmo» connected starter pack look for the logo **zigbee** on the packaging or on the product's manual. You can also consult the list of all Zigbee 3.0 certified products at the following address: <https://csa-iot.org>
If you already have Zigbee 3.0 certified products that have their own connected bridge, consider resetting them to be able to use them with your «with Netatmo» connected starter pack. Refer to your products' manuals for the reset procedure



www.legrand.fr/reference/199100

LEGRAND - Pro and Consumer Service - BP 30076
87002 LIMOGES CEDEX FRANCE • www.legrand.com

SIMPLIFIED EU DECLARATION OF CONFORMITY

The undersigned,

Legrand

declares that the radio-electric equipment referred to in these instructions complies with directive 2014/53/EU.

www.legrandoc.com

⚠ Safety instructions

This product should be installed in compliance with installation rules, preferably by a qualified electrician. Incorrect installation and/or incorrect use can lead to risk of electric shock or fire. Before carrying out the installation, read the instructions and take account of the product's specific mounting location. Do not open up, dismantle, alter or modify the device except where specifically required to do so by the instructions. All **Legrand** products must be opened and repaired exclusively by personnel trained and approved by **Legrand**. Any unauthorised opening or repair completely cancels all liabilities and the rights to replacement and guarantees. Use only **Legrand** brand accessories.

Apple HomeKit: When you install the iOS mobile application, you will be asked for this code

Unique Apple HomeKit installation code to be kept