

Requires the installation of a:

Gateway module

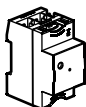

OR

Connected Starter Pack
"... with Netatmo"



OR

Any kind of
"with Netatmo"
gateway

Load shedding function compatible with :

Socket outlet, cable outlet, connected contactors and dry contacts
from « ... with Netatmo » range



Socket outlet



Cable outlet



Mobile socket outlet

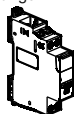

Connected contactor

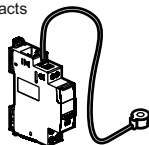

Connected dry contact

N.B. The installation of at least one of these products is necessary to the operating of the smart load shedder.

Composition

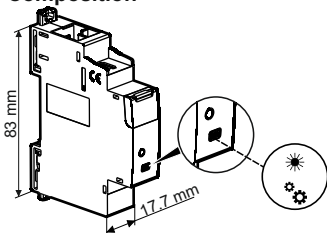

Smart load shedder

+

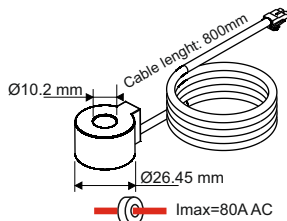

Pay attention to the direction of the current

Measure coil

	U	I measured	F 	Accuracy 	Shedding
+5°C +45°C	100-240V~ 50 / 60Hz	80A MAX	2.4 à 2,4835Ghz <100 mW	+/-1% under 63A	

CE Directive
Compliant with the following European directive:

Low voltage directive
(LVD) 2014/35/UE

Electromagnetic compatibility
(CEM) n° 2014/30/UE

Imperative security precaution



The instructions for installation and use must be strictly observed in order to avoid the risk of electric shock or fire.

1 Preparation, connection



Turn off the power at general circuit breaker

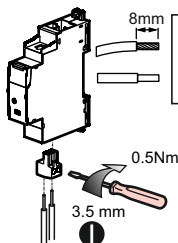
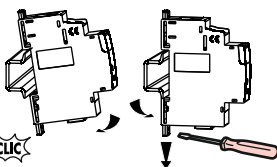

V1, N:
MAX
2x 1.5mm²
1.5mm²

Wiring

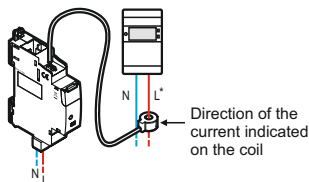
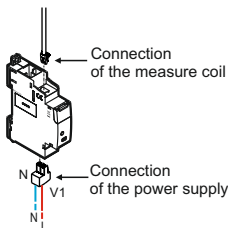

A circuit breaker with rated current C2 to C16 is necessary depending on wire section used for supplying the smart load shedder.

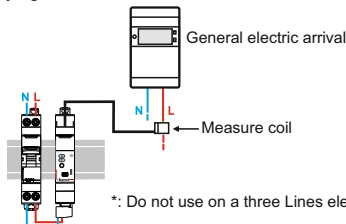

*: Do not use on a three Lines electrical installation.

If the product is not wired on the phase it is tracking consumption from, the product will flash in orange.

— N (neutral) = blue

— L (Line) = Everything but blue and green/yellow

2 Add the **Smart load shedder** in a connected installation

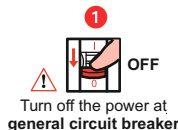

Turn off the power at the general circuit breaker

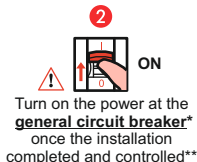

Turn on the power at the general circuit breaker* once the installation completed and controlled**

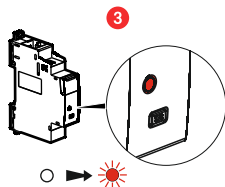

* In order to restart all connected products at the same time.

** After wiring the installation, refit the front plate so that no active live part is accessible.

3 Finalize the installation in the Legrand Home + Control app

Download the Home + Control App and follow the instructions for adding the connected product in your setup.

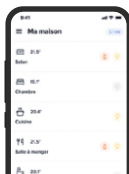

You also have the option of controlling your installation via a voice assistant and can customize your scenarios via the Home + Control App.



Reset a Smart load shedder to remove it from a connected installation

Press the configuration button of the Smart load shedder (> 5 seconds) until the configuration indicator lights up in fixed red. It is no longer associated with the Gateway present in the installation.

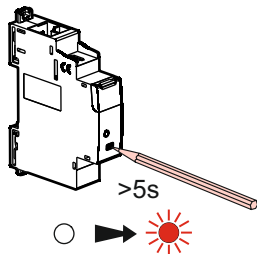



www.legrand.fr/reference/412172

LEGRAND - Pro and Consumer Service - BP 30076
87002 LIMOGES CEDEX FRANCE • www.legrand.com

UE SIMPLIFIED DECLARATION OF CONFORMITY

The undersigned,

Legrand

declares that the radio equipment listed on this instruction sheet
are compliant to the directive 2014/53/UE.

The full text of the UE declaration of conformity
is available at the following website:

www.legrandoc.com