

# RJ45, RJ11 socket

2 811 58xx/2 811 59xx/2 811 60xx/2 811 61xx/2 811 62xx

xx:MW MB MG DS DB CH BA BB BC

2 811 63xx/2 811 64xx/2 811 65xx/2 811 66xx

yy:MY SG

2 811 58xx yy/2 811 59xx yy/2 811 60xx yy/2 811 61xx yy/2 811 62xx yy

2 811 63xx yy/2 811 64xx yy/2 811 65xx yy/2 811 66xx yy



## Safety instructions

GB CA IN IE US SG

This product should be installed in compliance with installation rules, preferably by a qualified electrician.

Before carrying out the installation, read the instructions and take account of the product's specific mounting location.

Do not open up, dismantle, alter or modify the device except where specifically required to do so by the instructions.

All Legrand products must be opened and repaired exclusively by personnel trained and approved by Legrand. Any unauthorised opening or repair completely cancels all liabilities and the rights to replacement and guarantees.

Use only Legrand brand accessories.

## Presentation

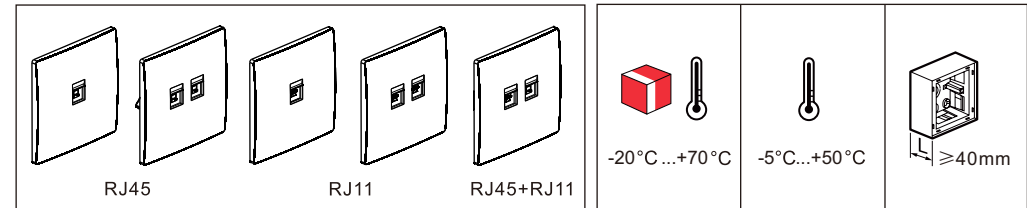

## Wiring

RJ45 socket

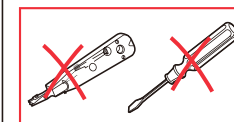
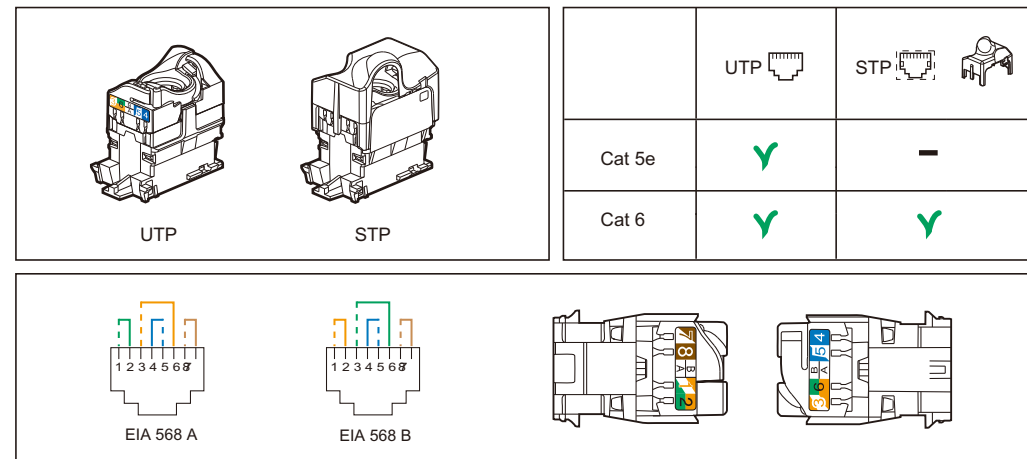

1 Peel off outer sheath about 50mm in length.

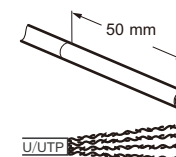

2 Turn the lock according to the direction shown in the diagram to separate the cover.

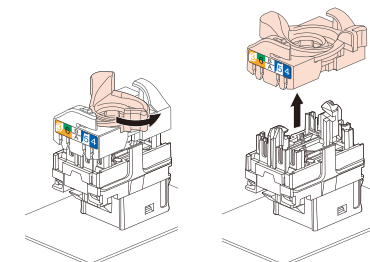

- ③ Insert the twisted pair and press all the wires into the presser cover in turn according to EIA568A or EIA568B.

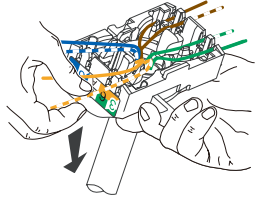

- ④ Reconnect the cover with the module and rotate the lock to the locking position.

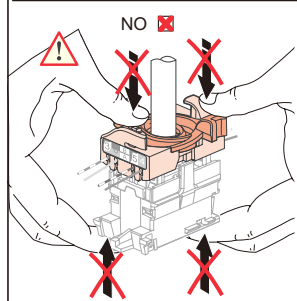
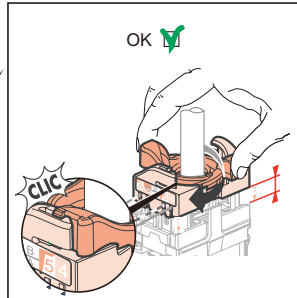
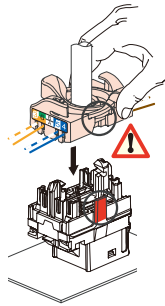

- ⑤ Cut out the excess thread.

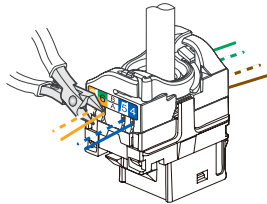

STP

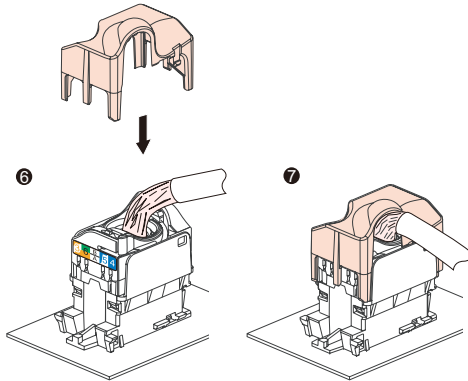

When removing, gently pry open the cover with a small screwdriver in the shown position.

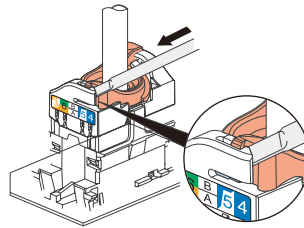

RJ11 socket

- ① Strip the outer sheath of the telephoneline to about 20mm.

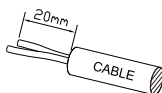

- ② When using a 2-core phone line connection, insert the phone line into the 4, 5 slots in the middle of the IDC terminal and then flip the cover.

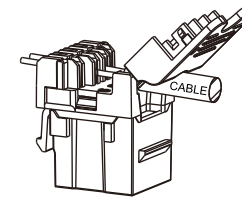

- ③ When using 4-core phone line connection, the telephone line is stuck into 3, 4, 5 and 6 slots in the order of black, red, green and yellow respectively, and then flip the cover.

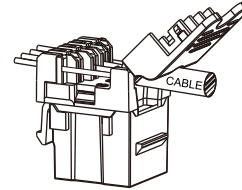

Press the cover and let the wire into the clip, cut the excess ends.

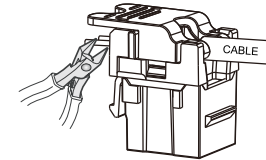

Remove the wire, push the wire and then pull up.

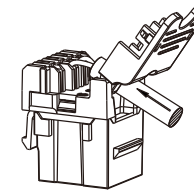

Installation

