

Requires the installation of a:

Gateway module

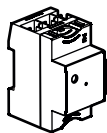

/

OR

/

Any kind of
"with Netatmo"
gateway

Composition

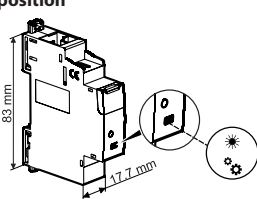

Connected energy meter

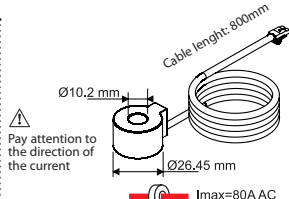

Measure coil

	U	I measure	F	Accuracy	Measure	Measure
				kWh	kWh	kWh
+5°C +45°C	100-240V~ 50/60Hz	80A MAX	2,4-2,4835Ghz <100 mW	+/-1% under 63A	Global or Per circuit	PV Production

CE Directive
Compliant with the following European
directive:

Low voltage directive
(LVD) 2014/35/UE

Electromagnetic compatibility
(CEM) n° 2014/30/UE

Safety instructions

This product should be installed in compliance with installation rules, preferably by a qualified electrician. Incorrect installation and/or incorrect use can lead to risk of electric shock or fire. Before carrying out the installation, read the instructions and take account of the product's specific mounting location. Do not open up, dismantle, alter or modify the device except where specifically required to do so by the instructions. All **Legrand** products must be opened and repaired exclusively by personnel trained and approved by **Legrand**. Any unauthorised opening or repair completely cancels all liabilities and the rights to replacement and guarantees. Use only **Legrand** brand accessories.



1 Preparation, connection



OFF

Turn off the power at
general circuit breaker

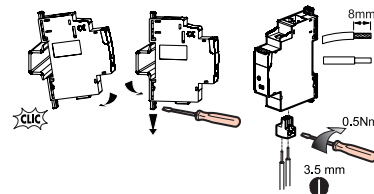

V1, N:
MAX
2x 1.5mm²
1.5mm²

ENERGY CONSUMPTION

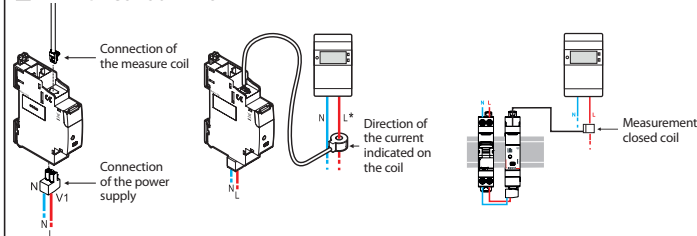

ENERGY PRODUCTION

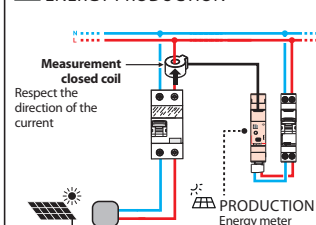

The energy meter cannot operate alone. It provides the measurement of photovoltaic panels (production part). The consumption measurement function must be ensured by a connected load-shedder or another single-phase energy meter "with Netatmo" (refer to technical documentation).

WARNING: This system is not compatible with installations that include a connected ecometer and/or storage batteries.

⚠ Measuring production: the coil that measures production must be positioned strictly upstream of the production section to measure only this data.

⚠ "Plug & play" panels: it is imperative to have a dedicated electrical line. The protection device must therefore only protect the panels.

The connected energy meter must be powered and protected by a suitable protection device, such as a circuit breaker rated C2 to C16 (depending on the section of cable used). If conditions allow, the existing electrical protections in the electrical panel can be reused for this purpose.

*: To be used only on a single-phase power line

— N (neutral) = blue

— L (phase) = everything but blue and green/yellow

2 Add the **Energy meter** to a connected installation

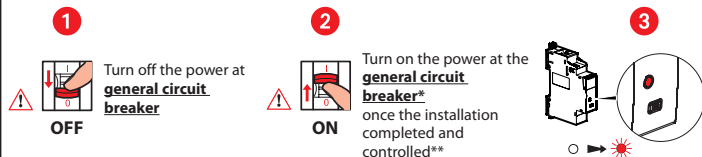

* In order to restart all connected products at the same time.

** After wiring the installation, refit the front plate so that no active live part is accessible.

3 Finalize the installation in the Legrand Home + Control app

Download the Home + Control App and follow the instructions for adding the connected product in your setup.

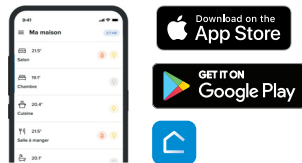

Reset an Energy meter to remove it from a connected installation.

Press the configuration button of the Energy meter (> 5 seconds) until the configuration indicator lights up in fixed red.

It is no longer associated with the gateway present in the installation.

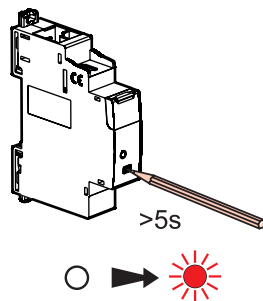

www.legrand.com/ecatalogue/

LEGRAND - Pro and Consumer Service - BP 30076
87002 LIMOGES CEDEX FRANCE • www.legrand.com

EU SIMPLIFIED DECLARATION OF CONFORMITY

The undersigned,

Legrand

declares that the radio equipment listed on this instruction sheet are compliant to the directive 2014/53/UE.

The full text of the UE declaration of conformity is available at the following website:

www.legrand.com/ecatalogue