

Connected switch

7 525 84 - 7 526 84 - 7 527 84 - 7 528 84 - 7 529 84



This pack is a connected accessory which **requires** you to buy and install the Valena Allure with Netatmo connected starter pack first.

Pack contents

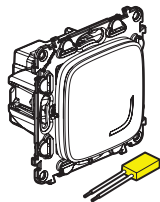

Connected switch
(with dimmer option)
+ bleeder

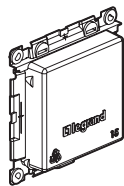

Site protection

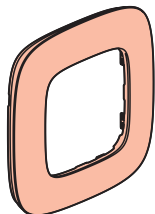

Finishing plate

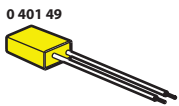

	100/240 V~
	50/60 Hz
	11 mA
	-5° C → +55° C

Characteristics

In default mode (on/off), this switch works with the following types of bulb :

Temperature +45°C +5°C	Switch type	Bulb type	LED Dimmable				Transformer
			LED	LED	LED	LED	
100-240 VAC 50/60 Hz	2 x 2,5 mm ²						
240 VAC	Max. Min.	300 W 7 W	(*)60 W 5 W	60 W 9 W	300 VA 10 VA	300 VA 35 VA	
100 VAC	Max. Min.	150 W 7 W	(*)30 W 5 W	30 W 9 W	150 VA 10 VA	150 VA 35 VA	

(*) or 10 bulbs max. For comfortable lighting, we recommend using bulbs of the same type and make.
(**) Using only transformers intended for operation with electronic switches. Take account of transformer losses for power calculations. Transformers should be charged to over 60% of their rated power.

In dimmer option operating mode (wich can be activated via the App), this switch functions only with dimmable bulbs (identifiable by the logo on packaging).



LE10674AA

Before you start: wiring precautions

If you plan to install two-way light switches or switched power outlets, read the following precautions:

To control a light **with two or more switches**, only use the products:

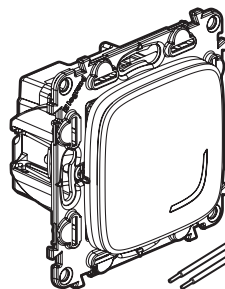

Connected switch (with dimmer option)
+ bleeder

AND

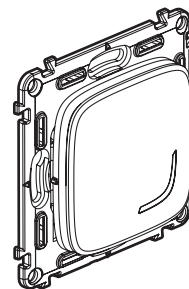

x 1
or several

Do not use: two connected switches (with dimmer option) to control the same lighting point.

Tip if replacing a two-way switch:
old flush-mounted switch replaced by the wireless switch.

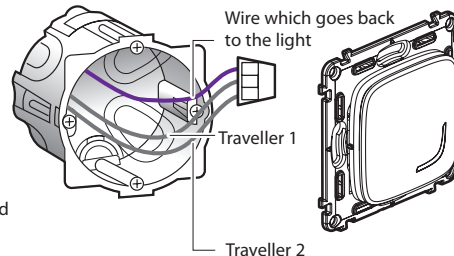

Use a **connector** to connect all 3 wires together (travellers 1 and 2 and lamp return wire).

1 Necessary safety precautions

1



OFF

Switch off the power at the main circuit breaker

2



Make sure that the power is off before continuing with the installation.

2 Install the connected switch (with dimmer option)

1

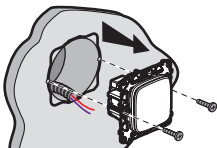

Remove the existing switch

3

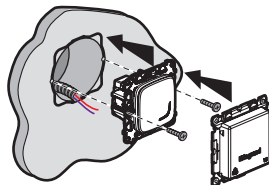

2 Wire the connected switch

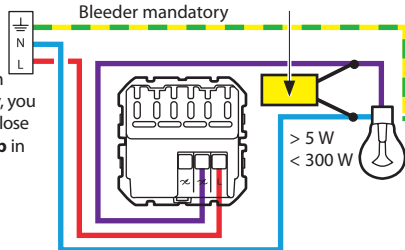

Frequency bands: 2.4 - 2.4835 GHz
Power level: < 100 mW

— N (neutral) = blue

— L (live) = any except blue and green/yellow

— \perp (earth) = green/yellow



The connected switch (with dimmer option) works with standard bulbs or dimmable bulbs including LEDs over 5 W. Using dimmable LEDs is recommended for optimal installation results.



If you have wired your bleeder but you are using non-dimmable LED bulbs, it

is possible that your bulbs will not go out fully or will flicker. If this is the case, refer to the table of recommended bulbs on the legrand.fr website.

3 To add a connected product to your connected installation, you should follow the instructions:

- in the **user guide in your connected starter pack**
- in the **Legrand Home + Control application (Settings/Add a new product section)**
- or consult the user manual on legrand.fr



www.legrand.fr

LEGRAND - Pro and Consumer Service - BP 30076
87002 LIMOGES CEDEX FRANCE • www.legrand.com

⚠ Safety instructions

This product should be installed in compliance with installation rules, preferably by a qualified electrician. Incorrect installation and/or incorrect use can lead to risk of electric shock or fire. Before carrying out the installation, read the instructions and take account of the product's specific mounting location. Do not open up, dismantle, alter or modify the device except where specifically required to do so by the instructions. All **Legrand** products must be opened and repaired exclusively by personnel trained and approved by **Legrand**. Any unauthorised opening or repair completely cancels all liabilities and the rights to replacement and guarantees. Use only **Legrand** brand accessories.

SIMPLIFIED EU DECLARATION OF CONFORMITY

The undersigned,

Legrand

declares that the radio-electric equipment referred to in these instructions complies with directive 2014/53/EU.

The full text of the EU declaration of conformity is available on the following website :

www.legrandoc.com