

This pack is a connected accessory which **requires** you to buy and install the Céliane with Netatmo connected starter pack first.

### Pack contents

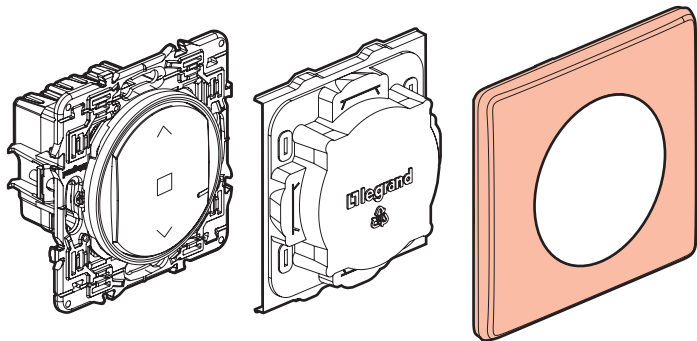

Connected roller shutter switch

Site protection

Finishing plate

### Characteristics

+45°C +5°C 100-240 VAC 50/60 Hz	1 x 2,5 mm <sup>2</sup> 2 x 1,5 mm <sup>2</sup>	①
100 VAC max.	1 x 270 VA	

① Roller shutter motor

LE10318AA

### Before you start

If you plan to install roller shutter switches, read the following precautions:

**To control a roller shutter switch with two or more wireless switches, only use the products:**

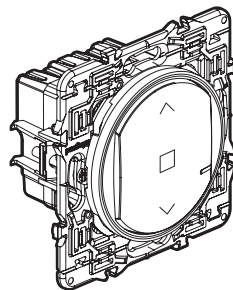

x 1

Connected roller shutter switch

AND

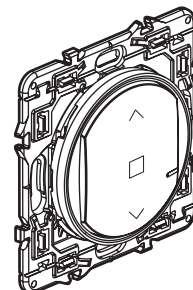

x 1  
or several

Roller shutters wireless switch  
(not included in this pack)

Ensure you have roller shutters wireless switches for each additional control point.

**To create a centralised control:**

- Use one or more connected roller shutter switches.
- Use a roller shutters wireless switch.

## 1 Necessary safety precautions

1

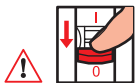

**OFF**

Switch off the power at the main circuit breaker

2



**Make sure that the power is off before continuing with the installation.**

## 2 Install the connected roller shutter switch

1

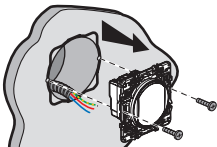

Remove the existing switch

3

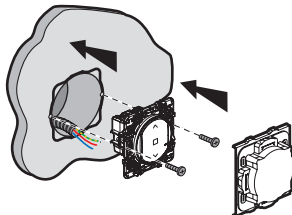

### 2 Wire the connected roller shutter switch

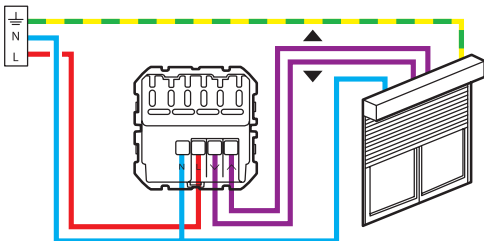

The Céliane with Netatmo solution is compatible with roller shutters with a mechanical or electronic stop, controlled by a standard wired roller shutter switch. They are not compatible with motors directly controlled by radio control. To check it, refer to the roller shutter instructions.

Frequency bands: 2.4 - 2.4835 GHz  
Power level: < 100 mW

— N (neutral) = blue  
— L (live) = any except blue and green/yellow  
— ⊥ (earth) = green/yellow

## 3 To add a connected product to your connected installation, you should follow the instructions:

- in the **user guide in your connected starter pack**
- in the **Legrand Home + Control application** (Settings/Add a new product section)
- or consult the user manual on **legrand.fr**



[www.legrand.fr](http://www.legrand.fr)

LEGRAND - Pro and Consumer Service - BP 30076  
87002 LIMOGES CEDEX FRANCE • [www.legrand.com](http://www.legrand.com)

### ⚠ Safety instructions

This product should be installed in compliance with installation rules, preferably by a qualified electrician. Incorrect installation and/or incorrect use can lead to risk of electric shock or fire. Before carrying out the installation, read the instructions and take account of the product's specific mounting location. Do not open up, dismantle, alter or modify the device except where specifically required to do so by the instructions. All **Legrand** products must be opened and repaired exclusively by personnel trained and approved by **Legrand**. Any unauthorised opening or repair completely cancels all liabilities and the rights to replacement and guarantees. Use only **Legrand** brand accessories.

## SIMPLIFIED EU DECLARATION OF CONFORMITY

The undersigned,  
**Legrand**

declares that the radio-electric equipment referred to in these instructions complies with directive 2014/53/EU.  
The full text of the EU declaration of conformity is available on the following website :

[www.legrandoc.com](http://www.legrandoc.com)