

• Installation and disassembly

The picture is only for reference, please make the object as the standard.
(when use this product, please install a fuse or protective device to protect the product in the line of fire (L) input, the protective device should be equal to 16A/250V.)

1. Disassembly

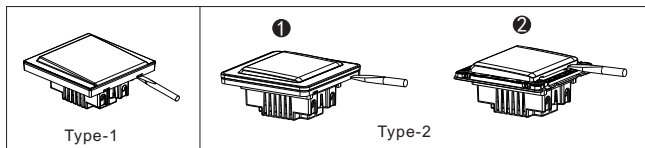

2. Finish wiring and fix the product into mounting box with screw.

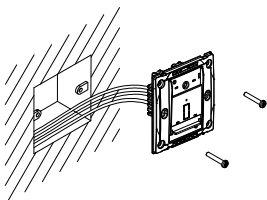

Note : the depth of mounting box $\geq 45\text{mm}$.

3. Assemble the front plate.

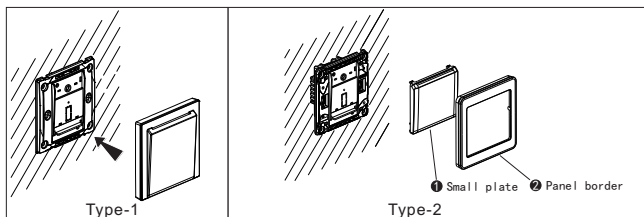

4. Note

The RF card can not be bended and deformed to avoid bad effect when reading card.

Keycard Switch



• Technical parameters

Rated voltage: 200-240V~ 50/60Hz

Rated current: 16A(resistive load)

Delay time: 30 \pm 1s(RF)

30 \pm 10s

• Card type

1. For normal keycard switch, use normal card.

2. For RF keycard switch, the card should comply with ISO-14443A protocol(Mifare_UltraLight;Mifare_One_S50;Mifare_One_S70;Mifare_Pro ; Mifare_DESFire and so on)

3. Size:85.5mmX54mm

• Wiring diagram

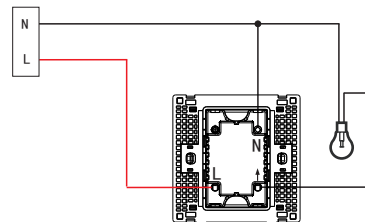

Note : Please strictly follow the wiring diagram so as not to damage the product.

• Operation

Insert card into the slot and then power on
(The card is not included in the Key Card Switch RFID product);
Remove this card, then the power will be off after about 30 seconds.

