

### • Wiring

Stripped off coaxial cable sheath

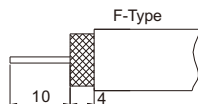
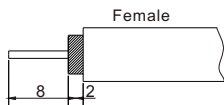

### • Connection

1

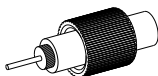

Combine the cap into the stripped cable and keep the tread outside.

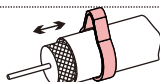

The accessory ferrule (supplied with the product)

2

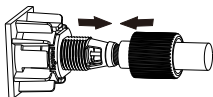

Insert the cable head in to the thread of TV socket and ensure the end of TV socket inside the isolation layer

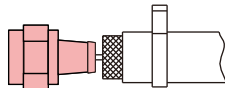

Insert the metal foil with the isolation layer into F hole (supplied with the product)

3

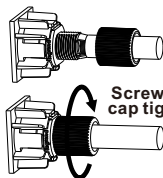

Screw the cap tightly

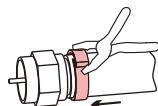

Push ferrule against the coaxial cable and crimp tightly with tools such as pliers

4

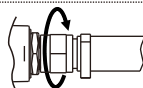

Insert the F hole with cable into the thread head of TV socket and screw tightly