

0 326 40

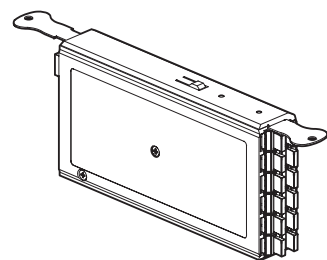

0 326 45/47

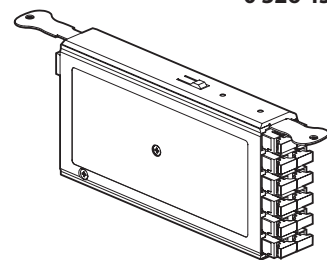

0 326 46/48

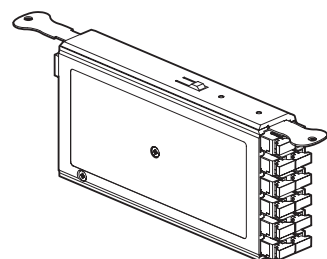

9 001 36

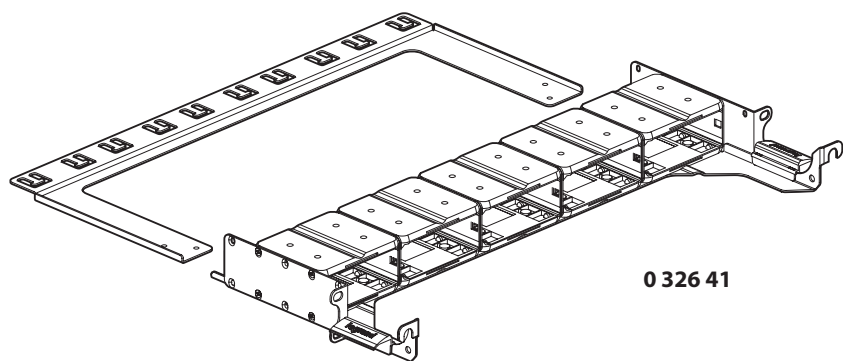

0 326 41



0 326 49

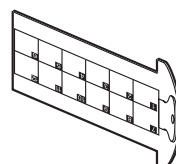

x 5 (0 326 40/41)
x 12 (0 326 42)

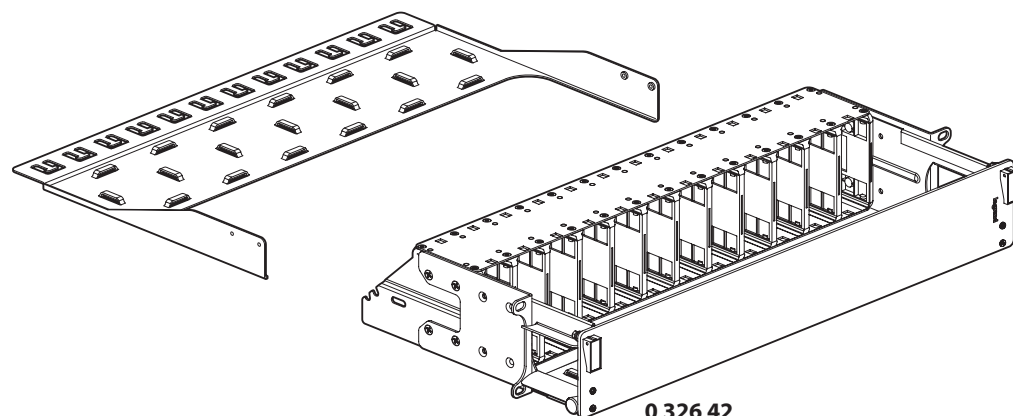

0 326 42



x 4



x 4



x 4

Method A (0 326 45/46)

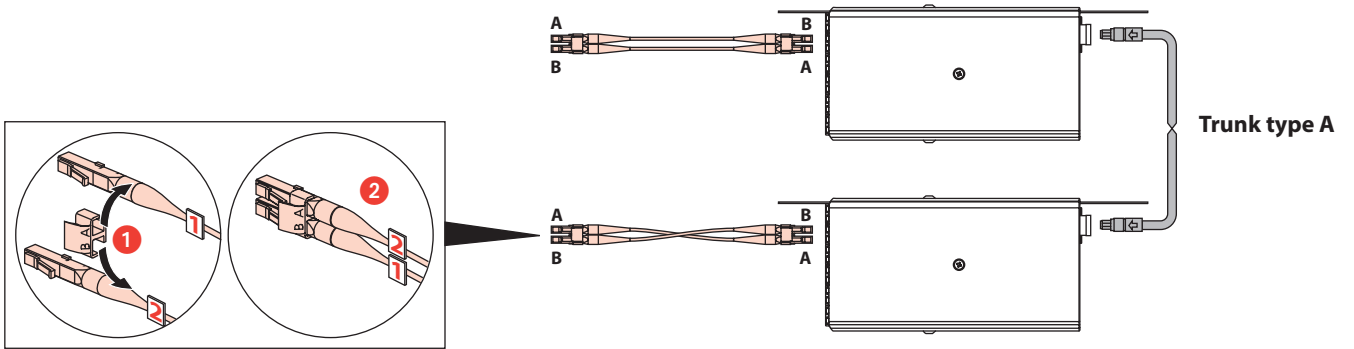

Method C (0 326 45/46)

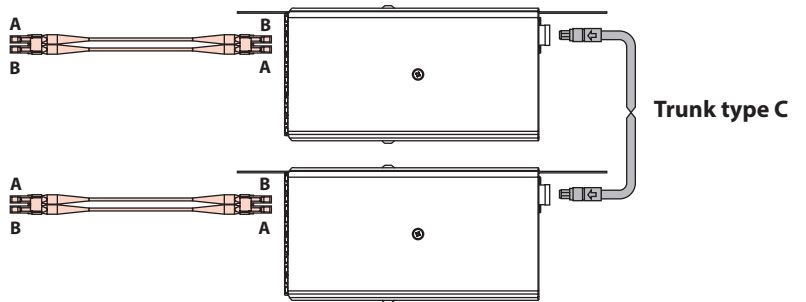

Method B (9 001 36) cassettes with polarity B on demand

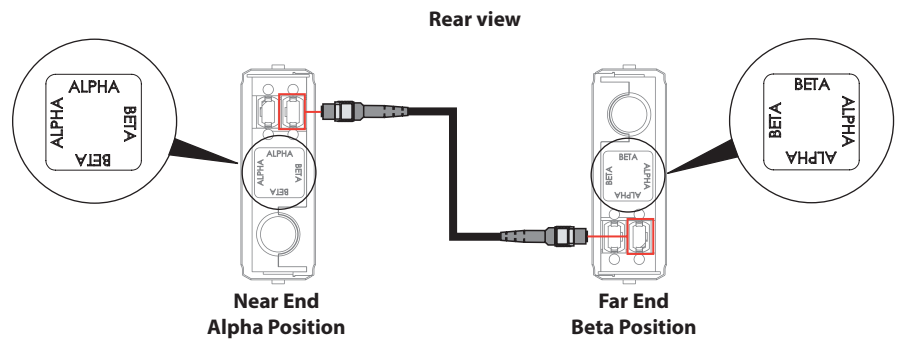
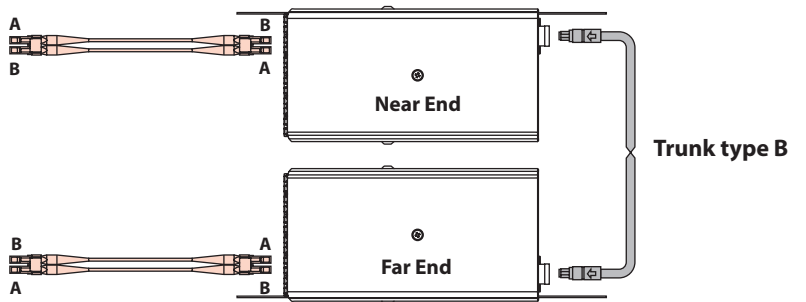

0 326 40

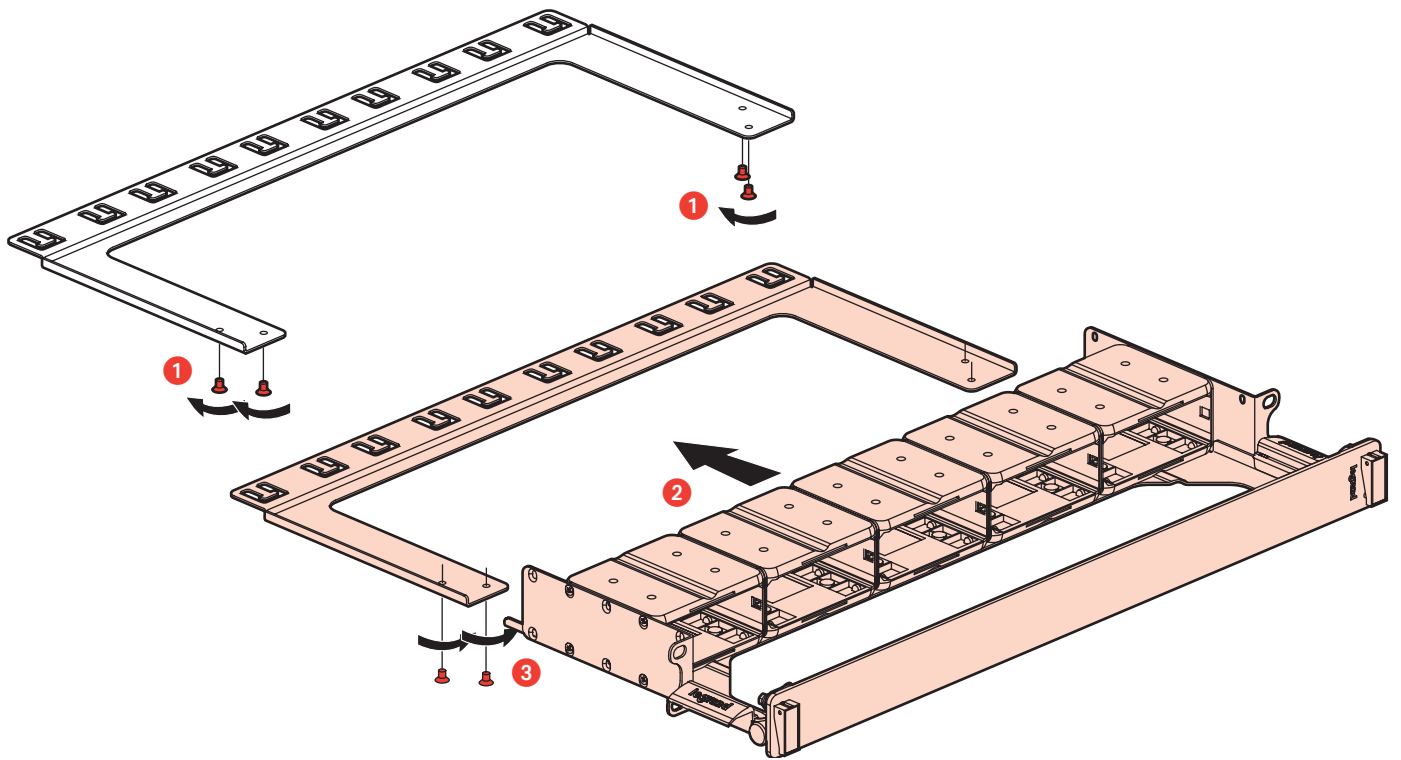

0 326 42

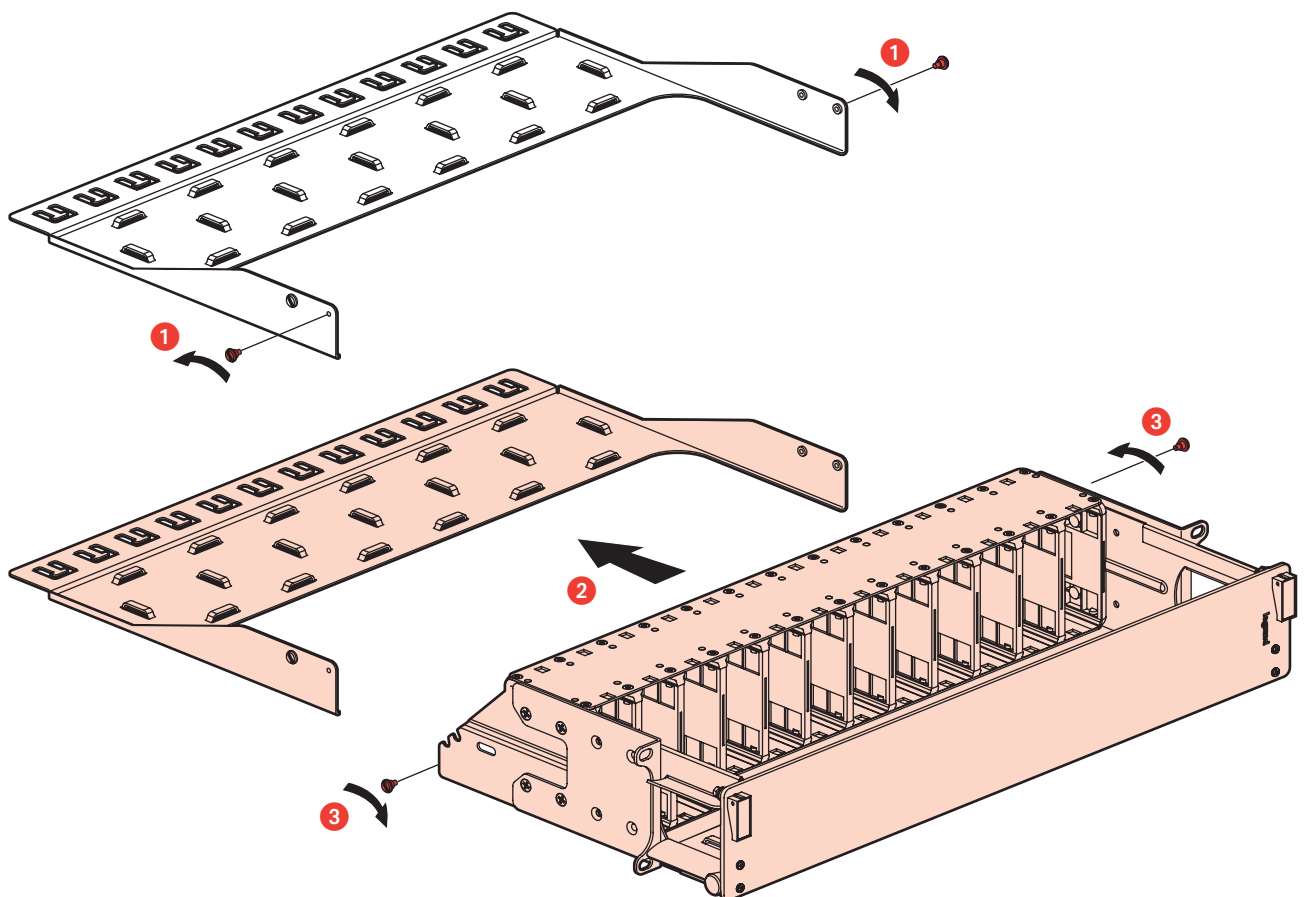

0 326 40

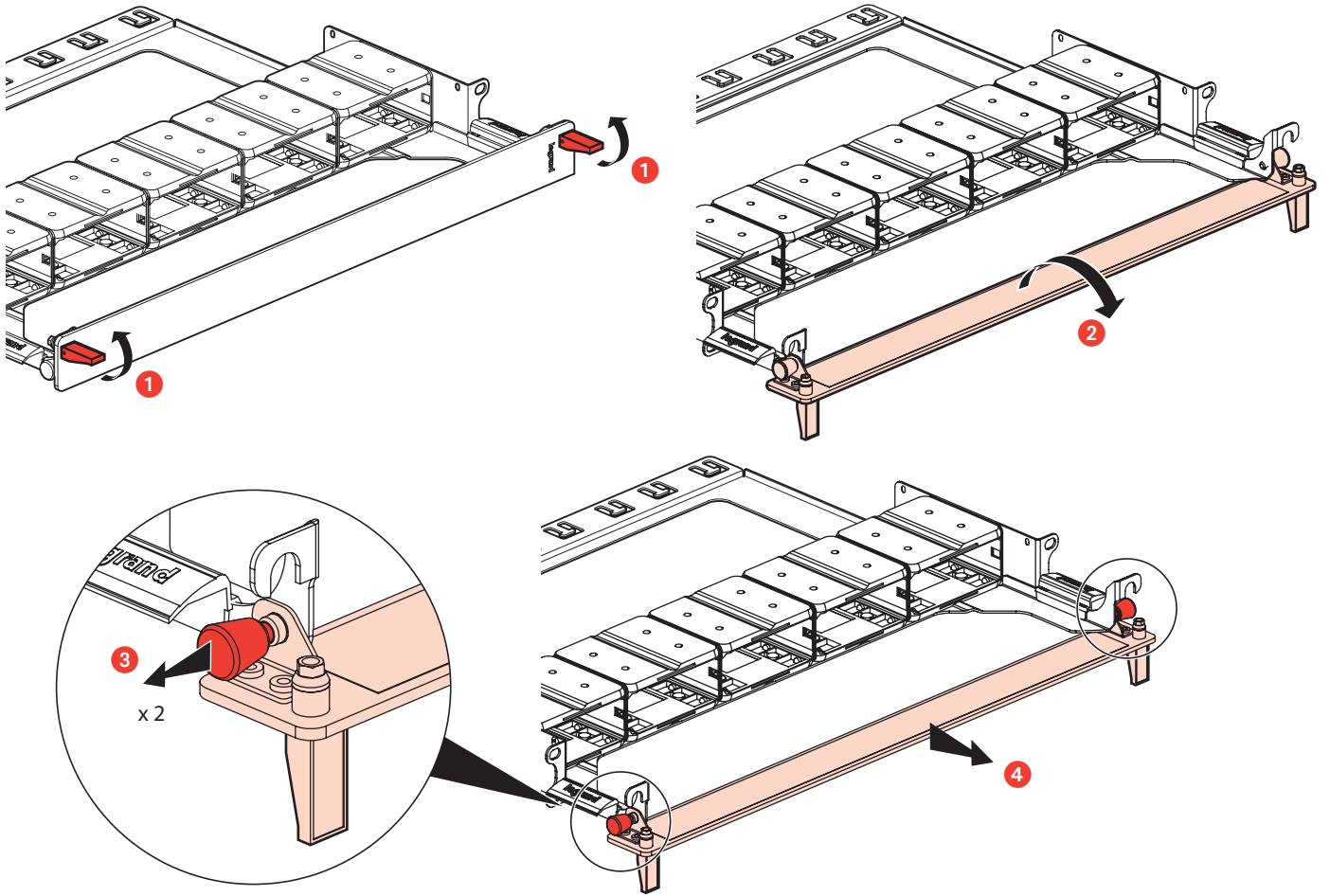

0 326 42

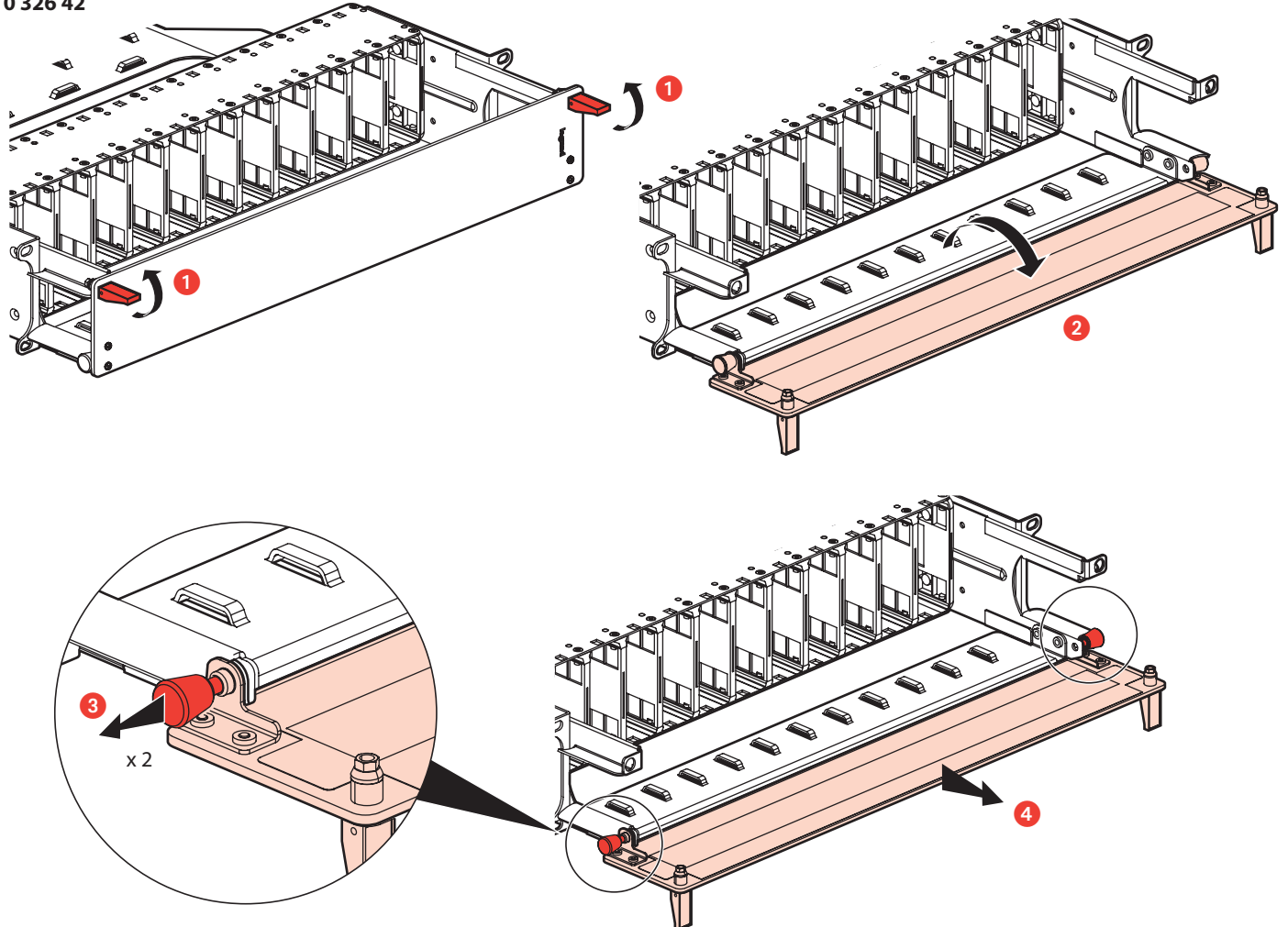

0 326 40

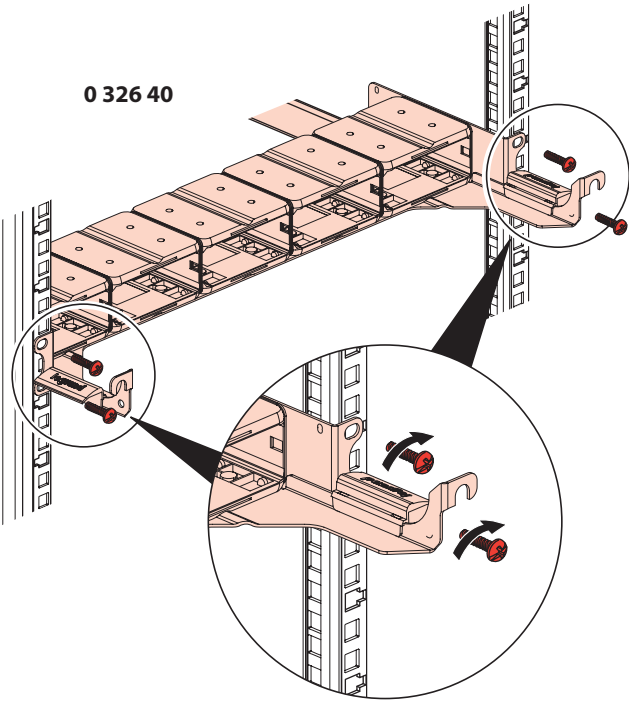

0 326 42

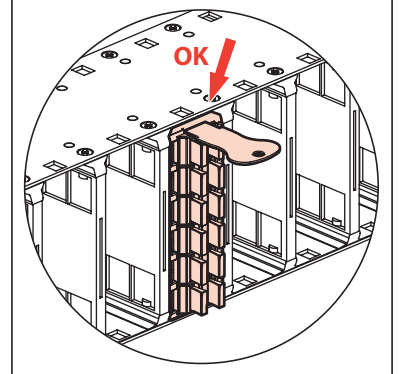
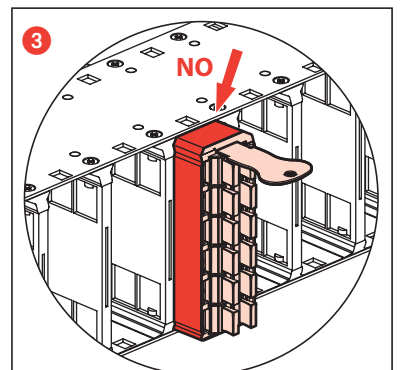
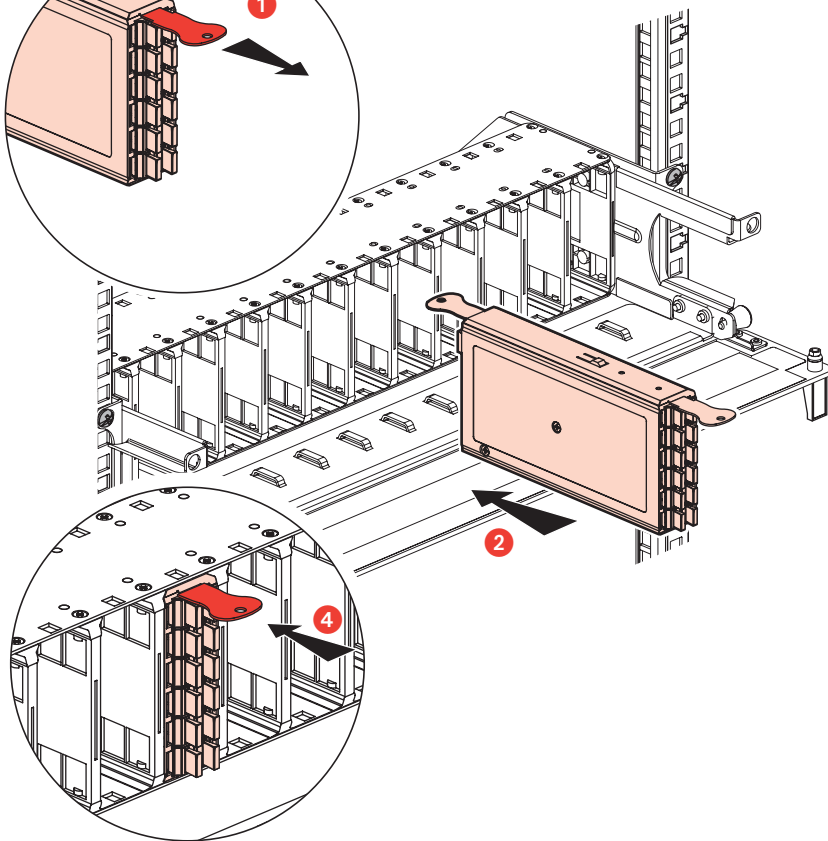
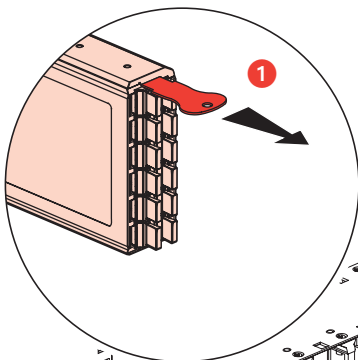
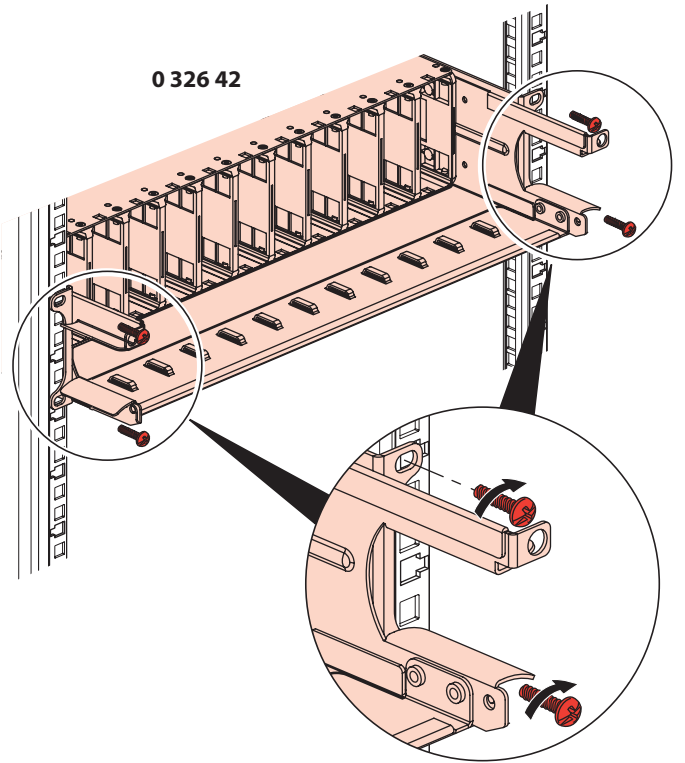

0 326 42

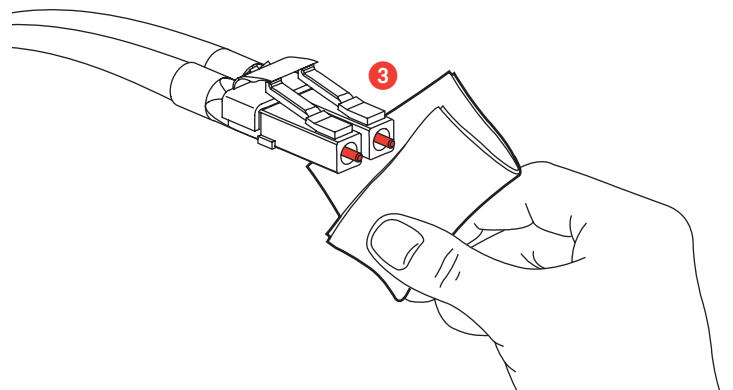
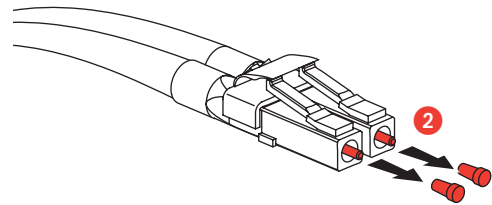
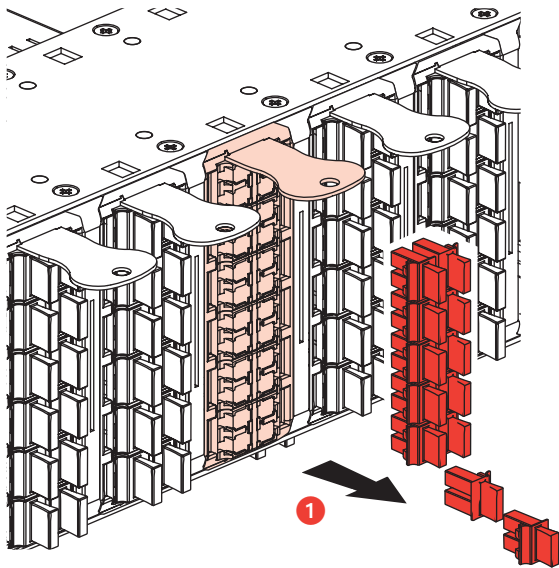
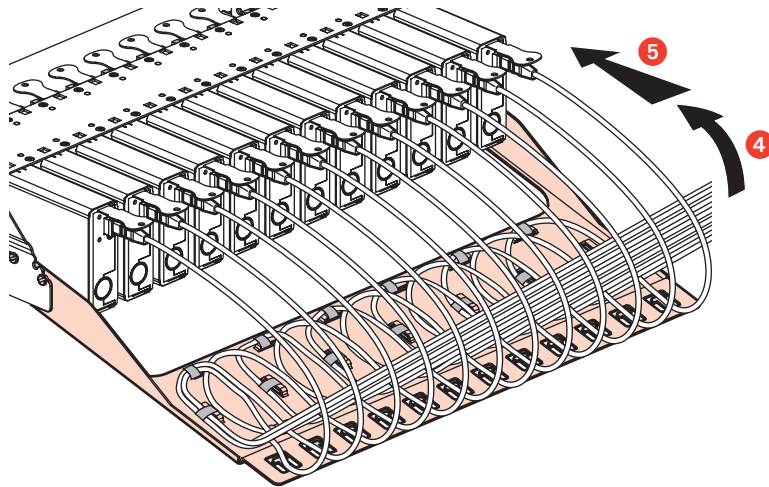
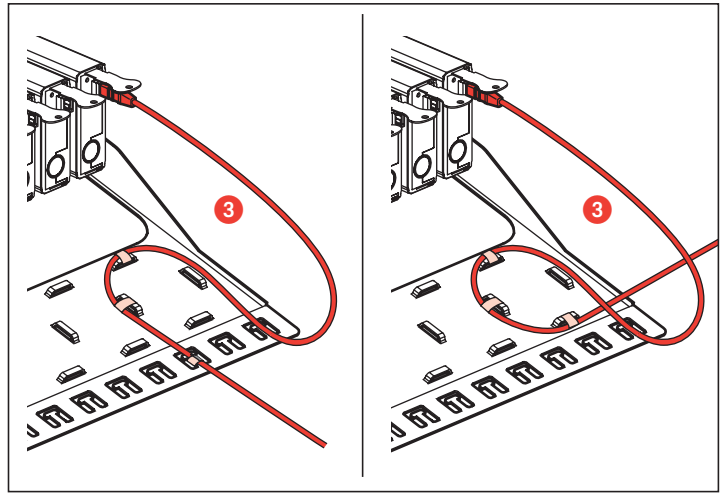
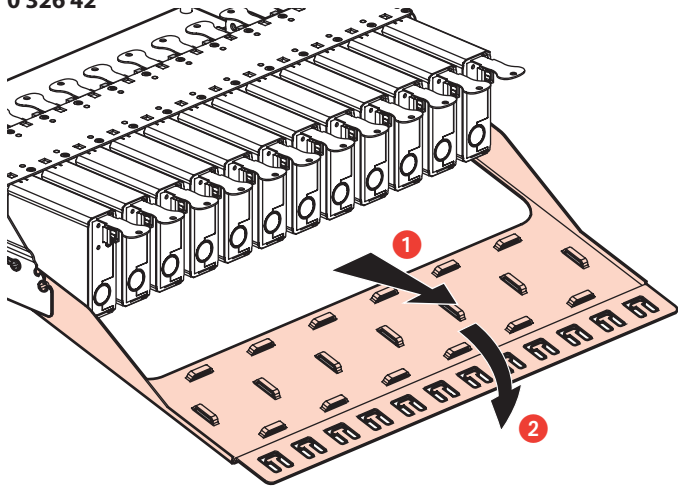

OK

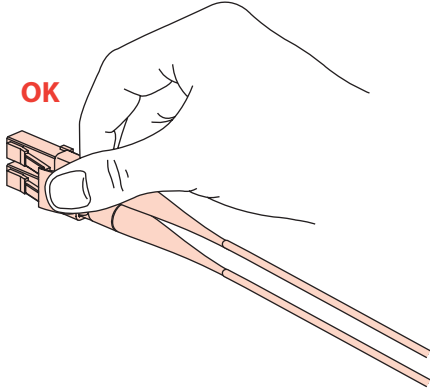

NO

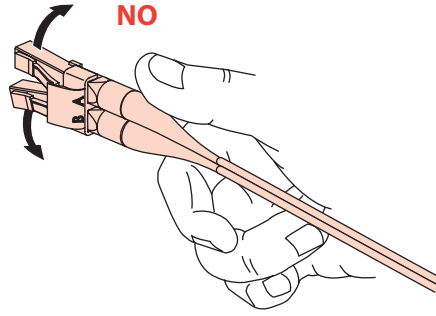

LC

SC

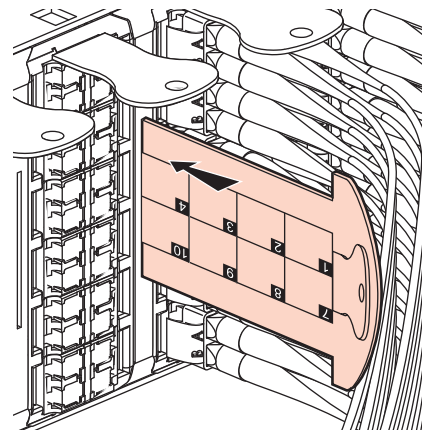
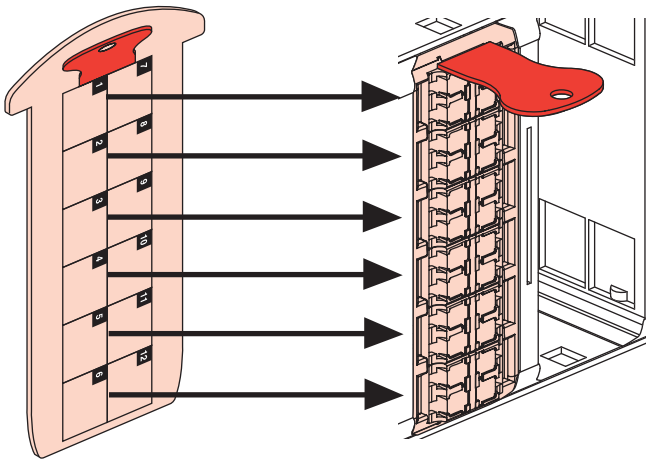
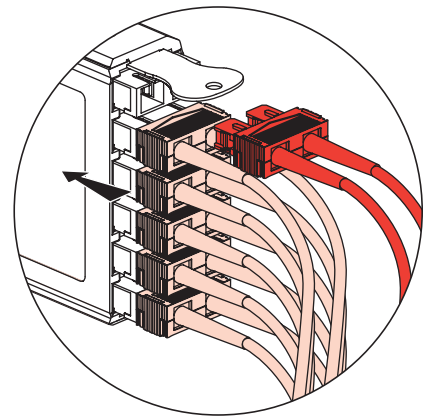
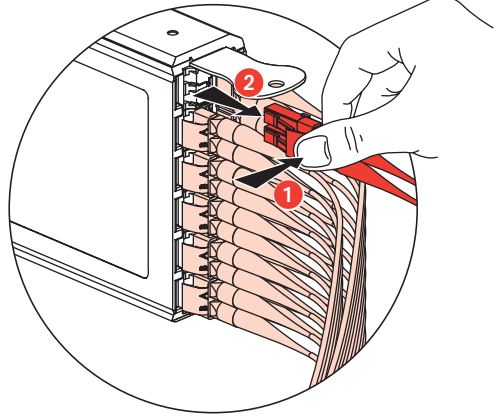
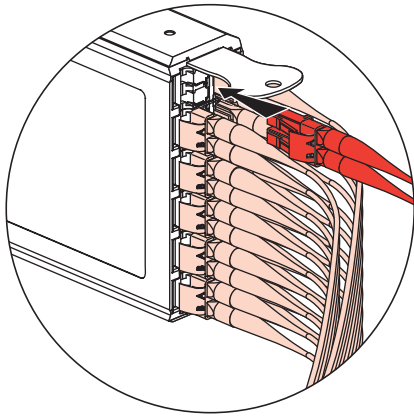

0 326 40

0 326 42

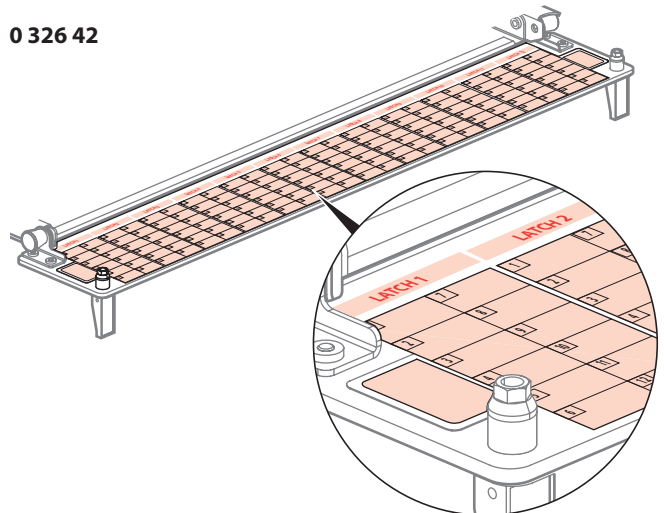
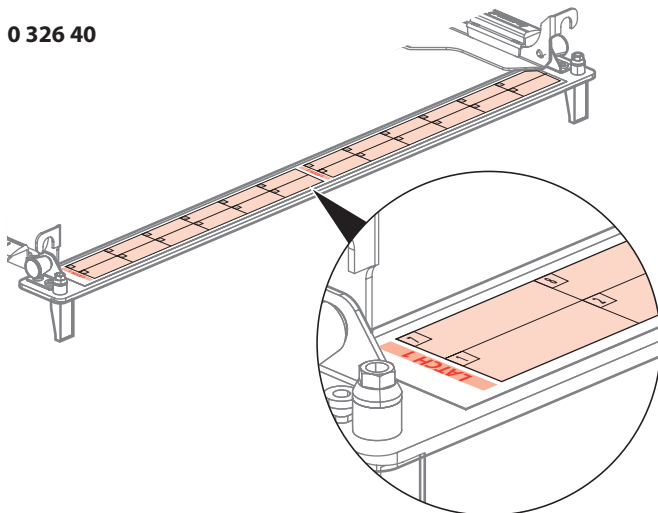

0 326 40

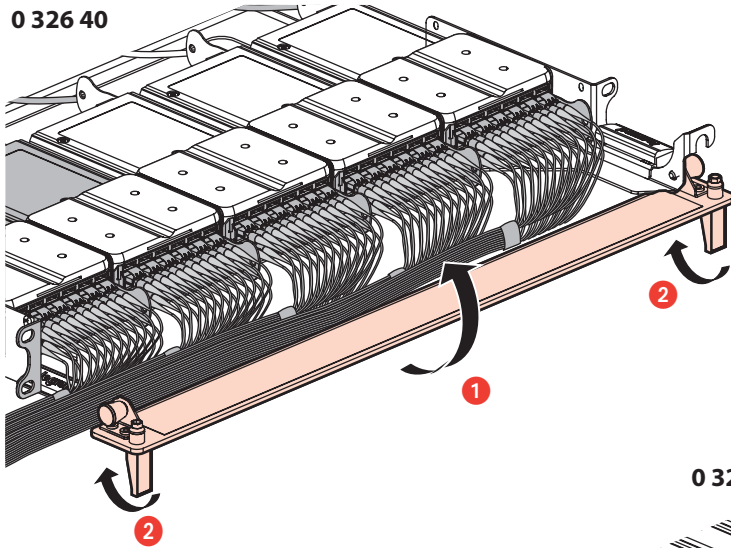

0 326 42

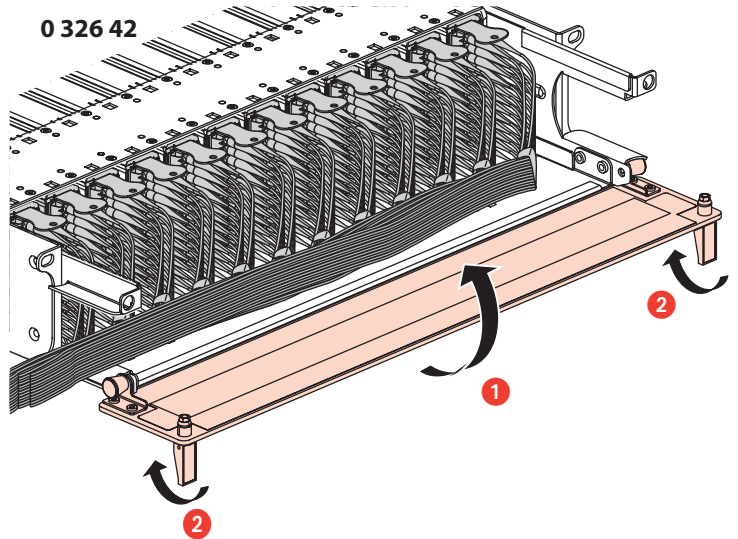

⚠ Consignes de sécurité

Avant toute intervention, couper le courant.
Respecter strictement les conditions d'installation et d'utilisation.

FR LU BE CH

⚠ Safety instructions

Make sure the power supply is disconnected before any intervention.
Strictly comply with instructions for installation and use.

GB IE

⚠ Sicherheitshinweise

Vor jeglichem Eingriff die Spannungsfreiheit sicherstellen.
Einbau- und Gebrauchsanleitungen sind genau zu beachten.

DE CH

⚠ Consignas de seguridad

Antes de realizar cualquier intervención, cortar la corriente eléctrica.
Respetar estrictamente las condiciones de instalación y uso.

ES

⚠ Instruções de segurança

Antes de qualquer intervenção, desligar a corrente.
Respeitar rigorosamente as condições de instalação e de utilização.

PT

⚠ Меры предосторожности

Отключить питание перед проведением любых ремонтных работ.
Строго соблюдайте требования к условиям монтажа и эксплуатации.

RU

⚠ Istruzioni di sicurezza

Prima di qualsiasi intervento, interrompere l'alimentazione.
Rispettare scrupolosamente le condizioni d'installazione e uso.

IT CH

⚠ إرشادات الأمان:
«اقطع التيار الكهربائي قبل أي تدخّل. تقيّد تقيداً تاماً بشروط التركيب والاستخدام.»