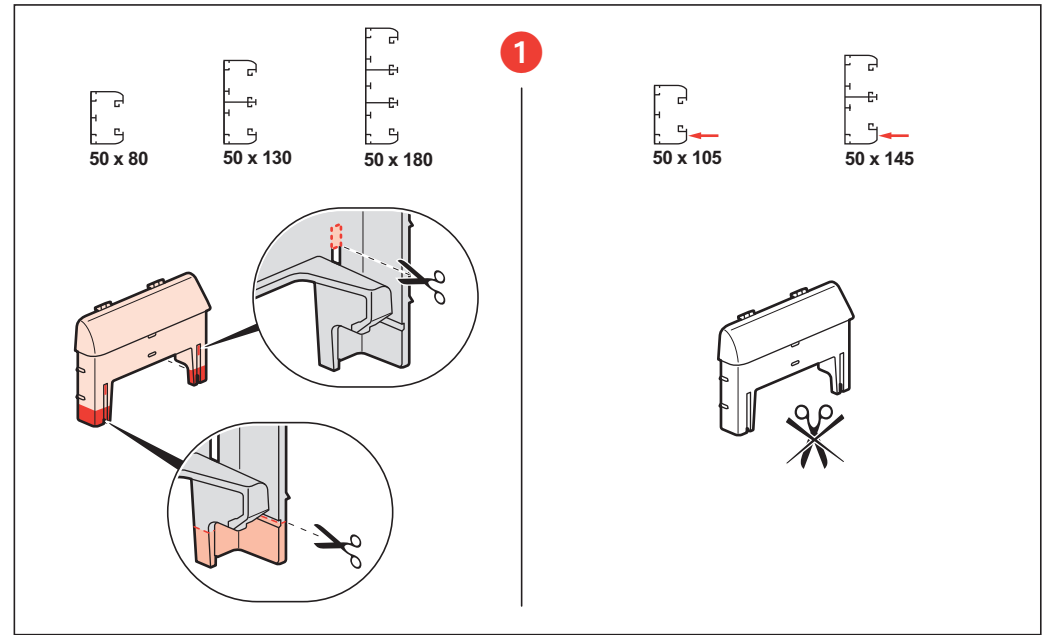
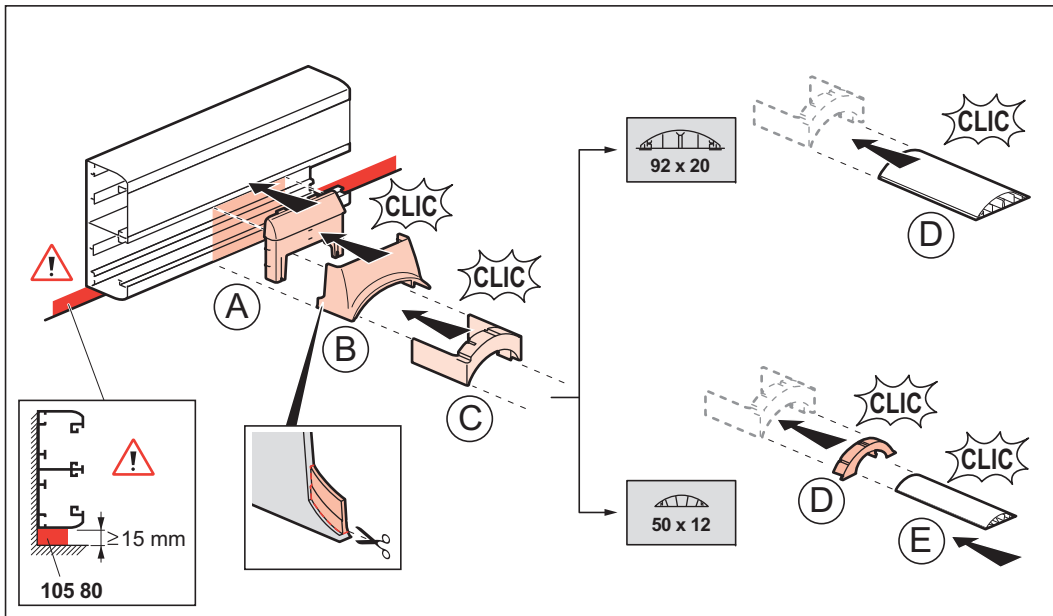

Diagram showing the components of the LED strip light assembly, including the main housing, end caps, and various lengths of the LED strip.

	A x B		
1	50 x 80 mm	756 01	756 88
	50 x 105 mm	756 02	756 88
2	50 x 130 mm	756 03	756 88
	50 x 145 mm	756 04	756 88
3	50 x 180 mm	756 06	756 88



Step 1: Preparing the LED strip. The strip is cut to the required length (50 x 80, 50 x 130, 50 x 180, 50 x 105, or 50 x 145 mm). The diagram shows the strip being inserted into the housing and secured with a clip.



Step 2: Mounting the LED strip. The strip is inserted into the housing and secured with a clip. The diagram shows the strip being inserted into the housing and secured with a clip. A warning symbol indicates that the strip should be inserted from the side.

Warning:  $\geq 15$  mm

105 80

92 x 20

50 x 12

CLIC

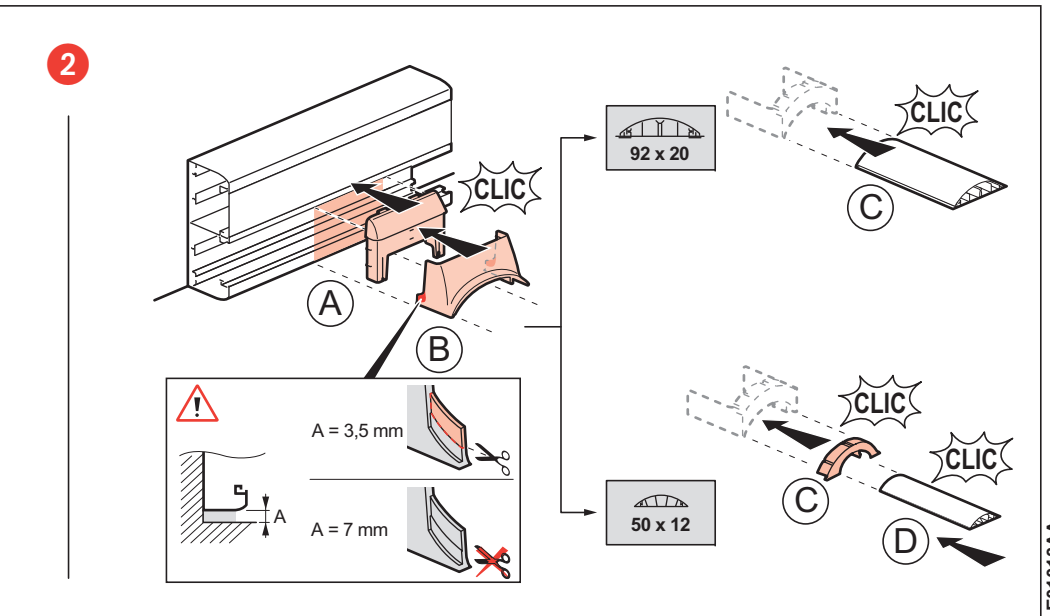

Step 2: Mounting the LED strip. The strip is inserted into the housing and secured with a clip. The diagram shows the strip being inserted into the housing and secured with a clip. A warning symbol indicates that the strip should be inserted from the side.

Warning:  $A = 3,5$  mm

Warning:  $A = 7$  mm

92 x 20

50 x 12

CLIC

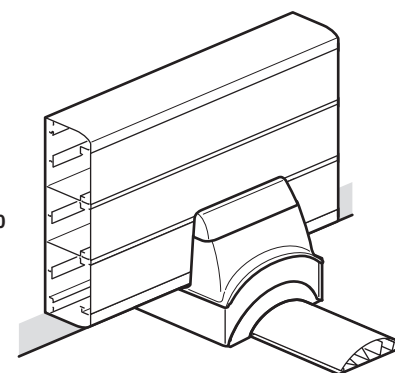
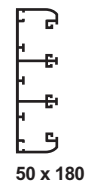
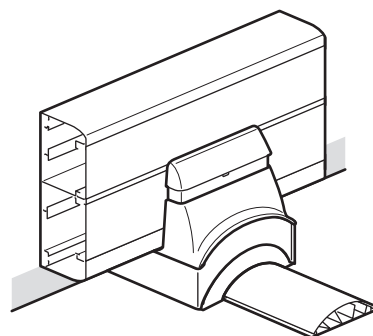
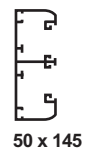
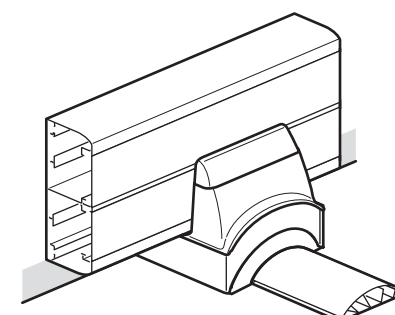
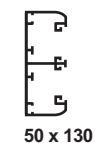
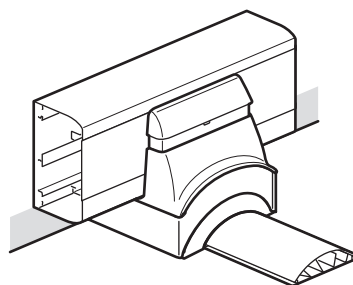
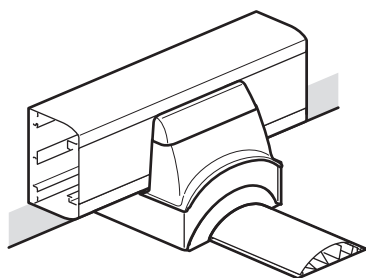
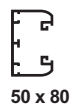
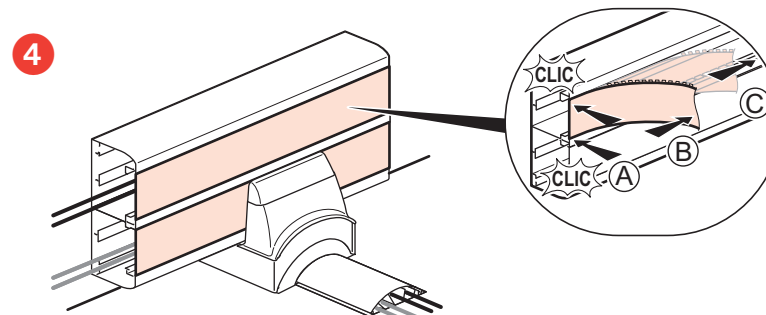
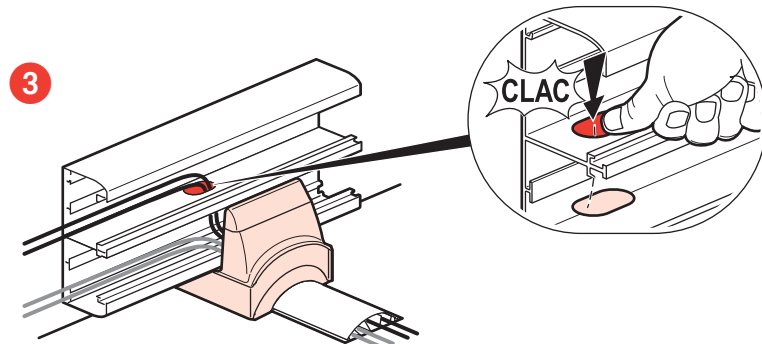

**FR LU BE** Respecter strictement les conditions d'installation et d'utilisation.  
**NL BE** Neem de installatie- en gebruiksvaarden nauwgezet in acht.  
**GB IE** Strictly comply with instructions for installation and use.  
**DE AT LI** Einbau- und Gebrauchsanleitungen sind genau zu beachten.  
**ES** Respetar estrictamente las condiciones de instalación y de utilización.  
**IT** Rispettare scrupolosamente le condizioni d'installazione e uso.

**PT** Respeitar estritamente as condições de instalação e de utilização.  
**GR CY** Τηρίστε αυστηρά τις συνθήκες εγκατάστασης και χρήσης.  
**PL** Ścisłe przestrzegać instrukcji dotyczących instalacji i użytkowania.  
**TR CY** Yerleşirme ve kullanım koşullarına titizlikle riayet ediniz.  
**HU** Tartsa be pontosan a beszerelési és használati feltételeket.  
**FI** Noudata asennus- ja käyttöohjeita tarkoin.

**SE** Iaktta noggrant installations- och användningsföreskrifterna.  
**CZ** Důsledně dodržujte instalační a uživatelské podmínky.  
**SK** Prísne dodržiavajte podmienky, za ktorých sa má prístroj inštalovať a používať.  
**SI** Natančno upoštevajte pogoje za montažo in uporabo.  
**DK** Installations- og anvendelsesbetingelserne skal overholdes nøje.  
**MT** Imxi skond l-istruzzjonijiet mogħtija għall-installazzjoni u l-użu.

**EE** Pidage täpselt kinni paigaldus-ja kasutamistingimustest.  
**LV** Stingri ievērot uzstādīšanas un lietošanas noteikumus.  
**LT** Griežtai laikytis instalavimo ir naudojimo sąlygų.  
**NO** Installasjons- og bruksbetingelsene må nøye overholdes.  
**IS** Fylgja skal vandlega öllum reglum um uppsetningu og notkun.