

P31 HS
Ceiling hanger/Suspente plafond

Reference(s) : 341 170

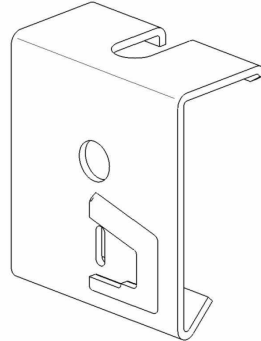

1 RANGE

Reference	Code	Matière Raw material	Norme Standard	Finition Coating	Epaisseur Thickness (mm/Inch)	Colisage Packing	Masse Weight (KG)
P31 HS	341 170	DX51D Z200 MAC	EN 10346	GS	2 / 0,08"	50	0,083

Dimensions in (mm/inch) :

