

SUSPENTE CENTRALE FAS - SCF  
FAS PCH - CENTER HANGER

Reference(s) : 586 156/200/206/210/300/306/400/406  
586 450/456/500/506/600/606  
586 810/820/830/840

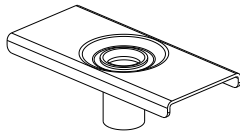

PFSCF

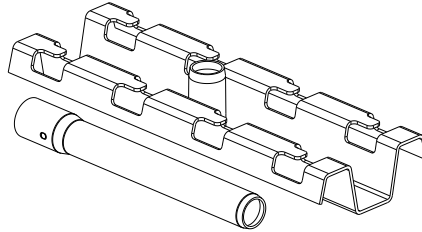

SCF / FASPCH

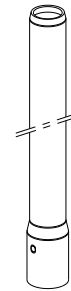

EXT-SCF

1. USAGE / USE

Support plafond pour chemin de câbles fils avec système FAS (sans vis). A fixer sur tige filetée  
Ceiling supports for wire mesh tray with FAS system (screwless). Suspended from threaded rods

2. GAMME / RANGE

| Designation    | L    |        | GS      |                             |       | ZnMg-HR |                             |       |
|----------------|------|--------|---------|-----------------------------|-------|---------|-----------------------------|-------|
|                | (mm) | (inch) | CODE    | Poids / Weight<br>(Kg) (lb) |       | CODE    | Poids / Weight<br>(Kg) (lb) |       |
| SCF FASPCH 150 | 144  | 5.669  | -       | -                           | -     | 586 156 | 0.243                       | 0.536 |
| SCF FASPCH 200 | 194  | 7.638  | 586 200 | 0.301                       | 0.664 | 586 206 | 0.303                       | 0.668 |
| SCF FASPCH 325 | 294  | 11.575 | 586 300 | 0.419                       | 0.924 | 586 306 | 0.421                       | 0.928 |
| SCF FASPCH 400 | 394  | 15.512 | 586 400 | 0.539                       | 1.188 | 586 406 | 0.541                       | 1.193 |
| SCF FASPCH 450 | 444  | 17.480 | 586 450 | 0.599                       | 1.321 | 586 456 | 0.601                       | 1.325 |
| SCF FASPCH 500 | 494  | 19.449 | 586 500 | 0.659                       | 1.453 | 586 506 | 0.661                       | 1.457 |
| SCF FASPCH 600 | 594  | 23.386 | 586 600 | 0.778                       | 1.715 | 586 606 | 0.780                       | 1.720 |

| Designation | GS      |                             |       |
|-------------|---------|-----------------------------|-------|
|             | CODE    | Poids / Weight<br>(Kg) (lb) |       |
| PFSCF       | 586 210 | 0.08                        | 0.176 |

| Designation | L1   |        | EZ      |                             |       |
|-------------|------|--------|---------|-----------------------------|-------|
|             | (mm) | (inch) | CODE    | Poids / Weight<br>(Kg) (lb) |       |
| EXT-SCF 50  | 80   | 3.15   | 586 810 | 0.032                       | 0.071 |
| EXT-SCF 100 | 130  | 5.118  | 586 820 | 0.051                       | 0.112 |
| EXT-SCF 150 | 180  | 7.087  | 586 830 | 0.070                       | 0.154 |
| EXT-SCF 300 | 355  | 13.976 | 586 840 | 0.137                       | 0.302 |

3. DIMENSIONS (mm/inch)

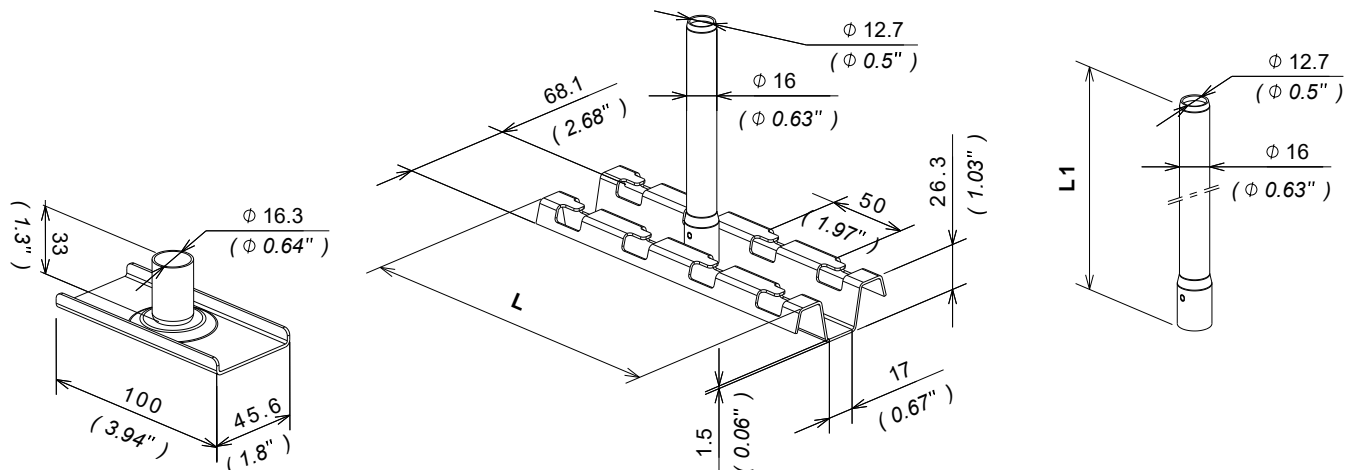

**3. DIMENSIONS (mm/inch)**

■ **3.1 SCF**

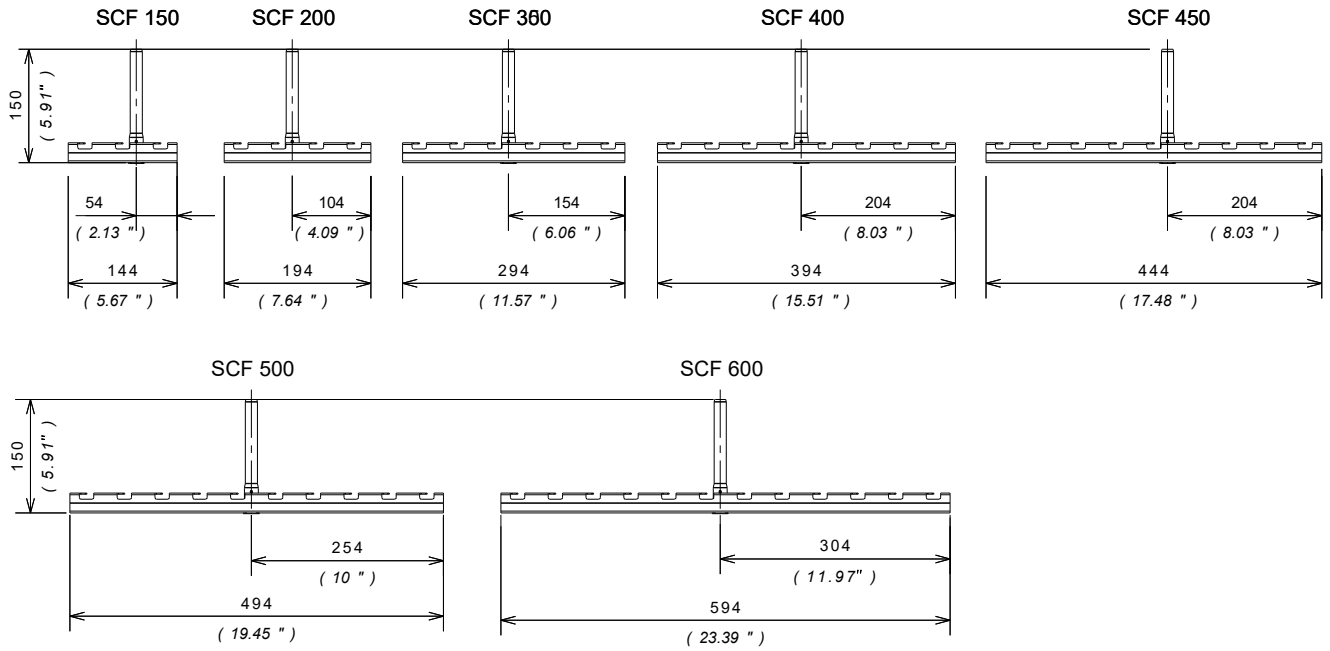

■ **3.2 SCF + PFSCF**

SCF + PFSCF

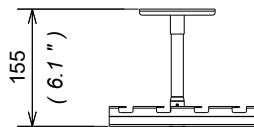

SCF + EXT-SCF 325

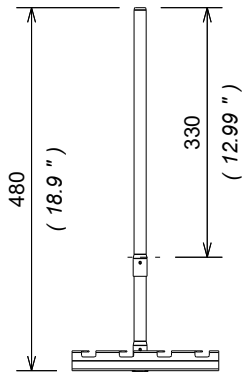

■ **3.2 SCF + EXT-SCF**

SCF + EXT-SCF 50

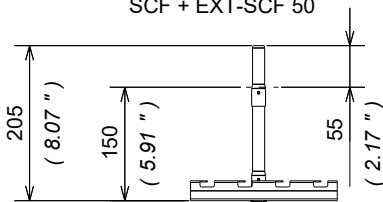

SCF + EXT-SCF 100

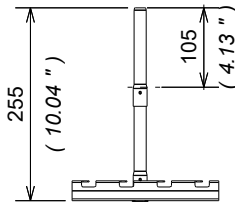

SCF + EXT-SCF 150

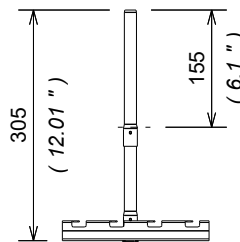

**4. FIXATION / FIXING**

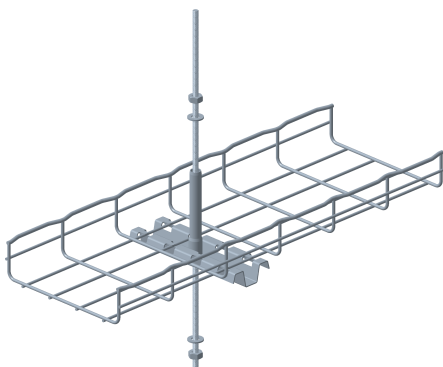

M8 1/4"  
 M10 3/8"  
 M12 1/2"



x1





x2



x2



## 5. INSTALLATION

 CF30 → CF150

 100 → 600

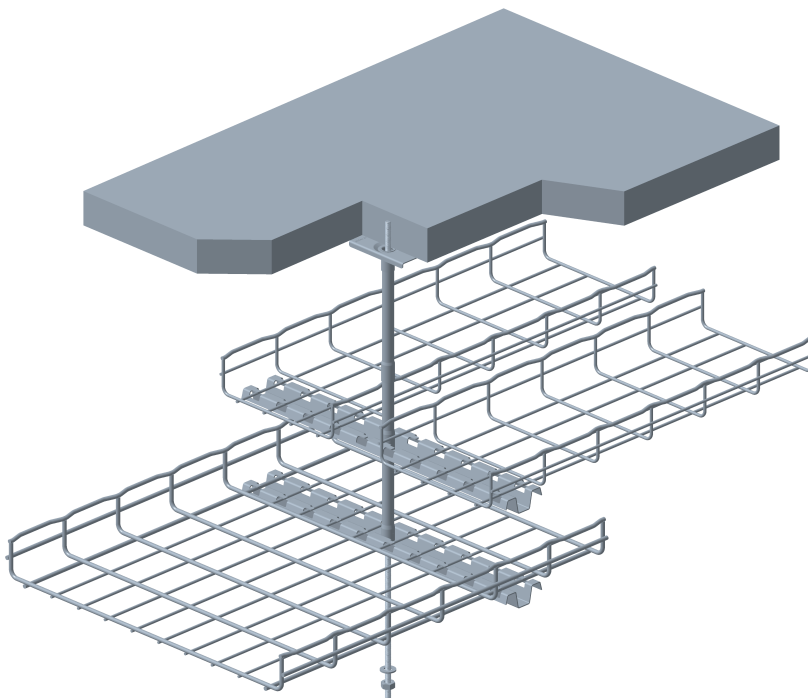
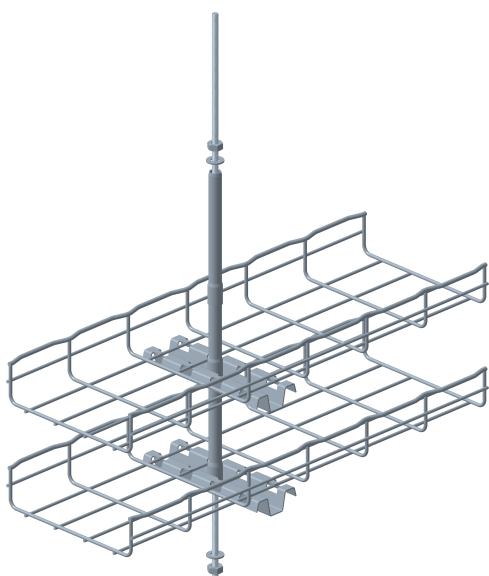
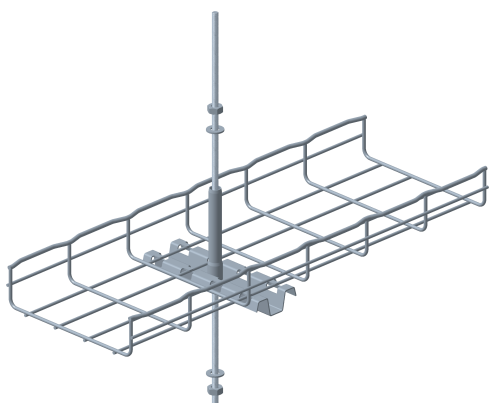
 ZF31 H 25 → 100



|                |  |  +  |
|----------------|--|---|
| SCF FASPCH 150 | 100 ou/ou 150  | X   |
| SCF FASPCH 200 | 200  | X   |
| SCF FASPCH 300 | 300  | 100 + 100   |
| SCF FASPCH 400 | 400  | 150 + 150   |
| SCF FASPCH 450 | 450  | 200 + 150   |
| SCF FASPCH 500 | 500  | 200 + 200   |
| SCF FASPCH 600 | 600  | 200 + 200   |

## 6. DONNEES TECHNIQUES/ TECHNICAL DATA

### 6.1 Caractéristiques matières / Material characteristics

| Finition / Material finish | Matière / Material  | Norme / Standard | Classe de résistance contre la corrosion / Resistance class against corrosion |
|----------------------------|---------------------|------------------|---|
| GS                         | DX51D Z275          | EN 10 346        | Classe 3 - CEI 61537 / Class 3 - IEC 61537                                    |
| EZ (tubes)                 | E220+CR2 S4         | EN 10 305-3      |   |
| ZnMg-HR                    | DX51D + ZM          | EN 10 346        | Classe 8 - CEI 61537 / Class 8 - IEC 61537                                    |
|                            | (Tubes) E220+CR2 S3 | EN 10 305-3      |   |

## 7. CHARGE PRATIQUE DE SECURITE / SAFE WORKING LOAD

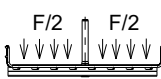
| CPS / SWL      |  |
|----------------|---|
|                | F (daN)   |
| SCF FASPCH 150 | 300   |
| SCF FASPCH 200 | 300   |
| SCF FASPCH 300 | 160   |
| SCF FASPCH 400 | 140   |
| SCF FASPCH 450 | 130   |
| SCF FASPCH 500 | 120   |
| SCF FASPCH 600 | 100   |

