

1. GENERAL CHARACTERISTICS

1.1 Présentation

USB dongle to plug on intelligent PDUs to pair them with wireless sensors.

Energy-friendly radio communications powered by 2.4 GHz Zigbee GreenPower Technology.

2. TECHNICAL SPECIFICATIONS

Frequency band	2400-2483,5 MHz
RF power max.	< 10dBm/10mW
Number of sensors supported by 1 dongle	30
Max dongle/sensor range	Range: 200 m free field point to point
	Datacenter interior environment : approximately 15m

3. INSTALLATION

3.1 DONGLE

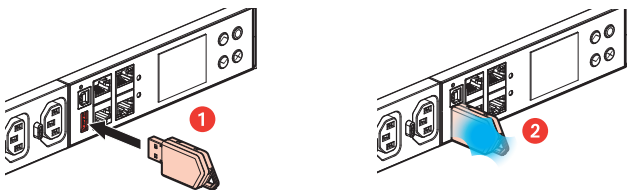

3.2 GENERAL INSTALLATION

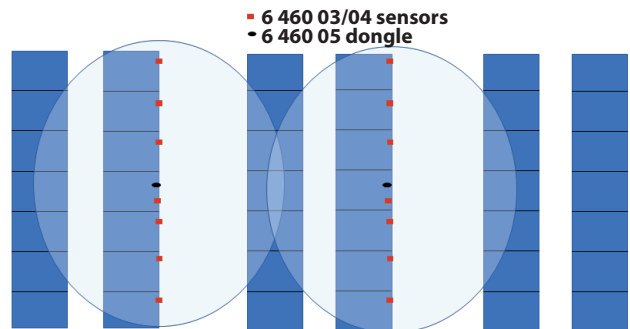

Maximum radius of sensor installation around a dongle: 15m

Maximum number of sensors per dongle : 30

4. DIMENSIONS

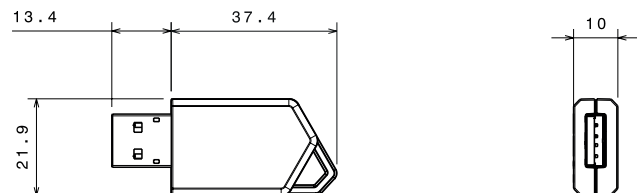

5. STANDARDS AND APPROVALS

IEC62368-1

ETSI EN 301 489-1

ETSI EN 301 489-17

EN 62 311

EN 300 328 V2.2.2