



1. USE

Use this accessory to fix cover on cable ladders or fittings.

Legrand advises to apply an additional fixing for vertical covers:

- to prevent covers sliding down due to vibrations or removal of bottom cover first
- to make it more difficult for unauthorized people to access the cable ladder

2. RANGE

■ 2.1 Cover Clamp

Description	Code	Weight		Thickness		Coating
		(kg)	(lb)	(mm)	(inch)	
GLO-4 CLAMP FOR COVER - LD + MD - INOX	8236000	0,004	0,009	0,6	0,02	S30100

3. DIMENSIONS (mm/inch)

■ 3.1 Cover Clamp dimensions

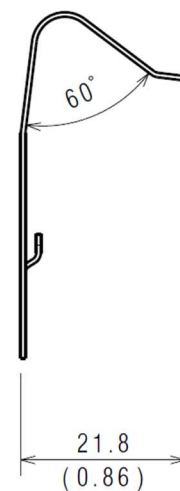
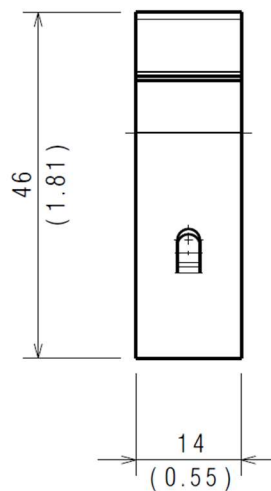
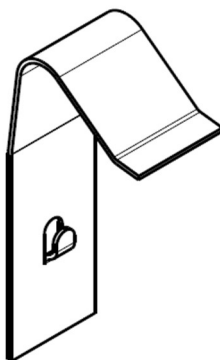

4. INSTALLATION

■ **4.1 Cover fixing clip**

Insert the clip in the side hole and push to lock it.

■ **4.1.1 Clip on Cable ladder's cover**

Use 4 clips for each cover

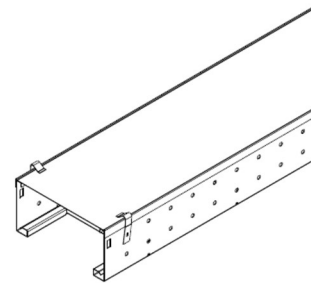
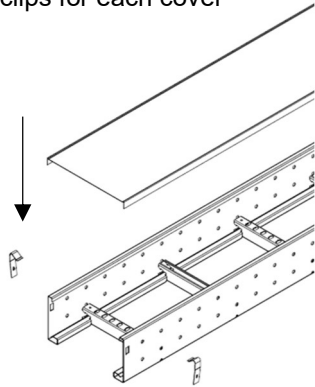

■ **4.1.2 Clip on Fitting's cover**

Insert clip into the available holes.

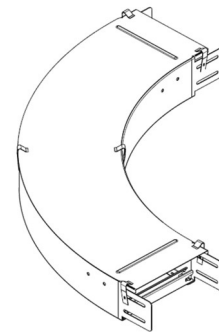
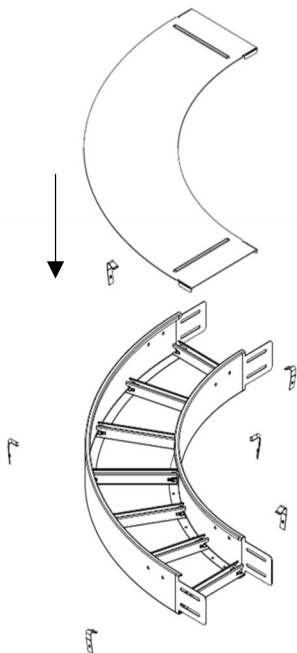

Fitting	Number Of Clip
Flat Bend 90°	6
Equal Tee	9
Universal Bend	2
Vertical Rise	10

5. TECHNICAL DATA

■ **5.1 Climatic characteristics**

Storage and operating temperature: - 20° C à + 120° C

■ **5.2 Material characteristics**

Material finish	Material	Standard	Resistance class against corrosion
S.S.301	1.4310 (AISI 301)	EN 10151	Classe 2 – IEC 61537

6. CONFORMITY - CERTIFICATION

Comply with IEC 61537 Cable tray systems
 Certification: CE