

Céliane™

Rotary dimmer with or without neutral

Cat. No(s): CB0408 - CN0408 - CT0408

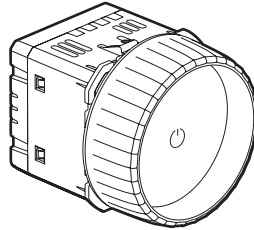

1. USAGE

This product allows the control and variation of all types of lamps.
 Can be associated with one or several push-buttons without neon, each push-button then allowing the on/off/dimming functions.
 Gradually turn the light on and off.
 Lights come on again at the same lighting level as before they were last switched off.

It features:

- a luminous mode (indicator and/or standby)
- status memory mode
- 2 load control modes (see LE14556 manual - product Cat. No. CB0408).

Installed in a box at least 40 mm deep.

Fixing with screws.

2. RANGE

Dimmer with rotary ring with or without neutral - 200 W LED

White	Black	Titanium
CB0408	CN0408	CT0408

3. DIMENSIONS (mm)

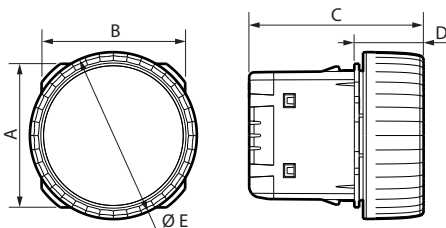

A	B	C	D	Ø E
45	45	55	22	52.5

4. CONNECTION

Type of terminals: with screws

Terminal capacity: 2 x 1.5 mm² max. or 1 x 2.5 mm²

Stripping length: 8 mm

Screwdriver: flat 3 mm

5. OPERATION

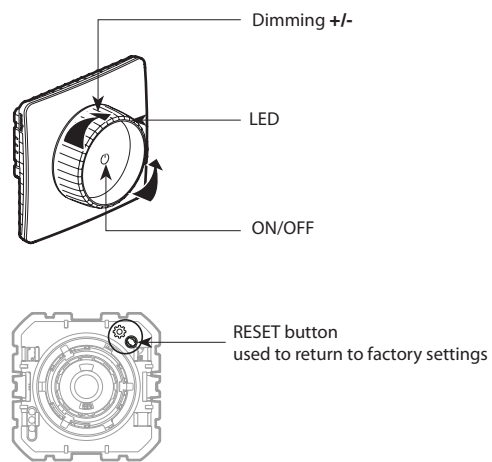

6. TECHNICAL CHARACTERISTICS

■ 6.1 Mechanical characteristics

Protection against impacts: IK 04

Protection against solid bodies and liquids: IP 20

■ 6.2 Caractéristiques matières

Support frame: PA 6.6 + Galvan steel

Mechanism casing: PC

Ring: ABS

Halogen-free

UV-resistant

Self-extinguishing:

850°C/30 s for insulating components holding live parts in place.

650°C/30 s for other insulating components

■ 6.3 Electrical characteristics

Voltage: 110-240 V~

Power: 7 W - 200 W

LED power: 7 VA - 200 VA or max. 10 lamps

Frequency: 50/60 Hz

Standby consumption: 1.2 mA

Caution: Only works with variable-intensity bulbs.



6. TECHNICAL CHARACTERISTICS *(continued)*

■ 6.3 Electrical characteristics

In case of load malfunction :

- 1 - Check that the bulb is dimmable.
- 2 - Reduce the maximum light intensity by following the product instructions.
- 3 - Install compensator Cat. No. 0 401 49 (product wiring without neutral).
- 4 - Wiring with neutral allows greater compatibility with all types dimmable bulbs.

■ 6.4 Climate characteristics

Usage temperature: +5°C to +35°C

Storage temperature: 0°C to +45°C

7. CARE

Clean the surface with a cloth.

Do not use acetone, tar-removing cleaning agents or trichloroethylene.

Resistance to cleaning products: Hexane, methylated spirit, soapy water, diluted ammonia, pure bleach diluted to 10%, window-cleaning products, pre-impregnated wipes.

Resistance to hospital-grade cleaning products: Anios, Surfanios, Bactylsine, Diluted hydrogen peroxide (35%).

Caution: Always test before using special cleaning products.

8. STANDARDS AND APPROVALS

Compliant with installation and manufacturing standards.

See e-catalogue.