

## Tower

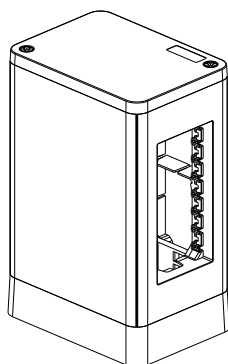

653200

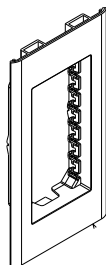

653201

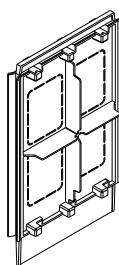

653202

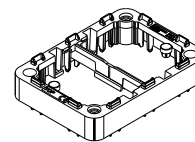

653203

### Use

Tower 4 modules for surface mounting installation.  
 Can be extended to 8,16 or more modules thanks to the accessories (additional support and joining kits)  
 Compatible with our 45x45 format wiring devices (Mosaic, Arteur, Matix Go, Lyncus)

### Range

#### Designation

#### Item

Turret - white case

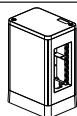

653200

Color code:

White (RAL 9003) and grey.

### Overall dimensions (mm)

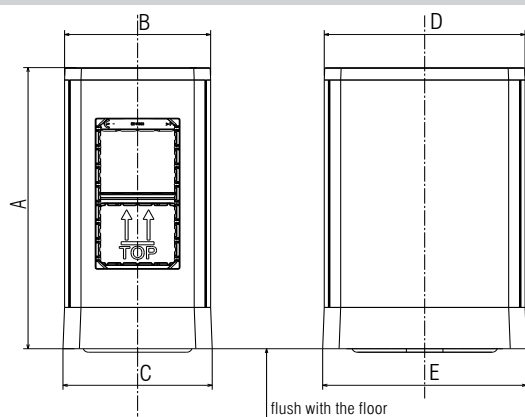

	A	B	C	D	E
653200	170	80	82	110	112

### Accessory

Supporting frame 4m

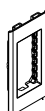

653201

### Accessory

Horizontal junction



653202

Vertical junction

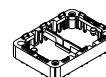

653203

Color code:

White (RAL 9003)

### Technical characteristics

#### - Protection index

(considering a complete installation)  
 Penetration by solid bodies/liquid: IP40

#### - Mechanical characteristics

Impact test: IK 08

#### - Material characteristics

Materials:

- White covers: ABS
- Internal structure: PA6 with fiber glass
- Grey covers: PC (polycarbonate)
- Yellow separator: PP (polypropylene)

UV resistant. Halogen free.

Self-extinguishing:

650° C / 30 s for parts made of insulating materials

#### - Climatic characteristics

Storage temperature: - 10° C to + 70° C

Use temperature: - 5° C to + 35° C

### Cleaning

Clean the surface with a cloth.

Do not use acetone, tar-removing cleaning agents or trichloroethylene.

**Caution: Always test before using special cleaning products.**

### Standards and approvals

Compliance with standards CEI EN 50085-2-4

Refer to e.catalogue.