

Céliane™
TV/SAT socket

Cat. No(s): CM0392

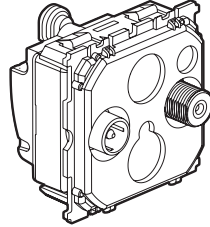

1. USE

Socket suitable for receiving individual TV and satellite signals. UHD (Ultra High Definition) compatible. Class A shielded star socket LTE Ready (4G protected). Recommended coaxial cable 17/19 VATC. Single Cable entry. Can be flush mounted in a box min. 40 mm deep.

2. RANGE

| Description | Reference |
|-------------------------------------------------------------------------------------------------|-----------|
| TV/SAT socket - 2 modules To be equipped with support frame, cover plate and finishing plate | CM0392 |

3. DIMENSIONS (mm)

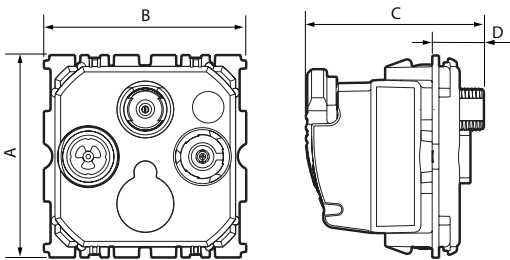

| A | B | C | D |
|----|----|------|------|
| 45 | 45 | 39.5 | 11.5 |

4. CONNECTION

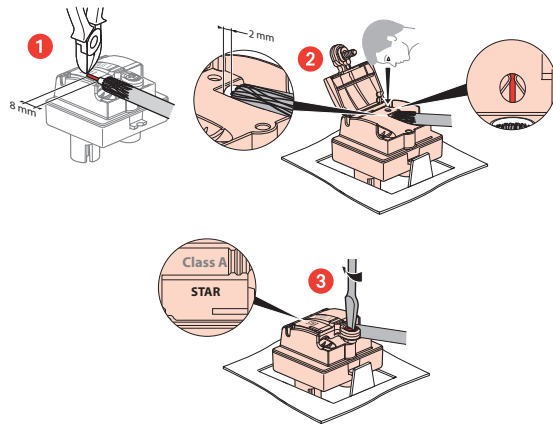

5. WIRING PRECAUTIONS

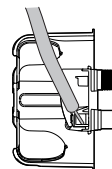
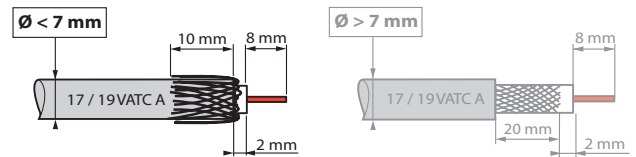

By restricting deformation of the coaxial cable, the rear connection avoids impedance discontinuity, thereby sustaining performance.

6. TECHNICAL CHARACTERISTICS

■ 6.1 Mechanical characteristics

Protection against impacts: IK 03
Protection against solid/bodies and liquids: IP 21
Cable resistance: 120 N

■ 6.2 Material characteristics

Halogen-free

Motor: Box: Zamac
Cover: Zamac
Pin: Bronze
Screws: Steel

Self-extinguishing:

850° C/30 s for insulating parts holding live parts in place.
650° C/30 s for other parts made of insulating materials.

■ 6.3 Electrical characteristics

Male connector Ø 9.52 mm (TV)
Female F screw-type connector (SAT)
Impedance: 75 ohm

Class A shielding efficiency (class A shielding is necessary to prevent interference caused by using new 3 and 4 G phone signals, as these unwanted signals can result in pixellation on screen or adversely affect the sound track).

Frequency bands: TV: 5-862 MHz
SAT: 950-2400 MHz

UHD: Passage of the signals of improvement:
WCG : Wide Color Gamut
HDR : High Dynamic Range
HFR : High Frame Rate

Insulation resistance: IEC 61169-24
Low attenuation: < 1.5 dB max

■ 6.4 Climate characteristics

Storage temperature: - 10° C à + 70° C
Usage temperature: - 5° C à + 35° C

7. CLEANING

Surface cleaning with a cloth.
Do not use acetone, tar remover, trichloroethylene.

Resistant to the following products: Hexane (NF C 61-314), Methylated spirit, soapy water, diluted ammonia, bleach diluted to 10 %, window-cleaning products, pre-impregnated wipes.

Caution: Always test before using special cleaning products.

8. PERFORMANCE

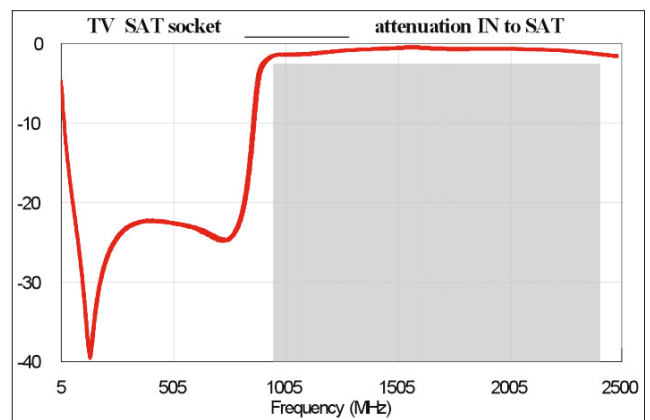
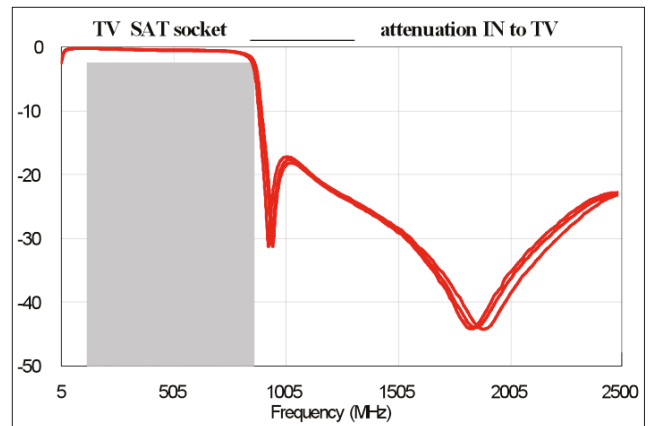

9. STANDARDS AND APPROVALS

EN 50083-2
Class A certified

