

Céliane™
LCS² Cat. 6 RJ 45 socket

Cat. No(s): CM0344 - CM0345 - CM0347

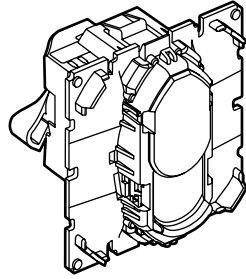

CM0344

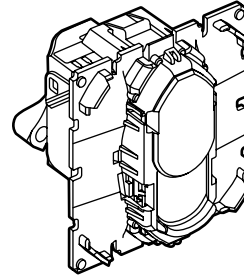

CM0347

1. USE

Category 6 RJ 45 socket for high speed transmission (Gigabit Ethernet).
 The mechanism can be flush-mounted or surface-mounted in 40 mm depth box min.
 To be equipped with frame and plates.
 Fixing with clips.

2. RANGE

	Description	Cat. No.
	Cat. 6 RJ 45 socket	CM0344
	Cat. 6 RJ 45 socket	CM0345
	Cat. 6 RJ 45 socket	CM0347

3. DIMENSIONS (mm)

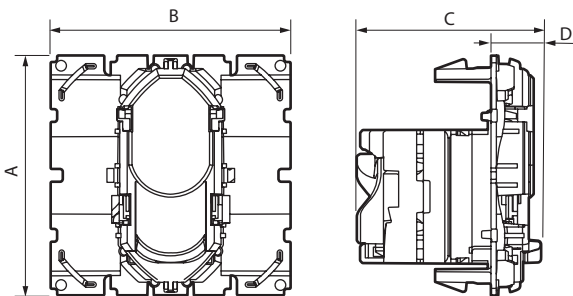

Références	A	B	C	D
CM0344 - CM0345	45	45	34.5	9.5
CM0347	45	45	40.5	9.5

4. CONNECTION

Accepts the following cable connectors:
 RJ 11 (4 contacts), RJ 12 (6 contacts), RJ 45 (9 contacts).
 Double colour code T568A and T568B on terminals:
 UTP 8 contacts
 FTP 9 contacts
 STP 9 contacts 360° screen

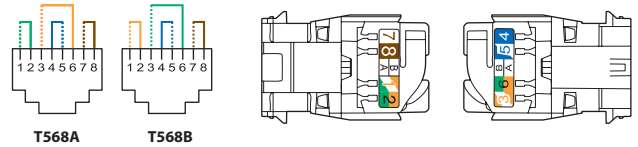

Conductors supported:
 - Solid/stranded: 0.4 to 0.65 mm, AWG 26 to 22
 - Polyethylene conductor insulation: Ø 0.85 to 1.7 mm on insulation

RJ 45 connectors are equipped with a locking nut that does not require the use of a specific tool and which enables re-cabling in the event of error.

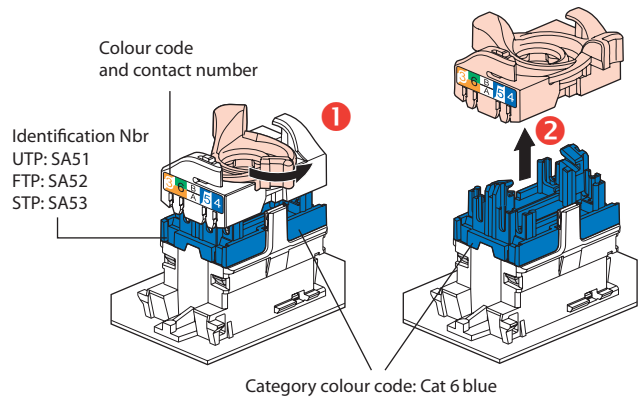

4. CONNECTION (continued)

This system allows the wire pairs to be spread easily before mounting them on the connector.

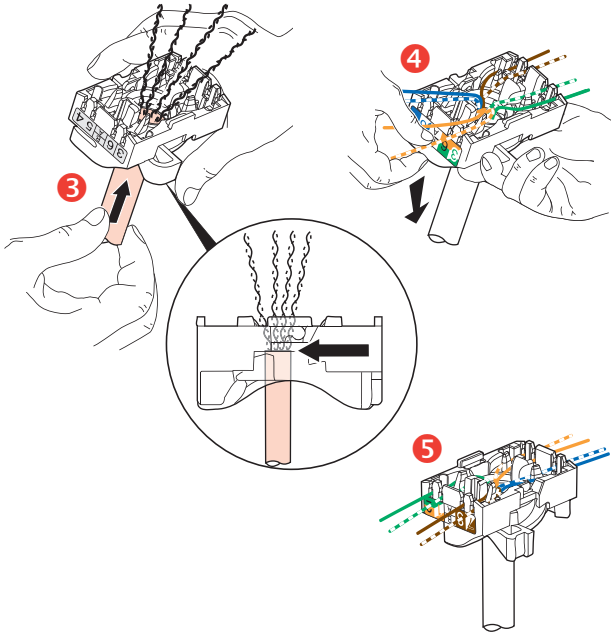

Spreading cables ensures that each pair is separated by the specified 13 mm.

Spreading pairs by 90° in relation to the cable ensures optimum performance.

5. INSTALLATION

This product can be assembled in duplicate after breaking off the fins.

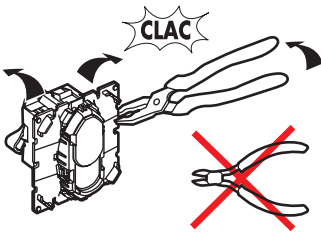

Connection

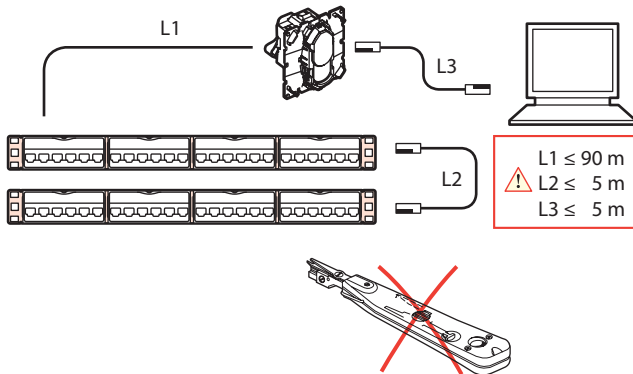

6. TECHNICAL CHARACTERISTICS

6.1 Mechanical characteristics

Impact resistance: IK 03

Penetration against solid bodies and liquids: IP 20

Max. number of connections and disconnections: 5 without refreshing the wiring.

Endurance: 2500 movements (plug insertion/withdrawal).

6.2 Material characteristics

Contacts: Gold/nickel, minimum thickness of gold > 0.8 μm

Metal parts: Bronze, nickel, platinum, gold

For STP products the body and the spreader are made of metal alloy with a copper-nickel coating.

Base: PC

Halogen-free

Self-extinguishing:

850°C/30 s for insulating components holding live parts in place

650°C/30 s for other insulating components

6.3 Electrical characteristics

Breakdown voltage ≥ 1000 V

Contact resistance ≤ 20 mΩ

Insulation resistance ≥ 500 mΩ at 100 Vdc

Tested and independently certified to comply with IEC 60512-99-001 and IEC 60512-99-002 for PoE support up to 90 W (Type 4).

6.4 Climate characteristics

Storage temperature: -10°C to +70°C

Operating temperature: -5°C to +35°C

7. CLEANING

Clean the surface with a cloth.

Do not use acetone, tar-removing cleaning agents or trichloroethylene.

Caution: Always test before using special cleaning products.

8. STANDARDS AND APPROVALS

ISO/IEC 11801 series : International standard for generic cabling for customer premises

ANSI/TIA 568 series : North American standard for generic cabling for customer premises

EN 50173 series : European standard for generic cabling for customer premises

IEC 60603-7 series : International standard for connector specifications

Connectors are compliant to requirements for the following remote powering applications

IEEE 802.3af, IEEE 802.3at, IEEE 802.3bt : "Power over Ethernet", Types 1 to 4, up to 90 W.

9. PERFORMANCE

■ 9.1 Component performance (RJ 45 connectors)

Return loss

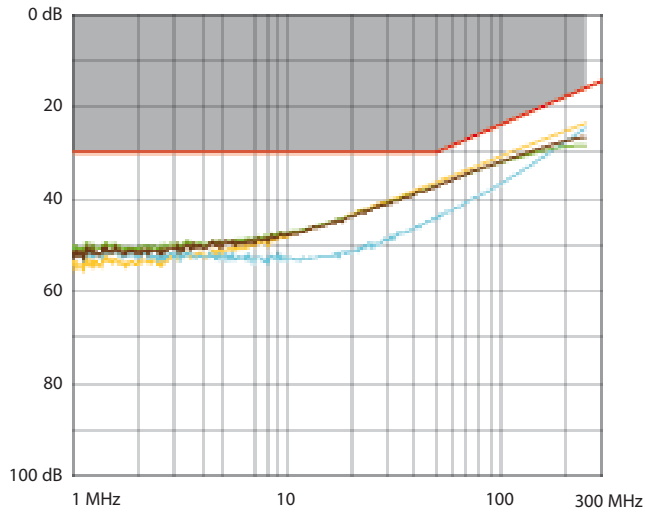

Attenuation

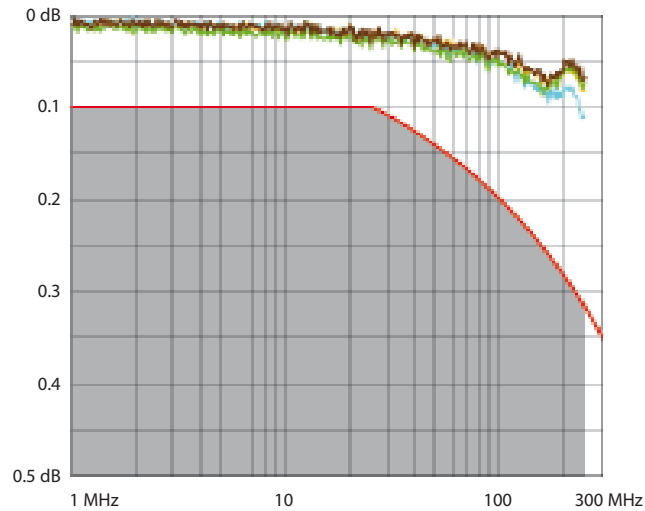

NEXT (Near end Crosstalk Attenuation)

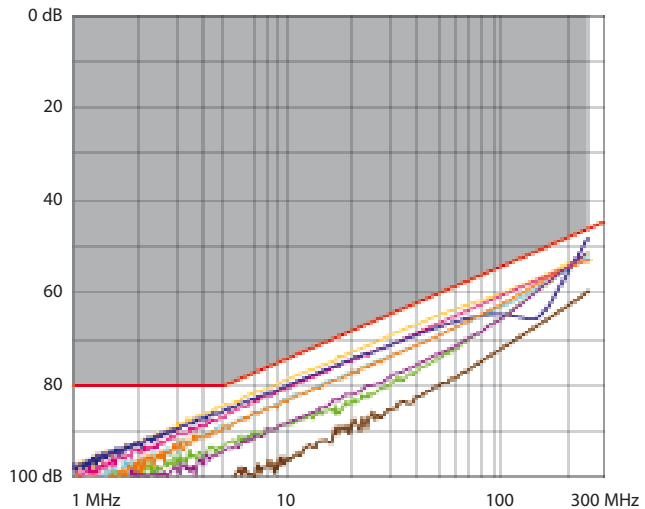

9. PERFORMANCE (Cont.)

■ 9.1 Component performance (RJ 45 connectors) (cont.)

FEXT (Far end Crosstalk Attenuation)

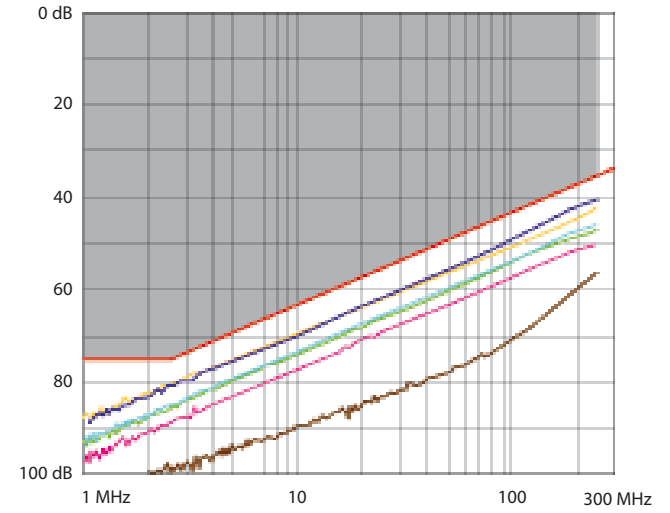

■ 9.2 Performance of permanent link with F/UTP cable

Return loss

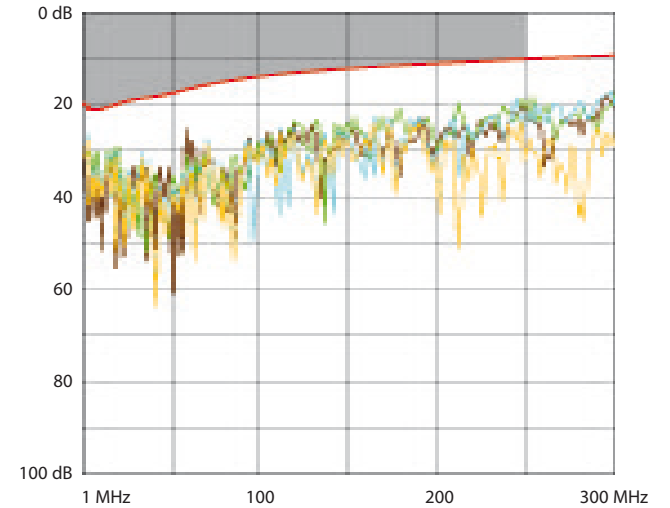

Attenuation

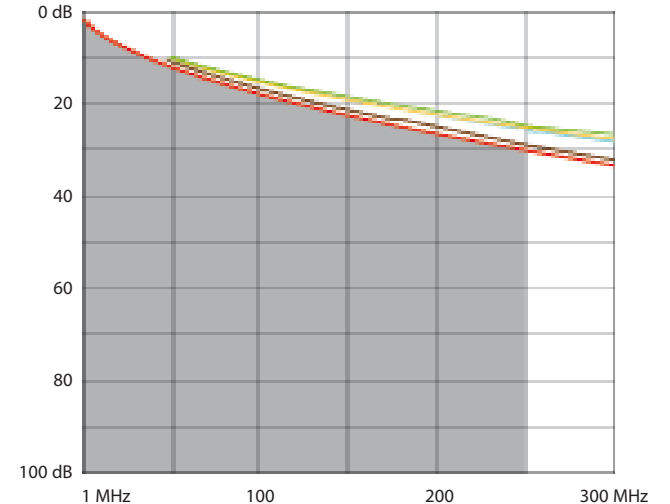

9. PERFORMANCE (Cont.)

■ 9.2 Performance of permanent link with F/UTP cable (Cont.)
NEXT (Near end Crosstalk Attenuation)

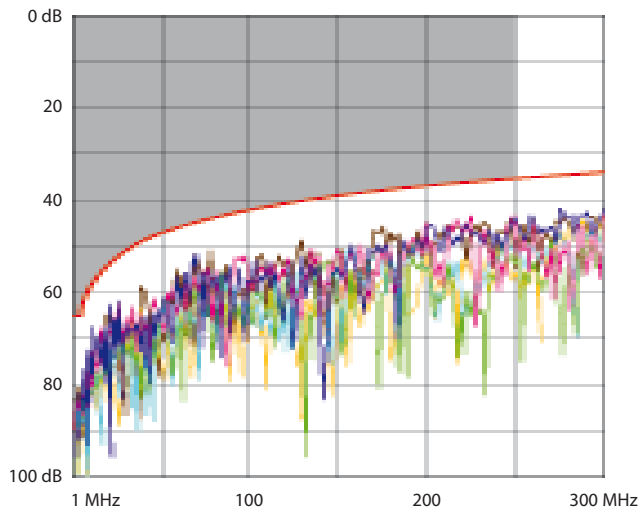

PS NEXT (Power Sum NEXT)

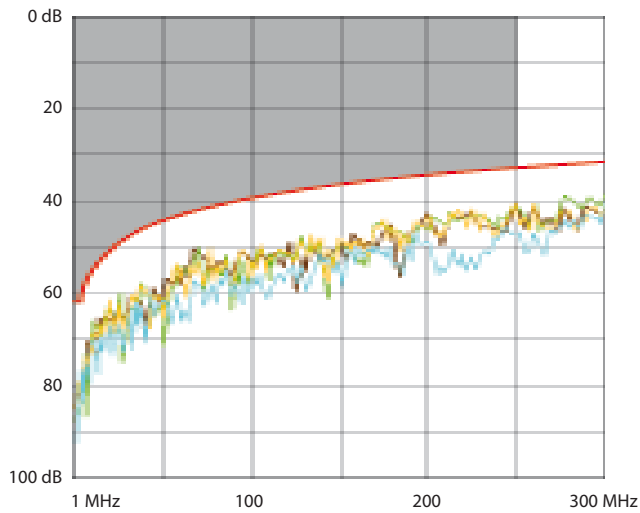

ACR (Attenuation to Crosstalk Ratio)

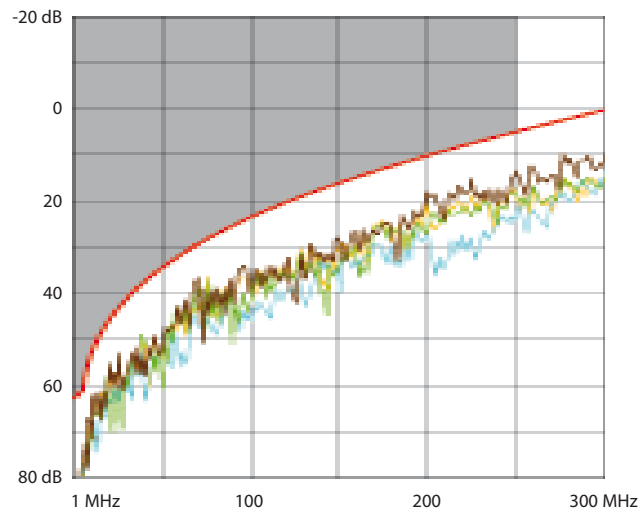

9. PERFORMANCE (Cont.)

■ 9.2 Performance of permanent link with F/UTP cable (Cont.)
ELFEXT (Equal Level End Crosstalk Attenuation)

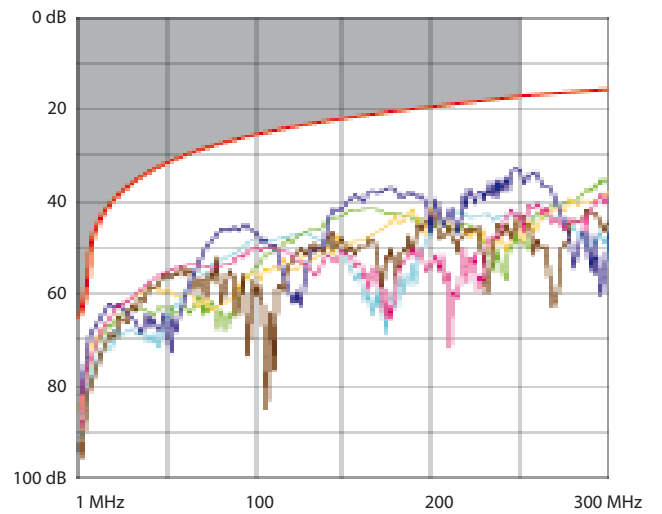

Delay skew

