

1. USE

Mechanism for controlling the opening and closing of circuits requiring the use of a key.
To be fitted with barrel ref. 0 697 95 or with standard European barrel.

2. RANGE

Description	References
2-position key switch - 2 NO contacts. Extraction of the key in the central position without modifying the state of the contacts.	CM0071
3-position key push button - Reverseur with OFF position. Extracting the key in the central position on the stop function.	CM0072

3. DIMENSIONS (mm)

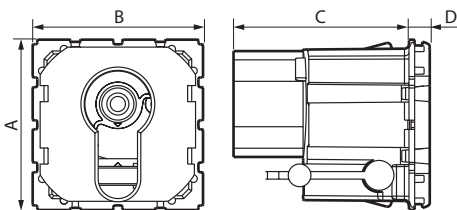

A	B	C	D
45	45	52	5.5

4. CONNEXION

Type of terminals: with screws
Terminal capacity: 2 x 2.5 mm²
Compatible flexible or rigid cables
Stripping length: 6 mm
Screwdriver: Philips N°1

5. TECHNICAL CHARACTERISTICS

■ 5.1 Mechanical characteristics

Protection against impacts : IK 04
Protection against solid/bodies and liquids: IP 41

■ 5.2 Material characteristics

Mechanism casing and front plate: PC

Self-extinguishing:

850°C/30 s for insulating components holding live parts in place
650°C/30 s for other insulating components

■ 5.3 Electrical characteristics

Voltage: 250 V~

Current: 10 A

Frequency: 50/60 Hz

Maximum power supported (motor): 750 W - 230 V~
48 V= - 3 A

■ 5.4 Climate characteristics

Storage temperature: -10°C to +70°C

Usage temperature: -5°C to +35°C

6. ACCESSORIES

European barrel Cat. No. 0 697 95 delivered with a single set of 3 keys.

7. STANDARDS AND APPROVALS

Compliant with installation and manufacturing standards.
See e-catalogue.