

Arteor™ with Netatmo - British Standard Connected curtain/roller blind switches

Cat. Nos: 5 746 29/30/31/32/33/34/35/36

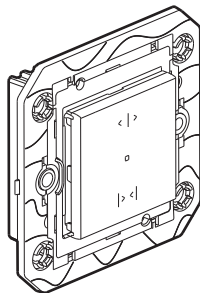

5 746 29/30/31/32

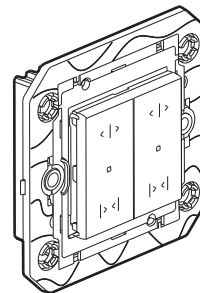

5 746 33/34/35/36

1. USE

For local or remote control of a roller shutter/curtains.

Can be combined with one or more wireless roller shutter controls/curtains.

Can be installed in place of an existing roller shutter switch in a flush-mounting box 25 mm deep (minimum).

The Arteor with Netatmo solution is compatible with roller shutters with a mechanical or electronical stop, controlled by a standard wired switch for roller shutters.

Caution: Must be connected to the neutral.

Not compatible with radio-controlled roller shutter motors.

2. RANGE

Description	White	Magnesium	Soft Alu	Champagne
Connected curtain/roller blind switches with neutral. Mechanisms supplied with rocker plates and support frames. Equipped with an LED indicator. Hidden reset button used to return to factory settings.	5 746 29 1-gang	5 746 30 1-gang	5 746 31 1-gang	5 746 32 1-gang
	5 746 33 2-gang	5 746 34 2-gang	5 746 35 2-gang	5 746 36 2-gang

3. DIMENSIONS (mm)

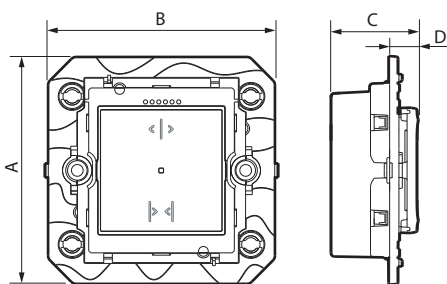

A	B	C	D
81.5	81.5	31	10.5

4. CONNECTION

Terminal type : with screws

Terminal capacity: 2 x 1.5 mm² - 2 x 2.5 mm² - 1 x 4 mm²

Stripping length: 8 mm

5. OPERATION

Integrated time delay for up/down inversion: 500 ms

1-gang: 5 746 29/30/31/32

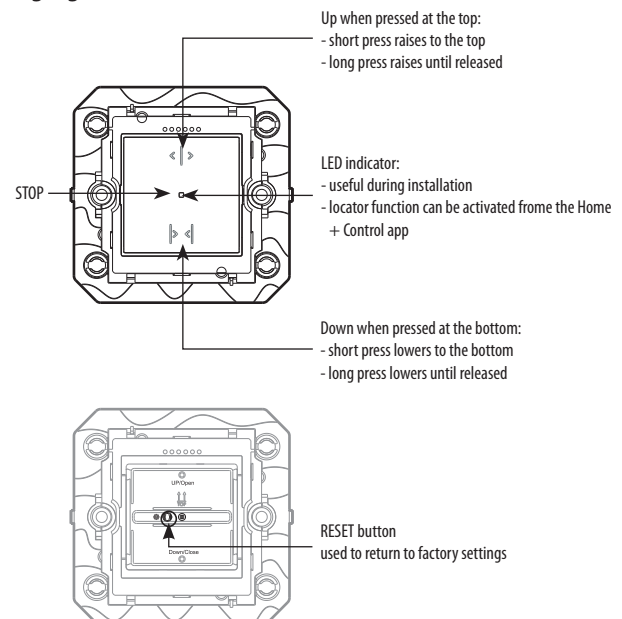

5. OPERATION (continued)

2-gang: 5 746 33/34/35/36

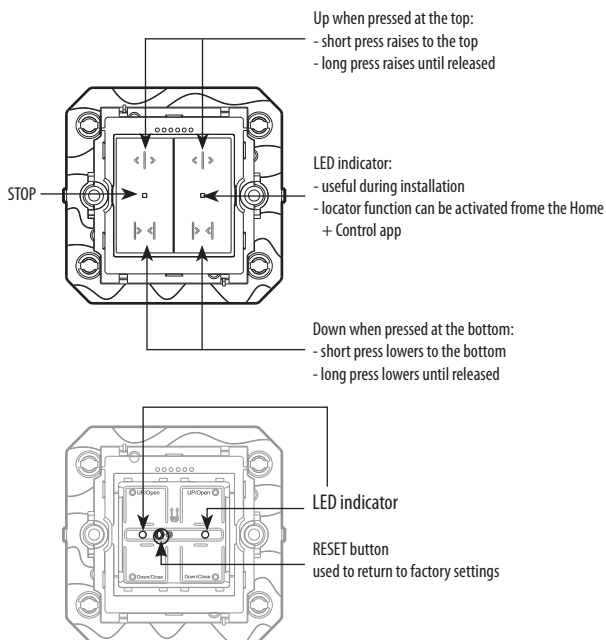

6. TECHNICAL CHARACTERISTICS

■ 6.1 Mechanical characteristics

Protection against impacts: IK 04

Protection against solid bodies/liquids: IP 20

■ 6.2 Material characteristics

Rocker plate: ABS White RAL 9003

ABS Magnesium painted

ABS Soft Alu painted

ABS Champagne painted

Mechanism casing: PC

Halogen-free

UV-resistant

Self-extinguishing:

850°C/30 s for insulating components holding live parts in place.

650°C/30 s for other insulating components.

■ 6.3 Electrical characteristics

Voltage: 110/240 V~

Frequency: 50/60 Hz

Standby consumption: 0.1 mA

Zigbee technology

Frequency bands: 2.4 GHz to 2.4835 GHz

Power level: < 100 mW

Range: 200 m of unobstructed space

10 m between products

■ 6.4 Climate characteristics

Storage temperature: 0°C to + 45°C

Usage temperature: +5°C to + 35°C

7. CARE

Clean the surface with a cloth.

Do not use acetone, tar-removing cleaning agents or trichloroethylene.

Resistant to the following products:

Hexane, methylated spirit, soapy water, diluted ammonia, bleach diluted to 10%, window-cleaning products, pre-impregnated wipes.

Caution: Always test before using special cleaning products.

8. STANDARDS AND APPROVALS

Compliant with installation and manufacturing standards.

See e-catalogue.

The undersigned, LEGRAND, declares that the radio-electric equipment type (5 746 29/30/31/32/33/34/35/36) complies with directive 2014/53/EU. The full text of the EU declaration of conformity is available on the following website: www.legrandoc.com