

P31 – TELESCOPIC ELEMENT H75

Reference(s): X9T71../72../73../74../75..(Z,G)



1. USE

Telescopic element in H75 able to adjust the length without cut.

2. RANGE

■ 2.1 Telescopic Element PG

Description	Code	Weight		Thickness		Coating	Min. Section	
		(Kg)	(lb)	(mm)	(inch)		(mm ²)	(inch ²)
P31-TELESCOPIC ELEMENT 75X75 PG	X9T71Z	0,77	1,70	0,95	0,04	PG	5298	8,21
P31-TELESCOPIC ELEMENT 75X100 PG	X9T72Z	0,84	1,85	0,95	0,04	PG	6940	10,76
P31-TELESCOPIC ELEMENT 75X150 PG	X9T73Z	1,01	2,22	0,95	0,04	PG	10590	16,41
P31-TELESCOPIC ELEMENT 75X200 PG	X9T74Z	1,17	2,58	0,95	0,04	PG	14240	22,07
P31-TELESCOPIC ELEMENT 75X300 PG	X9T75Z	1,50	3,30	0,95	0,04	PG	21577	33,44

■ 2.2 Telescopic Element BLUE

Description	Code	Weight		Thickness		Coating	Min. Section	
		(Kg)	(lb)	(mm)	(inch)		(mm ²)	(inch ²)
P31-TELESCOPIC ELEMENT 75X75 BLUE	X9T71G	0,77	1,70	0,95	0,04	BLUE	5746	8,91
P31-TELESCOPIC ELEMENT 75X100 BLUE	X9T72G	0,84	1,85	0,95	0,04	BLUE	7489	11,61
P31-TELESCOPIC ELEMENT 75X150 BLUE	X9T73G	1,01	2,22	0,95	0,04	BLUE	11279	17,48
P31-TELESCOPIC ELEMENT 75X200 BLUE	X9T74G	1,17	2,58	0,95	0,04	BLUE	15014	23,27
P31-TELESCOPIC ELEMENT 75X300 BLUE	X9T75G	1,50	3,30	0,95	0,04	BLUE	22425	34,76

3. DIMENSION (mm/inch)

■ 3.1 Telescopic Element dimension

Description	Width 1 (W1)		Width 2 (W2)		Max. Length (L)		Min. Length (L)	
	(mm)	(inch)	(mm)	(inch)	(mm)	(inch)	(mm)	(inch)
P31-TELESCOPIC ELEMENT 75X75 PG	77	3,03	75	2,95	400	15,75	250	9,84
P31-TELESCOPIC ELEMENT 75X100 PG	100	3,94	98	3,86	400	15,75	250	9,84
P31-TELESCOPIC ELEMENT 75X150 PG	150	5,91	148	5,83	400	15,75	250	9,84
P31-TELESCOPIC ELEMENT 75X200 PG	200	7,87	198	7,80	400	15,75	250	9,84
P31-TELESCOPIC ELEMENT 75X300 PG	300	11,81	298	11,73	400	15,75	250	9,84

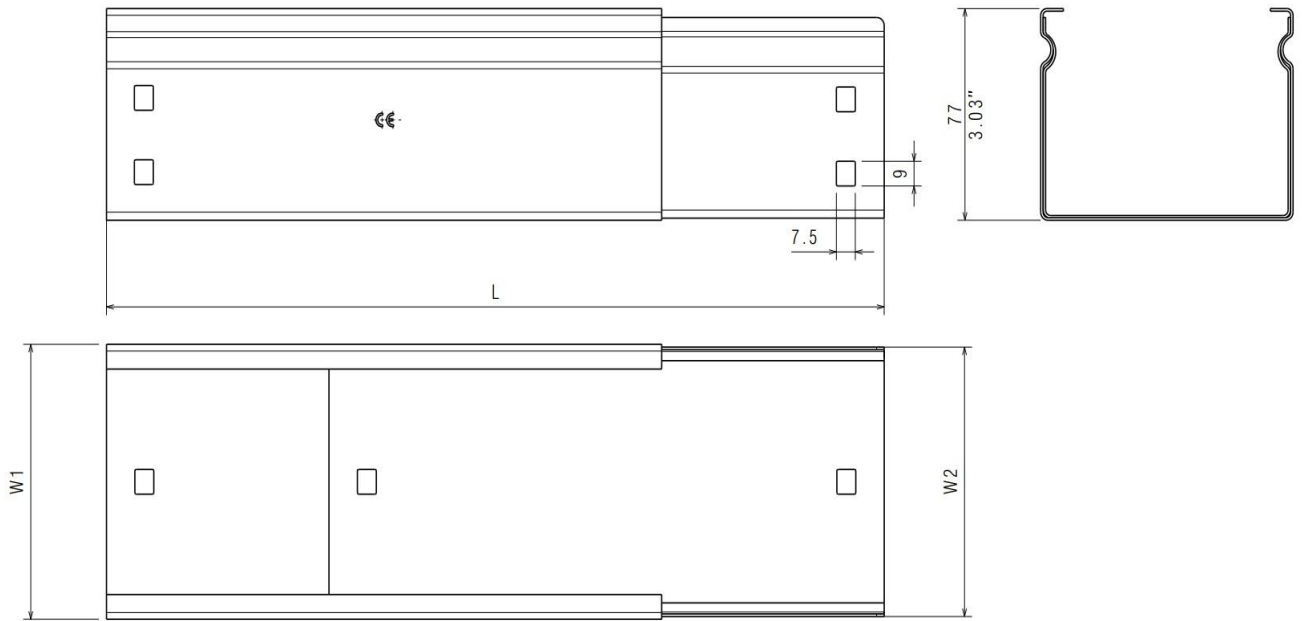

4. INSTALLATION

■ 4.1 Screw

Use screws M6x12 tightened at 11Nm

Reference(s): 341895/ 03V1M610Z (PG)
485035 (Zn-Ni)
346895/ 03V1M610L (SS316L)

■ 4.2 Installation PG

Slide together the two part of telescopic element at the right length and fix it to the cable tray using 4 screws M6x12 on each side. Is not necessary to disassembly automatic coupler.

The screw in the middle is optional up to and included width 300mm.

There is a possibility to fix the part of telescopic element drilling one hole in the bottom and adding a screw M6x12; use 7mm diameter drill bit.

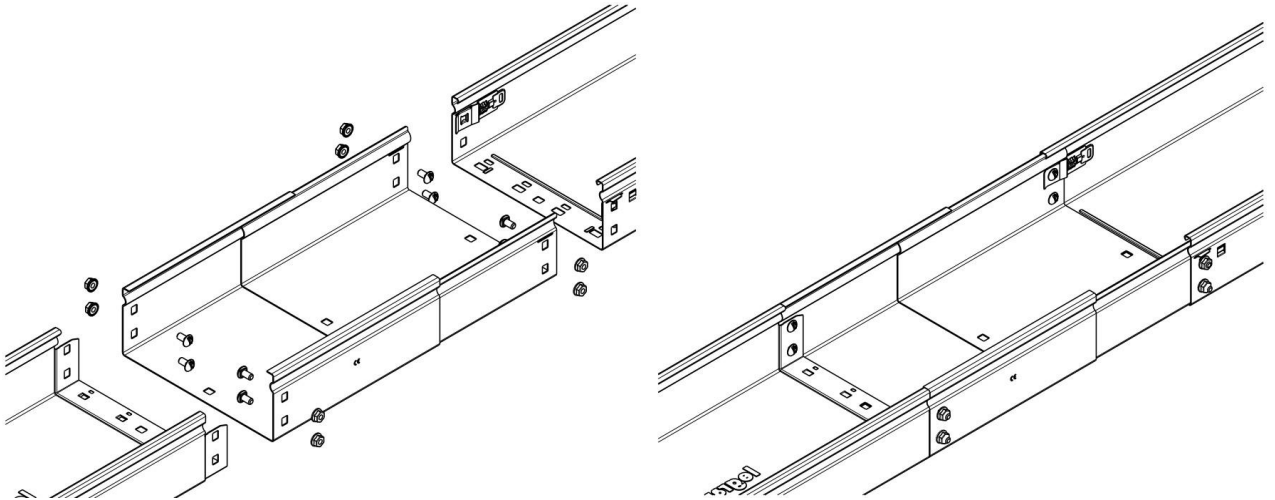

■ 4.3 Installation BLUE

Slide together the two part of telescopic element at the right length and fix it to the cable tray using 4 screws M6x12 on each side. Is not necessary to disassembly automatic coupler.

The screw in the middle is optional up to and included width 300mm.

For the painted version, it is mandatory to insert a cable on the unpainted area and fix the cable along the length (outside) of the telescopic element using two screws to guarantee the electrical continuity between the two parts.

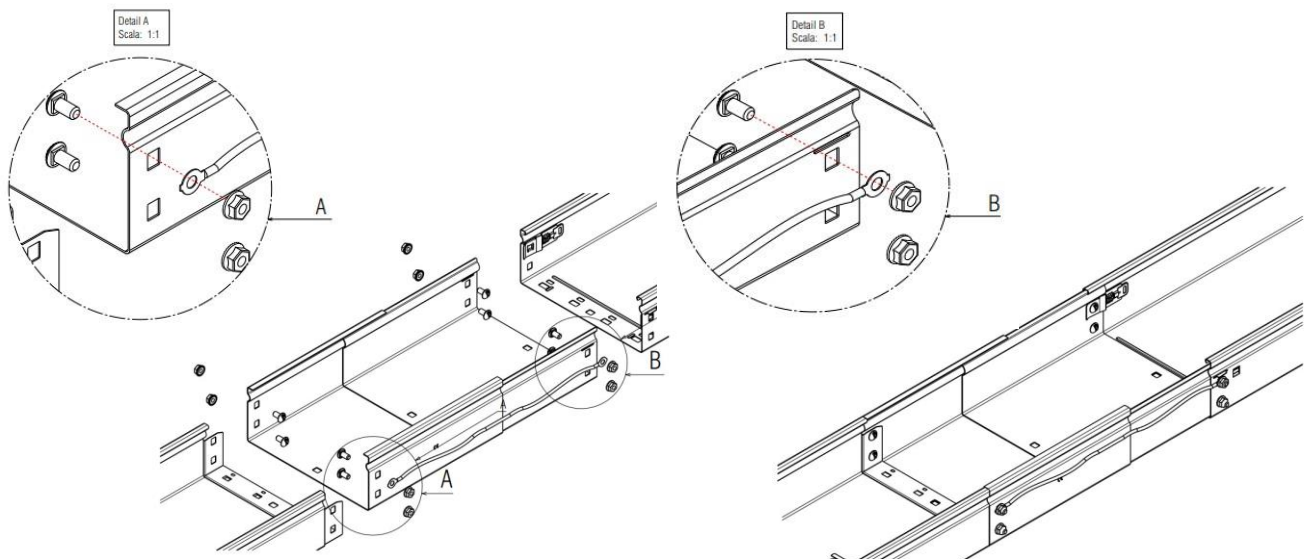

5. TECHNICAL DATA

■ 5.1 Climatic characteristics

Storage and operating temperature: - 20° C à + 120° C

■ 5.2 Material characteristics

Material finish	Material	Standard	Resistance class against corrosion
PG	DX51D + Z200	EN 10346	Classe 3 - CEI 61537
BLUE	DX51D + Z200	EN 10346	Classe 3 - CEI 61537
HDG	DC 01	EN 10130	Classe 6 - CEI 61537
SS304	X5CrNi18-10	EN 10 088-2	Classe 9A - CEI 61537
SS316L	X2CrNiMo17-12-2	EN 10 088-2	Classe 9B - CEI 61537

6. CONFORMITY - CERTIFICATION

Comply with CEI 61537 Cable tray systems

Certification: CE, IMQ