

Epure Style
2 P+E socket outlets - German standard

Cat. No(s): AR67334/35/36 - AR67434/35/36 - AR67534/35/36
 AR67634/35/36 - AR67734/35/36 - AR67834/35/36 - AR67934/35/36

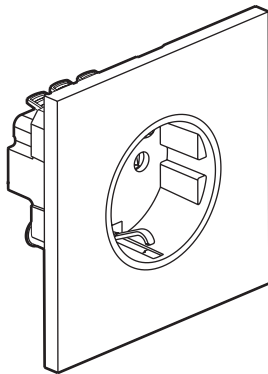

AR67934

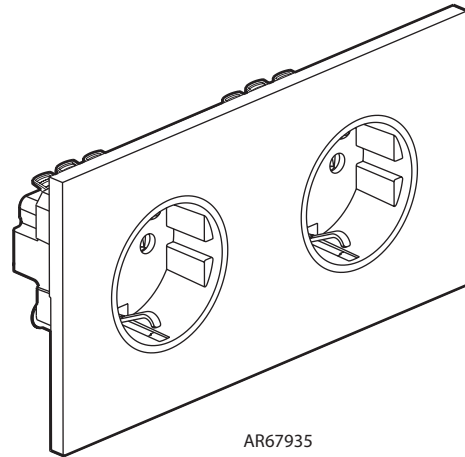

AR67935

1. USE

2 P+E socket outlets with protective eclips.
 Mechanisms supplied with protection cover.
 To be installed in flush-mounting box depth 50 mm recommended.

2. RANGE

AR67434 AR67534 AR67634 AR67734 AR67334 AR67834 AR67934	<ul style="list-style-type: none"> ● Brushed steel ● Satin steel ○ Mirror-polished steel ● Mirror-polished gold ● Bronze ● Matt black ○ Satin white 	2 P+E socket outlet
AR67435 AR67535 AR67635 AR67735 AR67335 AR67835 AR67935	<ul style="list-style-type: none"> ● Brushed steel ● Satin steel ○ Mirror-polished steel ● Mirror-polished gold ● Bronze ● Matt black ○ Satin white 	Double 2 P+E socket
AR67436 AR67536 AR67636 AR67736 AR67336 AR67836 AR67936	<ul style="list-style-type: none"> ● Brushed steel ● Satin steel ○ Mirror-polished steel ● Mirror-polished gold ● Bronze ● Matt black ○ Satin white 	Triple 2 P+E socket

Note: Other finishes and configurations are provided, see technical data sheet F02217EN/01.

3. CONNECTION

Terminal type: automatic
 Terminal capacity: 2 x 2.5 mm²
 Stripping length: 12 mm

4. DIMENSIONS (mm)

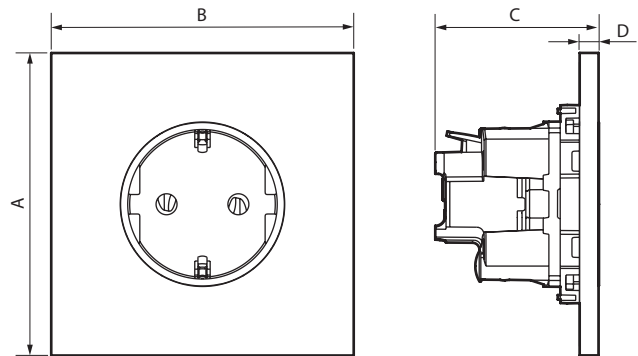

Cat. Nos	A	B	C	D
AR67334 - AR67434 - AR67534 - AR67634 AR67734 - AR67834 - AR67934	80	80	43.5	5
AR67335 - AR67435 - AR67535 - AR67635 AR67735 - AR67835 - AR67935	80	151	43.5	5
AR67336 - AR67436 - AR67536 - AR67636 AR67736 - AR67836 - AR67936	80	222	43.5	5

5. INSTALLATION

ART d'Arnoult electrical wiring accessories are supplied with long fixing screws which can be cut at several points to adapt the screw length to the box flush-mounting depth in the wall.

If ART d'Arnoult wiring accessories are being mounted in thick surfaces such as tiles, marble, wainscot panelling with flush-mounting boxes chased deep into the wall, the whole screw length can be used to fix the wiring accessory.

If ART d'Arnoult wiring accessories are being installed in walls with non-projecting flush-mounting boxes (masonry walls, dry partitions), the screws which can be cut at several points to shorten the thread.

To protect the products, it is essential to install them: once all surface coatings are completely dry, in a dry, non-aggressive environment, indoors only.

It is recommended that you install the plates only after the wall coatings have been completely finished (paint, fabrics, etc.).

5. INSTALLATION *(continued)*

Dismantling:

The plates can be dismantled by inserting the tip of a screwdriver in a purpose-designed notch on the sides of the plate and using it as a lever to unclip it from the fixing points.

Once the plate has been lifted off the wall slightly, just slide your fingers between the plate and the wall to gently remove the plate.

Take care not to pull too hard on the plate, to avoid breaking the fixing clips.

6. TECHNICAL CHARACTERISTICS

■ 6.1 Mechanical characteristics

Impact test: IK 02

Protection against solid bodies and liquids: IP 20

■ 6.2 Material characteristics

• Cover plates: PC

Epure Brushed steel/Satin steel/Mirror-polished steel: 2 P+E sockets, magnesium grey

Epure Mirror-polished gold: 2 P+E sockets, Ivory

Epure Matt black/Bronze: 2 P+E sockets, Charcoal Grey

Epure Satin white: 2 P+E sockets, White

• Plates:

Brushed steel: brushed + galvanised with steel colour + varnish

Satin steel: steel colour + varnish

Mirror-polished steel: polished + galvanised with steel colour

Mirror-polished gold: polished + galvanised with 24-carat gold

Bronze: brass + oxidation + patina and brushed + varnish

Matt black: brass + matt paint

Satin white: brass + satin-finish paint

• Mechanism box: PC

Halogen-free

UV-resistant

Self-extinguishing:

850°C/30 s for insulating components holding live parts in place

650°C/30 s for other insulating components

■ 6.3 Electrical characteristics

Voltage: 250 V~

Current: 16 A

Frequency: 50/60 Hz

■ 6.4 Climate characteristics

Storage temperature: - 10°C to + 70°C

Operating temperature: - 5°C to + 35°C

7. CARE

Clean and dust using a soft, damp cloth (dampened with water) or wipes impregnated with a product containing less than 5% alcohol and anionic surfactant.

Caution: Always test before using other special cleaning products.

Banned products

- Solvents, various essential oils, paint, or adhesive tape,
- Scouring powders (because are abrasive),
- Products containing bleach,
- Special products for stainless steel,
- Renovators (because they often contain abrasives and chemical agents),
- Splashes or fumes from floor, paint, or wood stripping products, etc.

Caution:

Any mechanical attack or foreign object (screwdriver, etc.) striking the surface of the plate would damage the finish and therefore also the surface treatment.

8. STANDARDS AND APPROVALS

Compliant with installation and manufacturing standards.

See e.catalogue.