

Incara™ Disq'In

Cat. No(s): 6 547 40 to 51 - 6 547 55 to 57 - 6 547 59 to 61 - 6 547 63 to 65

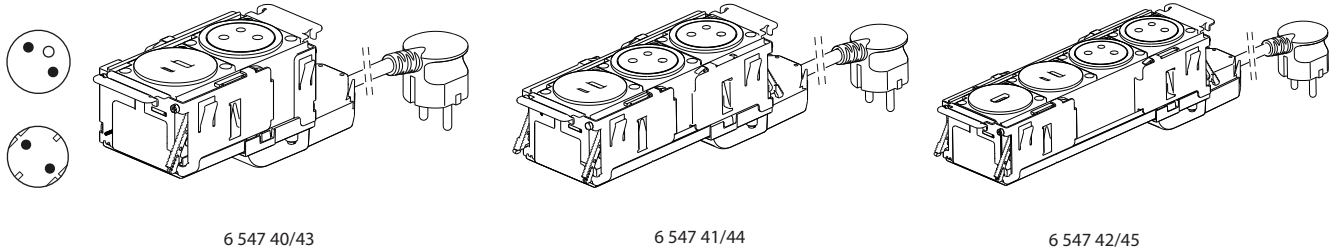

6 547 40/43

6 547 41/44

6 547 42/45

1. USE

Incara™ Disq'In is an aesthetic integrated solution for individual desks and meeting rooms tables. The range is available in 2, 3 and 4 gang and provides essential functions for workstation. Provided with fast fixing claws system, Incara™ Disq'In is easy and fast to install. For a perfect finish, metal plates are available in white, black or brushed metal.

2. RANGE

Incara™ Disq'In 2 m cord equipped with :			Standards	2 gang		3 gang		4 gang	
				White	Black	White	Black	White	Black
1x 2P+E	1 USB A+C	-	French	6 547 40	6 547 43	-	-	-	-
2x 2P+E		-		-	6 547 41	6 547 44	-	-	
		1 HDMI	-	-	-	-	6 547 42	6 547 45	
1x 2P+E		-	Schuko	6 547 46	6 547 49	-	-	-	-
	-	-		-	6 547 47	6 547 50	-	-	
2x 2P+E	1 HDMI	-		-	-	-	6 547 48	6 547 51	

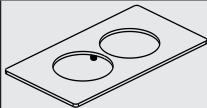
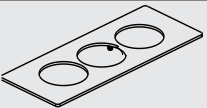
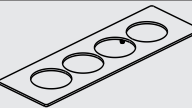
Metal finishes plates*	2 gang	3 gang	4 gang
			
Metal	6 547 55	6 547 59	6 547 63
White	6 547 56	6 547 60	6 547 64
Black	6 547 57	6 547 61	6 547 65

* Finishes (4 additional colors available on demand)

HDMI = coupler (female/female)

Other wiring devices configurations possible on demand

British Standard products available on request

3. DIMENSIONS

■ 3.1 Finishes plates Incara™ Disq'In

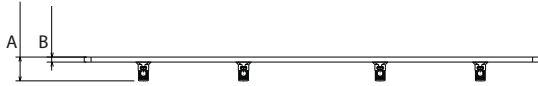

Cat. Nos	A	B
6 547 55/56/57	10.4	2.2
6 547 59/60/61		
6 547 63/64/65		

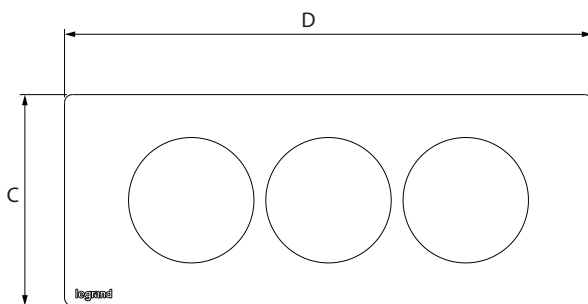

Cat. Nos	C	D
6 547 55/56/57	80	148
6 547 59/60/61		200
6 547 63/64/65		252

3. DIMENSIONS (cont.)

■ 3.2 2G-3G-4G Incara™ Disq'In: Top view

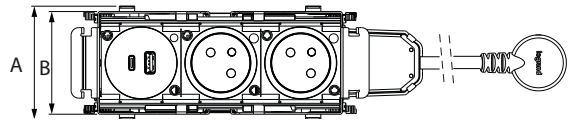

Cat. Nos	A	B
6 547 40/41/42/43/44/45/46 /47/48/49/50/51	74	67

■ 3.3 Incara™ Disq'In: Side view

2 gang

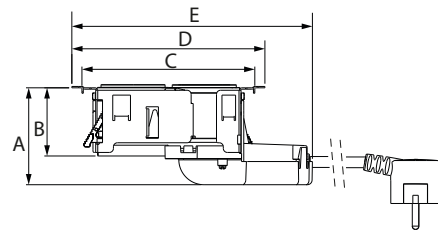

Cat. Nos	A	B	C	D	E
6 547 40/43/46/49	71	50	126.8	141.6	176.4

3 gang

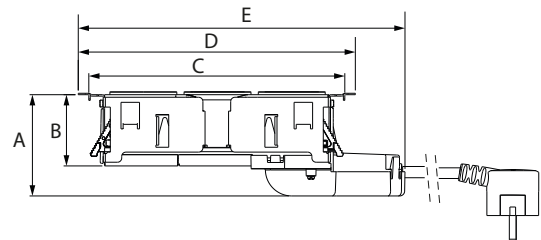

Cat. Nos	A	B	C	D	E
6 547 41/44/47/50	71	50	179.7	194.5	229.4

4 gang

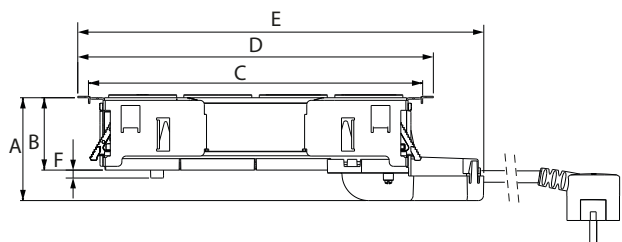

Cat. Nos	A	B	C	D	E	F
6 547 42/45/48/51	71	50	231	245.8	280.6	5.5

4. INSTALLATION

Must not be fitted on the floor

■ 4.1 Into the desk

4.1.1 Drilling dimensions

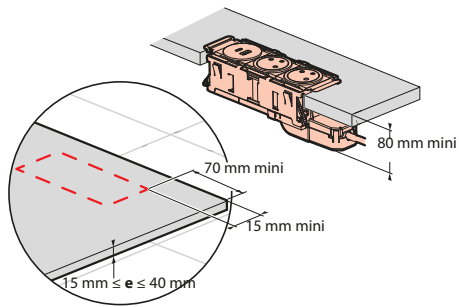

4.1.2 Max cut-out radius in corners

4.1.2.1 Sharp edges cut-out

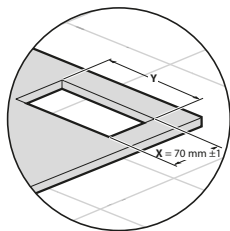

	Y ± 1mm
6 547 40/43/46/49	129,5
6 547 41/44/47/50	181,5
6 547 42/45/48/51	233,5

4.1.2.2 CNC machining cut-out



X	R1 MAX	R2 MAX
76	12	6

4. INSTALLATION (cont.)

4.1.3 Insertion and fixing

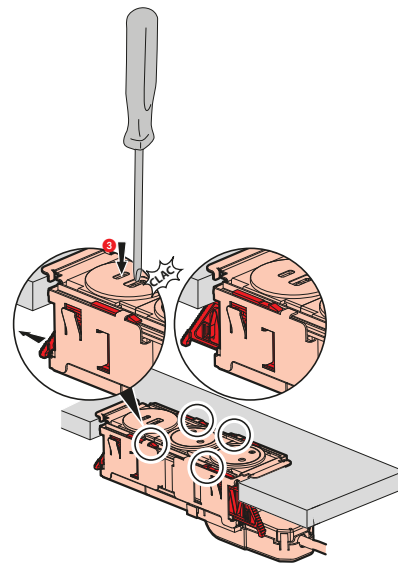
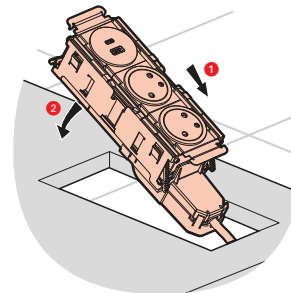

5. TECHNICAL CHARACTERISTICS

■ 5.1 Mechanical characteristics

Resistance to Impact : IK 07

Degree of protection provided by enclosures : IP 30

■ 5.2 Material characteristics

- Wiring devices frames : Polycarbonate

- Housing:

. ABS

. galvanised steel (Z275)

. aluminium

- Finishes plates:

. Brushed aluminium + varnish

. Painted aluminium: black mat

. Painted aluminium: white satin

■ 5.3 Electrical characteristics

5.3.1 2 P+E sockets characteristics

- Supply voltage: 250V~

- Frequency: 50/60 Hz

- Rated current:

. for French & Schuko standards = 16A

. for British standard : individually fused = 5A

5. TECHNICAL CHARACTERISTICS (cont.)

5.3.2 USB charger type (LXX15) :

Trade mark	
Address	128, av. du Maréchal-de-Lattre-de-Tassigny - 87045 LIMOGES Cedex Tel. : 0 (+33) 5 55 06 87 87 Fax : 0 (+33) 5 55 06 88 88 www.legrand.com
Input voltage	110-240V
Input AC frequency	50-60Hz
Output voltage	5,0V
Output current	3,0A
Output power	15,0W
Average active efficiency	83,9%
Efficiency at low load (10%)	83,3%
No-load power consumption	0,06W

5.3.3 Coupler RJ45 characteristics

5.3.3.1 Performance of link

Standard performance at 20°C
Following chart indicates maximal distances according to several configurations

CP Cord (C)	Maximum CP link (B)	TR Cord(s) (A)	Work Area Cord (D)	Total Channel
8 m	74 m	5 m	5 m	92 m
15 m	63 m			88 m
20 m	56 m			86 m

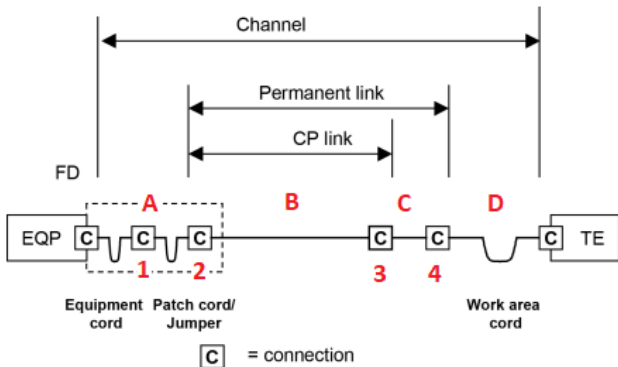

- 1 - Optional replication panel used only in specific 4-connector channels
- 2 - Panel
- 3 - Outlet (considered as a consolidation point)
- 4 - Incara Product (considered as an outlet in a 3-connector permanent link)

5. TECHNICAL CHARACTERISTICS (cont.)

5.3.3.2 POE Compliances

PoE++ type 1, 2, 3 and 4 according to 802.3 standard.

For more informations about performance with POE please refer to Legrand documentation (Legrand POE Guide)

5.3.4 Cords characteristics :

H05VV-F 3G 1.5mm²

■ 5.4 Audio/Video characteristics (HDMI coupler)

These values are subject to installation in accordance with good engineering practice and connection in compliance with current standards. Additional accessories and cords must comply with the same criteria.

5.4.1 HDMI 1.4

Maximum resolution (pixels) : 1080p

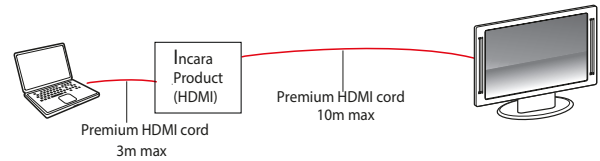

5.4.2 HDMI 2.0

Maximum resolution (pixels) : 2160p
16/9 format: 2160 p, 60Hz, RGB
21/9 format: 3840 x 2160p, 60Hz, RGB

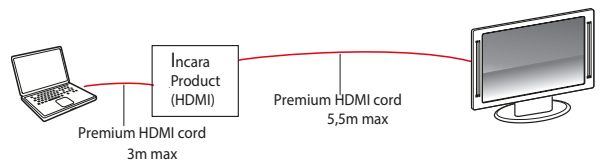

■ 5.5 Climate characteristics

Operating temperature : from -5°C to +35°C
Storage temperature: from -10°C to +70°C

6. CLEANING

Superficial cleaning with a soft cloth. Do not use abrasive products or detergents

Caution: Always test before using other special cleaning products

7. STANDARDS & APPROVALS

Compliant to:

Standards			
French	Schuko	British	
		socket	complete product
NF C61-314 and IEC 60884-1	IEC 60884-1	BS 1363-2	BS 5733

USB charger compliant to IEC 62368-1

Products should be installed by competent persons to the current version of the local wiring regulations.
Please consult Legrand locally for further details.