

## Epure Style TV-R-SAT sockets

Cat. No(s): AR-68045 - AR-68145 - AR-68245 - AR-68345 - AR-68445

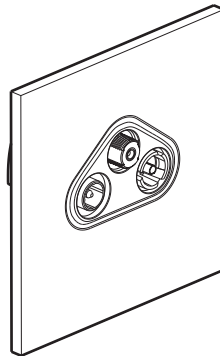

### 1. USE

TV/R/SAT: for receiving TV, radio and satellite signals.  
 UHD (ultra high definition) compatible and radio DAB+ (Digital Audio Broadcasting).  
 Class A shielded star sockets LTE Ready (4G protected)  
 Recommended coaxial cable 17/19 VATC.  
 Single cable entry.  
 Supplied with finishing plates.  
 For flush-mounting, back box to be min. 40 mm deep.  
 Fixing with screws.

### 2. RANGE

#### TV-R-SAT sockets - FM radio + DAB+

AR-68045	○ Configured Cat. No
AR-68145	● Brushed steel
AR-68245	● Brushed gold
AR-68345	○ Satin white
AR-68445	● Matt black

**Note:** Other finishes and styles are provided, see technical data sheet F02217EN/01.

### 3. OVERALL DIMENSIONS (mm)

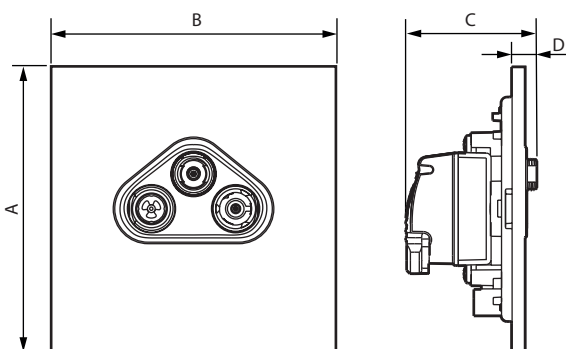

A	B	C	D
86	86	39,5	8

### 4. DISMANTLING

The plates can be dismantled by inserting the tip of a screwdriver in a purpose-designed notch on the sides of the plate and using it as a lever to unclip it from the fixing points.  
 Once the plate has been lifted off the wall slightly, just slide your fingers between the plate and the wall to gently remove the plate.  
 Take care not to pull too hard on the plate, to avoid breaking the fixing clips.

### 5. CONNECTION

#### 5.1 Connection

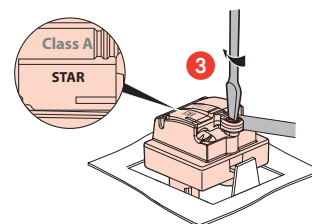
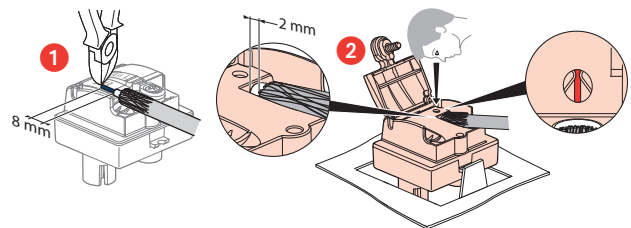

#### 5.2 Wiring instruction

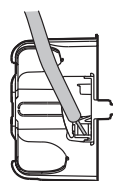
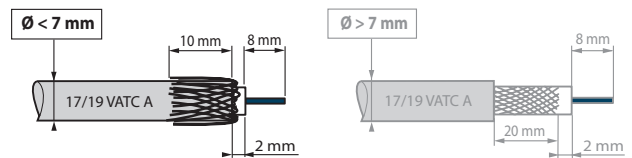

The rear connection minimises deformation of the coaxial cable, preventing loss of impedance and deterioration in performance.

## 6. TECHNICAL CHARACTERISTICS

### ■ 6.1 Mechanical characteristics

Impact test: IK 02

Ingress of solids/liquids: IP 20

### ■ 6.2 Material characteristics

• Plates:

Decorative brass: AR-68145 - AR-68245

Brass + paint: AR-68345 - AR-68445

Halogen-free

UV-resistant

• Support: steel with surface treatment

• Motor:

Case: Zamac

Cover: Zamac

Pin: Bronze

Screws: Zinc-plated Steel

Self-extinguishing: 650°C/30 s

### ■ 6.3 Electrical characteristics

Male connector Ø 9.52 mm (TV)

Female connector (Radio)

Female screw-type connector (SAT)

Characteristic impedance: 75 Ohm

Shielding efficiency: Class A (class A shielding is necessary to prevent interference caused by using new 3 and 4 G telephone signals, as these unwanted signals can generate on-screen pixellation or adversely affect the soundtrack).

Frequency bands: TV: 5-68 / 320-862 MHz

R: 87.5-240 MHz

SAT: 950-2400 MHz

UHD: Passage of the signals of improvement:

WCG: Wide Color Gamut

HDR: High Dynamic Range

HFR: High Frame Rate

DAB+: AAC+ codec passage defined in MPEG-4 part3

Insulation resistance: IEC 61169-24

Low attenuation: < 1.5 dB

### ■ 6.4 Climate characteristics

Storage temperature: - 10°C to + 70°C

Usage temperature: - 5°C to + 35°C

## 7. CARE

### ■ 7.1 Installation

To protect the products, it is essential to install them:

- once all surface coatings are completely dry,
- in a dry, non-aggressive environment,
- indoors only.

It is recommended that you install the plates only after the wall coatings have been completely finished (paint, fabrics, etc.).

### ■ 7.2 Instructions

Clean and dust using a soft, damp cloth (dampened with water) or wipes impregnated with a product containing less than 5% alcohol and anionic surfactant.

### ■ 7.2 Banned products

- Solvents, various essential oils, paint, or adhesive tape,
- Scouring powders (because are abrasive),
- Products containing bleach,
- Special products for stainless steel,
- Renovators (because they often contain abrasives and chemical agents),
- Splashes or fumes from floor, paint, or wood stripping products, etc.

**Caution:** Always test before using other special cleaning products.

Any mechanical attack or foreign object (screwdriver, etc.) striking the surface of the plate would damage the finish and therefore also the surface treatment.

## 8. STANDARDS AND APPROVALS

EN 50083-2

Class A certified

**9. PERFORMANCE**

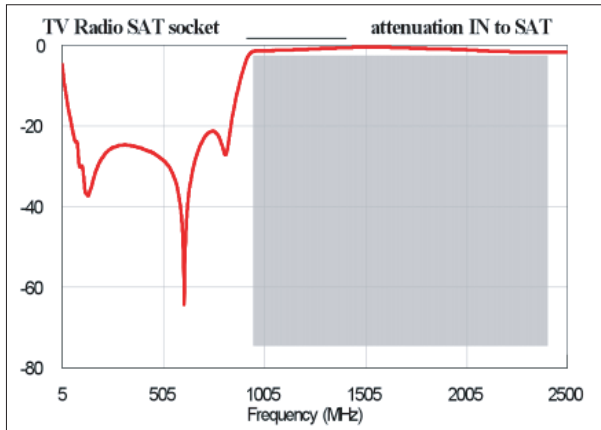
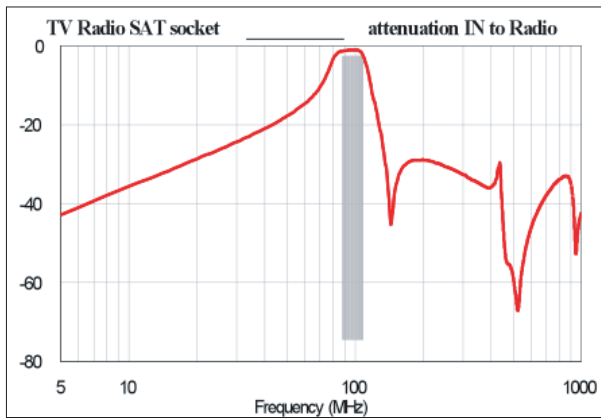
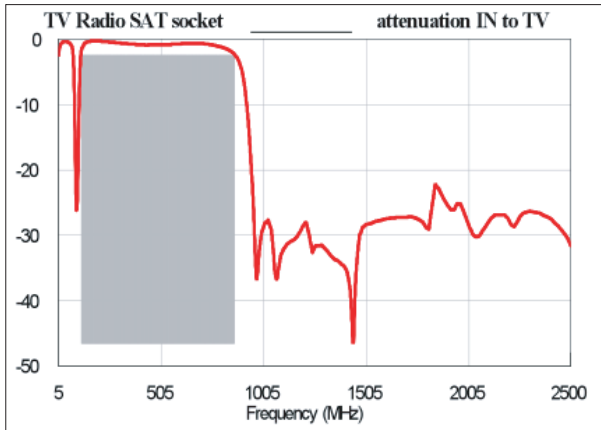

DAB Radio TV sockets

