

## Epure Style Data sockets Cat. 6

Cat. No(s): AR68041/42 - AR68141/42 - AR68241/42  
AR68341/42 - AR68441/42

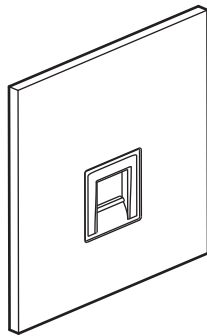

AR68x41

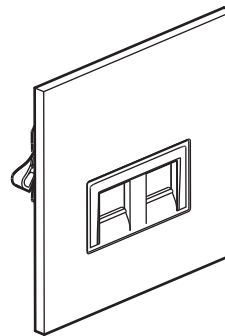

AR68x42

### 1. USE

Category 6 RJ 45 sockets.  
Take high-speed transmissions (Ethernet Gigabit).  
For flush-mounting, back box to be min. 35 mm deep.  
Fixing with screws.

### 2. RANGE

#### RJ 45 - single

AR68041	<input type="radio"/> Configured Cat. No
AR68141	<input type="radio"/> Brushed steel
AR68241	<input type="radio"/> Brushed gold
AR68341	<input type="radio"/> Satin white
AR68441	<input checked="" type="radio"/> Matt black

#### RJ 45 - twin

AR68042	<input type="radio"/> Configured Cat. No
AR68142	<input type="radio"/> Brushed steel
AR68242	<input type="radio"/> Brushed gold
AR68342	<input type="radio"/> Satin white
AR68442	<input checked="" type="radio"/> Matt black

**Note:** Other finishes and styles are provided, see technical data sheet F02217EN.

### 3. OVERALL DIMENSIONS (mm)

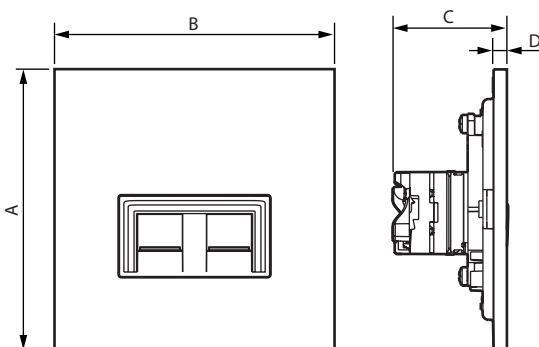

Cat. Nos	A	B	C	D
AR68x41	86	86	35	4
AR68x42	86	146	35	4

### 4. DISMANTLING

The plates can be dismantled by inserting the tip of a screwdriver in a purpose-designed notch on the sides of the plate and using it as a lever to unclip it from the fixing points.  
Once the plate has been lifted off the wall slightly, just slide your fingers between the plate and the wall to gently remove the plate.  
Take care not to pull too hard on the plate, to avoid breaking the fixing clips.

### 5. CONNECTION

Takes the following plugs: RJ 11 (4 contacts), RJ 12 (6 contacts), RJ 45 (8 contacts UTP and 9 contacts FTP).

EIA/TIA 568 A and B dual colour code on terminals:

- FTP 9 contacts
- STP 9 contacts with 360° shielding

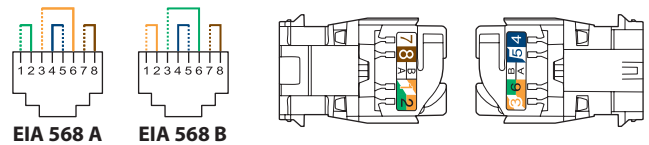

Permissible conductors:

- Single-core: 0.5 to 0.65 mm - AWG 22 to 25
  - Multicore: AWG 26
  - Polyethylene conductor insulation: maximum Ø on insulation 1.58 mm
- RJ 45 connectors are equipped with a locking nut. They do not require a special tool and can be re-wired if a mistake is made.

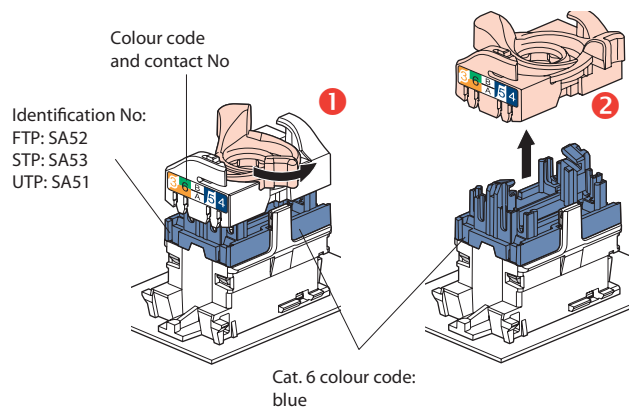

### 5. STANDARD RJ 45 CONNECTION (continued)

This system makes it easy to spread pairs before fitting them onto the connector

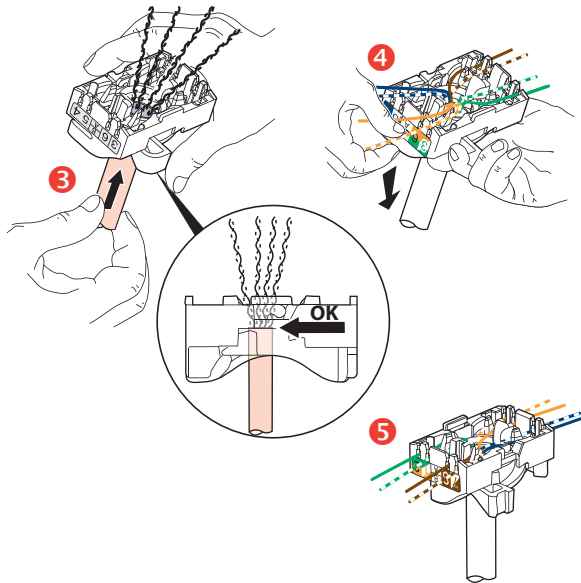

Spreading the cables ensures that a pair-breakage distance of 13 mm is kept between each pair.

Spreading pairs at 90° to the cable ensures the best possible performance

### 6. TECHNICAL CHARACTERISTICS

#### ■ 6.1 Mechanical characteristics

Impact test: IK 02

Ingress of solids/liquids: IP 20

#### ■ 6.2 Material characteristics

• Plates:

Decorative brass: AR68141/42 - AR68241/42

Brass + paint: AR68341/42 - AR68441/42

Halogen-free

UV-resistant

• Support: steel with surface treatment

• Motor:

Contacts: gold/nickel, thickness of gold > 0.8 µm minimum

Metal parts: bronze, nickel, platinum, gold

Mechanism housing: PP

Self-extinguishing: 650°C/30 s

#### ■ 6.3 Electrical characteristics

Breakdown voltage ≥ 1000 V

Contact resistance ≤ 20 mΩ

Insulation resistance ≥ 500 mΩ at 100 Vdc

Compatible remote powering "PoE" up to 100 W (IEEE 802.3af, IEEE 802.3at, IEEE 802.3bt).

#### ■ 6.4 Climate characteristics

Storage temperature: - 10°C to + 70°C

Usage temperature: - 5°C to + 35°C

### 7. CARE

#### ■ 7.1 Installation

To protect the products, it is essential to install them:

- once all surface coatings are completely dry,
- in a dry, non-aggressive environment,
- indoors only.

It is recommended that you install the plates only after the wall coatings have been completely finished (paint, fabrics, etc.).

#### ■ 7.2 Instructions

Clean and dust using a soft, damp cloth (dampened with water) or wipes impregnated with a product containing less than 5% alcohol and anionic surfactant.

#### ■ 7.3 Banned products

- Solvents, various essential oils, paint, or adhesive tape,
- Scouring powders (because are abrasive),
- Products containing bleach,
- Special products for stainless steel,
- Renovators (because they often contain abrasives and chemical agents),
- Pplashes or fumes from floor, paint, or wood stripping products, etc.

**Caution:** Always test before using other special cleaning products. Any mechanical attack or foreign object (screwdriver, etc.) striking the surface of the plate would damage the finish and therefore also the surface treatment.

### 8. STANDARDS AND APPROVALS

Compliant with installation and manufacturing standards.  
See e.catalogue.

**9. PERFORMANCE**

■ **9.1 Component performance (RJ 45 connectors)**

Return loss

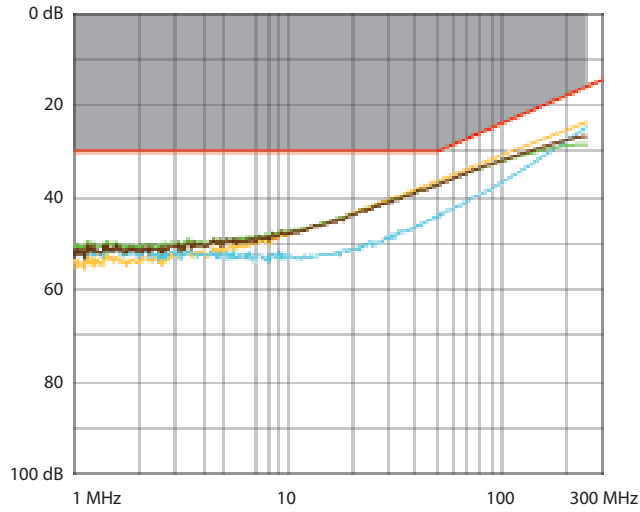

Attenuation

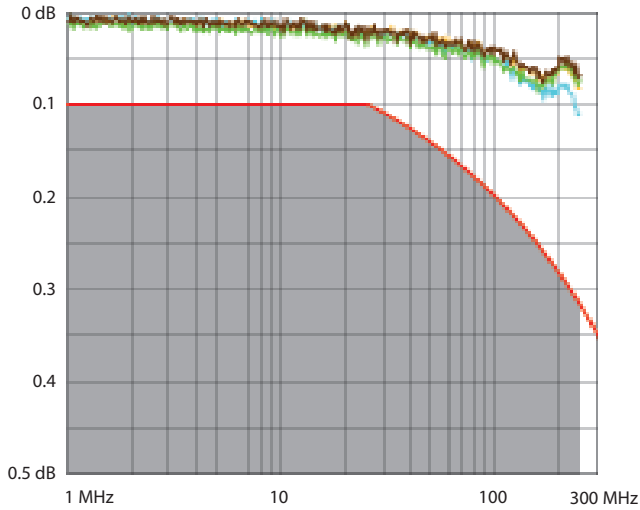

NEXT (Near end Crosstalk Attenuation)

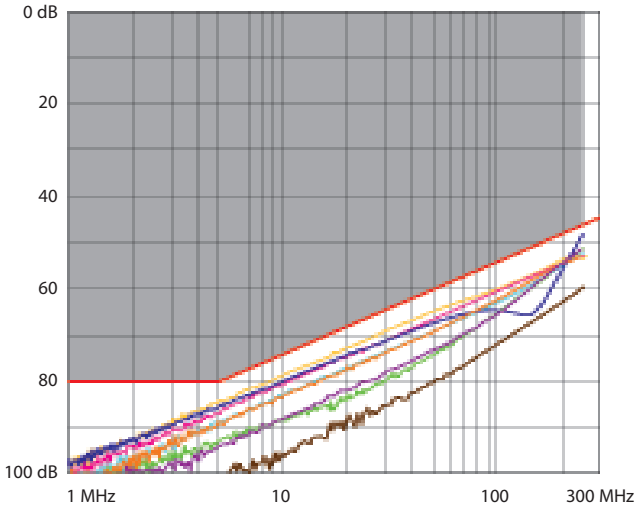

**9. PERFORMANCE (Cont.)**

■ **9.1 Component performance (RJ 45 connectors) (cont.)**

FEXT (Far end Crosstalk Attenuation)

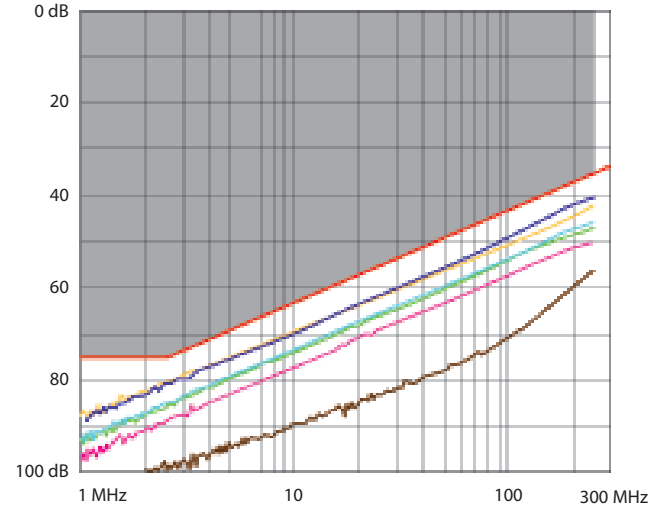

■ **9.2 Performance of permanent link with F/UTP cable**

Return loss

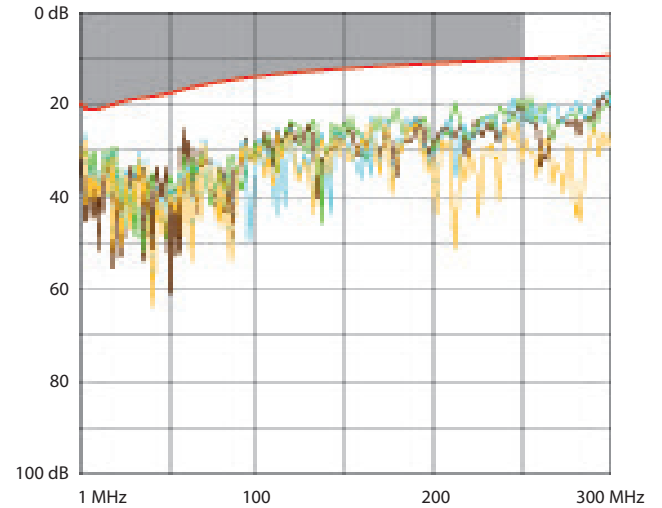

Attenuation

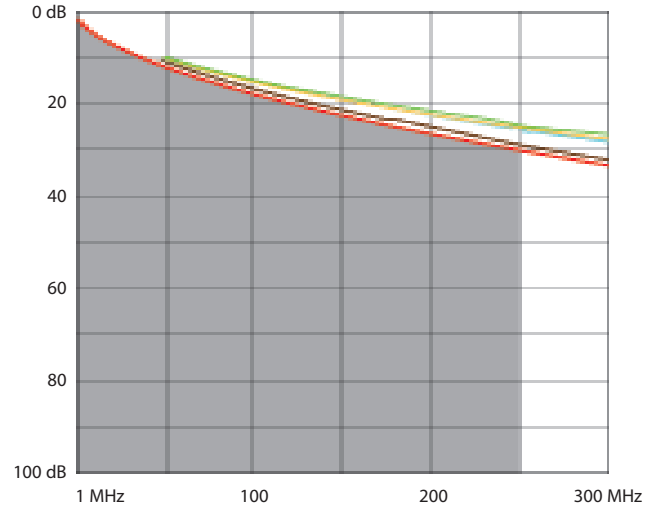

**9. PERFORMANCE (Cont.)**

■ **9.2 Performance of permanent link with F/UTP cable (Cont.)**  
NEXT (Near end Crosstalk Attenuation)

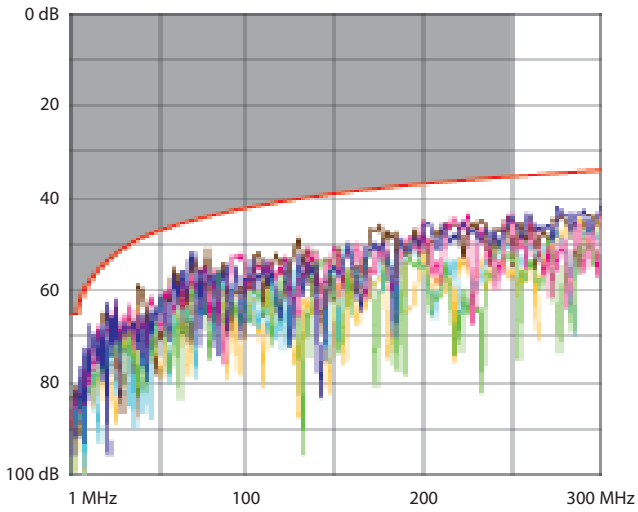

PS NEXT (Power Sum NEXT)

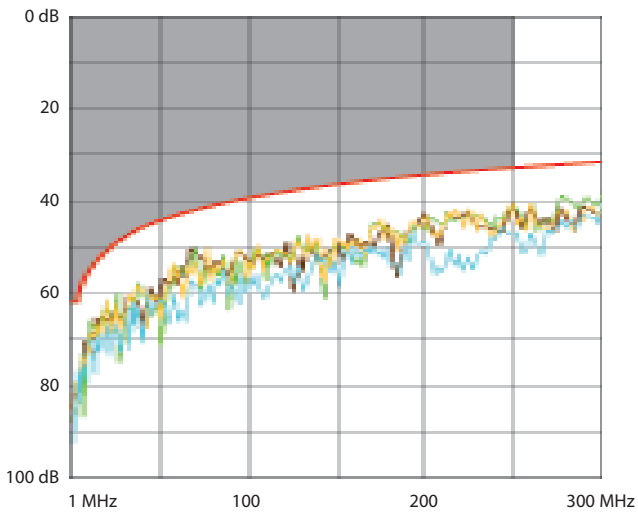

ACR (Attenuation to Crosstalk Ratio)

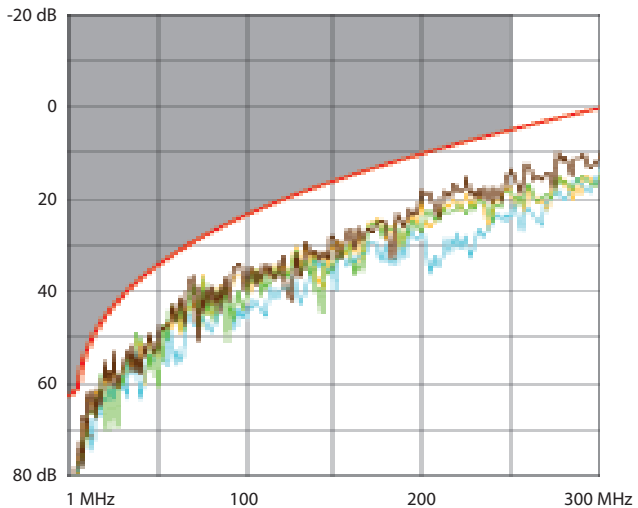

**9. PERFORMANCE (Cont.)**

■ **9.2 Performance of permanent link with F/UTP cable (Cont.)**  
ELFEXT (Equal Level End Crosstalk Attenuation)

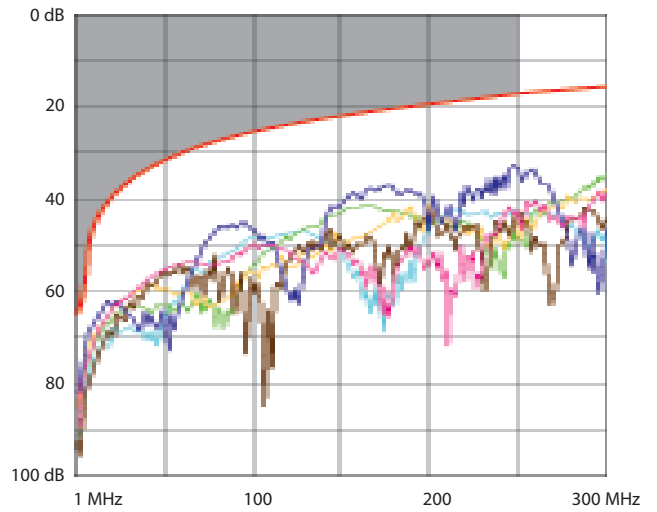

Delay skew

