

## Valena™ Allure Connected Wake up/Sleep wireless control

Cat. No(s): 7 525 89 - 7 526 89 - 7 527 89 - 7 528 89 - 7 529 89

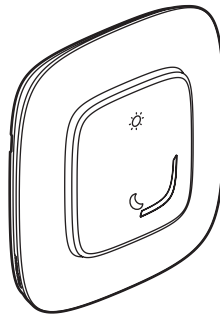

### 1. USE

Used to control wake up/sleep scenes involving lights, roller shutters and connected sockets.

- Fixes directly on the wall or screws onto a flush-mounting box. Multi-gang versions can be combined with other wiring accessories.
- Fits on a piece of furniture (movable).

### 2. RANGE

Description	White	Ivory	Aluminium	Black	Pearl
Wake up/Sleep wireless control, with battery. Supplied complete. Equipped with an LED indicator (configuration) and a RESET button (hidden) used to return to factory settings. Repositionable self-adhesive fixings supplied.	7 525 89	7 526 89	7 527 89	7 528 89	7 529 89

### 3. DIMENSIONS

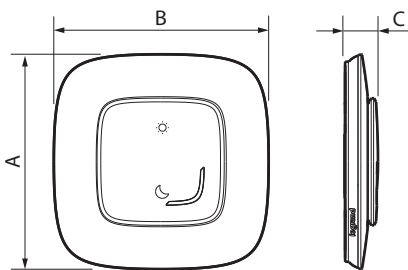

A	B	C
90	90	14

### 4. OPERATION

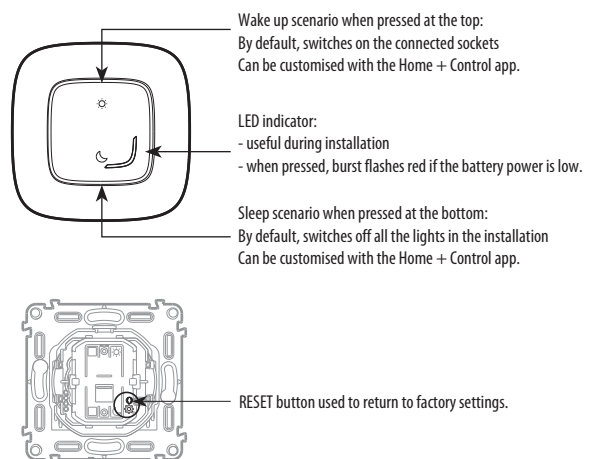

## 5. TECHNICAL CHARACTERISTICS

### ■ 5.1 Mechanical characteristics

Protection against impacts: IK 02  
Protection against solid bodies/liquids:  
- IP 20 without plate and rocker plate  
- IP 40 for assembled product

### ■ 5.2 Material characteristics

Plate: ABS  
Sub-plate: PC  
Rocker plate: ABS  
Mechanism with grid: Fibreglass-reinforced (10 %) PC  
Halogen-free  
UV resistant  
Self-extinguishing: 650°C/30 s

### ■ 5.3 Electrical characteristics

Powered by a CR2032 - 3 V lithium battery (supplied)  
Battery life: 8 years for 10 activations a day  
**ZigBee radio technology** frequency: 2.4 GHz to 2.4835 GHz  
Wireless mesh network, self-adaptive and secure (AES 128), conforming to standard IEEE 802.15.4 (LR-WPAN)  
Power level: < 100 mW

### ■ 5.4 Climate characteristics

Usage temperature: + 5° C to + 45° C  
Storage temperature: 0° C to + 45° C

## 6. CARE

Clean the surface with a cloth.  
Do not use acetone, tar-removing cleaning agents or trichloroethylene.  
Resistant to the following products: Hexane (EN 60669-1), methylated spirit, soapy water, diluted ammonia, bleach diluted to 10%, window-cleaning products, pre-impregnated wipes.

**Caution:** Always test before using special cleaning products.

The plates must not be painted.



Take care to recycle the battery appropriately

## 7. ACCESSORIES

0 648 71: Repositionable adhesive for wireless control (x 4 supplied)

## 8. STANDARDS AND APPROVALS

The undersigned, LEGRAND, declares that the radio-electric equipment type (7 525 89 - 7 526 89 - 7 527 89 - 7 528 89 - 7 529 89) complies with directive 2014/53/EU.

The full text of the EU declaration of conformity is available on the following website: [www.legrandoc.com](http://www.legrandoc.com)