

**Mémoire Metal style**  
**RJ 45 socket - Cat. 6**

Cat. No(s): AR-67125 - AR-67225

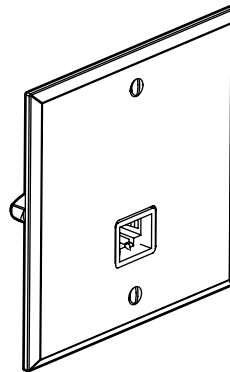

**1. USE**

Category 6 RJ 45 sockets.  
 Take high-speed transmissions (Ethernet Gigabit).  
 Supplied with finishing plates.

**2. RANGE**

AR-67125	● Brushed steel	RJ 45 socket Cat. 6 FTP
AR-67225	● Brushed gold	

**Note:** Other finishes and configurations are provided, see technical data sheet F02217EN/01.

**3. DIMENSIONS (mm)**

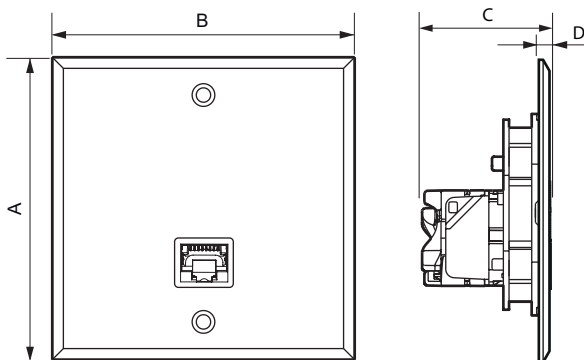

A	B	C	D
80	80	35	3.5

**4. ASSEMBLY**

- Do not use an electric screwdriver to tighten the screws when assembling wiring accessories.
- Take care not to overtighten the visible screws when assembling Mémoire style wiring accessories:
  - Risk of damaging the screw heads.
  - Risk of the screwdriver slipping and permanently scratching the plate.
  - Risk of the plate warping (bending), resulting in the plate not lying flat against the wall.
  - Use a flat screwdriver (4 mm wide, 0.8 mm thick) for the screws supplied on the wiring accessory.
- ART d'Arnoult electrical wiring accessories are supplied with long fixing screws which can be cut at several points to adapt the screw length to the box flush-mounting depth in the wall.

If ART d'Arnoult wiring accessories are being mounted in thick surfaces such as tiles, marble, wainscot panelling with flush-mounting boxes chased deep into the wall, the whole screw length can be used to fix the wiring accessory.

If ART d'Arnoult wiring accessories are being installed in walls with non-projecting flush-mounting boxes (masonry walls, dry partitions), the screws which can be cut at several points to shorten the thread.

To protect the products, it is essential to install them: once all surface coatings are completely dry, in a dry, non-aggressive environment, indoors only.

It is recommended that you install the plates only after the wall coatings have been completely finished (paint, fabrics, etc.).

**5. STANDARD RJ 45 CONNECTION**

Takes the following plugs: RJ 11 (4 contacts), RJ 12 (6 contacts), RJ 45 (8 contacts UTP and 9 contacts FTP).

EIA/TIA 568 A and B dual colour code on terminals:

- FTP 9 contacts
- STP 9 contacts with 360° shielding

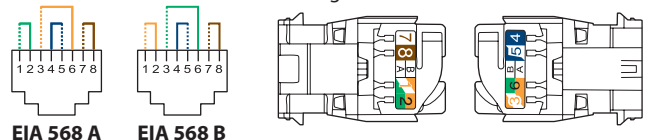

Permissible conductors:

- Single-core: AWG 22 to 26
- Multicore: AWG 26
- Polyethylene conductor insulation: maximum Ø on insulation 1.58 mm

## 5. STANDARD RJ 45 CONNECTION (continued)

RJ 45 connectors are equipped with a locking nut. They do not require a special tool and can be re-wired if a mistake is made.

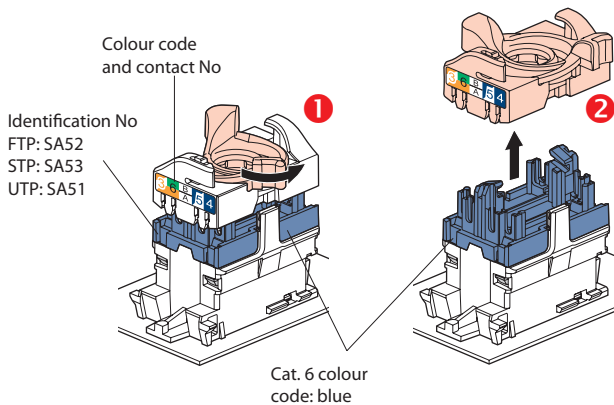

This system makes it easy to spread pairs before fitting them onto the connector.

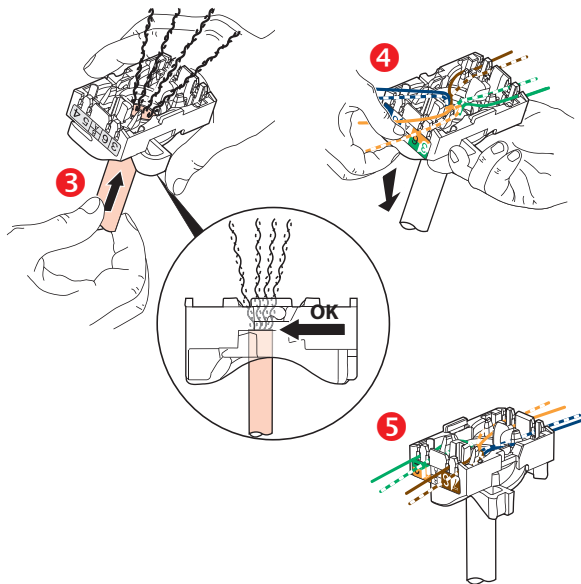

Spreading the cables ensures that a pair-breakage distance of 13 mm is kept between each pair.  
Spreading pairs at 90° to the cable ensures the best possible performance.

## 6. TECHNICAL CHARACTERISTICS

### 6.1 Mechanical characteristics

Impact test: IK 02  
Ingress of solids bodies and liquids: IP 20

### 6.2 Material characteristics

- Plates:
  - Brushed steel: brushed + galvanised with steel colour + varnish
  - Brushed gold: brushed + galvanised with 24-carat gold
- Chrome screws
- Moteur :
- Motor:
  - Contacts: gold/nickel, thickness of gold > 0.8 em minimum
  - Metal parts: bronze, nickel, platinum, gold
  - Box of the mechanism: Polycarbonate PBT

Self-extinguishing: 650°C/30 s

### 6.3 Electrical characteristics

Breakdown voltage  $\geq 1000$  V  
Contact resistance  $\leq 20$   $\Omega$   
Insulation resistance  $\geq 500$   $\Omega$  under 100 V Vdc  
Compatible remote powering « PoE » up to 100 W (IEEE 802.3af, IEEE 802.3at, IEEE 802.3bt).  
Tests are carried out with 2 simultaneous POE+ circuits for a minimum total power of 50 W.

### 6.4 Climate characteristics

Storage temperature: - 10°C to + 70° C  
Usage temperature: - 5°C to + 35°C

## 7. CARE

Clean and dust using a soft, damp cloth (dampened with water) or wipes impregnated with a product containing less than 5% alcohol and anionic surfactant.

**Caution:** Always test before using other special cleaning products.

### Banned products:

- Solvents, various essential oils, paint, or adhesive tape,
- Scouring powders (because are abrasive),
- Products containing bleach,
- Special products for stainless steel,
- Renovators (because they often contain abrasives and chemical agents),
- Splashes or fumes from floor, paint, or wood stripping products, etc.

### Caution:

Any mechanical attack or foreign object (screwdriver, etc.) striking the surface of the plate would damage the finish and therefore also the surface treatment.

## 8. STANDARDS AND APPROVALS

Compliant with installation and manufacturing standards.  
See e.catalogue.