

# Cat. 5e RJ 45 110 Keystone

Cat. No(s): 6 327 03/04

## CONTENTS

Page

- 1. General characteristics . . . . . 1
- 2. Presentation . . . . . 1
- 3. Technical characteristics . . . . . 1
- 4. Overall dimensions . . . . . 2
- 5. Usual connection of RJ45 sockets . . . 2
- 6. Standards and approvals . . . . . 3
- 7. Performance . . . . . 3

### 1. GENERAL CHARACTERISTICS

Category 5e RJ45 socket.  
Enables high speed data transmission (Gigabit Ethernet).

### 2. PRESENTATION

Référence	Désignation	UTP	FTP	Weight (g)
6 327 03	Keystone RJ45 UTP socket cat.5e	G01		5,88
6 327 04	Keystone RJ45 FTP socket cat.5e		G03	12,68

6 327 04

### RJ45 Cat 5e FTP 110 Keystone

A	green	C	orange
B	blue	D	brown

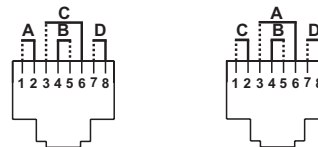

EIA 568 A

EIA 568 B

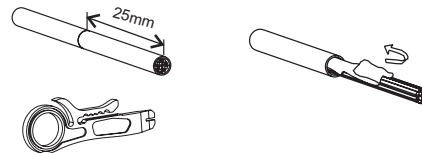

6 327 03

### RJ45 Cat 5e UTP 110 Keystone

A	green	C	orange
B	blue	D	brown

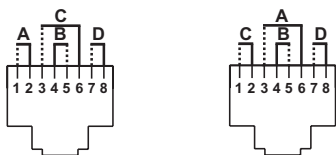

EIA 568 A

EIA 568 B

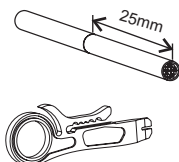

### 3. TECHNICAL CHARACTERISTICS

#### 3.1 Material characteristics

Contacts: gold/nickel, minimum thickness of gold > 1,27 µm  
Metal parts: bronze  
Polycarbonate

#### 3.2 Electrical characteristics

Breakdown voltage ≥ 1000 V  
Contact resistance ≤ 20 mΩ  
Insulation resistance ≥ 500 MΩ at 100 V DC

#### 3.3 Mechanical characteristics

Max. number of connections and disconnections: 5 without refreshing the wiring.  
Endurance: 750 movements (plug insertion/withdrawal)

#### 3.4 Climatic characteristics

Operating temperature: - 40° C to + 70° C  
Humid heat cycle 21 days

4. OVERALL DIMENSIONS

6 327 03

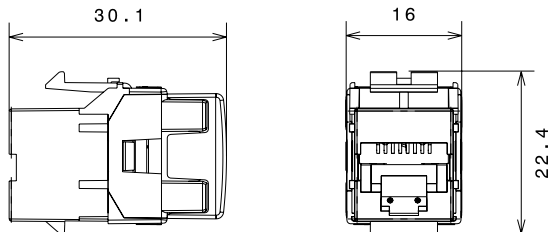

6 327 04

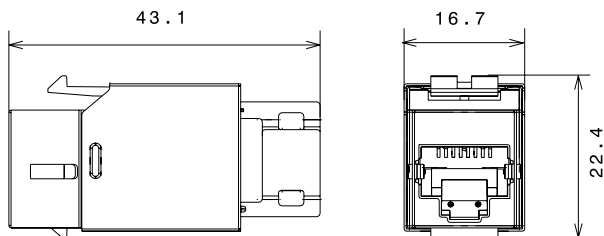

5. USUAL CONNECTION OF RJ 45

6 327 03

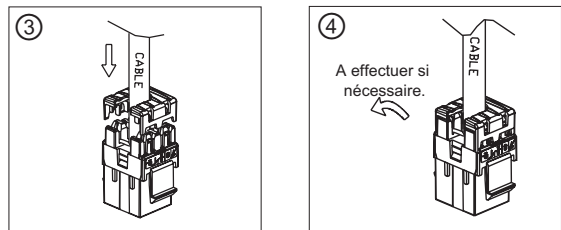
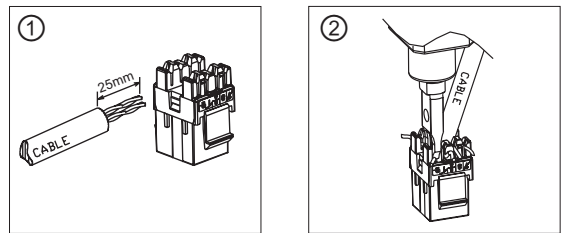

6 327 04

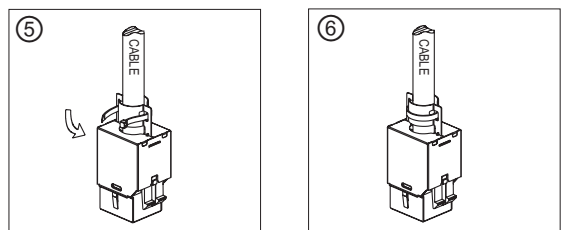
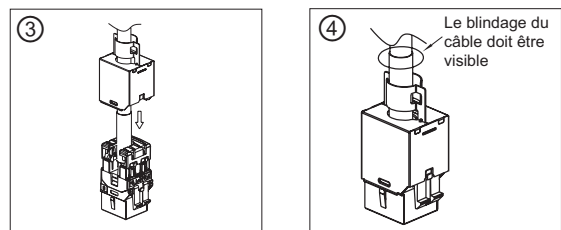
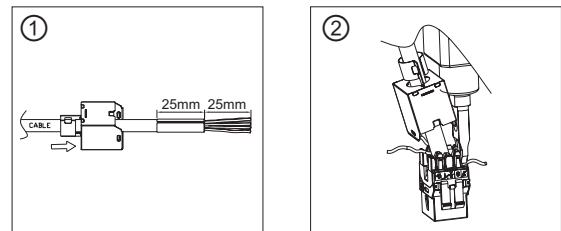

Accepts the following cable connectors:  
 RJ11 (4 contacts), RJ12 (6 contacts), RJ45 (8 contacts).  
 Double colour code EIA – TIA 568 A and B on terminals:  
 - STP 9 contacts 360° screen

Conductors supported:  
 - AWG 22 to 26  
 - Multiple-wire: AWG 26  
 - Polyethylene conductor insulation

**6. STANDARDS AND APPROVALS**

Conforms to standards: ISO 11801 Edition 2  
 CENELEC EN 50173-1 2007  
 EIA/TIA 568-C2  
 ISO/IEC series 60603-7

**7. PERFORMANCES**

Component performance (RJ 45 connectors)

Return Loss

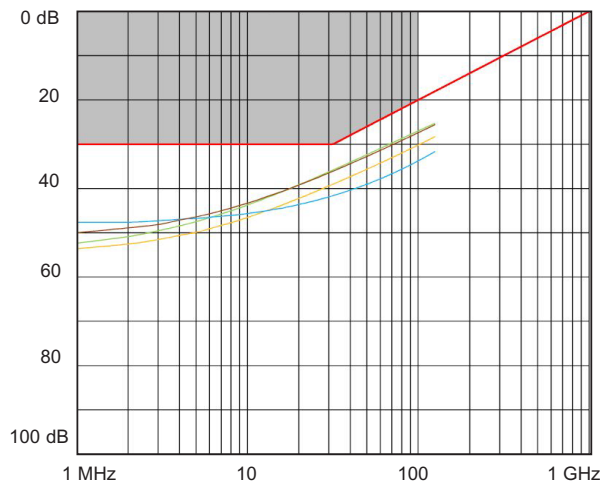

Attenuation

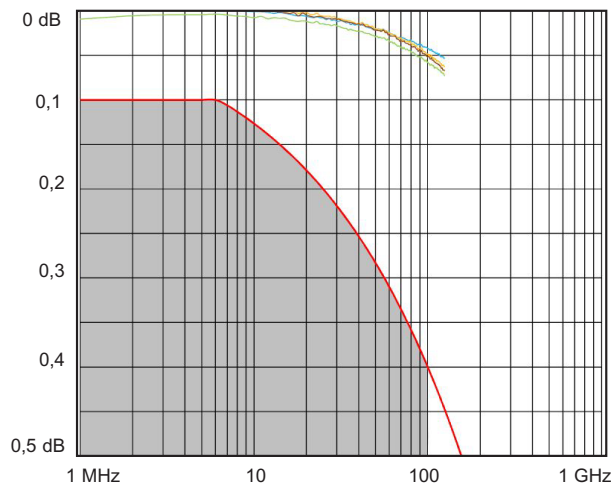

**7. PERFORMANCES (suite)**

Component performance (RJ 45 connectors)

FEXT (Far end Crosstalk Attenuation)

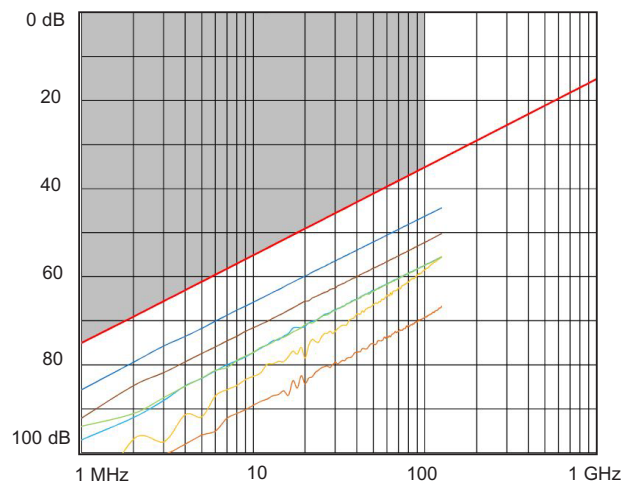

NEXT (Near end Crosstalk Attenuation)

