

Pop-Up floor

Cat. No(s) : 0 540 00 to 03 – 0 540 05 to 08 – 0 540 10 to 13 – 0 540 15 to 18 – 0 540 20 to 23 – 6 503 31 – 6 503 90

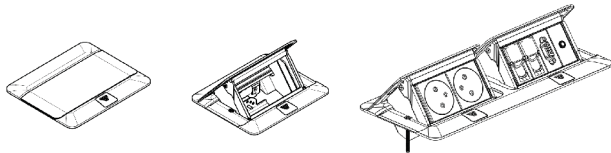

CONTENTS

Page

1. Use	1
2. Range	1
3. Installation	3
4. Cabling	6
5. Examples of wiring devices installation	8
6. Technical characteristics	9

1. USE

Floor pop-up range is a solution for integration of wiring accessories in raised or concrete floor.
Floor pop-up are conform to NFC 61-314 / EN 60 670-1 / EN 60 670-23.

Raised floor		For safety reasons, the installation kit is mandatory for installation in a raised floor.	Compatibility : - Power - Data (Cat 6) - Audio/Video
Concrete floor		Use metal or plastic back boxes	Compatibility : - Power

2 types of Pop-up :

single		double	
3 modules	4 modules	6 modules	8 modules

2. RANGE

Pop-up to be equipped with Mosaic functions

Finishes	3 modules	4 modules	6 (2x3 modules)	8 (2x4 modules)
Brushed brass	0 540 15	0 540 16	0 540 17	0 540 18
Matt aluminium	0 540 10	0 540 11	0 540 12	0 540 13
Brushed stainless steel	0 540 20	0 540 21	0 540 22	0 540 23

Note: screws delivered with Pop Up
Maximum power: 16A 250 V~, 3680W en 230 V~per circuit

2. RANGE (CONT.)

2.1 Overall dimensions

2.1.1 Floor pop-up lid

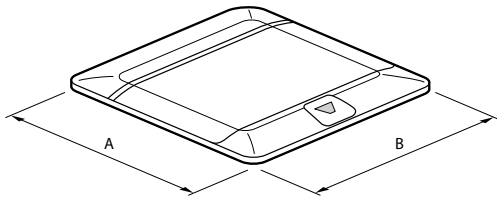

Floor pop-up	A (mm)	B (mm)
3 modules	120	120
4 modules		142.5
6 modules		230
8 modules		275

2.1.2. Empty floor pop-up

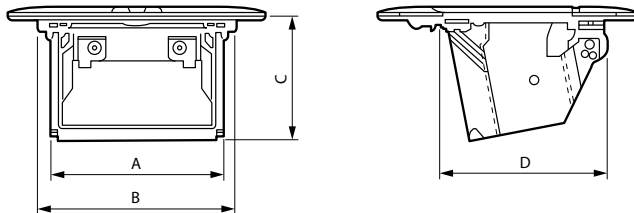

Floor pop-up	A (mm)	B (mm)	C (mm)	D (mm)
3 modules	79.8	92	57	77.5
4 modules	102.3	114.5		
6 modules	189.8	202		
8 modules	231.6	247		

2.1.3 Pop-up with installation kit for raised floor

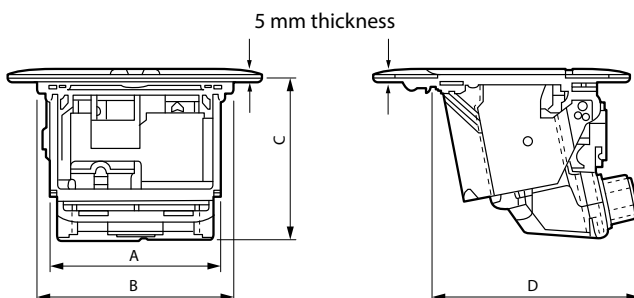

Floor pop-up	A (mm)	B (mm)	C (mm)	D (mm)
3 modules	79.8	92	57	77.5
4 modules	102.3	114.5		
6 modules	189.8	202		
8 modules	231.6	247		

2.2 Floor pop-up opening

When closed, the pop-up is locked.

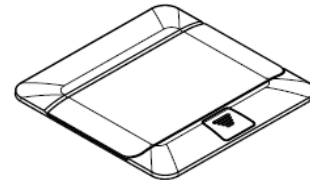

Press on the button to unlock the safety system.

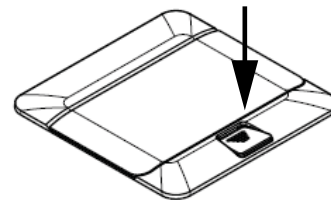

Pull the button.

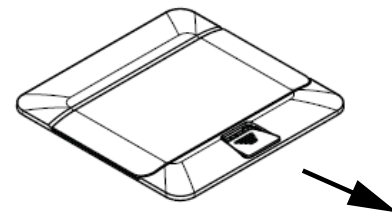

The trap door rises.

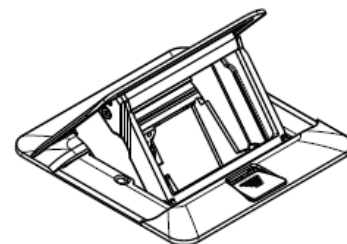

The button is positioned back automatically and the trap is locked when it is in high position (open).

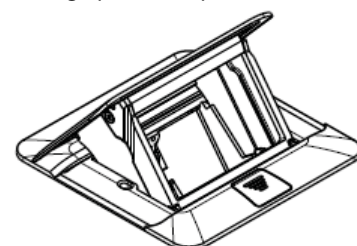

To close again the Pop-up, it is necessary to press and pull to unlock.

3. INSTALLATION

3.1 on concrete floor with metal or plastic back boxes

Minimum screed depth = 60mm

To be used with conduits diameter 20mm, delivered with protection cover

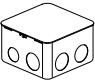
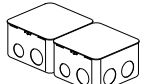
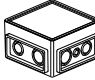
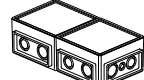
		Pop up			
		3 modules	4 modules	6 (2x3) modules	8 (2x4) modules
metal					
		0 540 00	0 540 01	0 540 02	0 540 03
plastic					
		6 503 90	-	6 503 91	-

Dimensions

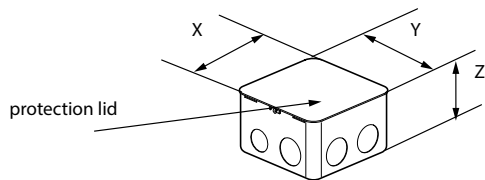

metal	X (mm)	Y (mm)	Z (mm)
3 modules	100	100	61.2
4 modules		122	
6 (2x3) modules		210	
8 (2x4) modules		255	

plastic	X (mm)	Y (mm)	Z (mm)
3 modules	112	112	62.2
6 (2x3) modules		222	

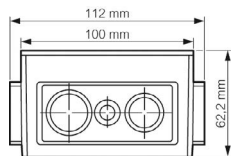

Concrete floor fixing centres (A)

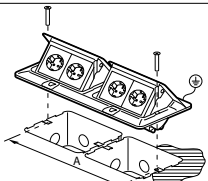
	metal & plastic	A (mm)
	3 modules	84
	4 modules	106.5
	6 (2x3) modules	194
	8 (2x4) modules	239

IMPORTANT :

If $e < 10\text{mm}$, conduits diameter 20mm must enter the back box by the back side, for all boxes 3, 4, 6 and 8 modules

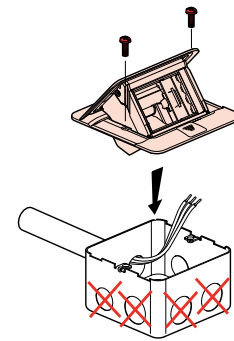
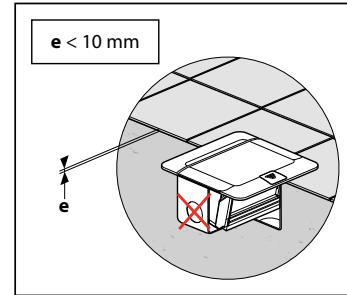

If $e > 10\text{mm}$, conduits diameter 20mm must enter the back box by the front side, for all boxes 3, 4, 6 and 8 modules

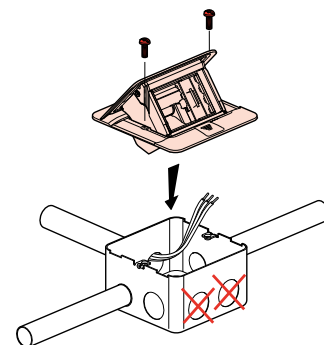
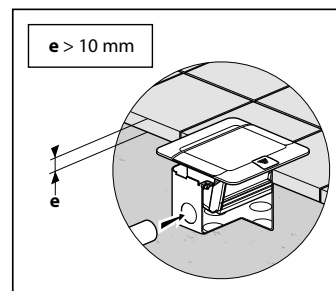

3. INSTALLATION (CONT.)

■ 3.1 on concrete floor with metal or plastic back boxes (cont.)

Pop-up is delivered with terminal block.

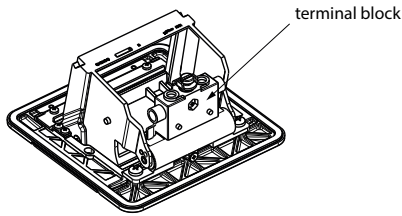

(1) It is necessary to close the back box for concrete using the protection cover delivered with before (2) pouring the concrete in order to prevent that the concrete to enter in the backbox

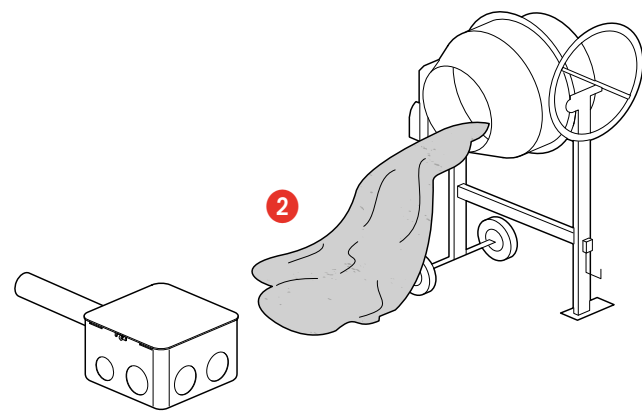
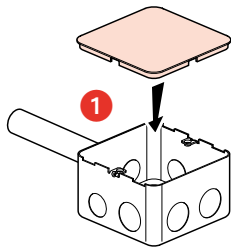

(3) Before the installation of pop-up, remove the cover protection delivered with the back box

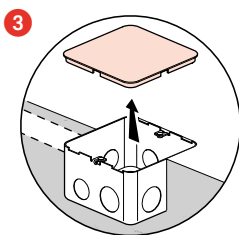

(4) Before fitting coating, adjustment of the level (3mm mini)

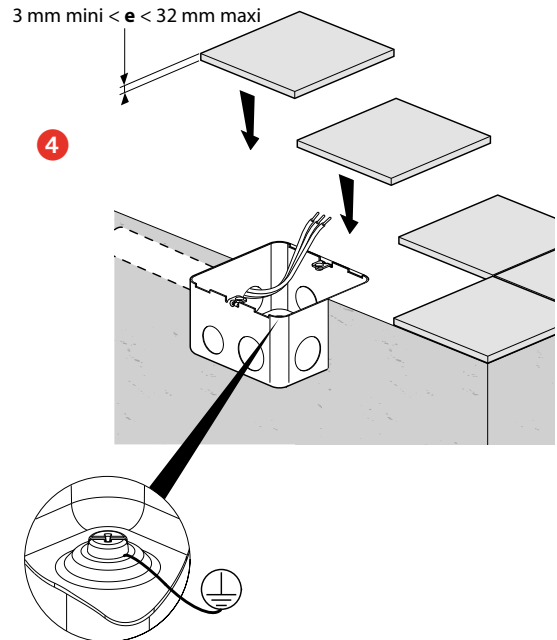

(5) Installation of Pop-up on the concrete floor by screwing on the back box

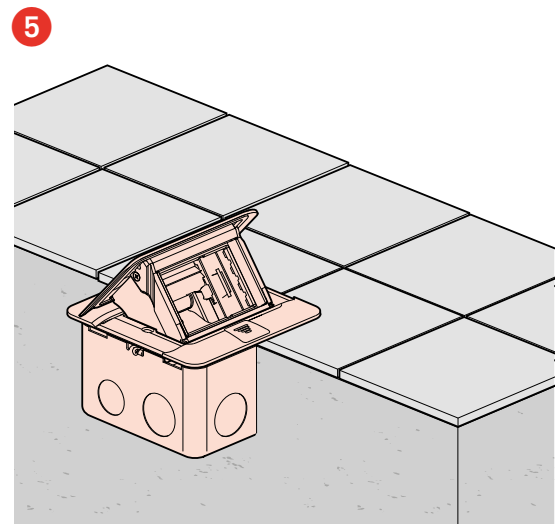

3. INSTALLATION (CONT.)

3.2 in a raised floor with the mandatory installation kit

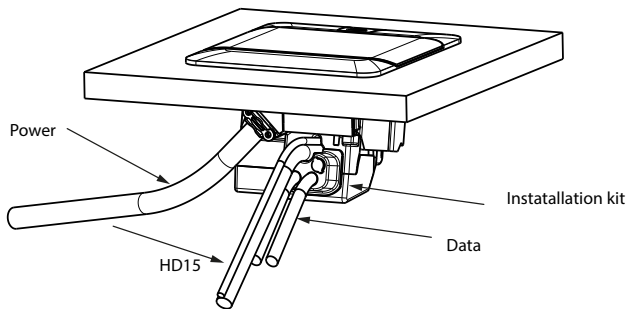

Cat. nos	Modules number
0 540 05	3
0 540 06	4
0 540 07	6
0 540 08	8

Contents

1 insulation unit

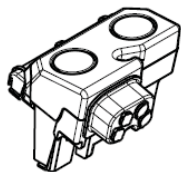

1 clamp support

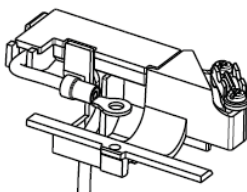

1 fixing bracket set

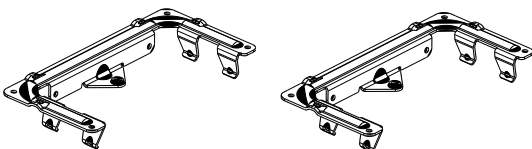

Specific fixing brackets allowing to install the product directly on the raised floor

Raised floor cut out

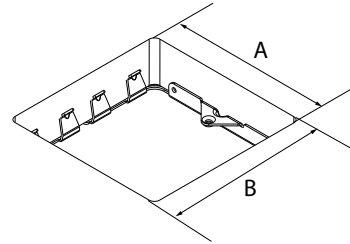

	A (mm)	B (mm)
3 modules	108 (+/-1mm)	108 (+/-1mm)
4 modules	108 (+/-1mm)	131 (+/-1mm)
6 modules	108 (+/-1mm)	218 (+/-1mm)
8 modules	108 (+/-1mm)	263 (+/-1mm)

Positioning of the fixation brackets in raised floor

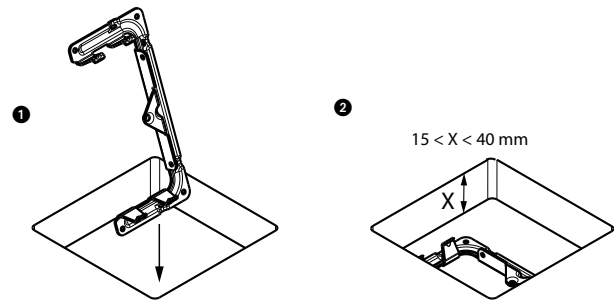

The retaining claws are positioned against the raised floor (if the cut-out is not correctly made, fasten the bracket with screws in the corners)

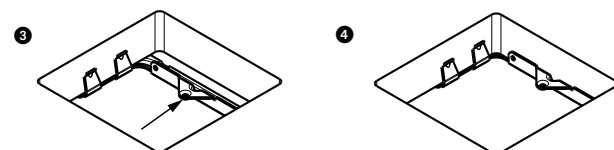

The round holes located in the four corners of the bracket allow fixing with nails if necessary (when the cut-out is oversized)

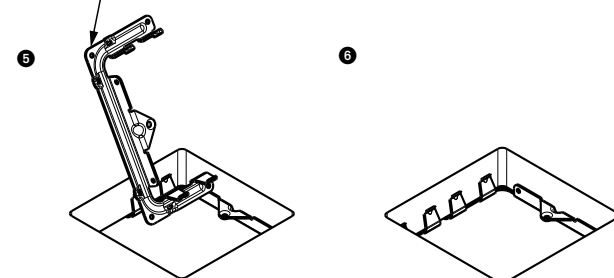

4. CABLING

Before the installation of the kit, remove the terminal block delivered with the Pop-up (not to be used in this configuration)

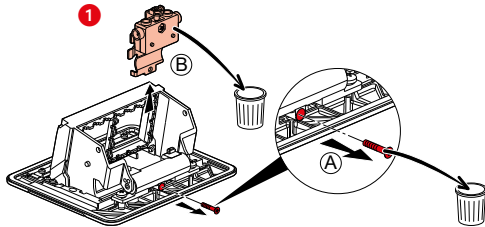

Please use the clamp support if you need power
 A : put the clamp support on the cylindrical dumper fix with the earthing screw
 B : earth on the metal part on the Pop-up

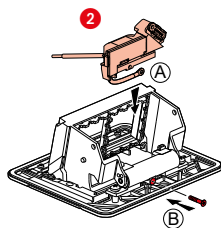

Support clamp is not necessary if you use only data socket

Position your fingers as represented above,

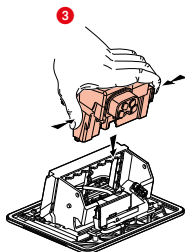

Press the kit and insert it in the Pop-up until clic.

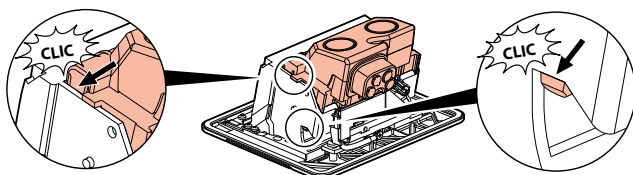

■ 4.1 Power installation

Assembly of the power cable in the Pop-up before the connection to wiring devices:

1- Remove the cable clamp

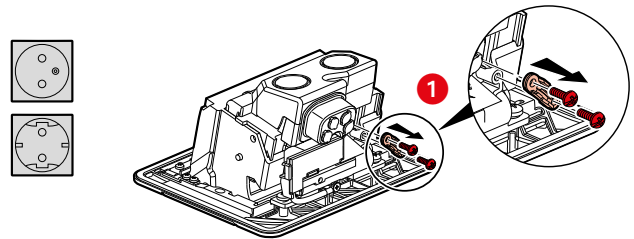

Wiring devices connection:

Type of terminals : automatic with side connections
 Number of terminals : 3 inputs – 3 outputs
 Terminal capacity : 2 x 2,5 mm²
 Stripping length : 12 mm

2- Insert the cable (please use only flexible cable) through the clamp support..

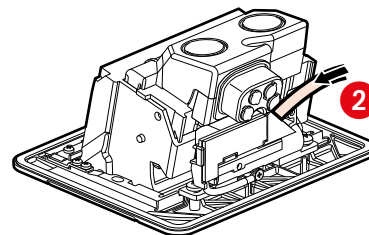

3- Let exceed only the stripped part of the cable inside the Pop-up

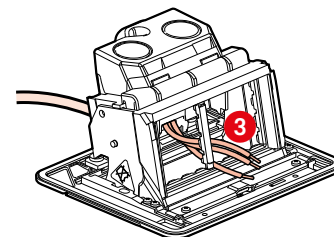

4-Lock the cable with the cable clamp

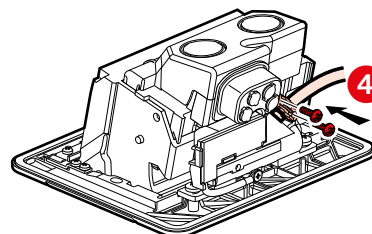

Connect the sockets cable before clipping on the support.

4. CABLING (CONT.)

4.2 Low power installation

4.2.1 RJ45 sockets installation

Assembly of the Ethernet cable for network in the Pop-up before the connection to RJ 45 sockets:

Remove the cable exit:

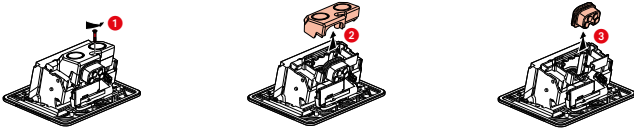

1- Cut out the protective cap according to the number of cable (4 max)

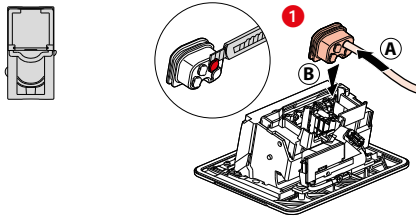

2- Pass the cables through the support to connect the sockets and clip them on the frame

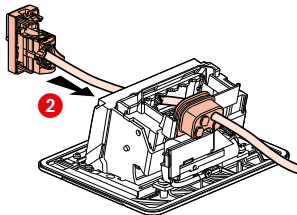

3- Reposition the cable exit and block the cable using the cable tie

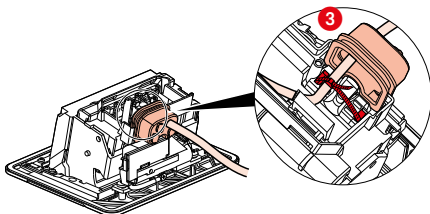

Reassemble the cover with its screw to finalize the installation

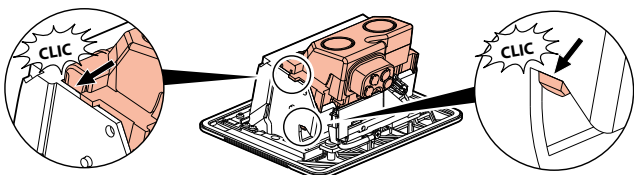

4.2.2 Audio/video sockets installation

Assembly of the Audio cable in the Pop-up before the connection to HD 15 sockets :

Remove the cable exit:

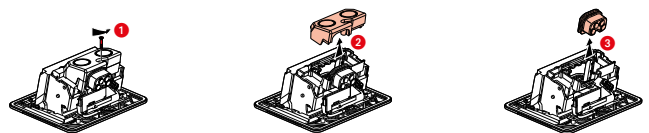

1- Pass the cable through the support to connect the HD 15 sockets
2- Break the strip allowing the passage of the cable

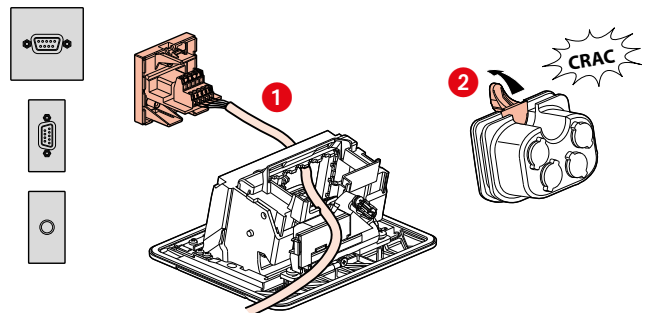

3- Position the cable in its receptacle and reposition the cable exit.

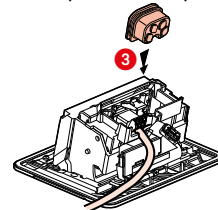

4- Lock the cable using the cable tie.

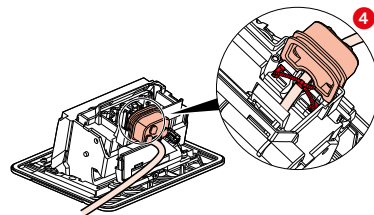

Reassemble the cover with its screw to finalize the installation

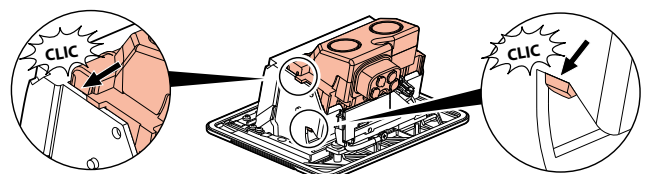

Note: in the case of audio/video mixed equipment (HD 15 + jack 3.5mm) equipped with two cords, proceed in the same way.

4. CABLING (CONT.)

Specific rules for data cable

(Network installation cables may be stiffer than standard office Ethernet patch cords. In this case, the cables must be managed as shown in the views below, ensuring full opening of the Pop-Up)

To respect the bend radius for data cables, it is necessary to fix the cables by respecting a radius higher than 80mm (curve of the cable at the exit on the kit and the points of fixing of the cable on the fixation brackets).

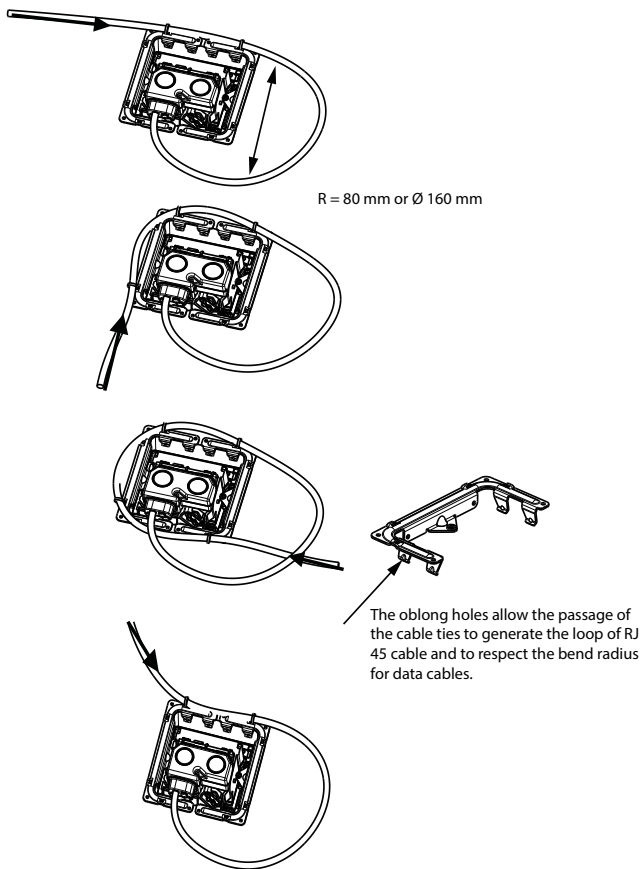

Maximun cable for data in assembly in a raised floor : cable 6a F/UTP

Note : if installation with several cables, they must be attached together using a cable tie

5. EXAMPLES OF WIRING DEVICES INSTALLATION

In Pop-Up sol 3 modules :

1 socket German standard 2P+E + 1 RJ 45 socket Cat6 UTP

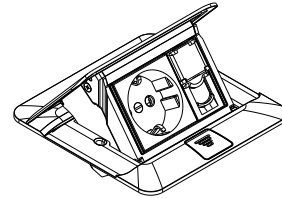

In Pop-up 4 modules :

2 sockets German standard 2P+E

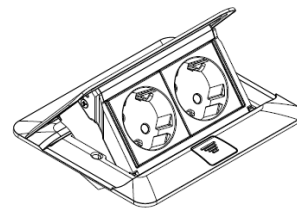

Or 1 socket German standard 2P+E + 2 RJ 45 sockets Cat6 UTP

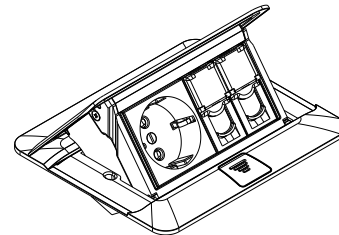

In Pop-up 2x3 modules :

1 socket German standard 2P+E + 1 blanking plate + 1 RJ 45 socket Cat6 UTP + 1 HD 15

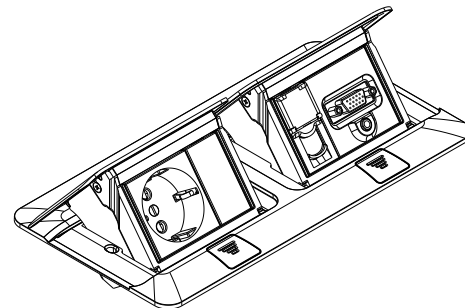

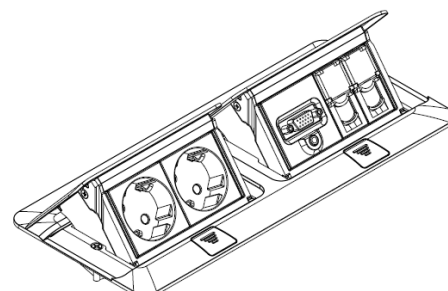

In Pop-up 2x4 modules :

2 sockets German standard 2P+E + 1 HD 15 + 2 RJ 45 sockets Cat6 UTP



6. TECHNICAL CHARACTERISTICS

6.1 Compatibility table of installable wiring devices

	Type of sockets (Mosaic & Arteor)
Power	
Data & Audio Video	

Please note that:

- for unswitched british standard socket you have to install it at 90°

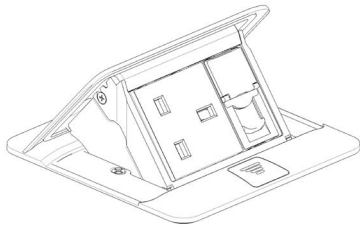

- for switched british standard socket, you have to install the mechanism at 180°.

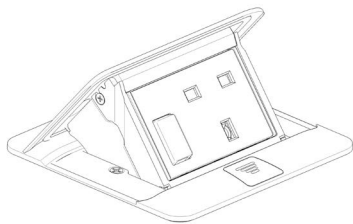

6.2 Classification for Pop-up according to Standard NFC 61-314 / EN 60 670-1 / EN 60 670-23)

Rated voltage	250 V~
To earth the system	R < 0,05 Ohms
Protection against mechanical impact	IK07
Degrees of protection provided by enclosure	IP30 open - IP40 closed
Resistance to vertical load applied through small surface area	1500N open - 3000N closed
Insulation resistance	U=500V - R > 5M Ohms
Electric strength	2000V
Installation on the floor	to be installed on floor subjected to a dry treatment

Material :

Material halogen free, fire proofed and no propagator of the flame.
Resistant to corrosion and to the changes of temperature

Finishes	Material
Polished stainless steel	Zamak nickel coating
Brushed brass	Brass material
Matt aluminium	Aluminium material

Installation : On the floor (raised floor or concrete floor)

Safety: Earthing of the product is mandatory

Installation and removal:

45-format devices are installed directly into the wiring devices supports (installation is carried out from the front).

The wiring devices supports can be removed from the pop-up using a cross-head screwdriver.

Cleaning:

Clean using a dry cloth (if a cleaning product is used, avoid any contact with live parts).

Do not use abrasive products.Cleaning: