

**Synergy®**  
**2A, 5A and 15A round pin socket outlets**

Cat. No(s) : 7300 59/68/69/88/89

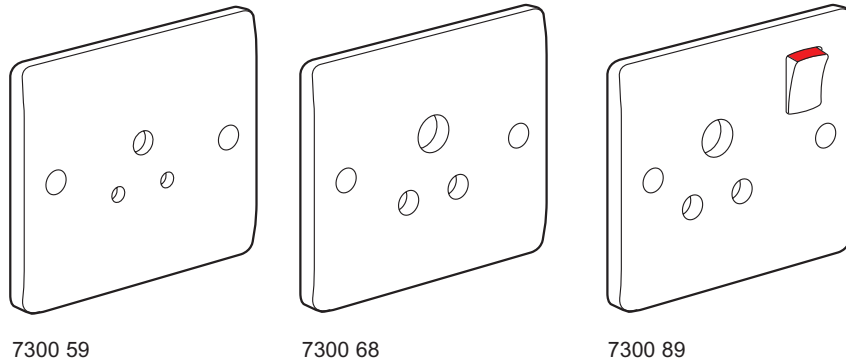

**1. APPLICATIONS**

One gang socket outlets in switched or unswitched versions designed to accept round pin plugs to BS 546

**2. WHITE RANGE**

Description	Cat. N°	Characteristics	Weight (g)
2A	7300 59	Unswitched with "E" pin operated shutter	79
5A	7300 68	Unswitched with 3 pin operated shutter	96
5A	7300 69	S.P. Switched with 3 pin operated shutter	99
15A	7300 88	Unswitched with 3 pin operated shutter	91
15A	7300 89	S.P. Switched with 3 pin operated shutter	94

**3. DIMENSIONS (mm)**

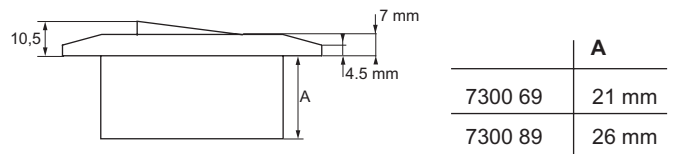
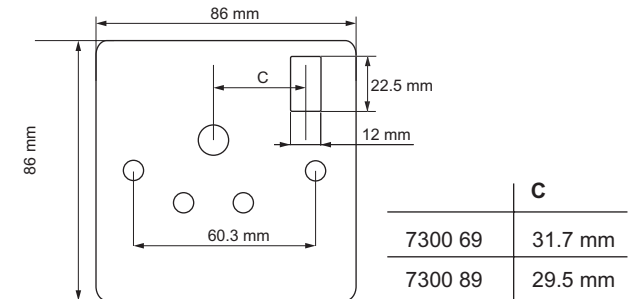
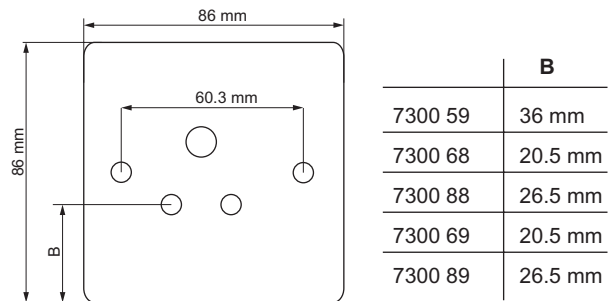

Switched versions

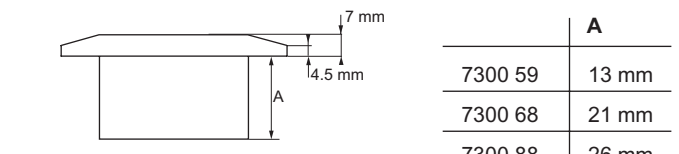

Unswitched versions

# Synergy® 2A, 5A and 15A round pin socket outlets

Cat. No(s) : 7300 59/68/69/88/89

## 4. INSTALLATION

- All products supplied with 2 x M 3.5 fixing screws and 2 thermo-plastic screw covers.

It is recommended that redundant top and bottom fixing lugs in metal backboxes are bent back to increase room for mechanisms and their attendant wiring.

### Flush mounting :

- Minimum depths
  - 2A : 16 mm
  - 5A : 25 mm
  - 15A : 35 mm

### Surface mounting :

- 2A : Surface pattress 16 mm Cat. N° 7364 03  
or 35 mm Cat. N° 7364 06
- 5A/15A : Surface pattress 35 mm Cat. N° 7364 06

## 5. CONNECTION

### 5.1 Terminals

- Terminal capacity 2A :
  - 4 x 1,5 mm<sup>2</sup>
  - (L,N and E) 2 x 2,5 mm<sup>2</sup>
  - 1 x 4,0 mm<sup>2</sup>
- Terminal capacity 5A\* and 15A :
  - 3 x 2,5 mm<sup>2</sup>
  - (L,N and E) 3 x 4,0 mm<sup>2</sup>
  - 2 x 6,0 mm<sup>2</sup>

\*Fitted with 2 earth terminals

- Recommended screwdriver size : 4 mm flat blade
- Recommended terminal tightening torque : 0.8 Nm

## 6. GENERAL CHARACTERISTICS

### 6.1 Mechanical characteristics

- IP rating : IP2X
- IK rating : IK01
- Patented 3 pin operated shutter mechanism on 5A and 15A variants.
- Terminal screws are supplied in backed off position.
- Retrofit LED "power-on" upgrade available for conversion of standard switched sockets (5A,15A only).

### 6.2 Electrical characteristics

- Minimum 3 mm contact separation
- Positive contact indication

### 6.3 Material properties

- Base : self-extinguishing at 850° C / 30 s
- Frontplate : thermoset urea self-extinguishing at 960° C / 30 s
- Rocker : polycarbonate, self-extinguishing at 850° C / 30 s
- Fixing screw concealment plugs : polycarbonate

## 6. GENERAL CHARACTERISTICS (continued)

### 6.4 Resistance to chemicals

Resistance to chemical agents	PC	UREA
Acetone	n	l
Acetic acid 10 %	s	-
Hydrochloric acid	s (20%)	n
Citric acid 10 %	s	-
Hydrofluoric acid 4 %	s	l
Lactic acid 10 %	s	-
Nitric acid 10 %	s	-
Phosphoric acid 85 %	l	n
Sulphuric acid 25 %	s	n
Tannic acid	n	-
Cleaning agents containing traces of ammonia quaternaires	n	s
Ethyl alcohol	s	l
Methyl alcohol (methanol)	l	l
Ammonia	n	l
Aniline	n	l
Benzene	n	l
Lime	n	l
Liquid chlorine	n	-
Barium chloride	s	-
Chlorinated lime 20 %	s	-
Javel water	s	-
Seawater	s	-
Oil	s	s
Milk	s	-
Fuel	s	l
Petroleum oil, petroleum ether	l	l
Caustic soda	n (40%)	s (25%)
Sugar	s	-
Toluene	n	-
Trichlorethylene	n	l
Urine	s	-
Wine	s	-

s = satisfactory

l = limit

n = not satisfactory

### 6.5 Functional limitations

- Products may be stored at temperatures between - 5° C and + 40° C
- Maximum average ambient temperature in any 24 hour period not to exceed 25° C.

## 7. MAINTENANCE

The use of abrasive or solvent-based cleaners is strictly forbidden as it could result in irreparable damage to the products external surfaces. We recommend the use of a soft, slightly damp cloth to remove fingerprints, etc...

## 8. ACCESSORIES

- LED "power on" upgrade pack, Cat. N° 7300 58 (pack of 10).
- Spare faceplate screw concealment plug, Cat. N° 7301 53 (pack of 50).

**Note : Ensure that LED's are either disconnected or socket outlet rockers are switched "off" when performing installation tests otherwise irreparable damage to LED's will occur.**

## 9. CONFORMITY TO STANDARDS

- The 2A, 5A and 15A socket outlets above conform to BS 546.