

**ELBOW ASSEMBLY, DOWN,
90 DEGREES, EXTERNAL LID, 100 mm DUCT**

Part number: TC1279-111A

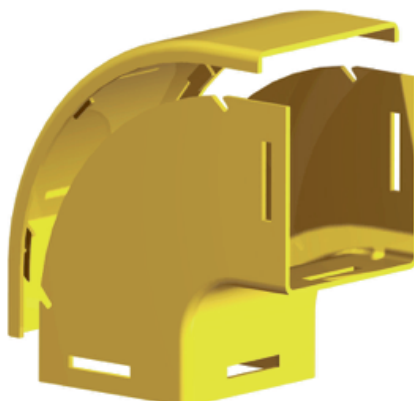

1. USE / APPLICATION

The 90 degree down elbow is a 100 mm vertical drop off with an external lid, so that optical fibre cords within the elbow can be accessed. This is usually installed where optical fibre cords are to be dropped off below. There are two 100 mm outlets, which use either: a standard joiner (Part No. TC1279-27) or a slotless joiner (Part No: TC1279-248A).

2. BENEFITS & FEATURES

- Provides easy access to optical fibre cords; which can also be retro fitted
- Clips straight into joiner
- Tough, fire retardant material
- Standard joiners (Part No: TC1279-27) or slotless joiners (Part No: TC1279-248A); available separately
- Purchase by the unit

3. TECHNICAL ATTRIBUTES

Dimensions	170 mm (W) x 170 mm (H) x 110 mm (D)
Weight	310 grams
Materials	Fire retardant plastic, Halogen free, UL94-VO rated