

**GI-CRW/GI-CRB/GI-CSW/GI-CSB  
 CORRIDOR RECESSED/SURFACE ON-OFF LIGHTING CONTROL SENSOR**

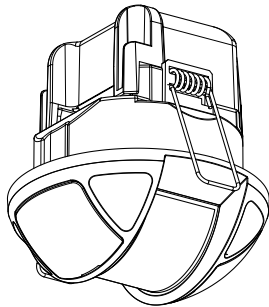

**Recessed**  
 0 484 66 (White)  
 0 484 67 (Black)

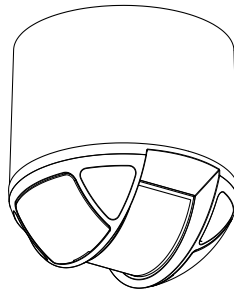

**Surface**  
 0 484 68 (White)  
 0 484 69 (Black)

**CONTENT**

1. USE ..... 1  
 2. TECHNICAL CHARACTERISTICS..... 1  
 3. DIMENSIONS ..... 2  
 4. CONNECTION ..... 3  
 5. INSTALLATION ..... 4  
 6. SETTINGS ..... 7  
 7. COVERAGE PERFORMANCE..... 9  
 8. FONCTIONNEMENT ..... 9  
 9. MAINTENANCE..... 10  
 10. STANDARDS ..... 10

**1. USE**

This device is used to control a light source automatically by detecting movement, using infrared (IR) technology. This motion sensor has 5x24m detection area. It is installed on false ceiling (0 484 66 / 0 484 67) or surface ceiling (0 484 68 / 0 484 69). It is quick and easy to set, using potentiometers or an IR remote control (0 484 75).

Detection type: Infrared (PIR)  
 Mounting type: Ceiling  
 Time Delay: 10sec to 30min  
 Light Level Setpoint: 5... 2000lux

**2. TECHNICAL CHARACTERISTICS**

**2.1 Technical data**

Voltage: 100-240V ~  
 Frequency: 50 / 60 Hz  
 No-load power consumption: 0.1W  
 Output by normally open contact connected to phase  
 Cabling: 2x1,5mm<sup>2</sup> or 1x2,5mm<sup>2</sup>  
 Flush-mounting diameter: 67 mm  
 Weight: 97.8g (0 484 66/0 484 67)  
 127.6g (0 484 68/0 484 69)  
 Impact resistance: IK04  
 Penetration by solid bodies and liquids:  
 IP41 (0 484 66, 0 484 67)  
 IP40 (0 484 68, 0 484 69)  
 Operating temperature: -5°C to +30°C  
 Storage temperature: -20°C to +70°C

**2.2 Features**

- Operates in standalone.
- 1 auxiliary input for overriding lightings using a push button connected to the line.
- 2 sensor (pyroelectric technology) with its lens for sensing movement.
- A daylight sensor measuring the natural and artificial light for driving lightings according to the daylight setpoint.
- 1 relay output dedicated to lightings, switching loads at the zero crossing.
- An Infrared protocol to configure.
  - Time delay
  - Light level setpoint
  - Launch test mode
  - PIR Sensitivity

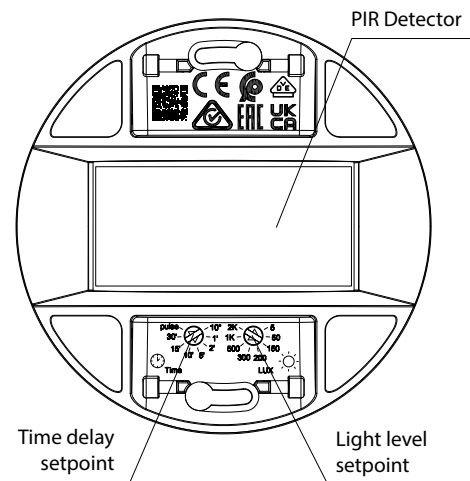

Scan the QR Code and access the technical documentation

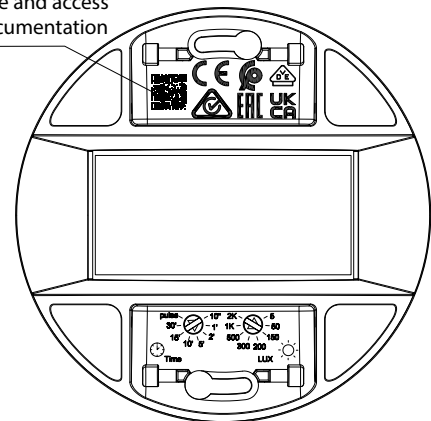

**GI-CRW/GI-CRB/GI-CSW/GI-CSB  
CORRIDOR RECESSED/SURFACE ON-OFF LIGHTING CONTROL SENSOR**

**2. TECHNICAL CHARACTERISTICS (Continued)**

■ 2.3 Load

①		②		③		④		⑤		⑥		⑦	
LED													
240 V~	350 V~	cos φ	2000 W	cos φ	1000 V~	cos φ	10x(2x36W)	cos φ	I ≤ 2 A	500 V~	cos φ	1000 V~	cos φ
100 V~	175 V~	0,5	1000 W	1	500 V~	1	5x(2x36W)	1		250 V~	1	500 V~	1

- 1- LED lamp
- 2- Incandescent and Halogen lamps
- 3- Halogen lamp with separate ferromagnetic or electronic transformer
- 4- Fluorescent tubes
- 5- Contactor
- 6- Compact fluorescent lamp with integrated ballast
- 7- Compact fluorescent lamp with transformer ferromagnetic or separate electronic

**3. DIMENSIONS**

■ 3.1 Recessed mount (Cat. Nos 0 484 66 / 0 484 67)

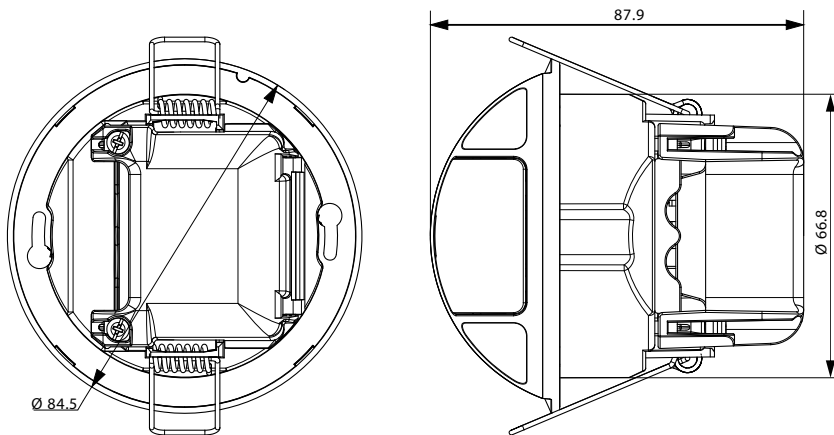

■ 3.2 Surface mount (Cat. Nos 0 484 68 / 0 484 69)

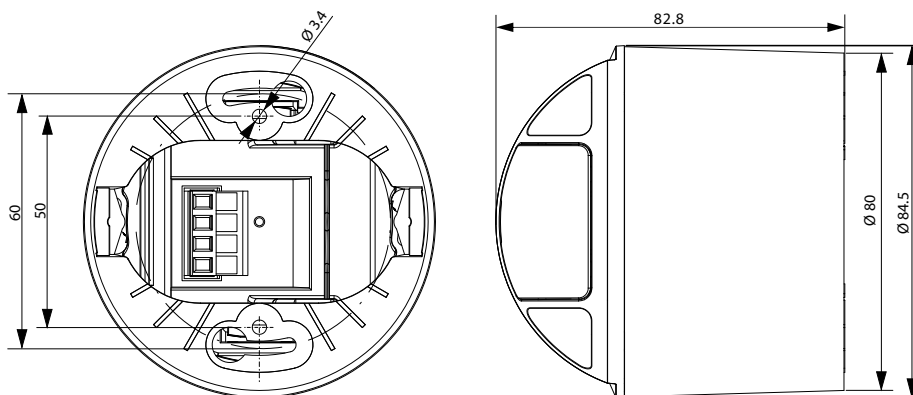

**GI-CRW/GI-CRB/GI-CSW/GI-CSB  
CORRIDOR RECESSED/SURFACE ON-OFF LIGHTING CONTROL SENSOR**

**4. CONNECTION**

Number of terminals: 4  
Terminal type: pluggable terminal  
Terminal capacity:  $2 \times 1.5\text{mm}^2$  or  $1 \times 2.5\text{mm}^2$   
Stripping length: 7 mm

■ 4.1 Wiring with auxiliary control

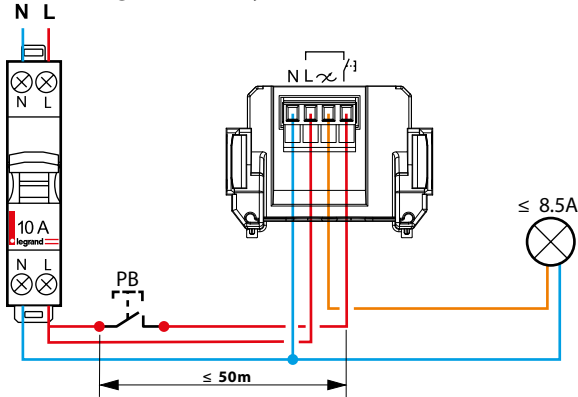

■ 4.2 Wiring without auxiliary control: Auto on/Auto off

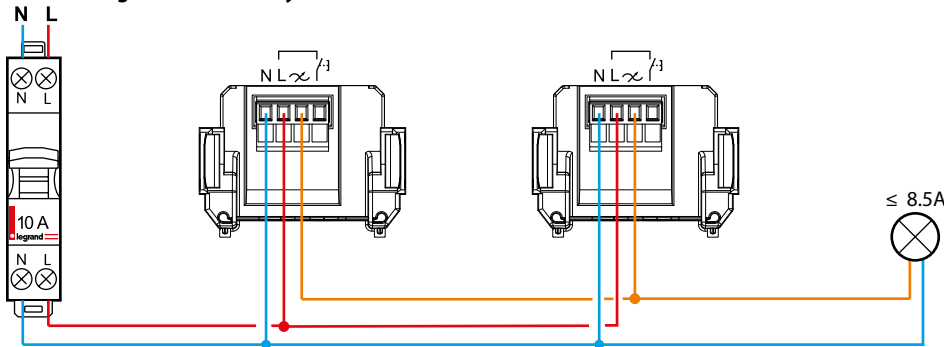

■ 4.3 Wiring for a single load connected in parallel

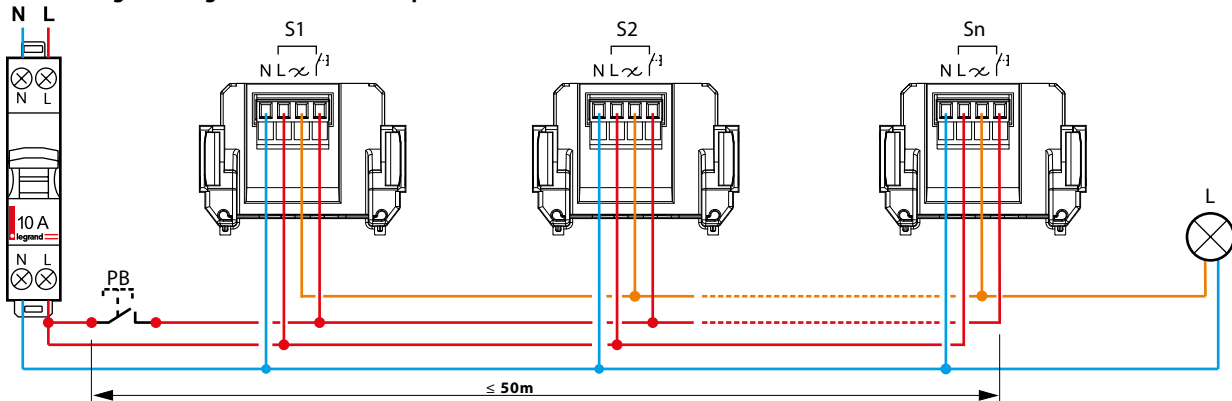

■ 4.4 Wiring for several loads connected in parallel

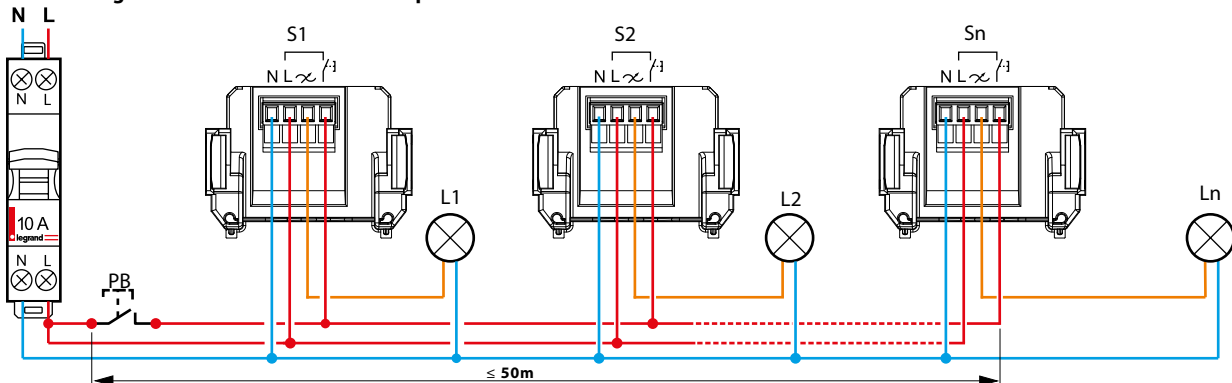

**GI-CRW/GI-CRB/GI-CSW/GI-CSB  
CORRIDOR RECESSED/SURFACE ON-OFF LIGHTING CONTROL SENSOR****5. INSTALLATION****■ 5.1 Recessed mounting (screw plug-in)**

0 484 66 / 0 484 67

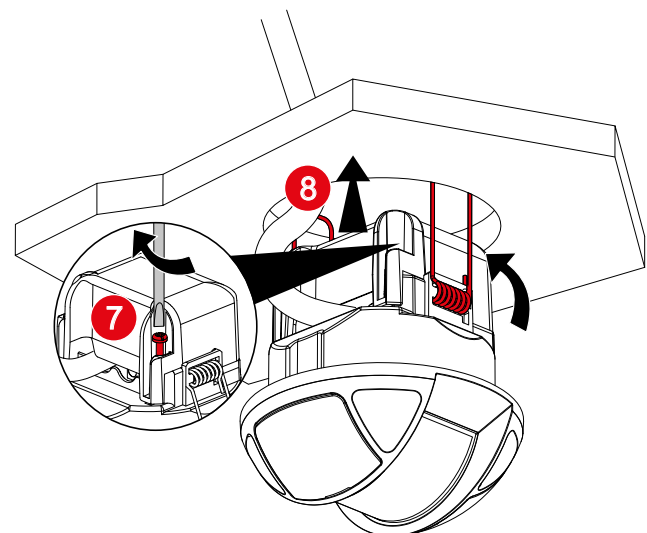
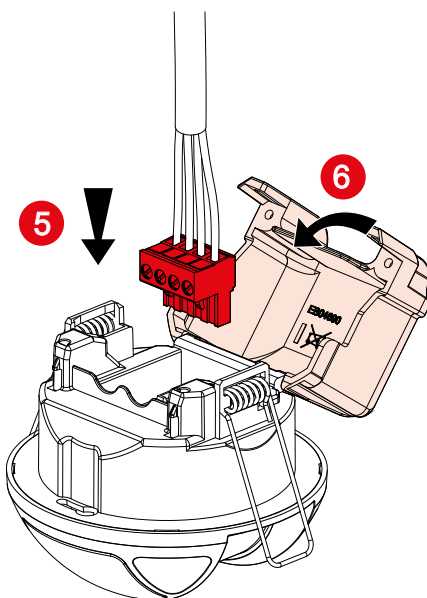
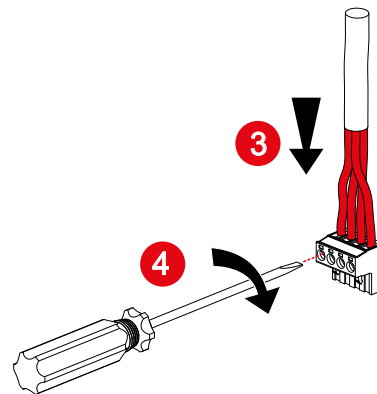
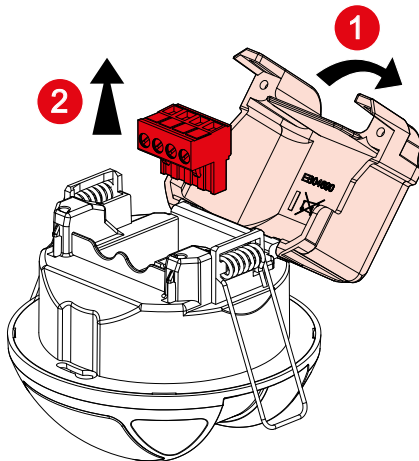
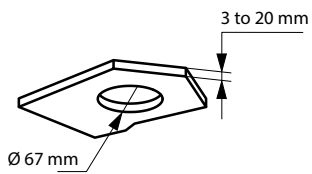

**GI-CRW/GI-CRB/GI-CSW/GI-CSB  
CORRIDOR RECESSED/SURFACE ON-OFF LIGHTING CONTROL SENSOR**

**5. INSTALLATION (Continued)**

■ 5.2 Surface mounted  
0 484 68 / 0 484 69

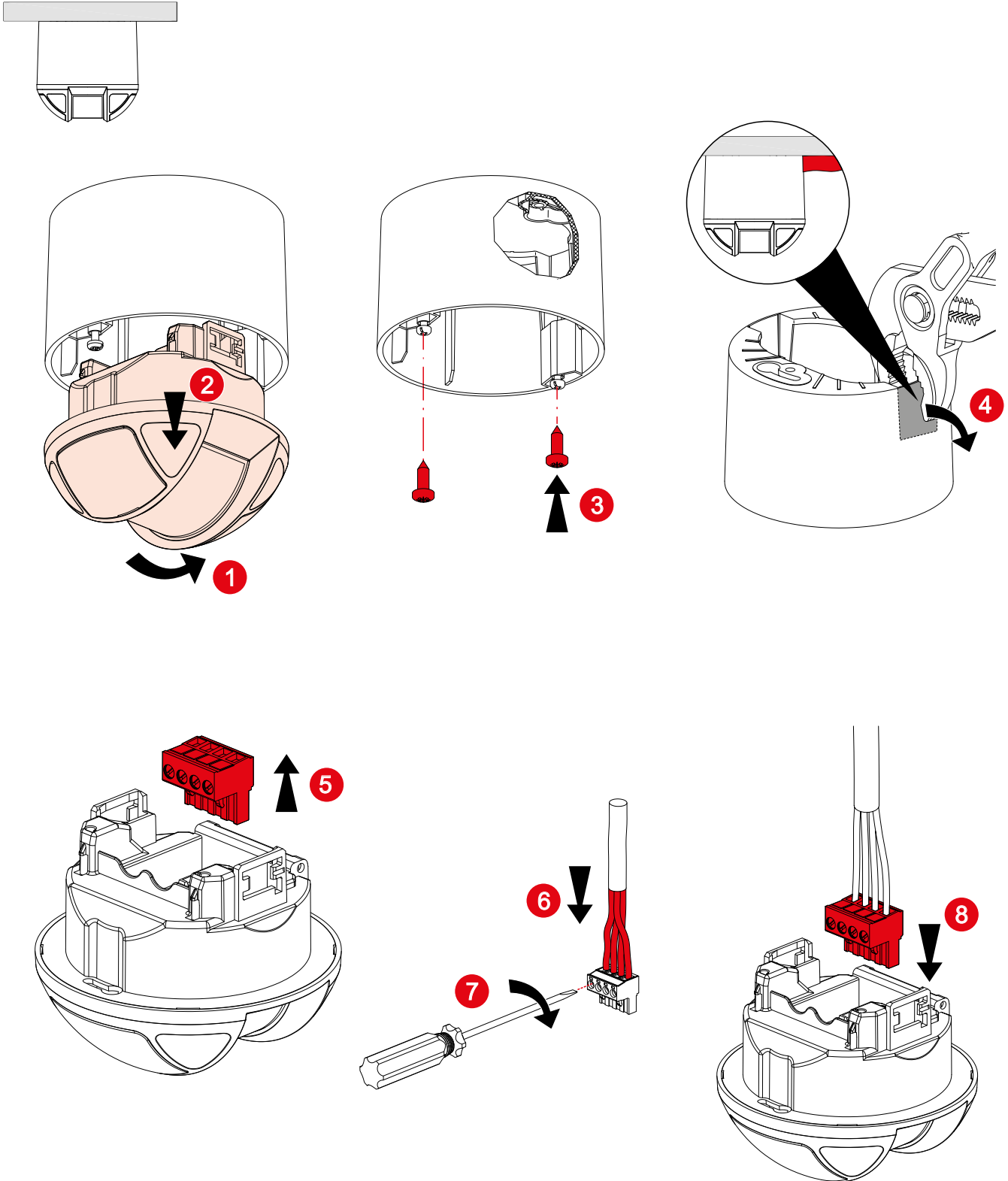

GI-CRW/GI-CRB/GI-CSW/GI-CSB  
CORRIDOR RECESSED/SURFACE ON-OFF LIGHTING CONTROL SENSOR

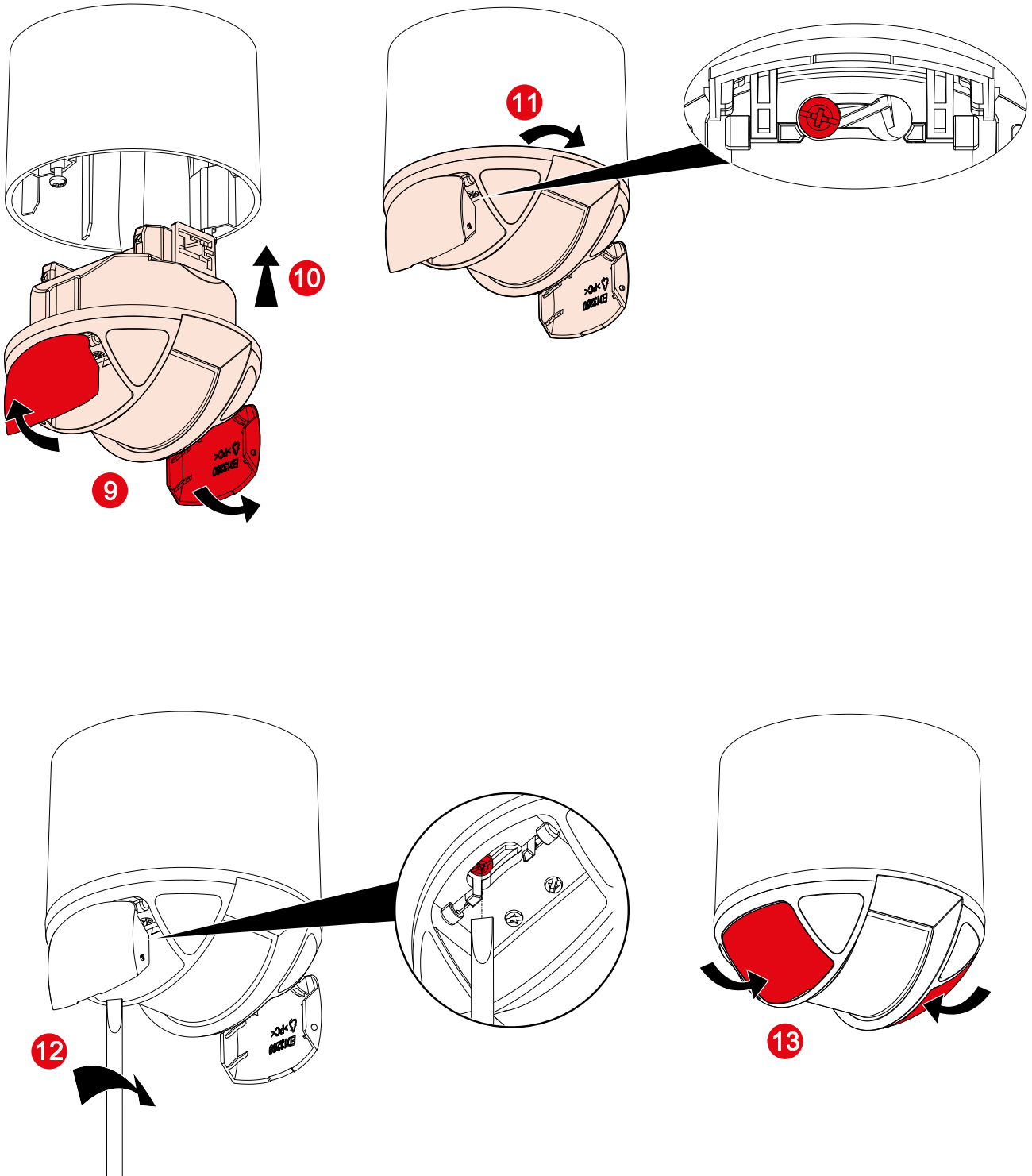

**GI-CRW/GI-CRB/GI-CSW/GI-CSB  
CORRIDOR RECESSED/SURFACE ON-OFF LIGHTING CONTROL SENSOR**

**6. SETTINGS**

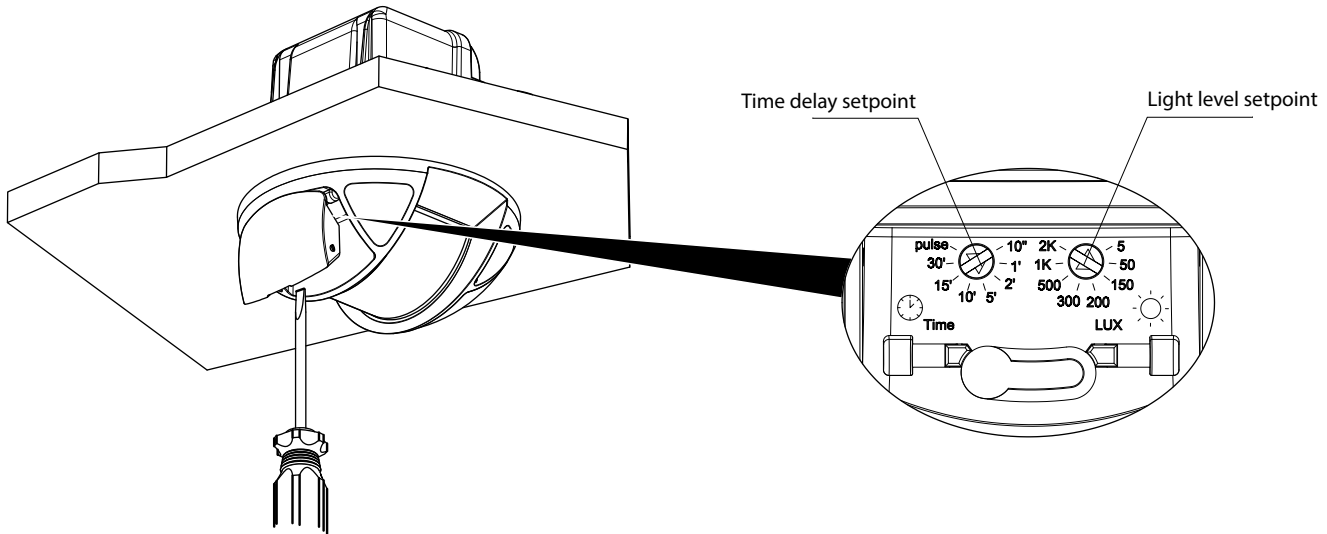

**6.1 Setting by Trimmer**

The product is set with this trimmer's positions.

**Time delay setpoint:** Time for which light is switched on following detection.

**Light level setpoint:** Light level setpoint value below which the light is switched on and above which the light is switched off.

Position	Trimmer daylight	Trimmer time delay
1	5 lux (Min)	10 sec
2	50 lux	1 min
3	150 lux	2 min
4	200 lux	5 min
5	300 lux	10 min
6	500 lux	15min
7	1000 lux	30 min
8	2000 lux (Max)	Pulse

**Light level Max:** Light will always be turn on/off no matter light level.

**Pulse:** The relay output is driven with short pulse (1s) spaced to 10s for driving a timer lag switch. Combined with a remote time-switch, the detector is ideal for stairwells and corridors.

The time set on the time switch determines how long the load is switched on following a signal detection.

**Factory Settings:**

Trimmer daylight: position 8 (max)

Trimmer time delay: position 1 (10sec)

**6.2 Setting by Infrared remote control (Cat. N° 0 484 75)**

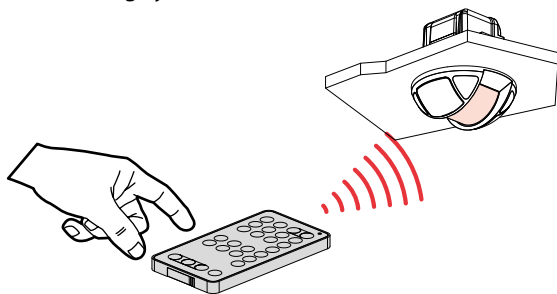

**6.2 Setting by Infrared remote control (continued)**

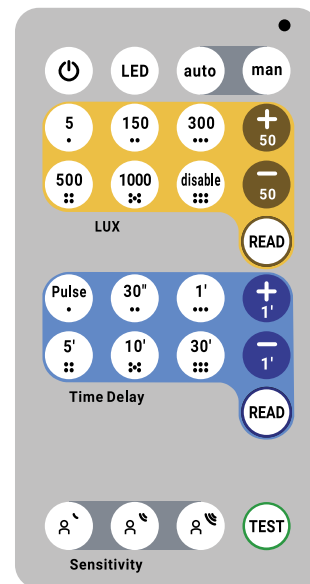

**Notes 1: Auto on/Auto off mode:**

Automatic switch-on:

- On detection of presence if the natural light level is insufficient.

Automatic switch-off:

- If no presence is detected and at the end of the set time delay

- Or if the natural light level is sufficient

Another detection causes automatic switch-on if there is insufficient light.

**Notes 2: Manual on/Auto off mode:**

Manual switch-on, automatic switch-off:

- When no presence is detected and at the end of the set time delay.

After switch-off, any new detection within a 30 second period triggers an automatic switch-on.

After 30 seconds the device is switched on via a manual switch.

**Note 3: Test Mode:**

This mode bypass parameters for 10 minutes.

Every detection switch ON the motion LED (in purple) for 1sec and drives the lightings for 5 seconds.

























After these 5 seconds, if no motion is sensed, the lightings turn OFF, else the 5 seconds delay is refreshed (test mode restarts).

The 10 minutes test timer is reset only if remote control test button is pushed again.

**GI-CRW/GI-CRB/GI-CSW/GI-CSB  
CORRIDOR RECESSED/SURFACE ON-OFF LIGHTING CONTROL SENSOR**

**6. SETTINGS (Continued)**

**■ 6.2 Setting by Infrared remote control (continued)**

TYPE	KEY	NAME	DESCRIPTION	Comment	
Parameter		Load ON/OFF	Turn ON/OFF the connected loads	After the setting is successful, the purple LED on the product blinks quickly three times.	
		Motion LED ON/OFF	Enables or Disables the motion detection LED(green)		
		Auto ON Auto OFF	The load will be switched on and off automatically		
		Manuel ON Auto OFF	Manual switching on by pressing the push button / Automatic switching off at the end of the timer period		
Light level Setpoint		5 LUX	Set light level to 5 LUX		
		150 LUX	Set light level to 150 LUX		
		300 LUX	Set light level to 300 LUX		
		500 LUX	Set light level to 500 LUX		
		1000 LUX	Set light level to 1000 LUX		
		Disable light level Regulation	Light will always be turn on/off no matter light level		
		Read light level	Upon activation the sensor yellow LED will blink «x» times to indicate the set values for LUX		Exemple : the sensor's LED blinks yellow 3 times = light level is set to 300 LUX or the closest value (250 or 350 LUX).
		Increase 50 lux	Increase by 50 LUX the set LUX level (maximum value when pressing + is 2000 LUX)		
		Decrease 50 lux	Decrease by 50 LUX the set LUX level		
Time delay		Pulse	Activate the pulse function on the sensor		
		30 seconds	Set time delay to 30s		
		1 minute	Set time delay to 1min		
		5 minute	Set time delay to 5min		
		10 minute	Set time delay to 10min		
		30 minute	Set time delay to 30min		
		Read time delay	Upon activation the sensor blue LED will blink «x» times to indicate the set values for time delay		Exemple : the sensor's LED blinks blue 4 times = time delay is set to 5minutes or closest value (4 min or 6 min).
		Increase 1 minute	Increase by 1min the set the time delay (maximum value when pressing + is 60 min)		
		Decrease 1 minute	Decrease by 1min the set the time delay		
Sensivity		PIR sensitivity	1.Low 2.Medium 3.High	Factory settings: medium	
Test Mode		Test Mode	Test mode is activated during 10min and the time delay is 5s.	Temporary sets values to : LUX disabled Delay 5s After test period, values return to their original settings and the test can be interrupted by pushing the button once more.	

**GI-CRW/GI-CRB/GI-CSW/GI-CSB  
CORRIDOR RECESSED/SURFACE ON-OFF LIGHTING CONTROL SENSOR**

**6. SETTINGS (Continued)**

**6.3 Pilot lamp feedback**

Motion LED feedback:

STATE	DESCRIPTION
● For 45s	Warmup state ( state after power ON)
● For 1s	Motion sensed
● For 1s	Motion sensed during test mode

Read mechanism feedback

STATE	DESCRIPTION
● Blink	Blinks X times to indicate the set values for TIME DELAY triggered by READ function.
● Blink	Blinks X times to indicate the set values for LUX triggered by READ function.

IR frame ACK feedback:

STATE	DESCRIPTION
● 3 blinks	Blinks quickly 3 times anytime a message is received from remote
● 3 blinks	Blinks quickly 3 times when the message coming from the remote cannot be taken into account

**6.4 WARM UP**

When powered on the motion sensor is in warmup state for 45s:  
Load is ON  
Green Motion LED is ON  
AUX functions is active  
Infrared remote control/trimmer settings are active  
PIR Sensor is inactive  
LUX level sensing is inactive

**7. COVERAGE PERFORMANCE**

**7.1 Radial movement**

Factory setting: "High Sensitivity" for a height of 2.5m and a temperature of 20 °C.

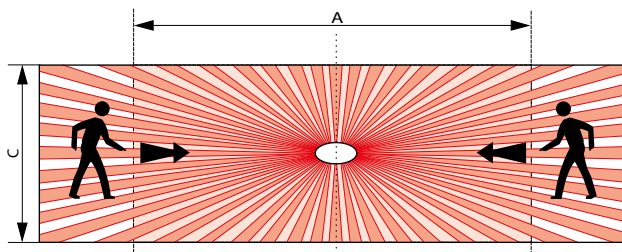

Height (m)	High Sensitivity (m)	
	A	C
2.5	18	5

**7.2 Tangential movement**

Factory setting: "High Sensitivity" for a height of 2.5m and a temperature of 20 °C.

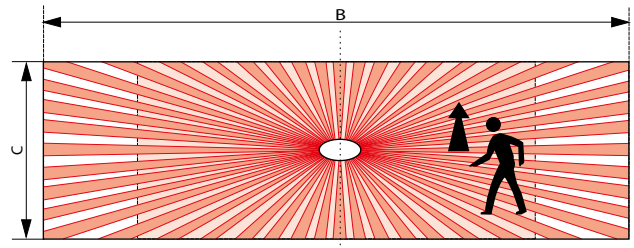

Height (m)	High Sensitivity (m)	
	B	C
2.5	24	5

**Remark:**

For an optimal detection, the movement should be done perpendicular to the sensor. In case direct and frontal approach, the detection of a movement will be harder, and scope will be therefore much lower.

**8. FONCTIONNEMENT**

**8.1 More than one sensor and more than one load**

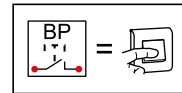

inversion of the state of the loads: < 1s

synchronisation of all loads to ON: > 1s

synchronisation of all loads to OFF: > 1s + < 1s

⊗ L1 OFF	⊗ S1 OFF	< 1s	⊗ L1 ON	⊗ S1 ON
⊗ L2 OFF	⊗ S2 OFF		⊗ L2 ON	⊗ S2 ON
⊗ Ln OFF	⊗ Sn OFF		⊗ Ln ON	⊗ Sn ON
⊙ L1 ON	⊙ S1 ON	< 1s	⊗ L1 OFF	⊙ S1 OFF
⊙ L2 ON	⊙ S2 ON		⊗ L2 OFF	⊙ S2 OFF
⊙ Ln ON	⊙ Sn ON		⊗ Ln OFF	⊙ Sn OFF

**GI-CRW/GI-CRB/GI-CSW/GI-CSB  
CORRIDOR RECESSED/SURFACE ON-OFF LIGHTING CONTROL SENSOR**

**8. FONCTIONNEMENT (Continued)**

**■ 8.1 More than one sensor and more than one load (continued)**

**■ 8.2 Several sensors connected to a single load**

**9. MAINTENANCE**

Ensure the lens remains clean.  
Surface cleaning using a cloth.  
Do not use: acetone, tar remover, trichloroethylene.  
Resistant to the following products:  
- Hexane (EN 60669-1),  
- Methylated spirit,  
- Soapy water,  
- Diluted ammonia  
- Bleach diluted to 10%,  
- Window cleaning products.

**WARNING:** Conduct preliminary tests before using any other specific cleaning products.

**10. STANDARDS**

LVD: Low Voltage Directive  
Directive: 2014/35/EU  
Standard: IEC 60669-2-1

EMC: Electromagnetic Compatibility  
Directive: 2014/30/EU  
Product standards: IEC 60669-2-1  
IEC 61000-3-2

ROHS: Restriction of Hazardous substances,  
Directive: 2011/65/EU of 08 June 2011 amended by 2015/862 of  
31 March 2015 (ROHS 2)  
Standard: EN IEC63000