

# Salamandre® distribution trunking

## lengths, lids and couplers

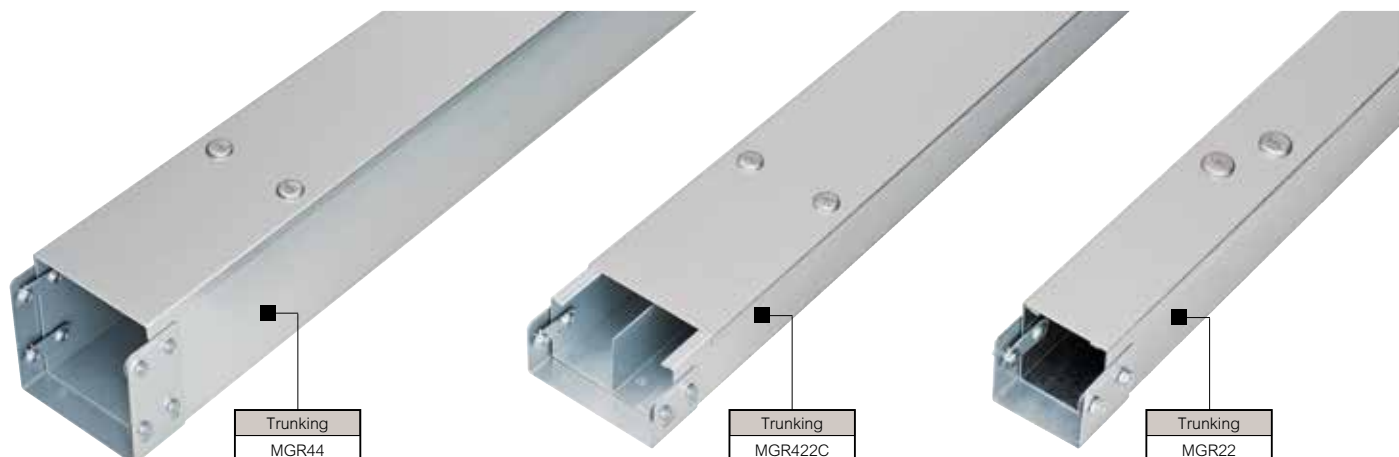

Selection chart (p. 8-9)  
 Order information (p. 10)  
 Standards and quality assessment (p. 20)  
 Dimensions and technical information (p. 21-30)

Pack	Cat. Nos.	Trunking lengths – 3 m																																						
		A safety return edge steel surface trunking system with strength and rigidity Manufactured to BS EN 50085-2-1 Each trunking length is supplied with coupler (fitted), lid and lid fixings Supplied as standard with push-fit diecast turnbuckle fixings. For screwfix or tamperproof screwfix, replace MGR with MSR or MSTR. For more details (see order information p. 10)																																						
		<b>Single compartment</b> Also available in multi-compartment options (see p. 10)																																						
		<table border="1"> <thead> <tr> <th>Width (mm)</th> <th>Depth (mm)</th> </tr> </thead> <tbody> <tr><td>50</td><td>50</td></tr> <tr><td>75</td><td>50</td></tr> <tr><td>75</td><td>75</td></tr> <tr><td>100</td><td>50</td></tr> <tr><td>100</td><td>75</td></tr> <tr><td>100</td><td>100</td></tr> <tr><td>150</td><td>50</td></tr> <tr><td>150</td><td>75</td></tr> <tr><td>150</td><td>100</td></tr> <tr><td>150</td><td>150</td></tr> <tr><td>225<sup>(1)</sup></td><td>75</td></tr> <tr><td>225<sup>(1)</sup></td><td>100</td></tr> <tr><td>225<sup>(1)</sup></td><td>150</td></tr> <tr><td>225<sup>(1)</sup></td><td>225</td></tr> <tr><td>300<sup>(1)</sup></td><td>75</td></tr> <tr><td>300<sup>(1)</sup></td><td>100</td></tr> <tr><td>300<sup>(1)</sup></td><td>150</td></tr> <tr><td>300<sup>(1)</sup></td><td>300</td></tr> </tbody> </table>	Width (mm)	Depth (mm)	50	50	75	50	75	75	100	50	100	75	100	100	150	50	150	75	150	100	150	150	225 <sup>(1)</sup>	75	225 <sup>(1)</sup>	100	225 <sup>(1)</sup>	150	225 <sup>(1)</sup>	225	300 <sup>(1)</sup>	75	300 <sup>(1)</sup>	100	300 <sup>(1)</sup>	150	300 <sup>(1)</sup>	300
Width (mm)	Depth (mm)																																							
50	50																																							
75	50																																							
75	75																																							
100	50																																							
100	75																																							
100	100																																							
150	50																																							
150	75																																							
150	100																																							
150	150																																							
225 <sup>(1)</sup>	75																																							
225 <sup>(1)</sup>	100																																							
225 <sup>(1)</sup>	150																																							
225 <sup>(1)</sup>	225																																							
300 <sup>(1)</sup>	75																																							
300 <sup>(1)</sup>	100																																							
300 <sup>(1)</sup>	150																																							
300 <sup>(1)</sup>	300																																							

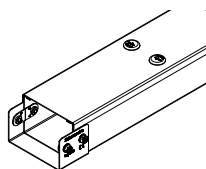

(1) Use additional cover straps (Cat. Nos. MGIP9TCS and MGIP12TCS) to achieve IP4X conformity, see opposite

Pack	Cat. Nos.	Spare lids
		<b>Spare turnbuckle lids</b> Diecast turnbuckles included Lids 50 to 150 wide : 6 per 3 m lid Lids 225 and 300 wide : 4 per 1.5 m lid
1	MGR2LID	50 mm wide x 3 m long
1	MGR3LID	75 mm wide x 3 m long
1	MGR4LID	100 mm wide x 3 m long
1	MGR6LID	150 mm wide x 3 m long
1	MGR9LID	225 mm wide x 1.5 m long
1	MGR12LID	300 mm wide x 1.5 m long
		<b>Spare screwfix and tamperproof screwfix lids</b> Screws and retaining clips not included (see p. 16) Lids up to 150 wide : 6 per 3 m lid Lids 225 and 300 wide : 4 per 1.5 m lid Replace MGR with MSR (screwfix) in the Cat. Nos. above

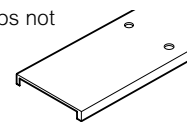
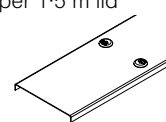

Pack	Cat. Nos.	Accessories
1	MGR Z C	<b>Trunking couplers</b> Supplied with coupler screws fitted and backed off
		<b>IP4X cover strap</b> Clips over coupler joint to provide IP4X Used in conjunction with IP4X fittings, see p. 14 for details
1	MGIP2CS	50 mm cover strap
1	MGIP3CS	75 mm cover strap
1	MGIP4CS	100 mm cover strap
1	MGIP6CS	150 mm cover strap
1	MGIP9CS	225 mm cover strap
1	MGIP12CS	300 mm cover strap

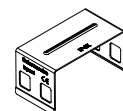
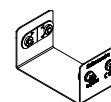

Pack	Cat. Nos.	IP4X cover strap for lids
		Clips over joint between two lids to provide IP4X conformity For use with 225 mm and 300 mm wide trunking Kit includes cover strap two clip options and M5 fixing screws
1	MGIP9TCS	225 mm cover strap
1	MGIP12TCS	300 mm cover strap

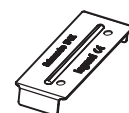

Key : Z = trunking size code  
 Replace Z with the relevant code (see p. 10)



**MGR can be replaced by MSR or MSTR for screwfix lids or tamperproof screwfix lids**  
 Also available in multi-compartment options

see p. 10

**NEW**