

# Snap-on mini-columns and columns

## Dimensions (in mm)

1-compartment columns, mini-columns and movable columns

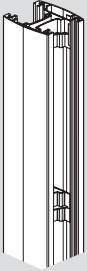
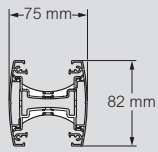

2-compartment columns, mini-columns and movable columns

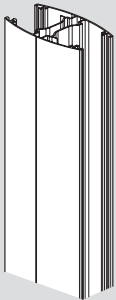
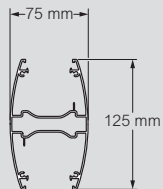

4-compartment columns and mini-columns

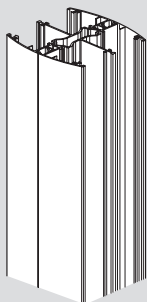
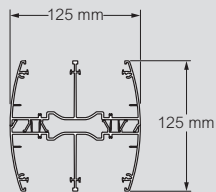

## Wiring capacity

1-compartment columns

Max. capacity of conductors (for each type of conductor)	1-compartment (with separation partition)		1-compartment (with 1 mechanism and separation partition)	
	A	B	C	D
<b>Compartment</b>	A	B	C	D
<b>Total cross-section (mm<sup>2</sup>)</b>	1440	1440	20	1440
<b>Number of cables</b>	Ø7 mm	16	-	16
	Ø9 mm	10	-	10
	Ø11 mm	6	6	-

2-compartment and 4-compartment columns

Max. capacity of conductors (for each type of conductor)	2-compartment (with 1 mechanism)		4-compartment (with 1 mechanism)		
	A	B	A	B	
<b>Compartment</b>	A	B	A	B	
<b>Total cross-section (mm<sup>2</sup>)</b>	1470	3110	1110	2760	
<b>Number of cables</b>	Ø7 mm	18	14	40	
	Ø9 mm	11	26	8	23
	Ø11 mm	6	14	4	14



**Note:** For wiring capacity corresponding to other types of installation (ovaline column, flexible ovaline kit, etc.) please consult the technical data sheet.

## Installation principle of the Flexible Ovaline kit on snap-on column

