

Incara™ Vertebra

for offices and desktops



Incara™ Vertebra

technical characteristics



6 549 92

6 549 90

For securing and running cables vertically from a desk to the floor or for running cables horizontally directly under a desk surface

Pack	Cat.Nos	Desk Vertebra
		2 compartments - 120 cm
		Two possible uses:
		- fixed position with rotation around 2 axes
		- flexible position with rotation around 4 axes
		Attached using screws or double-sided adhesive pads (supplied)
		Ideal for running cables horizontally
1	6 549 92	● Grey
1	6 549 93	● Black
		4 compartments - 80 cm
		Vertical
		Weighted metal base
		Can be screwed onto the underside of a desk or inserted in a Ø80 mm cut-out
1	6 549 90	● Grey
1	6 549 91	● Black

Dimensions (mm)

2-compartment Vertebra

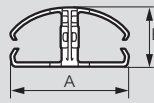

A	54
B	27

Bend radius

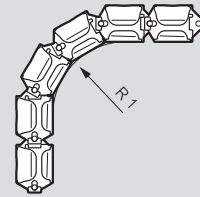

R1 50 min.

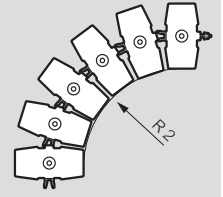

R2 80 min.

4-compartment Vertebra

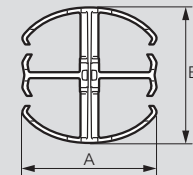

A	54
B	54

Bend radius

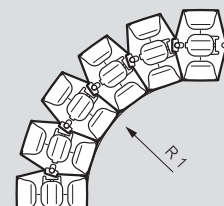

R1 80 min.

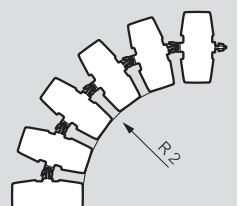

R2 80 min.

2-compartment Vertebra

Fixed position



Flexible position

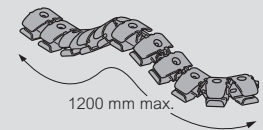
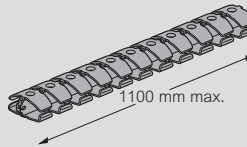

Mounting a 2-compartment Vertebra

Using screws Ø3.5 mm max. (not supplied)

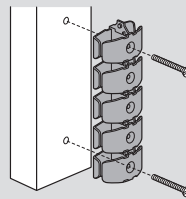

Using double-sided adhesive pads (supplied)

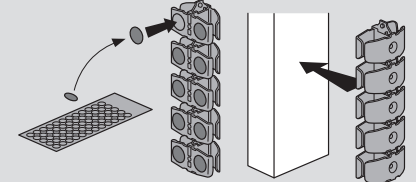

Recommended installation temperature: +15 °C to +25 °C

Mounting a 4-compartment Vertebra

