

## Mallia™ Senses

step lights and room temperature control units



## Mallia™ Senses

hotel equipment



2 810 97MB



2 810 23MB

Dimensions: 86 x 86 mm  
Supplied with 2 screws M 3.5 for BS boxes  
Supplied as complete product with protective film

Pack	Cat.Nos	Step lights
		<p>Conform to IEC 62094-1 Low output step light with LED Ideal to illuminate a corridor at night without dazzling people, or to highlight possible danger Voltage: 250 V Power: &lt; 1 W</p> <p><b>Without motion detector</b></p> <ul style="list-style-type: none"> <li>● Brushed Aluminium</li> <li>● Brushed Black</li> <li>● Champagne</li> <li>● Dark Bronze</li> <li>● Dark Silver</li> <li>● Matt Black</li> <li>○ Matt White</li> </ul>
1	2 810 97BA	<p><b>With motion detector</b></p> <p>Conform to BS EN 60669-2-1 Mechanism equipped with an infrared detection cell and a LED beam Equipped with an audible signal that can be deactivated (when product is used for lighting) or not (so as to indicate danger) Horizontal detection angle: 120° Luminosity threshold: dusk: 15 Lux, night: 3 Lux Detection range: max. 8 m Light adjust.: High, Mid, Low Adjustable time delay: 30 s, 60 s, 120 s Voltage: 250 V Power: &lt; 1 W</p> <ul style="list-style-type: none"> <li>● Brushed Aluminium</li> <li>● Brushed Black</li> <li>● Champagne</li> <li>● Dark Bronze</li> <li>● Dark Silver</li> <li>● Matt Black</li> <li>○ Matt White</li> </ul>
1	2 810 97BB	
1	2 810 97CH	
1	2 810 97DB	
1	2 810 97DS	
1	2 810 97MB	
1	2 810 97MW	
1	2 810 96BA	<p><b>Room temperature control units</b></p> <p>Conform to IEC 60730-1 Allows you to adjust and monitor the temperature in the rooms precisely and accurately with a tactile touch It can control an Air Conditioning System Power supply: 250 V~ 50/60 Hz Adjustable temperature range from 5 °C to 35 °C Temperature accuracy: +/- 1 °C Load type: magnetic valve/motor operated valve with 1 A capacity Temperature sensor: internal NTC Power consumption: &lt; 1 W</p> <ul style="list-style-type: none"> <li>● Champagne</li> <li>● Dark Bronze</li> <li>● Dark Silver</li> <li>● Matt Black</li> <li>○ Matt White</li> </ul>
1	2 810 96BB	
1	2 810 96CH	
1	2 810 96DB	
1	2 810 96DS	
1	2 810 96MB	
1	2 810 96MW	
1	2 810 23CH	<p>● Champagne <li>● Dark Bronze</li> <li>● Dark Silver</li> <li>● Matt Black</li> <li>○ Matt White</li> </p>
1	2 810 23DB	
1	2 810 23DS	
1	2 810 23MB	
1	2 810 23MW	

### Guest Room Management System

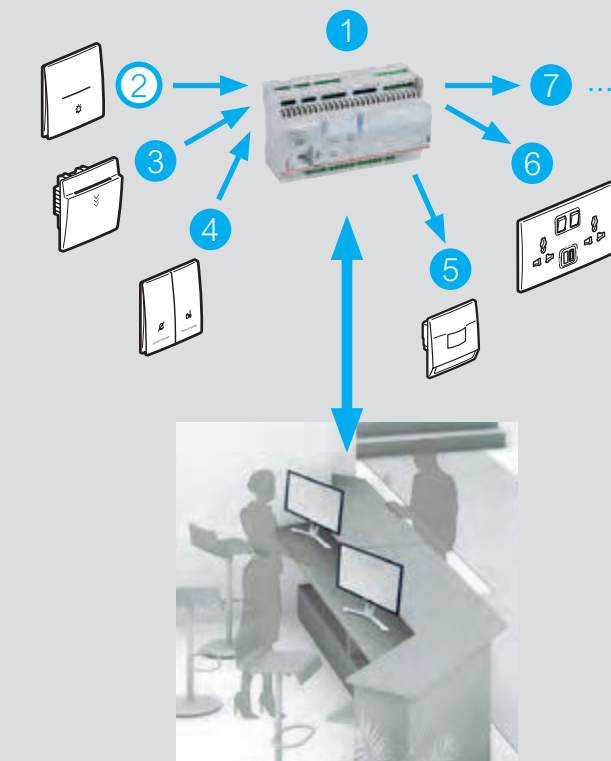

The Room controller unit, Cat.No 0 484 08 or 0 484 12, associated with mechanical Mallia™ Senses functions can manage the lights, sockets, ventilation and curtains independently in each room. It can be integrated with the Building Management System (BMS) and the Property Management System (PMS) in order to enable a global management of the building and the hotel's operations.

UX for Upscale hotels room management **p. 653**



For further information on Room controller, please contact us

