

P 17 Tempra Pro IP 44 - LV 16 and 32 A mobile products

P 17 Tempra domestic pin configuration 16 A - 250 V~

Dimensions

Straight plugs

Cat.Nos 5 551 24/25/26/27/28/29 and 5 552 34/35/36/37/38/39

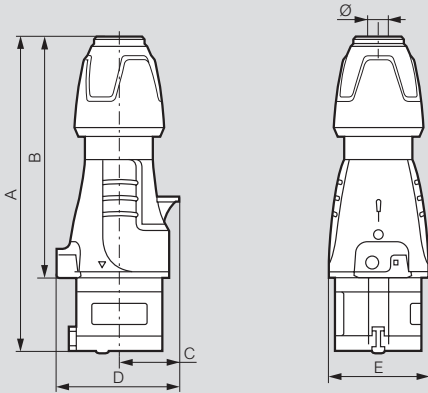

	A	B	C	D	E	Ø
LV 16 A						
2P+E	146 to 157	109.5 to 120.5	30	61	50	6.5 to 14
3P+E	146 to 157	109.5 to 120.5	34	67	55	7.10 to 15.5
3P+N+E	163 to 176	126.5 to 139.5	38	76	65	8 to 20
LV 32 A						
2P+E	172 to 185	127 to 140	40	78	65	8 to 20
3P+E	172 to 185	127 to 140	40	78	65	8 to 20
3P+N+E	179 to 189	133 to 143	45	86	71	11.9 to 22.2

Mobile sockets

Cat.Nos 5 551 04/05/06/07/08/09 and 5 552 34/35/36/37/38/39

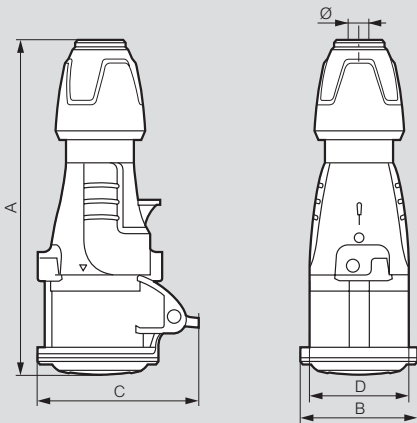

	A	B	C	D	Ø
LV 16 A					
2P+E	156 to 167	59	81	50	6.5 to 14
3P+E	157 to 168	65	88	55	7.10 to 15.5
3P+N+E	175 to 188	72	94	65	8 to 20
LV 32 A					
2P+E	184 to 197	73	99	65	8 to 20
3P+E	184 to 197	73.5	99	65	8 to 20
3P+N+E	190 to 203	79.5	105	71	11.9 to 22.2

Dimensions

Domestic pin configuration sockets

Cat.Nos 0 576 69/75

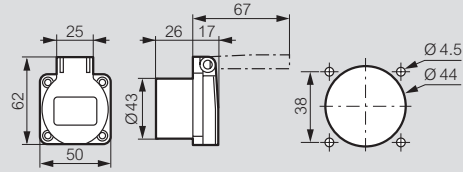

Cat.Nos 0 576 72/76

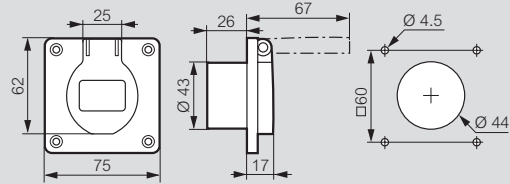

Adaptor 16 A - 230 V

Cat.No 0 521 05

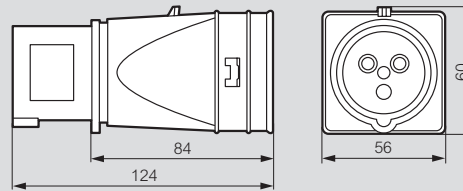

Flush mounting boxes

Cat.No 0 577 21

Cat.No 0 577 22

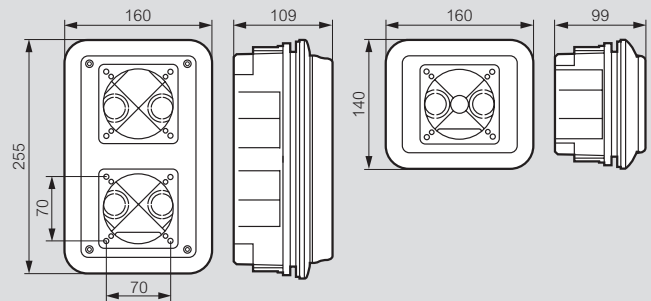

Panel mounting adaptor

Cat.No 0 539 48

