

Plastic cable glands IP 68

ISO and PG

Cable glands RAL 7001 supplied with locking nut

Characteristics

Halogen-free polyamide UL 94-V2
 Operating temperature: - 20 °C to + 80 °C
 Self-extinguishing 850 °C according to IEC 60695-2-11

Dimensions (mm)

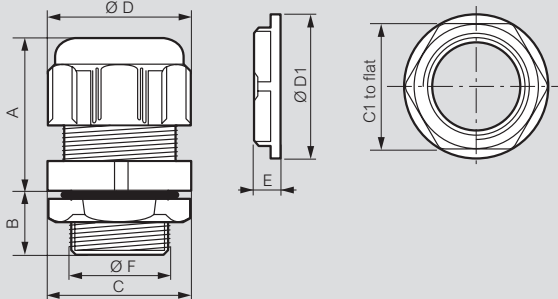

ISO

Cat.Nos	Threading	A	B	Ø D	C (to flat)	Ø F	Drilling Ø	C1	E	Ø D1
0 980 00	ISO 12	22	10	16,8	15	11,9	12,7	19	5	21
0 980 01	ISO 16	26	10	21	19	15,9	16,2	22	5	24
0 980 03	ISO 20	29	12	26,5	24	19,8	20,4	26	6	28
0 980 05	ISO 25	35	15	36	33	24,8	25,4	32	6	35
0 980 06	ISO 32	40	15	46,5	42	31,6	32,5	42	7	43
0 980 07	ISO 40	49	17	58,5	53	39,9	40,5	50	7	56
0 980 08	ISO 50	54	17	66,5	60	50	50,8	60	8	66
0 980 09	ISO 63	54	18	75	68	62,9	64	75	8	82

PG

Cat.Nos	Threading	A	B	Ø D	C (to flat)	Ø F	Drilling Ø	C1	E	Ø D1
0 980 20	PG 7	22	10	16,8	15	12,5	12,7	19	5	21
0 980 21	PG 9	26	10	21	19	15,2	15,2	22	5	24
0 980 22	PG 11	27	12	24,5	22	18,6	18,6	24	5	26
0 980 23	PG 13,5	29	12	26,5	24	20,4	20,4	26	6	28
0 980 24	PG 16	30	13	29,5	27	22,5	22,5	32	6	35
0 980 25	PG 21	35	15	36	33	28,3	28,3	36	7	38
0 980 26	PG 29	40	15	46,5	42	37	37	46	7	51
0 980 27	PG 36	49	17	58,5	53	47	47	60	8	66
0 980 28	PG 42	54	17	66,5	60	54	54	70	8	78
0 980 29	PG 48	54	18	75	68	60	60	75	8	82

Stopping plugs RAL 7001

Polyamide

Dimensions (mm)

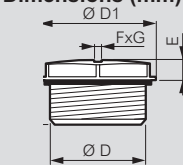

Cat.Nos	Threading	Ø D	D1	F X G	B	E
0 980 41	ISO 16	15,8	20,5	8 x 2	12	3,9
0 980 43	ISO 20	19,8	25	8 x 2	12	3,8
0 980 45	ISO 25	24,8	30,5	8 x 2	12	4,4
0 980 46	ISO 32	31,8	38	8 x 2	12	4,9
0 980 47	ISO 40	39,8	46,5	8 x 2	12,5	4,9

Cable glands RAL 9011 supplied without locking nut

Characteristics

Halogen-free polyamide
 Operating temperature: - 20 °C to + 80 °C
 Self-extinguishing 850 °C according to IEC 60695-2-11

Dimensions (mm)

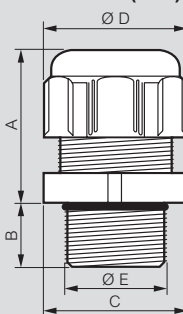

ISO

Cat.Nos	Threading	A	B	Ø D	C (to flat)	Ø E	Drilling Ø
3 815 58	ISO 12	22	10	16,8	15	11,9	12,7
3 815 59	ISO 16	26	10	21	19	15,8	16,2
3 815 60	ISO 20	29	12	26,5	24	19,9	20,4
3 815 61	ISO 25	35	15	36	33	24,8	25,4
3 815 62	ISO 32	40	15	46,5	42	31,6	32,5
3 815 63	ISO 40	49	17	58,5	53	39,8	40,5
3 815 64	ISO 50	54	17	66,5	60	49,8	50,8
3 815 65	ISO 63	54	18	75	68	62,6	64

Cable glands RAL 9011 supplied without locking nut (continued)

Dimensions (mm)

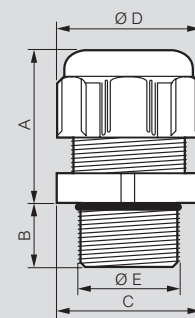

PG

Cat.Nos	Threading	A	B	Ø D	C (to flat)	Ø E	Drilling Ø
3 815 66	PG 7	22	10	16,8	15	12,1	12,7
3 815 67	PG 9	26	10	21	19	15,1	15,2
3 815 68	PG 11	27	12	24,5	22	18,2	18,6
3 815 69	PG 13,5	29	12	26,5	24	20,2	20,4
3 815 70	PG 16	30	13	29,5	27	22,3	22,5
3 815 71	PG 21	35	15	36	33	28,1	28,3
3 815 72	PG 29	40	15	46,5	42	36,9	37
3 815 73	PG 36	49	17	58,5	53	46,4	47
3 815 74	PG 42	54	18	66,5	60	53,5	54
3 815 75	PG 48	54	18	75	68	59,9	60

Cable glands RAL 7035 supplied without locking nut

Characteristics

Halogen-free polyamide
 Operating temperature: - 20 °C to + 80 °C
 Self-extinguishing 850 °C according to IEC 60695-2-11

Dimensions (mm)

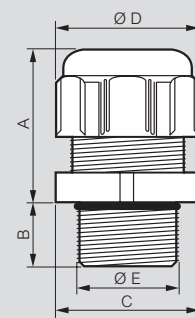

ISO

Cat.Nos	Threading	A maxi	B	Ø D	C (to flat)	Ø E	Drilling Ø
3 815 76	ISO 12	22	10	16,8	15	11,9	12,7
3 815 77	ISO 16	26	10	21	19	15,9	16,2
3 815 78	ISO 20	29	12	26,5	24	19,8	20,4
3 815 79	ISO 25	35	15	36	33	24,8	25,4
3 815 80	ISO 32	40	15	46,5	42	31,6	32,5
3 815 81	ISO 40	49	17	58,5	53	39,9	40,5
3 815 82	ISO 50	54	17	66,5	60	50	50,8
3 815 83	ISO 63	54	18	75	68	62,9	64

PG

Cat.Nos.	Threading	A maxi	B	Ø D	C (to flat)	Ø E	Drilling Ø
3 815 84	PG 7	22	10	16,8	15	12,5	12,7
3 815 85	PG 9	26	10	21	19	15,2	15,2
3 815 86	PG 11	27	12	24,5	22	18,6	18,6
3 815 87	PG 13,5	29	12	26,5	24	20,4	20,4
3 815 88	PG 16	30	13	29,5	27	22,5	22,5
3 815 89	PG 21	35	15	36	33	28,3	28,3
3 815 90	PG 29	40	15	46,5	42	37	37
3 815 91	PG 36	49	17	58,5	53	47	47
3 815 92	PG 42	54	17	66,5	60	54	54
3 815 93	PG 48	54	18	75	68	60	60

Plastic locking nuts RAL 9011 and RAL 7035

Fibreglass reinforced polyamide

Dimensions (mm)

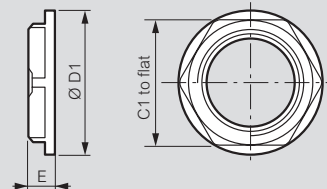

ISO

Cat.Nos	Threading	C1 (to flat)	E	Ø D1	Cat.Nos	Threading	C1 (to flat)	E	Ø D1
3 866 71/3 868 81	ISO 12	17	5	19	3 866 61/3 868 71	PG 7	19	5	21
3 866 72/3 868 82	ISO 16	22	5	24	3 866 62/3 868 72	PG 9	22	5	24
3 866 73/3 868 83	ISO 20	26	6	28	3 866 63/3 868 73	PG 11	24	5	26
3 866 74/3 868 84	ISO 25	32	6	35	3 866 64/3 868 74	PG 13,5	26	6	28
3 866 75/3 868 85	ISO 32	42	7	46	3 866 65/3 868 75	PG 16	30	6	32
3 866 76/3 868 86	ISO 40	50	7	56	3 866 66/3 868 76	PG 21	36	7	38
3 866 77/3 868 87	ISO 50	60	8	66	3 866 67/3 868 77	PG 29	46	7	51
3 866 78/3 868 88	ISO 63	75	8	81	3 866 68/3 868 78	PG 36	60	8	66
					3 866 69/3 868 79	PG 42	70/64	8	78/72
					3 866 70/3 868 80	PG 48	75/69	8	82/77

PG